

meross

User Manual

Package Contents

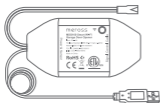

1 x Smart Garage Door Opener



1 x USB Adapter



8 x Screws



1 x Door Sensor with Cable



1 x Test Wire



1 x Double-sided Adhesive Tapes

* If you find any part is missing in the package, please contact support@meross.com, we will provide proper solution for you.

Installation Guide

1. Meross smart garage door opener is the companion device of your existing garage door opener. Its main working principle is as follows.

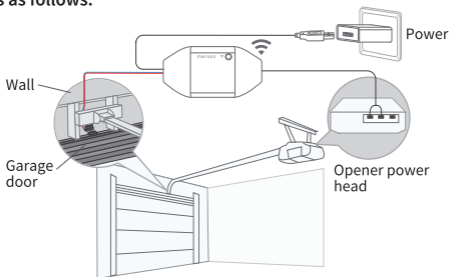

2. Download the Meross app and choose Smart Garage Door Opener to get start.



3. Power on the device. Wait about 5 seconds until the status LED blinks amber and green.

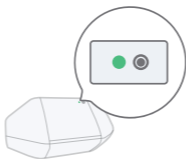

4. Connect the device to your home WiFi with Meross app.

5. Connect the sensor cable. Move the sensor to check if it is functional*.



*Please contact support@meross.com for help if the sensor is not functional.

6. Find a proper position on the garage door to mount the sensors*. Please make sure the distance between the two sensors is less than 1 inch when the garage door is closed, and the two sensors are well separated when the garage door is open.

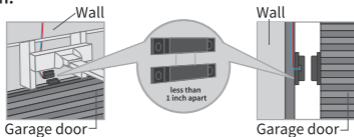

*You can use the included double-sided adhesive tapes or screws for sensor fixation.

7. Power off your smart garage door opener first. Then screw the signal control cable into the slots. Wire order does not matter here.

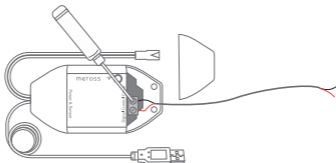

8. Power off your existing garage door opener. Connect the other end of the signal control cable to the two terminals that connects to the wall button. Wire order does not matter here, too.

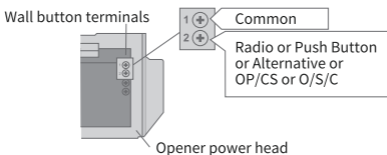

9. Deploy the device. We recommend to deploy it on the top of your existing garage door opener. Use the provided double-sided adhesive tapes for the fixation if necessary.

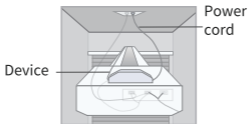

10. Power on both existing garage door opener and smart garage door opener. The smart garage door opener will reconnect to Meross cloud service automatically. Congratulations! You have completed all installation steps.

LED and Button Rules

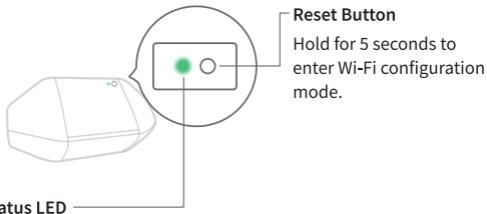

Solid amber: Initialization/ Reset/ Firmware upgrading mode.

Flashing amber and green slowly: Configuration mode.

Flashing green rapidly: Wi-Fi connecting mode.

Solid green: Successfully connected.

Solid red: No internet connection.

Flashing amber once: Sensors connected or disconnected(Door close or open detected).

Off: Powered OFF.

How to Use

1. General Settings

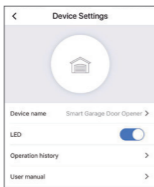

Device name:

Change device name.

LED:

Turn on/off LED.

Operation history:

Check operation history.

User manual:

Check user manual.

2. Voice Control

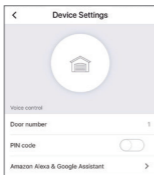

Door number:

The garage door number, used for voice control function to distinguish different doors.

PIN code:

After enable this, PIN code verification is needed each time when you open or close the door.

Amazon Alexa & Google Assistant:

Check Amazon Alexa & Google Assistant user manual.

Amazon Alexa  WORKS WITH amazon alexa

Meross provides two types of voice commands for Amazon Alexa.

If you choose “Meross” skill, the commands are as following:

- “Hi Alexa, lock/unlock my garage.”

- “Hi Alexa, is my garage locked?”

Note: Please replace “garage” to the garage door name you set.

Amazon Alexa support Security Code, you can enable it via Amazon Alexa app.

If you choose “Smart Meross” skill, the commands are as following:

-“Hi Alexa, ask Smart Meross to open/close the garage door one/two/...”

-“Can I have your PIN code?”

Or

-“Hi Alexa, open Smart Meross.”

-“Open/Close garage one/two/...”

-“Can I have your PIN code?”

-“Check garage.”

Note: PIN code is an optional setting.

Google Assistant:



The same as Amazon Alexa, Meross provides two types of voice commands for Google Assistant.

If you choose “Meross” action, the commands are as following:

-“Hey Google, open/close my garage.”

-“Can I have your security code?”

-“Hey Google, is my garage opened/closed?”

Note: Please replace “garage” to the garage door name you set.

If you choose “Smart Meross” customized action, the commands are as following:

-“Hey Google, ask Smart Meross to open/close the garage door one/two/...”

-“Can I have your PIN code?”

-“Hey Google, ask Smart Meross to check the garage door two?”

Or

-“Hey Google, talk to Smart Meross”

-“Open/Close garage two.”

-“Can I have your PIN code?”

-“Check garage.”

Note: PIN code is an optional setting.

3. Door notification

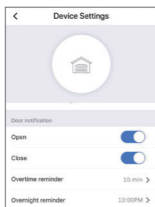

Open:

Send me a notification each time my garage door opens.

Close:

Send me a notification each time my garage door closes.

Overtime reminder:

Send me a notification when my garage door opens for 10-60 mins.

Overnight reminder:

Send me a notification when my garage door is still open after particular time.

4. Widgets

Widgets are the quick access to your Meross devices and Scenes. To enable it, please go to **Account** -> **Widget** to add shortcuts first. And then follow below steps on your smartphones to activate them.

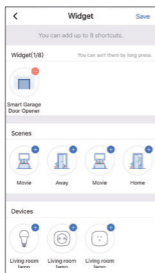

For iPhones:

1. Swipe to the right on your Home or Lock screen.
2. Scroll down to the bottom of your widget list and then tap edit.
3. Scroll down to find Meross and add it.

For Android smartphones:

1. On the home screen, tap and hold on an available space.
2. Tap Widgets, find Meross widget and then add it.

FAQ

At Meross we strive to assure your satisfaction. Any questions about Smart Garage Door Opener please feel free to contact support@meross.com.

1. Can I manage multiple smart garage door openers within Meross app?

One smart garage door opener is for one garage door only, you can configure multiple smart garage door openers within the app.

2. What shall I do when my Meross app is unable to control the added smart garage door opener?

Please check the followings:

- Check the main Wi-Fi's internet connection.
- Make sure that main Wi-Fi's password hasn't been changed.
- Factory reset the device and try to configure its Wi-Fi part again.

Warranty

Meross products are covered by a 12 months limited warranty from the date of its original purchase. If any problems occur, please contact support@meross.com for help.

We can only provide aftersales service for products that are sold by Meross or Meross authorized retailers and distributors.



Federal Communication Commission (FCC) Statement for Users

Warning: Changes or modifications not expressly approved by the party responsible for compliance could void the user's authority to operate the equipment.

This device complies with Part 15 of the FCC Rules. Operation is subject to the following two conditions: (1) this device may not cause harmful interference, and (2) this device must accept any interference received, including interference that may cause undesired operation.

Note: This equipment has been tested and found to comply with the limits for a Class B digital device, pursuant to Part 15 of the FCC Rules. These limits are designed to provide reasonable protection against harmful interference in a residential installation. This equipment generates, uses, and can radiate radio frequency energy, and if not installed and used in accordance with the instructions, may cause harmful interference to radio communications. However, there is no guarantee that interference will not occur in a particular installation. If this equipment does cause harmful interference to radio or television reception, which can be determined by turning the equipment off and on, the user is encouraged to try to correct the interference by one or more of the following measures:

- Reorient or relocate the receiving antenna.
- Increase the separation between the equipment and receiver.
- Connect the equipment into an outlet on a circuit different from that to which the receiver is connected.
- Consult the dealer or an experienced radio/TV technician for help.

This equipment complies with FCC radiation exposure limits set forth for an uncontrolled environment. This equipment should be installed and operated with a minimum distance of 20cm between the radiator & your body. This transmitter must not be co-located or operating in conjunction with any other antenna or transmitter.

IC

Innovation, Science and Economic Development Canada (ISED) Statement for Users

This device contains licence-exempt transmitter(s)/receiver(s) that comply with Innovation, Science and Economic Development Canada's licence-exempt RSS(s). Operation is subject to the following two conditions:

- (1) This device may not cause interference.
- (2) This device must accept any interference, including interference that may cause undesired operation of the device.

L'émetteur/récepteur exempt de licence contenu dans le présent appareil est conforme aux
CNR d'Innovation, Sciences et Développement économique
Canada applicables aux appareils radio exempts de licence.
L'exploitation est autorisée aux deux conditions suivantes :

- 1) L'appareil ne doit pas produire de brouillage;
- 2) L'appareil doit accepter tout brouillage radioélectrique subi, même si le brouillage est susceptible d'en compromettre le fonctionnement.

SIMPLE DEVICE SIMPLIFY YOUR LIFE

Email: support@meross.com
Website: www.meross.com

