

HYPER TOY CO

2.4Ghz

INSTRUCTION MANUAL -1:10 SCALE AMPHIBIOUS RC TRUCK

Welcome to our company's world of toys! To ensure an enjoyable experience with this toy, read the following instructions—which will give you a proper understanding of the product and its correct use—before use. Please hold on to this manual.

USE AGE: 8+

NOTICE:

This toy is not suitable for children under the age of 36 months due to the risk of swallowing small components. They are a choking hazard.

- Keep these instructions for future reference. They contain important information. We have the right to improve/modify our product specifications without notice.
- Use under the supervision of adults.
- Do not change or modify this product. If you modify the product, you may not use it.

BATTERY USE

- When using the battery for the first time, charge it before use. For the first two charges, the charge time will be at least 8 hours for the first charge and 4 hours for the second charge. Do not overcharge. Charging for a long time will not increase power.
- Insert the battery cable connector into the charger's cable port. Then plug the charger into an indoor power outlet.
- Use the rechargeable battery and charger that we have configured for this product.
- Regularly check toy, batteries, charger wires, plugs, and other parts. If these parts are damaged, they cannot be used again. They need to be repaired before they can be used.
- Please use high-quality AA batteries for the best user experience of this product.

OPERATING THE CONTROLLER AND REMOTE-CONTROL CAR

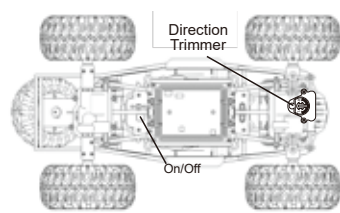

OPERATING TIPS

- Make sure the power switch is in the On position. When you are operating the remote-control car, if the power switch is in the Off position, it will not function.
- When the remote-control car veers left when you are trying to drive in a straight line, adjust the direction trimmer slightly to the right until the remote-control car has the correct trajectory.
- When the remote-control car veers right when you are trying to drive in a straight line, adjust the direction trimmer slightly to the left until the remote-control car has the correct trajectory.

CONTROLLER USE DIAGRAM

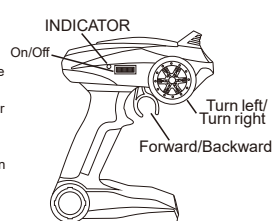

Battery charging and installation method

- Install the battery according to the positive and negative electrodes in the battery box.
- Install the battery cover as indicated by the arrows in the above figure.
- Put rechargeable batteries into the battery box.
- Turn the four rotating tabs to fasten the battery cover.
- Batteries should be charged under adult supervision.

Rechargeable battery

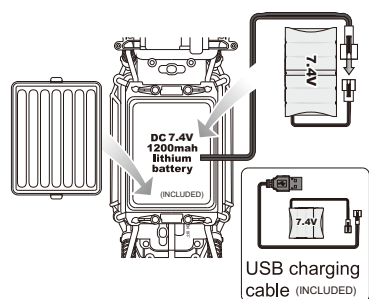

CONTROLLER

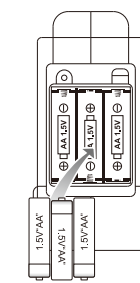

3x1.5V"AA"
(NOT INCLUDED)

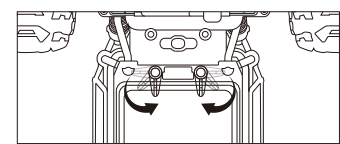

Rotate the tabs to fasten the battery cover.

NOTICE:

- You must completely install the battery cover before using the remote-control car.
- The battery and body-battery interface must not be exposed to water.
- When the USB is charging, the red light will flash, and the red light will be off when the battery is fully charged. The red light is on when the battery is disconnected from the power supply.

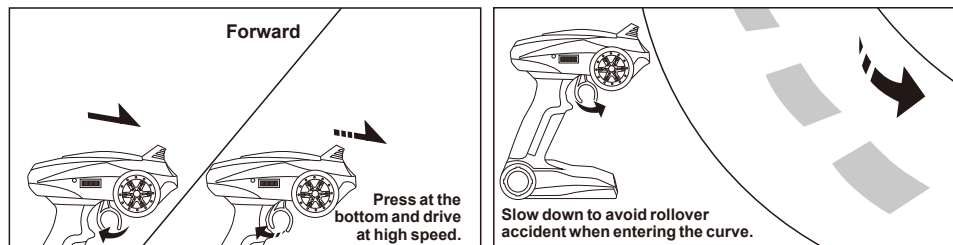

How do you play with the remote-control car?

- Flip the remote-control car's switch to the On position.
- Operate the control trigger to make the remote-control car drive forward or backward and to the left or right.
- If the remote-control car does not drive in a straight line, adjust the direction trimmer beneath the car.
- Flip the switch of the remote-control car and controller to the Off position after use.

Safe use of batteries

- Charge under adult supervision.
- Remove the rechargeable battery from under the car to charge.
- Remove dead batteries from the remote-control car and controller.
- Turn the remote-control car switch to the Off position before installing the battery.
- When installing the batteries in the battery compartment according to the instructions, be careful not to install the (+) and (-) electrodes in the wrong position. Make sure that the battery's electrodes are installed correctly.
- Do not recharge non-rechargeable batteries.
- The power terminals must not be short-circuited.
- If it has been a long time since you have used the remote-control car, remove the batteries from the remote-control car and controller.
- Do not expose the battery to fire: It may explode or leak.
- Different types of batteries or old and new batteries should not be mixed.
- Only use the recommended batteries or their equivalent.
- The batteries should be checked regularly for leaks.
- Keep this manual for use when needed. This manual has important information.

Maintenance and repair

- Do not put the toy in the water: This will damage the electronic components. (If you buy an amphibious vehicle, you can drive it in the water.)
- Do not allow the wires or power connector to come into contact with water.
- Wipe the surface with a damp cloth.
- Do not expose toys to high temperatures, humidity or direct sunlight.
- If you don't expect to play for a long period, remove the batteries.

Be careful

When the car is moving, do not touch its four wheels with your hands to avoid damaging it.

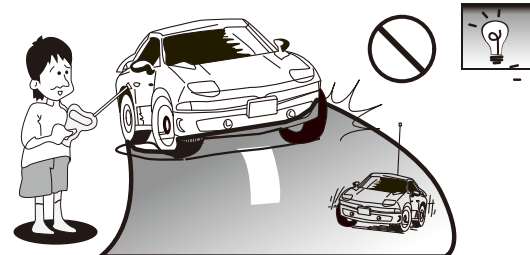

Avoid playing beside the road or in dangerous places. This will prevent accidents.



Do not play with your remote-control car in wastewater.

Common troubleshooting method

Problem.	Cause of problem.	Solution
Why the car will not drive.	1. You did not flip the car's or the controller's switch to the On position. 2. The battery is not installed correctly. 3. The car's battery power is low.	1. Flip the car's or controller's switch to the On position. 2. Install the battery correctly in the controller. 3. Replace the car's battery or charge rechargeable battery.
The car is hard to control, or the remote control distance is limited.	1. People nearby are using the same or a close frequency. 2. The controller or car does not have enough power.	1. Use the car elsewhere or wait for others to stop using the frequency. 2. Replace the controller's or remote-control car's battery or charge the rechargeable battery.

NOTE: This equipment has been tested and found to comply with the limits for a Class B digital device, pursuant to part 15 of the FCC Rules. These limits are

designed to provide reasonable protection against harmful interference in a residential installation. This equipment generates uses and can radiate radio frequency energy and, if not installed and used in accordance with the instructions, may cause harmful interference to radio communications. However, there is no guarantee that interference will not occur in a particular installation. If this equipment does cause harmful interference to radio or television reception, which can be determined by turning the equipment off and on, the user is encouraged to try to correct the interference by one or more of the following measures:

- Reorient or relocate the receiving antenna.
- Increase the separation between the equipment and receiver.
- Connect the equipment into an outlet on a circuit different from that to which the receiver is connected.
- Consult the dealer or an experienced radio/TV technician for help

Changes or modifications not expressly approved by the party responsible for compliance could void the user's authority to operate the equipment.

This device complies with Part 15 of the FCC Rules. Operation is subject to the following two conditions:

- (1) this device may not cause harmful interference, and
- (2) this device must accept any interference received, including interference that may cause undesired operation.

BATTERY WARNING:

- Do not mix alkaline, standard (carbon zinc), rechargeable (nickel hydride) batteries.
- Do not mix old and new batteries.
- Non-rechargeable batteries should not be recharged.
- Rechargeable batteries should be removed from the appliance before being charged.
- Rechargeable batteries should be charged under adult supervision only.
- Exhausted batteries should be removed.
- The supply terminals should not be short-circuited.
- Only batteries of the same or equivalent type are recommended to be used.
- Batteries should be inserted with the correct polarity.

This device contains licence-exempt transmitter(s)/receiver(s) that comply with Innovation, Science and Economic Development Canada's licence-exempt RSS(s). Operation is subject to the following two conditions:

- (1) This device may not cause interference.
- (2) This device must accept any interference, including interference that may cause undesired operation of the device.

This equipment complies with IC RSS-102 radiation exposure limits set forth for an uncontrolled environment.



Tested to comply with FCC standards.
FOR HOME OR OFFICE USE.
This device complies with part 15 of the FCC Rules. Operation is subject to the following two conditions:
(1) This device may not cause harmful interference and
(2) This device must accept any interference received, including interference that may cause undesired operation.

WARNING:
CHOKING HAZARD—Small parts.
Not for children under 3 years.



DISTRIBUTED BY:
HYPER TOY COMPANY
1-866-204-9737 Toll Free
177 Malaga Park Dr. Malaga, NJ 08328

HYPER TOY CO
help@hypertoys.com

DISTRIBUÉ PAR:
HYPER TOY COMPANY
1-866-204-9737
Numéro de téléphone sans frais ou
177 Malaga Park Dr. Malaga, NJ 08328

© Copyright 2021 HyperToys
©Tous droits réservés 2021. Hyper Toy Company

MADE IN CHINA
Batch Ref: 210610HY
HYP-SAM-0110