

<p>DO NOT MIX ALKALINE, STANDARD (CARBON ZINC) OR RECHARGEABLE (NICKEL-CADMIUM) BATTERIES.</p> <p>DO NOT MIX OLD AND NEW BATTERIES.</p> <p>DO NOT DISPOSE OF BATTERIES IN FIRE. BATTERIES MAY EXPLODE OR LEAK.</p>	<p><b>WARNING:</b> CHOKING HAZARD—Small parts. Not for children under 3 years.</p> <p>PLEASE DO NOT RETURN TO STORE</p> <p>For more information please email Consumer Services: help@hypertoys.com</p> <p>COLORS AND DECORATIONS MAY VARY. KEEP CONTENT DETAILS FOR FUTURE REFERENCE.</p>
--	---

This device complies with RSS210 of Industry Canada.  
This device complies with Industry Canada license-exempt RSS standard(s). Operation is subject to the following two conditions: (1) this device may not cause interference, and (2) this device must accept any interference, including interference that may cause undesired operation of the device.

### Battery Safety Information:

- Ensure that battery polarity is correct.
- Use only batteries of the type recommended (or equivalent).
- Do not mix old and new batteries.
- Do not mix alkaline, standard (carbon-zinc), or rechargeable (nickel-cadmium) batteries.
- Rechargeable batteries are to be recharged by Adult only.
- Remove used-up batteries immediately.
- Do not recharge non-rechargeable batteries.
- Do not short-circuit terminals.
- Dispose of batteries safely. Do not dispose of batteries (or products containing non-rechargeable batteries) in fire, as batteries may explode or leak.



This device complies with the Part 15 of the FCC rules. Operation is subject to the following two conditions: (1) This device may not cause harmful interference, and (2) this device must accept any interference received, including interference that may cause undesired operation.

Caution: changes or modifications not expressly approved by the party responsible for compliance could void the user's authority to operate the equipment.

NOTE: This equipment has been tested and found to comply with the limits for a Class B digital device, pursuant to Part 15 of the FCC Rules. These limits are designed to provide reasonable protection against harmful interference in a residential installation. This equipment generates, uses and can radiate radio frequency energy and, if not installed and used in accordance with the instructions, may cause harmful interference to radio communications. However, there is no guarantee that interference will not occur in a particular installation. If this equipment does cause harmful interference to radio or television reception, which can be determined by turning the equipment off and on, the user is encouraged to try to correct the interference by one or more of the following measures: Reorient or relocate the receiving antenna. Increase the separation between the equipment and receiver. Connect the equipment into an outlet on a circuit different from that to which the receiver is connected. Consult the dealer or experienced radio/TV technician for help.



**DISTRIBUTED BY:**  
**HYPER TOY COMPANY**  
1-866-204-9737 Toll Free  
177 Malaga Park Dr. Malaga, NJ 08328

**HYPER TOY CO**  
help@hypertoys.com

**DISTRIBUÉ PAR:**  
**HYPER TOY COMPANY**  
1-866-204-9737  
Numéro de téléphone sans frais ou  
177 Malaga Park Dr. Malaga, NJ 08328

© Copyright 2022. **HyperToys**  
© Tous droits réservés 2022. **HyperToys**

MADE IN CHINA

# HYPER TOY CO

## 6+

2.4 GHz

ENGLISH



## **Notice:**

If the car is in the raised state (as shown in the figure 1 ), please do not twist the front or rear of the car. Open the battery cover to connect the battery, then turn on the power switch, the car will automatically twist to the flat state (as shown in the figure 2 ), and then it can operate normally!

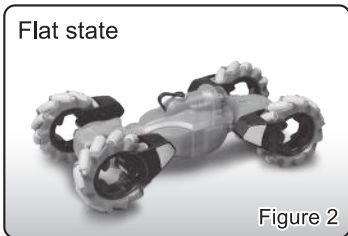
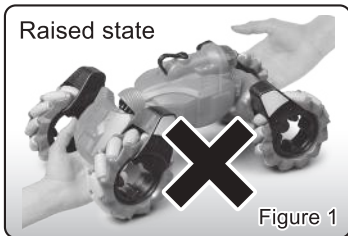

## **Batteries and Instructions for charging**

**(1) The remote control unit is equipped with two 1.5V AA non-rechargeable batteries (Battery need additional purchase).**

- Loosen the screws on the battery door with cross screwdrivers.  
(Phillips screwdriver need additional purchase)
- Load the new 1.5V AA batteries corresponding the “+” and “-” in the battery case to the “+” and “-” of the batteries.
- Cover up the battery cover, and tighten the screws.

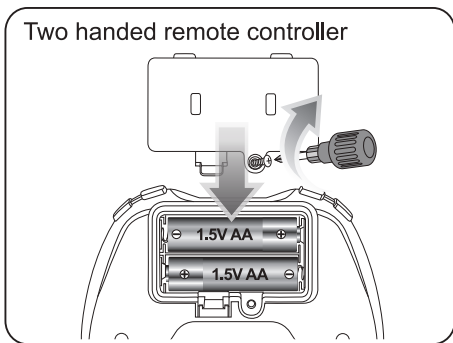

## (2) Charging mode of USB cable

- a) Take out the rechargeable battery from the product as shown in the diagram.  
(Phillips screwdriver need additional purchase)

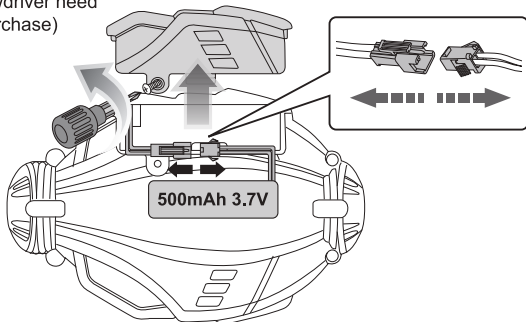

- b) Plug the USB into the computer's USB interface, and then plug the lithium battery into the charge port of the USB, when the red indicator light for charging in the USB will be long on. A full charge will take about 90 minutes. After a full charge, the red indicator light will be off, and the product will be used 5 minutes later. Overcharging may damage the batteries, cause burnings or catch a fire.

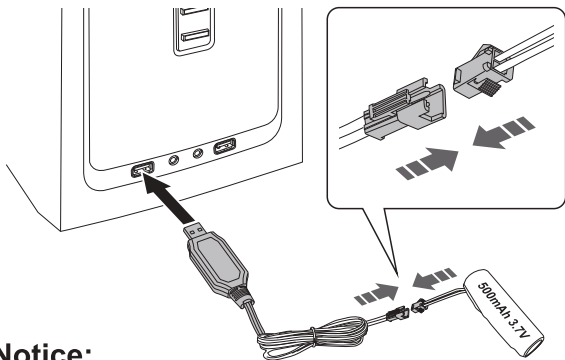

### Notice:

When the product is idle, please push its power switch to "OFF", and take out the batteries in case the service life of the rechargeable batteries is affected.

- c) Load the battery pack in the battery case by corresponding to the correct electrodes, and cover up the battery cover. (Phillips screwdriver need additional purchase)

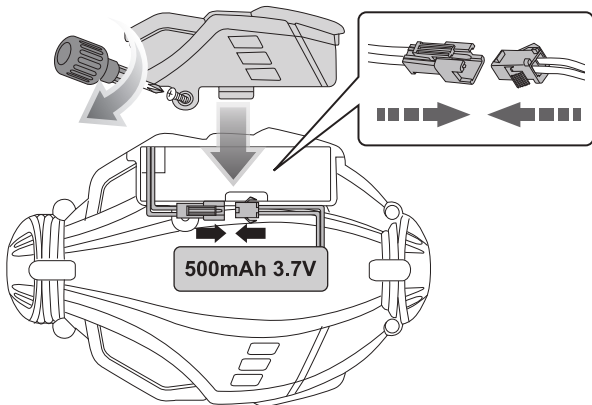

## 2 Battery Warning



- Do not mix alkaline, standard(carbon zinc), rechargeable(nickel hydride) batteries.
- Do not mix old and new batteries.
- Non-rechargeable batteries should not be recharged.
- Rechargeable batteries should be removed from the appliance before being charged.
- Rechargeable batteries should be charged under adult supervision only.
- Exhausted batteries should be removed.
- The supply terminals should not be short-circuited.
- Only batteries of the same or equivalent type are recommended to be used.
- Batteries should be inserted with the correct polarity.

Rechargeable batteries are to be removed from the toy before being charged; The packaging or instruction shall include a statement that the charger to be used with the sample should be regularly examined for potential hazard, such as damage to the cable or cord, plug, enclosure of other parts and that in the event of such damage, the sample must not be used until that damage had been properly removed.

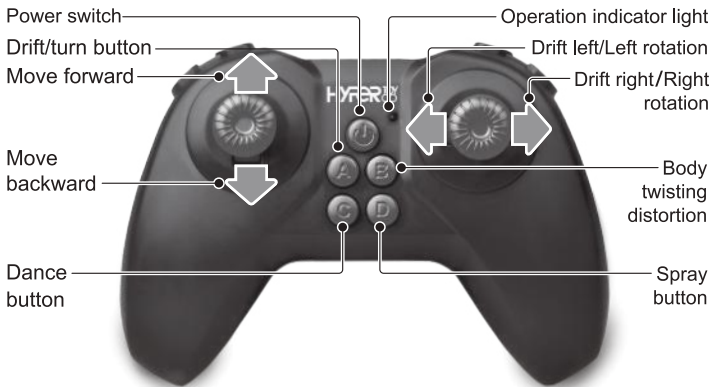
### 3 Description of functions of remote controller



## 4 Demonstration and description of functions

**Turn on the power:** Pull the power switch of the remote control car to the "ON" position, press the "  " power switch of the remote controller, making the power indicator flash, then the power will be turned on. If the operation indicator of the remote controller is on continuously, then the frequency matching succeeds. Long press the power switch button "  " of the remote controller to turn off the power and also the indicator light of the controller.

**Remote control distance:**

About 20-30m.

**Using time:** Up to 16 minutes about under a full charging state.

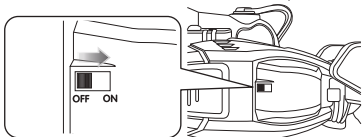

### **Notice:**

When the remote controller fails to control the remote control car, power off the remote controller first, then power off the remote control car, and then power on the remote controller and the remote control car again. If the indicator light of the remote controller is on continuously, then frequency matching succeeds.

---

#### 1. Move forward / Move backward

Push up/pull back the left control lever to move the remote control car forward/backward; push up/pull back the left control lever continuously, then remote control car will move forward/backward continuously.

**Move forward /  
Move backward**

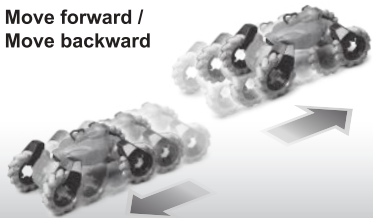

---

#### 2. Drift left

Push the right control lever to the left, then remote control car will drift to the left; push the right control lever to the left continuously, then the remote control car will drift to the left continuously.

**Drift left**

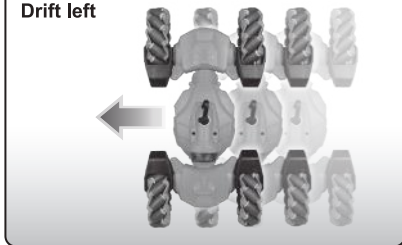

### 3. Drift right

Push the right control lever to the right, then remote control car will drift to the right; push the right control lever to the right continuously, then the remote control car will drift to the right continuously.

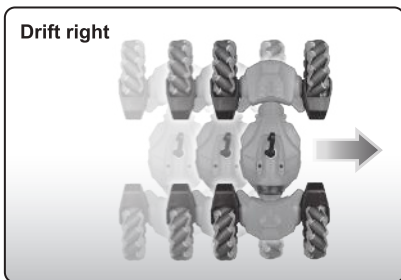

**Drift/turn button:** Press the "Drift/rotate" button to switch from "Left/right drift" to "Left/right turn".

### 4. Left rotation

Push the right control lever to the left, then remote control car will rotate in its original place in the counter-clockwise direction, push the right control lever to the left continuously, then the remote control car will rotate in its original place in the counter-clockwise direction continuously.

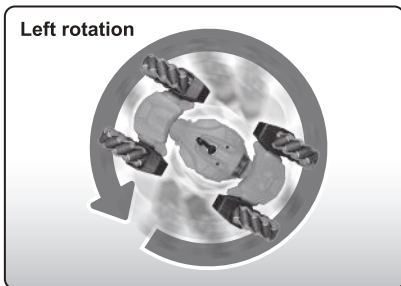

---

### 5. Right rotation

Push the right control lever to the right, then the remote control car will rotate in its original place in the clockwise direction; push the right control lever to the right continuously, then the remote control car will rotate in its original place in the clockwise direction continuously.

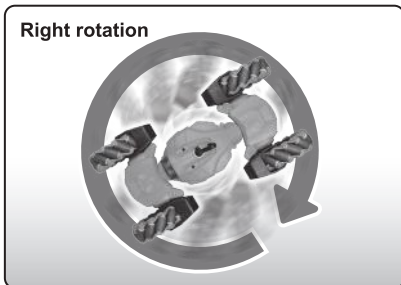

## 6. Left forward turn

Push the left control lever up and the right control lever to the left, and then the remote control car will move forward and to its left.

### Left forward turn



---

## 7. Right forward turn

Push the left control level up and the right control level to the right, and then the remote control vehicle will move forward and to its right.

### Right forward turn



---

## 8. Left backward turn

Pull the left control lever down and the right control lever to the left, and then the remote control car will move backward and to its left.

### Left backward turn





## 9. Right backward turn

Pull the left control lever down and the right control lever to the right, and then the remote control car will move backward and to its right.

### Right backward turn

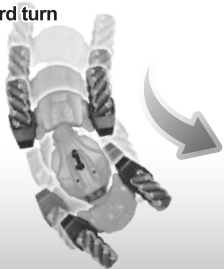

## 10. Body twisting distortion

Press the " **B** " button, the remote control car body rises and becomes the off-road vehicle mode. Press the " **B** " button again to lower the body of the remote control and resume the sports car mode.

### Body twisting distortion



## 11. Dance

When the " **C** " key is pressed once, music will be played and at the same time the remote control car will start to automatically dance; when the " **C** " key is pressed again, the next dance music is switched to automatically.

### Dance



## 12. Add clean water

- (1) Remove the water plug on the top of the remote control car.
- (2) Pour clean water into the water hole at the top of the remote control car with a kettle.
- (3). Put back the water plug.

### Add clean water



### Notice:

1. The water injected into the car should be clean without impurity.
  2. The injected water should not be too full in order to prevent the circuit board from immersing into the overflowing water, resulting in short circuit.
- 

## 13. Spray

Press the "  " button to control the car to spray from the rear spray jet (as shown on the right).

### Spray



## WARNING

There are small parts inside possibly causing a choking hazard, so the product isn't suitable for children 3 years old and below. When the product is being used, an adult must be on the scene for guardianship and guidance. These instructions have important information and thus shouldn't be discarded randomly. They should be kept properly for future inquiry.

## 5 Solutions to problems

<b>Problem</b>	<b>Cause</b>	<b>Processing Method</b>
The remote control fails to function.	1. The remote control is not powered on.	1. Power on the remote control.
	2. Fail to put the battery into the right electrodes.	2. Check and make sure that the battery is put in according to the signs of the electrodes on the battery box.
	3. Low battery.	3. Replace with new batteries.
	4. Out of the controllable distance.	4. Keep the remote control within 30 meter and point at the remote control car.
	5. No pairing frequency between the remote controller and remote control car	5. When the remote controller fails to control the remote control car, power off the remote controller first, then power off the remote control car, and then power on the remote controller and the remote control car again. If the indicator light of the remote controller is on continuously, then frequency matching succeeds.
The remote control car cannot be controlled	1. Make the on/off stay at the "OFF" position.	1. Make the on/off stay at the "ON" position.
	2. The remote control car and rechargeable battery pack haven't been connected by correctly corresponding with the electrodes.	2. Check and make sure that the battery pack is connected to the remote control car according to the right electrodes.
	3. Low battery.	3. Recharge or replace the battery pack when it is running low.
	4. The remote control car has unclear voice and dark light.	4. Recharge or replace the battery pack when it is running low.
	5. The remote controller and remote control car haven't undergone frequency pairing	5. When the remote controller fails to control the remote control car, power off the remote controller first, then power off the remote control car, and then power on the remote controller and the remote control car again. If the indicator light of the remote controller is on continuously, then frequency matching succeeds.
The car fails to spit fire in the form of atomization.	Insufficient water.	Replenish clean water for the car.