



Hennessey VELOCIRAPTOR 6X6

6+ AGES



YAMAHA

4XZ 1000R

ENGLISH

CONTENTS

Ford Hennessey VELOCIRAPTOR 6X6



YAMAHA 4XZ 1000R



Vehicle

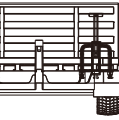
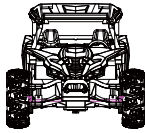

Trailer



Transmitter X 2

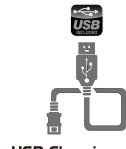

USB Charging Cord (Included) X 2

Battery

Vehicle

1 x 3.7V 800mAH

1 x 3.7V 600mAH (built-in battery)

Rechargeable Battery (included)

Transmitter

2 x AA.15V

(Not Included)



VELOCIRAPTOR 6X6 Hennessey

Vehicle

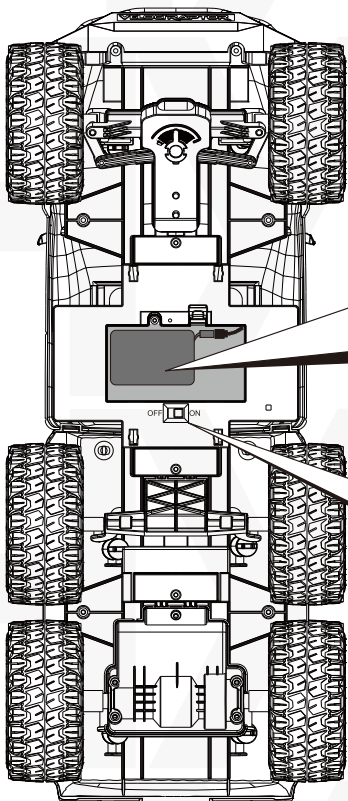

Connect the rechargeable Battery in the battery compartment.

Rechargeable battery can be recharged by USB cable.

Battery compartment need to unscrew to open.

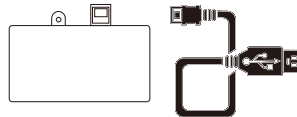

ON/ OFF Switch



Turn on the switch of the vehicle. Please be sure to confirm that the switch in the rubber packing was switched over.

TRANSMITTER

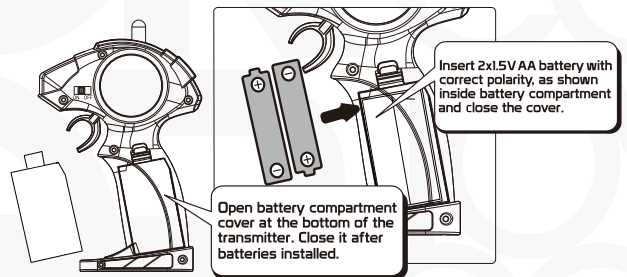

Insert 2x1.5V AA battery with correct polarity, as shown inside battery compartment and close the cover.

Open battery compartment cover at the bottom of the transmitter. Close it after batteries installed.

TURNING ALIGNMENT

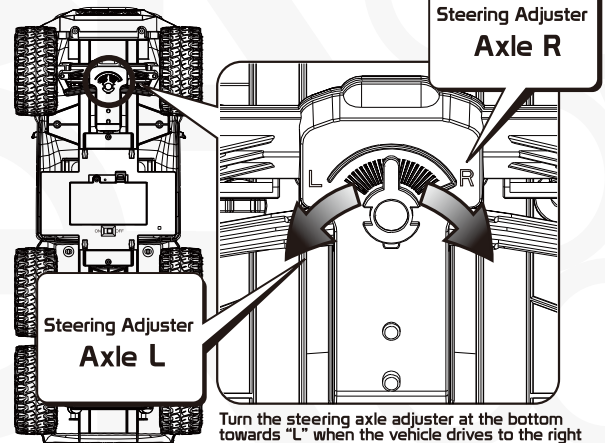

Steering Adjuster Axle R

Steering Adjuster Axle L

Turn the steering axle adjuster at the bottom towards "L" when the vehicle drives to the right unintentionally. If it turns left unintentionally, turn the adjuster towards "R".

Trailer

Trailer can be connected to the rear of the truck.

Gentle insert it from the trailer to the hole on the rear of the truck.

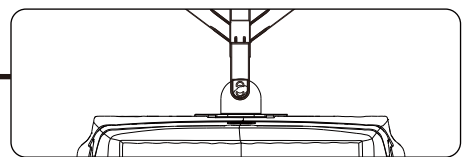
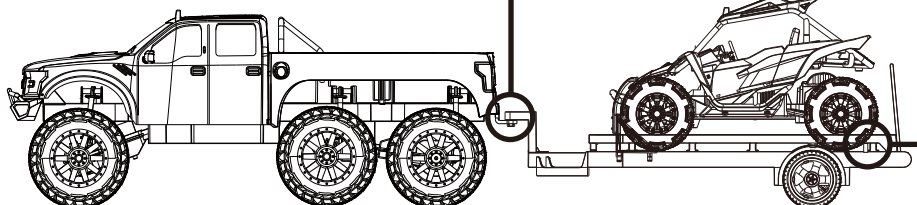

Two clips on the rear of the trailer can hold the vehicle which on the trailer when playing. Insert the clips from under the trailer, twist them left or right to lock them in place.



Vehicle

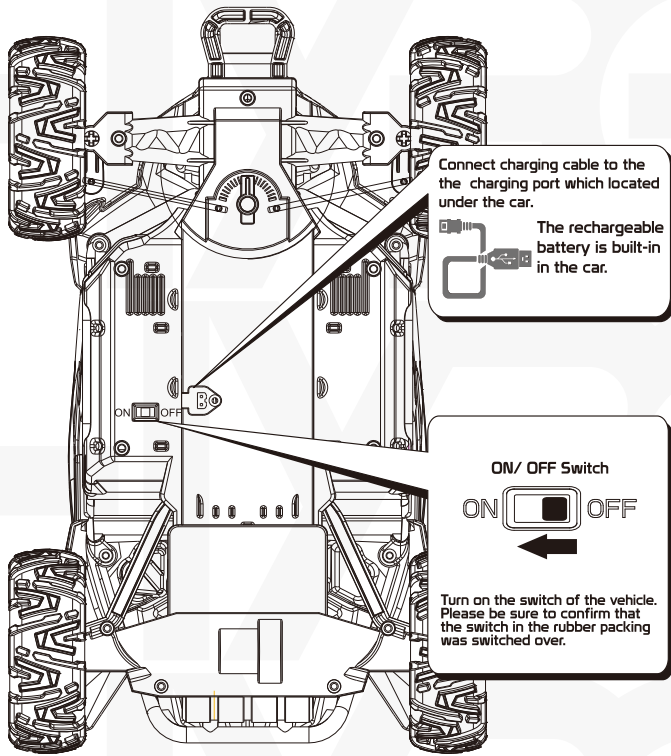

TRANSMITTER

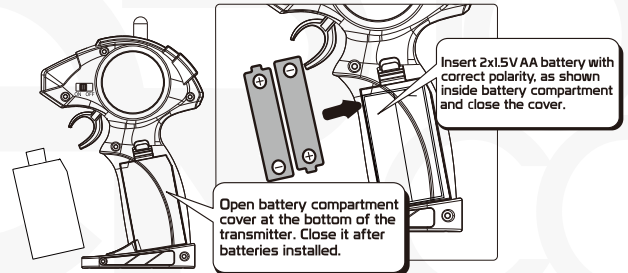

TURNING ALIGNMENT

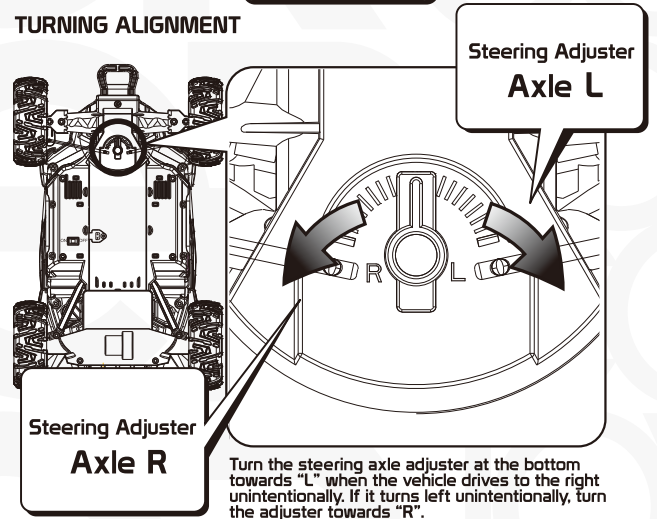

REMOTE INSTRUCTION

Forward

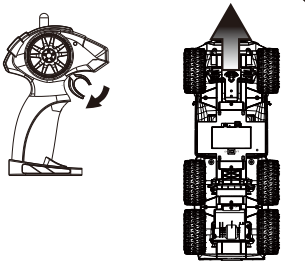

Backward

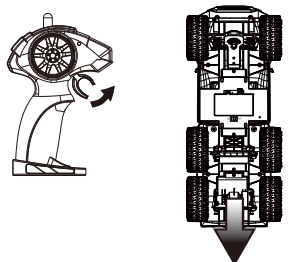

Turn Left

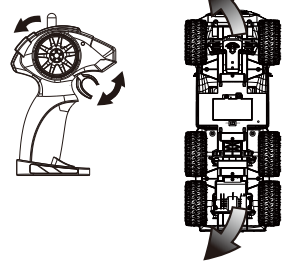

Turn Right

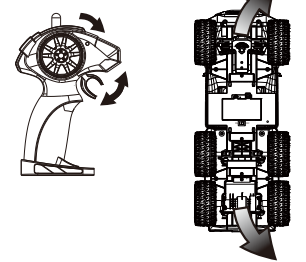

After Play

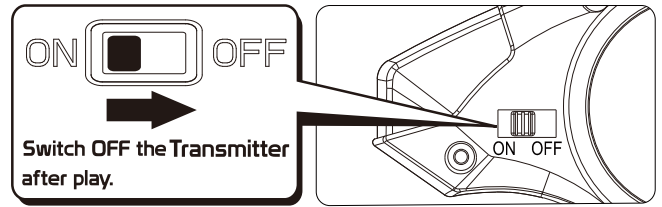
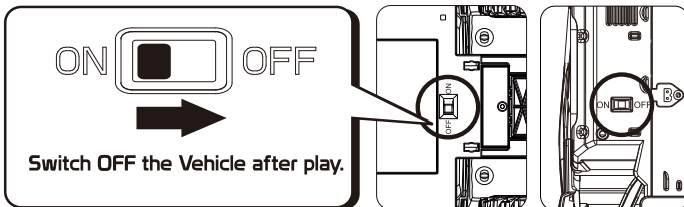

Battery Safety Information:

- Insure that battery polarity is correct.
- Use only batteries of the type recommended (or equivalent).
- Do not mix old and new batteries.
- Do not mix alkaline, standard (carbon-zinc), or rechargeable (nickel-cadmium) batteries.
- Rechargeable batteries are to be removed from the product before being charged.
- Rechargeable batteries are to be recharged by Adult only.
- Remove used-up batteries immediately.
- Do not recharge non-rechargeable batteries.
- Do not short-circuit terminals.
- Dispose of batteries safety. Do not dispose of batteries (or products containing non-rechargeable batteries) in fire, as batteries may explode or leak.



This device complies with the Part 15 of the FCC rules. Operation is subject to the following two conditions: (1) This device may not cause harmful interference, and (2) this device must accept any interference received, including interference that may cause undesired operation.

Caution: changes or modifications not expressly approved by the party responsible for compliance could void the user's authority to operate the equipment.

NOTE: This equipment has been tested and found to comply with the limits for a Class B digital device, pursuant to Part 15 of the FCC Rules. These limits are designed to provide reasonable protection against harmful interference in a residential installation. This equipment generates, uses and can radiate radio frequency energy and, if not installed and used in accordance with the instructions, may cause harmful interference to radio communications. However, there is no guarantee that interference will not occur in a particular installation. If this equipment does cause harmful interference to radio or television reception, which can be determined by turning the equipment off and on, the user is encouraged to try to correct the interference by one or more of the following measures: Reorient or relocate the receiving antenna. Increase the separation between the equipment and receiver. Connect the equipment into an outlet on a circuit different from that to which the receiver is connected. Consult the dealer or experienced radio/TV technician for help.

This device contains licence-exempt transmitter(s)/receiver(s) that comply with Innovation, Science and Economic Development Canada's licence-exempt RSS(s). Operation is subject to the following two conditions:

1. This device may not cause interference.
2. This device must accept any interference, including interference that may cause undesired operation of the device.



Made in China