

TWS02

TRUE WIRELESS SPORTS EARPHONES

USER MANUAL

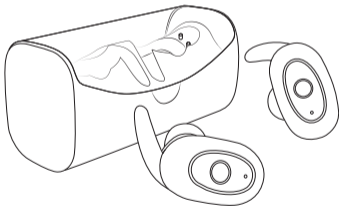

PACKAGE CONTENTS

TWS02

TRUE WIRELESS SPORTS EARPHONES

1



True Wireless Earphones

2



Power bank

3



Eartips (3 pairs)

4



Silicone holder (3 pairs)

5

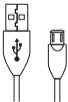

Micro-USB charging cable

6



User manual

PRODUCT OVERVIEW

Top Cover

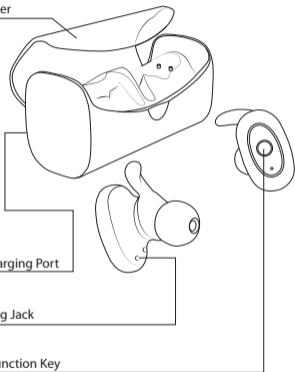

USB Charging Port

Charging Jack

Multi Function Key

TWS02 OPERATION

POWER ON AND PAIRING

1. Power on

Press the both earphones for 2 seconds, till blue light flickers with corresponding tone.

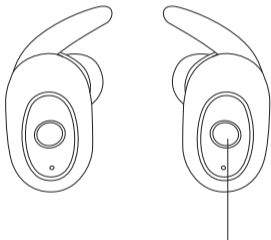

Press 2 seconds

2. Earphones paired each other automatically
One earphone with blue light, the other one with red and blue light flashes. Paired OK.

TWS02 OPERATION

3. Match with Mobile Phone

Switch on bluetooth function on mobile phone, search "TWS02" and connect. Enter "0000" if prompts to enter pairing code.

(Note: Each side earphone can be used separately)

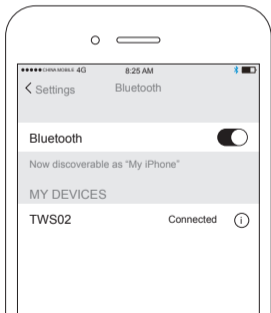

TWS02 OPERATION

SHUT DOWN

Under power-on state, press any side earphone for 3 seconds till red light flickers with corresponding tone. Then both earphones power off together.

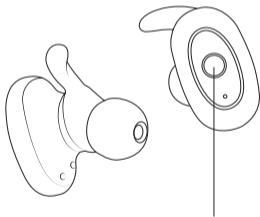

Press 3 seconds

TWS02 OPERATION

CALLING FUNCTION

(Note: During calling, only the left side bluetooth earphone is valid for calling)

1. Calling: Press the MF button once to answer call, double press to refuse.
2. Redialing: Press the MF button twice to dial latest recording call.
3. End calling: Press the MF button once to end phone call during calling.

PLAY MUSIC

(The left and right earphones have same function)

1. Play music: Press the MF button once after connected with mobile phone
2. Pause music: Press the MF button once during playing

TWS02 OPERATION

CHARGING

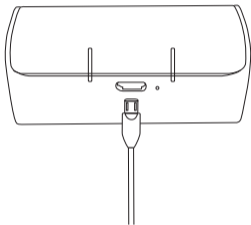

1. After finish to use earphone, put it back to box for charging.
2. During charging, the red light turn on. After full charge, the light turns off.

TWS02 OPERATION

3. Charging time for BT earphone : less than 2 hours.
4. Charging time for power bank: 2 hours.
5. When power bank is full, can charge the BT earphone more than 3 times.

SPECIFICATION

SPECIFICATION

- Chipset: Action
- Version: 4.2
- Frequency range: 2.402-2.48GHz
- Transmission distance: Up to 10m
- Support: A2DP, AVRCP, HSP, HFP
- Frequency response: 20-22kHz
- Music/Talk time: Up to 2 hrs
- Charge time: 2 hours for BT earphone and 3 hours for power bank
- Battery capacity: 40mAh / side
- Capacity for power bank: 320mAh
- Standby time: Up to 180hrs
- Operating temperature: -10°C -50°C

FCC Statement

This equipment has been tested and found to comply with the limits for a Class B digital device, pursuant to part 15 of the FCC rules. These limits are designed to provide reasonable protection against harmful interference in a residential installation. This equipment generates, uses and can radiate radio frequency energy and, if not installed and used in accordance with the instructions, may cause harmful interference to radio communications. However, there is no guarantee that interference will not occur in a particular installation. If this equipment does cause harmful interference to radio or television reception, which can be determined by turning the equipment off and on, the user is encouraged to try to correct the interference by one or more of the following measures:

- Reorient or relocate the receiving antenna.
- Increase the separation between the equipment and receiver.
- Connect the equipment into an outlet on a circuit different from that to which the receiver is connected.
- Consult the dealer or an experienced radio/TV technician for help.

To assure continued compliance, any changes or modifications not expressly approved by the party.

Responsible for compliance could void the user's authority to operate this equipment. (Example- use only shielded interface cables when connecting to computer or peripheral devices).

This equipment complies with Part 15 of the FCC Rules. Operation is subject to the following two conditions:

- (1) This device may not cause harmful interference, and
- (2) This device must accept any interference received, including interference that may cause undesired operation.

RF warning statement:

The device has been evaluated to meet general RF exposure requirement. The device can be used in portable exposure condition without restriction.