

WiFi Smart Devices Manual



Works with Alexa

Simplified steps to install App on your smart device and pair with Amazon Alexa using Brightfun App on App Store /Android Market and Alexa Home skills menu

Ver: FK170701_Alexa

1

2

Download and install the (Brightfun) App for either iOS or Android devices.



Once downloaded, the app will ask you to register your device. Enter your phone number or email which makes you feel comfortable and select the country you live in. If phone number selected you will receive a text with a registration code. If you choose email you will then create a password.



Input the Registration Code you received via text if phone method has been used or create password if email method chosen.

3

4

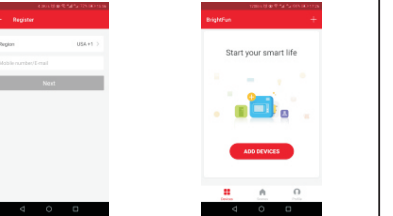

Adding a New Device
 * Turn on power of device being paired and make sure light is flashing quickly.
 * Open App and Click "+" to add appropriate device.
 * Select WiFi network and input password of WiFi then.
 * Once connected the App will prompt the connection, then you can rename the device or just click "done".

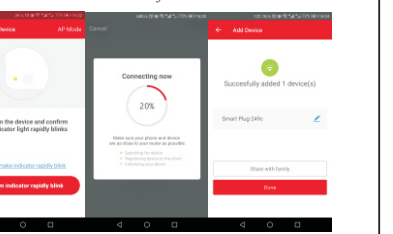

Once App is installed on your device and you have added your smart device to your app you will be able to control it.

5

6

Next step is to sync with Alexa or echo:
 1. Go to Home menu on Alexa App
 2. Select "Skills" in home menu of Amazon Alexa

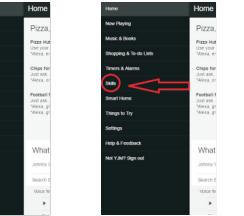

3. Type (Smart Life) on search window and find

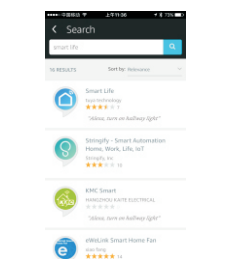

7

8

4. Click on the App (Smart Life) and press Enable to activate "smart life".

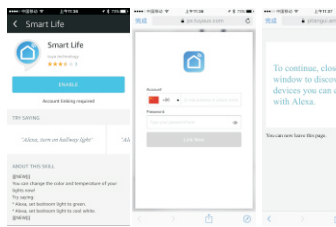

5. Then you need to input your account and password that you registered in (Brightfun) App. Now you finish the Alexa Link.

6. Your (Brightfun) App has been skilled with Alexa, and now you can control any device added to your (Brightfun) App, remember that if you rename the device you added, it must be a simple name that Alexa can recognize.

9

10

7. Control your smart devices through Alexa
 Now you can control your smart devices through Alexa. Take bedroom light as the example, the supported voice commands are as below:

"Alexa, turn off bedroom light"
 "Alexa, turn on bedroom light"
 "Alexa, dim bedroom light"
 "Alexa, set bedroom light to red"

Q & A

Why failed to add device?

1. Please check whether device is powered on;
2. Whether phone is connected via Wi-Fi;
3. Whether device is ready for configuration. To get the device ready before configuration, normally you can manually press on the device to get it ready. Please refer to "Product Instructions" or Device Reset Instruction for details.
 Notice Each time to add device, reset Wi-Fi to get device ready for configuration and make sure router is working properly.
4. Check routers or related: If router is dual-band router, select 2.4G network and add device. You also need to enable router's broadcasting function.
 Set up wireless router: Set encryption method as WPA2-PSK and authorization type as AES, or set both as auto. Wireless mode cannot be 11n only.

11

12

Don't use Chinese to name router Wi-Fi. To stay strong Wi-Fi signal, please keep device and router within certain distance.
 Whether connected devices have reached the maximum number of router's connections. If so, please try by turning off the Wi-Fi connection of some device.
 Router's wireless MAC filtering function is enabled. Remove the device from the filter list and make sure that router is not prohibiting device from connection.

5. Make sure the password entered in App is correct when adding new device

How to reset device?

1. Reset heater, oil heater etc. Long press reset button for 5 seconds until indicator light flashes, representing successful reset;
 Indicator light quickly flashes (2 times per second), representing quick connect mode;
 Indicator light slowly flashes (one time per 3 seconds), representing AP mode;
 Under EZ mode, long press reset button for 5 seconds until indicator light slowly flashes, representing switching to AP mode and vice versa.
2. Reset smart light: Turn off light first. Switch light with the steps: Switch on-off-on-off-on (time interval cannot exceed 10 seconds), flashing lights represents successful reset; if no light flashes, please repeat the steps above;
 Quick light flashes (4 times per second), represent EZ mode; Slow light flashes (2 times per 3 seconds) represent AP mode;
 Under EZ mode, turn off lights and then switch light with the steps:

Switch on-off-on-off-on (time interval cannot exceed 10 seconds). Light begins to slowly flash, representing that it has switched to AP mode and vice versa.

How to add device under EZ mode?
 1. Make sure that indicator light or light quickly flash;
 2. Phone has connected to Wi-Fi router and been able to connect to Internet;
 3. Tap "Add device" in app and enter correct Wi-Fi password. Touch to search device around;
 4. In the device list, select and add the device.

13

14

How to add device under AP mode?
 1. Make sure that indicator light quickly flashes or light slowly flashes;
 2. Tap "Add device" in App and then "AP mode" in the top right corner. Connect to device hotspot first and then Wi-Fi.
 3. Tap "Next" to add device.

Can I control device with 2G/3G/4G network?
 When adding device for the first time, it requires that device and phone need to be under the same Wi-Fi environment. After successfully adding device, you can remote control device with 2G/3G/4G network

How can I share my device with family?
 Open App, go to "Profile" > "Device Sharing" > "Sharings Sent", tap "Add Sharing", then you can share the device with the added family members.

How can I manage the devices shared by others?
 Open App, go to "Profile" > "Device Sharing" > "Sharings Received", then you can find the devices shared by other users. It also allows to add remarks to users or delete certain sharings by long pressing or swiping left.

Quick Guide of Using Google Home to Control Smart Devices

1. What you need to get started
 Before using Google Home to control your devices, make sure you meet the following conditions.
 ✓ A Google Home device, or Android phone with Google Assistant.
 ✓ Latest Google Home app.
 ✓ Latest Google app (Android only)
 ✓ A Google account.
 ✓ The device display language must be set to English US.
 ✓ brightfun app and a related account.
 ✓ Smart devices.

Add devices in (Brightfun) app (Refer to App Instruction)
 You can skip this part if you've already add some devices to your (Brightfun) account, and in the meantime the devices' name are easily recognized.

1. Download (Brightfun) app (Refer to App Instruction)
 You can scan the QR code below to download the (Brightfun) app.

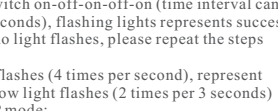

You can also search (Brightfun) in either App Store or Google Play to install the app.

2. Register a (Brightfun) account and sign in the app (Refer to App Instruction)
 Open the (Brightfun) app, tap "Register" to register an account, then sign in the app.

3. Add device and change device's name (Refer to App Instruction)
 Sign in with the (Brightfun) account, add the device, then change device name to a easily recognized word or phrase, like "bedroom light".

Link account in Home Control
 1. Tap "Home Control" in the hamburger menu on the Google Home app's home page, then tap "+".

Control your smart devices through Google Home
 Now you can control your smart devices through Google Home. Take bedroom light as the example, the supported voice commands are as below:

- ✓ Ok Google, turn on/off bedroom light.
- ✓ Ok Google, set bedroom light to 50 percent.
- ✓ Ok Google, brighten bedroom light.
- ✓ Ok Google, dim bedroom light.
- ✓ Ok Google, set bedroom light to red.

Control your smart devices through Google Home
 Now you can control your smart devices through Google Home. Take bedroom light as the example, the supported voice commands are as below:

- ✓ Ok Google, turn on/off bedroom light.
- ✓ Ok Google, set bedroom light to 50 percent.
- ✓ Ok Google, brighten bedroom light.
- ✓ Ok Google, dim bedroom light.
- ✓ Ok Google, set bedroom light to red.

Control your smart devices through Google Home
 Now you can control your smart devices through Google Home. Take bedroom light as the example, the supported voice commands are as below:

- ✓ Ok Google, turn on/off bedroom light.
- ✓ Ok Google, set bedroom light to 50 percent.
- ✓ Ok Google, brighten bedroom light.
- ✓ Ok Google, dim bedroom light.
- ✓ Ok Google, set bedroom light to red.

Control your smart devices through Google Home
 Now you can control your smart devices through Google Home. Take bedroom light as the example, the supported voice commands are as below:

- ✓ Ok Google, turn on/off bedroom light.
- ✓ Ok Google, set bedroom light to 50 percent.
- ✓ Ok Google, brighten bedroom light.
- ✓ Ok Google, dim bedroom light.
- ✓ Ok Google, set bedroom light to red.

Control your smart devices through Google Home
 Now you can control your smart devices through Google Home. Take bedroom light as the example, the supported voice commands are as below:

- ✓ Ok Google, turn on/off bedroom light.
- ✓ Ok Google, set bedroom light to 50 percent.
- ✓ Ok Google, brighten bedroom light.
- ✓ Ok Google, dim bedroom light.
- ✓ Ok Google, set bedroom light to red.

Control your smart devices through Google Home
 Now you can control your smart devices through Google Home. Take bedroom light as the example, the supported voice commands are as below:

- ✓ Ok Google, turn on/off bedroom light.
- ✓ Ok Google, set bedroom light to 50 percent.
- ✓ Ok Google, brighten bedroom light.
- ✓ Ok Google, dim bedroom light.
- ✓ Ok Google, set bedroom light to red.

Control your smart devices through Google Home
 Now you can control your smart devices through Google Home. Take bedroom light as the example, the supported voice commands are as below:

- ✓ Ok Google, turn on/off bedroom light.
- ✓ Ok Google, set bedroom light to 50 percent.
- ✓ Ok Google, brighten bedroom light.
- ✓ Ok Google, dim bedroom light.
- ✓ Ok Google, set bedroom light to red.

Control your smart devices through Google Home
 Now you can control your smart devices through Google Home. Take bedroom light as the example, the supported voice commands are as below:

- ✓ Ok Google, turn on/off bedroom light.
- ✓ Ok Google, set bedroom light to 50 percent.
- ✓ Ok Google, brighten bedroom light.
- ✓ Ok Google, dim bedroom light.
- ✓ Ok Google, set bedroom light to red.

Control your smart devices through Google Home
 Now you can control your smart devices through Google Home. Take bedroom light as the example, the supported voice commands are as below:

- ✓ Ok Google, turn on/off bedroom light.
- ✓ Ok Google, set bedroom light to 50 percent.
- ✓ Ok Google, brighten bedroom light.
- ✓ Ok Google, dim bedroom light.
- ✓ Ok Google, set bedroom light to red.

Control your smart devices through Google Home
 Now you can control your smart devices through Google Home. Take bedroom light as the example, the supported voice commands are as below:

- ✓ Ok Google, turn on/off bedroom light.
- ✓ Ok Google, set bedroom light to 50 percent.
- ✓ Ok Google, brighten bedroom light.
- ✓ Ok Google, dim bedroom light.
- ✓ Ok Google, set bedroom light to red.

Control your smart devices through Google Home
 Now you can control your smart devices through Google Home. Take bedroom light as the example, the supported voice commands are as below:

- ✓ Ok Google, turn on/off bedroom light.
- ✓ Ok Google, set bedroom light to 50 percent.
- ✓ Ok Google, brighten bedroom light.
- ✓ Ok Google, dim bedroom light.
- ✓ Ok Google, set bedroom light to red.

Control your smart devices through Google Home
 Now you can control your smart devices through Google Home. Take bedroom light as the example, the supported voice commands are as below:

- ✓ Ok Google, turn on/off bedroom light.
- ✓ Ok Google, set bedroom light to 50 percent.
- ✓ Ok Google, brighten bedroom light.
- ✓ Ok Google, dim bedroom light.
- ✓ Ok Google, set bedroom light to red.

Control your smart devices through Google Home
 Now you can control your smart devices through Google Home. Take bedroom light as the example, the supported voice commands are as below:

- ✓ Ok Google, turn on/off bedroom light.
- ✓ Ok Google, set bedroom light to 50 percent.
- ✓ Ok Google, brighten bedroom light.
- ✓ Ok Google, dim bedroom light.
- ✓ Ok Google, set bedroom light to red.

Control your smart devices through Google Home
 Now you can control your smart devices through Google Home. Take bedroom light as the example, the supported voice commands are as below:

- ✓ Ok Google, turn on/off bedroom light.
- ✓ Ok Google, set bedroom light to 50 percent.
- ✓ Ok Google, brighten bedroom light.
- ✓ Ok Google, dim bedroom light.
- ✓ Ok Google, set bedroom light to red.

Control your smart devices through Google Home
 Now you can control your smart devices through Google Home. Take bedroom light as the example, the supported voice commands are as below:

- ✓ Ok Google, turn on/off bedroom light.
- ✓ Ok Google, set bedroom light to 50 percent.
- ✓ Ok Google, brighten bedroom light.
- ✓ Ok Google, dim bedroom light.
- ✓ Ok Google, set bedroom light to red.

Control your smart devices through Google Home
 Now you can control your smart devices through Google Home. Take bedroom light as the example, the supported voice commands are as below:

- ✓ Ok Google, turn on/off bedroom light.
- ✓ Ok Google, set bedroom light to 50 percent.
- ✓ Ok Google, brighten bedroom light.
- ✓ Ok Google, dim bedroom light.
- ✓ Ok Google, set bedroom light to red.

Control your smart devices through Google Home
 Now you can control your smart devices through Google Home. Take bedroom light as the example, the supported voice commands are as below:

- ✓ Ok Google, turn on/off bedroom light.
- ✓ Ok Google, set bedroom light to 50 percent.
- ✓ Ok Google, brighten bedroom light.
- ✓ Ok Google, dim bedroom light.
- ✓ Ok Google, set bedroom light to red.

Control your smart devices through Google Home
 Now you can control your smart devices through Google Home. Take bedroom light as the example, the supported voice commands are as below:

- ✓ Ok Google, turn on/off bedroom light.
- ✓ Ok Google, set bedroom light to 50 percent.
- ✓ Ok Google, brighten bedroom light.
- ✓ Ok Google, dim bedroom light.
- ✓ Ok Google, set bedroom light to red.

Control your smart devices through Google Home
 Now you can control your smart devices through Google Home. Take bedroom light as the example, the supported voice commands are as below:

- ✓ Ok Google, turn on/off bedroom light.
- ✓ Ok Google, set bedroom light to 50 percent.
- ✓ Ok Google, brighten bedroom light.
- ✓ Ok Google, dim bedroom light.
- ✓ Ok Google, set bedroom light to red.

Control your smart devices through Google Home
 Now you can control your smart devices through Google Home. Take bedroom light as the example, the supported voice commands are as below:

- ✓ Ok Google, turn on/off bedroom light.
- ✓ Ok Google, set bedroom light to 50 percent.
- ✓ Ok Google, brighten bedroom light.
- ✓ Ok Google, dim bedroom light.
- ✓ Ok Google, set bedroom light to red.

Control your smart devices through Google Home
 Now you can control your smart devices through Google Home. Take bedroom light as the example, the supported voice commands are as below:

- ✓ Ok Google, turn on/off bedroom light.
- ✓ Ok Google, set bedroom light to 50 percent.
- ✓ Ok Google, brighten bedroom light.
- ✓ Ok Google, dim bedroom light.
- ✓ Ok Google, set bedroom light to red.

Control your smart devices through Google Home
 Now you can control your smart devices through Google Home. Take bedroom light as the example, the supported voice commands are as below:

- ✓ Ok Google, turn on/off bedroom light.
- ✓ Ok Google, set bedroom light to 50 percent.
- ✓ Ok Google, brighten bedroom light.
- ✓ Ok Google, dim bedroom light.
- ✓ Ok Google, set bedroom light to red.

Control your smart devices through Google Home
 Now you can control your smart devices through Google Home. Take bedroom light as the example, the supported voice commands are as below:

- ✓ Ok Google, turn on/off bedroom light.
- ✓ Ok Google, set bedroom light to 50 percent.
- ✓ Ok Google, brighten bedroom light.
- ✓ Ok Google, dim bedroom light.
- ✓ Ok Google, set bedroom light to red.

Control your smart devices through Google Home
 Now you can control your smart devices through Google Home. Take bedroom light as the example, the supported voice commands are as below:

- ✓ Ok Google, turn on/off bedroom light.
- ✓ Ok Google, set bedroom light to 50 percent.
- ✓ Ok Google, brighten bedroom light.
- ✓ Ok Google, dim bedroom light.
- ✓ Ok Google, set bedroom light to red.

Control your smart devices through Google Home
 Now you can control your smart devices through Google Home. Take bedroom light as the example, the supported voice commands are as below:

- ✓ Ok Google, turn on/off bedroom light.
- ✓ Ok Google, set bedroom light to 50 percent.
- ✓ Ok Google, brighten bedroom light.
- ✓ Ok Google, dim bedroom light.
- ✓ Ok Google, set bedroom light to red.

Control your smart devices through Google Home
 Now you can control your smart devices through Google Home. Take bedroom light as the example, the supported voice commands are as below:

- ✓ Ok Google, turn on/off bedroom light.
- ✓ Ok Google, set bedroom light to 50 percent.
- ✓ Ok Google, brighten bedroom light.
- ✓ Ok Google, dim bedroom light.
- ✓ Ok Google, set bedroom light to red.

Control your smart devices through Google Home
 Now you can control your smart devices through Google Home. Take bedroom light as the example, the supported voice commands are as below:

- ✓ Ok Google, turn on/off bedroom light.
- ✓ Ok Google, set bedroom light to 50 percent.
- ✓ Ok Google, brighten bedroom light.
- ✓ Ok Google, dim bedroom light.
- ✓ Ok Google, set bedroom light to red.

Control your smart devices through Google Home
 Now you can control your smart devices through Google Home. Take bedroom light as the example, the supported voice commands are as below:

- ✓ Ok Google, turn on/off bedroom light.
- ✓ Ok Google, set bedroom light to 50 percent.
- ✓ Ok Google, brighten bedroom light.
- ✓ Ok Google, dim bedroom light.
- ✓ Ok Google, set bedroom light to red.

Control your smart devices through Google Home
 Now you can control your smart devices through Google Home. Take bedroom light as the example, the supported voice commands are as below:

- ✓ Ok Google, turn on/off bedroom light.
- ✓ Ok Google, set bedroom light to 50 percent.
- ✓ Ok Google, brighten bedroom light.
- ✓ Ok Google, dim bedroom light.
- ✓ Ok Google, set bedroom light to red.

Control your smart devices through Google Home
 Now you can control your smart devices through Google Home. Take bedroom light as the example, the supported voice commands are as below:

- ✓ Ok Google, turn on/off bedroom light.
- ✓ Ok Google, set bedroom light to 50 percent.
- ✓ Ok Google, brighten bedroom light.
- ✓ Ok Google, dim bedroom light.
- ✓ Ok Google, set bedroom light to red.

Control your smart devices through Google Home
 Now you can control your smart devices through Google Home. Take bedroom light as the example, the supported voice commands are as below:

- ✓ Ok Google, turn on/off bedroom light.
- ✓ Ok Google, set bedroom light to 50 percent.
- ✓ Ok Google, brighten bedroom light.
- ✓ Ok Google, dim bedroom light.
- ✓ Ok Google, set bedroom light to red.

Control your smart devices through Google Home
 Now you can control your smart devices through Google Home. Take bedroom light as the example, the supported voice commands are as below:

- ✓ Ok Google, turn on/off bedroom light.
- ✓ Ok Google, set bedroom light to 50 percent.
- ✓ Ok Google, brighten bedroom light.
- ✓ Ok Google, dim bedroom light.
- ✓ Ok Google, set bedroom light to red.

Control your smart devices through Google Home
 Now you can control your smart devices through Google Home. Take bedroom light as the example, the supported voice commands are as below:

- ✓ Ok Google, turn on/off bedroom light.
- ✓ Ok Google, set bedroom light to 50 percent.
- ✓ Ok Google, brighten bedroom light.
- ✓ Ok Google, dim bedroom light.
- ✓ Ok Google, set bedroom light to red.

Control your smart devices through Google Home
 Now you can control your smart devices through Google Home. Take bedroom light as the example, the supported voice commands are as below:

- ✓ Ok Google, turn on/off bedroom light.
- ✓ Ok Google, set bedroom light to 50 percent.
- ✓ Ok Google, brighten bedroom light.
- ✓ Ok Google, dim bedroom light.
- ✓ Ok Google, set bedroom light to red.

Control your smart devices through Google Home
 Now you can control your smart devices through Google Home. Take bedroom light as the example, the supported voice commands are as below:

- ✓ Ok Google, turn on/off bedroom light.
- ✓ Ok Google, set bedroom light to 50 percent.
- ✓ Ok Google, brighten bedroom light.
- ✓ Ok Google, dim bedroom light.
- ✓ Ok Google, set bedroom light to red.

Control your smart devices through Google Home
 Now you can control your smart devices through Google Home. Take bedroom light as the example, the supported voice commands are as below:

- ✓ Ok Google, turn on/off bedroom light.
- ✓ Ok Google, set bedroom light to 50 percent.
- ✓ Ok Google, brighten bedroom light.
- ✓ Ok Google, dim bedroom light.
- ✓ Ok Google, set bedroom light to red.

Control your smart devices through Google Home
 Now you can control your smart devices through Google Home. Take bedroom light as the example, the supported voice commands are as below:

- ✓ Ok Google, turn on/off bedroom light.
- ✓ Ok Google, set bedroom light to 50 percent.
- ✓ Ok Google, brighten bedroom light.
- ✓ Ok Google, dim bedroom light.
- ✓ Ok Google, set bedroom light to red.

Control your smart devices through Google Home
 Now you can control your smart devices through Google Home. Take bedroom light as the example, the supported voice commands are as below:

- ✓ Ok Google, turn on/off bedroom light.
- ✓ Ok Google, set bedroom light to 50 percent.
- ✓ Ok Google, brighten bedroom light.
- ✓ Ok Google, dim bedroom light.
- ✓ Ok Google, set bedroom light to red.

Control your smart devices through Google Home
 Now you can control your smart devices through Google Home. Take bedroom light as the example, the supported voice commands are as below:

- ✓ Ok Google, turn on/off bedroom light.
- ✓ Ok Google, set bedroom light to 50 percent.
- ✓ Ok Google, brighten bedroom light.
- ✓ Ok Google, dim bedroom light.
- ✓ Ok Google, set bedroom light to red.

Control your smart devices through Google Home
 Now you can control your smart devices through Google Home. Take bedroom light as the example, the supported voice commands are as below:

- ✓ Ok Google, turn on/off bedroom light.
- ✓ Ok Google, set bedroom light to 50 percent.
- ✓ Ok Google, brighten bedroom light.
- ✓ Ok Google, dim bedroom light.
- ✓ Ok Google, set bedroom light to red.

Control your smart devices through Google Home
 Now you can control your smart devices through Google Home. Take bedroom light as the example, the supported voice commands are as below:

- ✓ Ok Google, turn on/off bedroom light.
- ✓ Ok Google, set bedroom light to 50 percent.
- ✓ Ok Google, brighten bedroom light.
- ✓ Ok Google, dim bedroom light.
- ✓ Ok Google, set bedroom light to red.

Control your smart devices through Google Home
 Now you can control your smart devices through Google Home. Take bedroom light as the example, the supported voice commands are as below:

- ✓ Ok Google, turn on/off bedroom light.
- ✓ Ok Google, set bedroom light to 50 percent.
- ✓ Ok Google, brighten bedroom light.
- ✓ Ok Google, dim bedroom light.
- ✓ Ok Google, set bedroom light to red.

Control your smart devices through Google Home
 Now you can control your smart devices through Google Home. Take bedroom light as the example, the supported voice commands are as below:

- ✓ Ok Google, turn on/off bedroom light.
- ✓ Ok Google, set bedroom light to 50 percent.

FCC Caution:

This device complies with part 15 of the FCC Rules. Operation is subject to the following two conditions: (1) This device may not cause harmful interference, and (2) this device must accept any interference received, including interference that may cause undesired operation.

Any Changes or modifications not expressly approved by the party responsible for compliance could void the user's authority to operate the equipment.

Note: This equipment has been tested and found to comply with the limits for a Class B digital device, pursuant to part 15 of the FCC Rules. These limits are designed to provide reasonable protection against harmful interference in a residential installation. This equipment generates uses and can radiate radio frequency energy and, if not installed and used in accordance with the instructions, may cause harmful interference to radio communications. However, there is no guarantee that interference will not occur in a particular installation. If this equipment does cause harmful interference to radio or television reception, which can be determined by turning the equipment off and on, the user is encouraged to try to correct the interference by one or more of the following measures:

- Reorient or relocate the receiving antenna.
- Increase the separation between the equipment and receiver.
- Connect the equipment into an outlet on a circuit different from that to which the receiver is connected.
- Consult the dealer or an experienced radio/TV technician for help.

This equipment complies with FCC radiation exposure limits set forth for an uncontrolled environment. This equipment should be installed and operated with minimum distance 20cm between the radiator & your body.