

1. Overview

1.1 Main Functions

- Cat M1 & NB-IOT
- Intelligent power saving
- IP66 waterproof grade
- Tamper alert
- Strong magnet
- Fast charging
- 10000mAh battery
- Voice monitoring

1.2 Specifications

Location accuracy	<10 meters
Monitoring range	≤5 meters
Battery	10000mAh/3.7V industrial grade lithium polymer battery
Standby	>2 years(GSM off, one position per day); >50 days (GPRS always connected, GPS sleep); >120 hours (GPS always on)
LED	1 red LED for GSM; 4 blue LEDs for battery
Operating temperature	-20 ℃— +70 ℃
Dimension	108(L) x 61(W) x 30(H) mm
Weight	285g

2. Appearance

2.1 Appearance

Notch



MIC
GSM
status indicator



2.2 Standard Accessories

Device	1
Bracket	1
User guide	1
Charger	1
Charge cable	1

2.3 LED Indicators

Status	Meaning
Flicker slowly (200ms high/1800ms low)	Network searching
Flicker slowly (1800ms high/200ms low)	Free
Flicker quickly (125ms high/125ms low)	Uploading data
Solid red	Calling

Blue (Battery status)
Shortly press the POWER button to display the battery status.

3. SIM card

SIM card should have access to GPRS and SMS.
Remove the cover, switch to OFF and insert the SIM card.

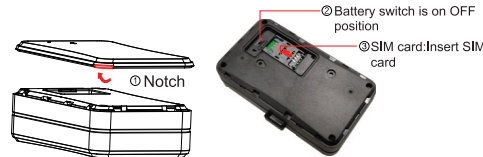

4. Installation

With strong magnet, the device has easy installation and can absorb on any magnetic item. Attached 3M foam tape and bracket help fix the device on non-magnetic items.

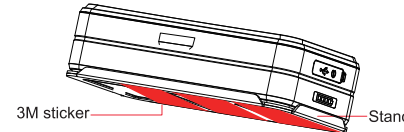

5. Device Installation

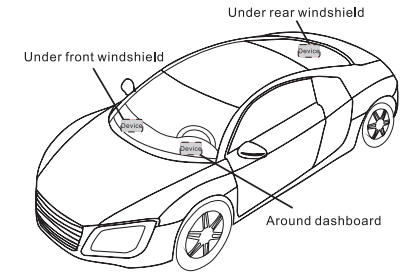

Note :
The device should face up to the sky.
Metal thermal barrier or heating layer of the windshield affects the signal. Please change installation places to receive better signal.

6. Operation

6.1 Power ON/OFF

Power on: Press power button for 3 seconds (battery switch is in ON position)

Power off: Press power button for 3 seconds

Changes or modifications not expressly approved by the party responsible for compliance could void the user's authority to operate the equipment.

This equipment has been tested and found to comply with the limits for a Class B digital device, pursuant to Part 15 of the FCC Rules. These limits are designed to provide reasonable protection against harmful interference in a residential installation. This equipment generates, uses and can radiate radio frequency energy and, if not installed and used in accordance with the instructions, may cause harmful interference to radio communications. However, there is no guarantee that interference will not occur in a particular installation.

If this equipment does cause harmful interference to radio or television reception, which can be determined by turning the equipment off and on, the user is encouraged to try to correct the interference by one or more of the following measures:
 - Reorient or relocate the receiving antenna.
 - Increase the separation between the equipment and receiver.
 - Connect the equipment into an outlet on a circuit different from that to which the receiver is connected.
 - Consult the dealer or an experienced radio/TV technician for help.

This equipment complies with FCC radiation exposure limits set forth for an uncontrolled environment. This equipment should be installed and operated with minimum distance 20cm between the radiator and your body. This transmitter must not be co-located or operating in conjunction with any other antenna or transmitter.

Troubleshooting

If you are having trouble with your device, try these troubleshooting procedures before contacting a service professional.

Problems	Causes	Solutions
Poor signal	The signal waves are unable to transmit when use the GPS tracker in the places that have poor signal reception, such as: tall building around or basement.	Using the GPS tracker in the places that have good signal condition.
Unable to boot	Power switch is off	Switch to ON
	Battery low	charge
	No SIM card	Insert SIM card
Unable to connect to the network	SIM card inserted incorrectly	Check SIM card
	Dirty things exist above the SIM card	Clean SIM card
	Invalid SIM card	Contact network supplier
	Not in GSM service area	Move to service area
Fail to locate	Poor signal	Move to area with strong signal
	SIM has no access to GPRS	Contact network supplier to get GPRS service
	Always reply "Address inquiry failed"	Contact supplier

Warranty instructions and service

1. The warranty is valid only when the warranty card is properly completed, and upon presentation of the proof of purchase consisting of original invoice indicating the date of purchase, model and serial No. of the product. We reserve the right to refuse warranty if this information has been removed or changed after the original purchase of the product from the dealer.

2. Our obligations are limited to repair of the defect or replacement of the defective part or at its discretion replacement of the product itself.
3. Warranty repairs must be carried out by our Authorized Service Centre. Warranty cover will be void, even if a repair has been attempted by any unauthorized service centre.
4. Repair or replacement under the terms of this warranty does not provide right to extension or renewal of the warranty period.
5. The warranty is not applicable to cases other than defects in material, design and workmanship.

Maintenance Record

Date	Serviced by
Product Model	
IMEI Number	
Fault Descriptions	
Comments	

LTE Asset GPS Tracker

User Guide (Version 1.0)



To ensure quickly and correctly use, please read this manual carefully before using. Any changes to the product appearance, color or accessories are without notice.