

**ZFX** TECH

# RF Wireless Headphones Systems



# IN THE BOX



RF Wireless Headphones

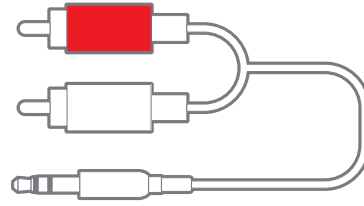

RCA/3.5mm Audio Cable

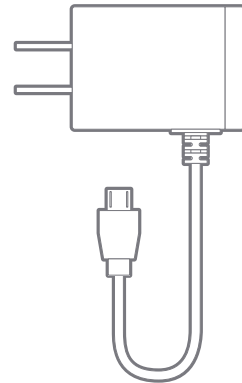

USB Charger

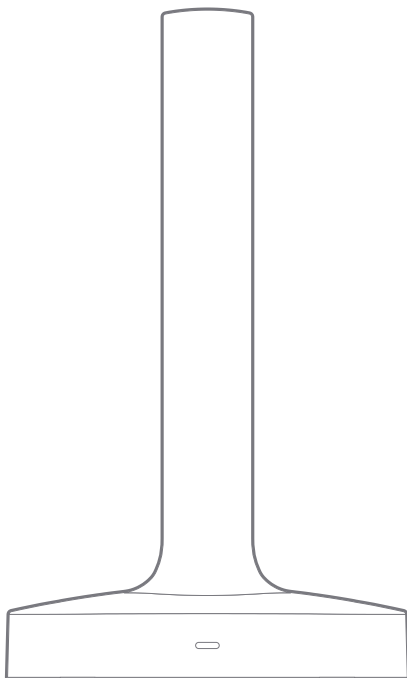

Charging Base

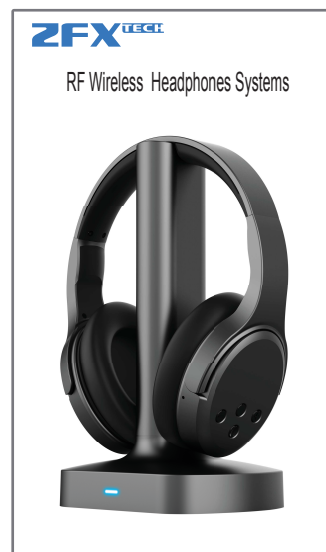

User Guide

# LOCATION OF CONTROLS – HEADPHONES

FRONT



SIDE

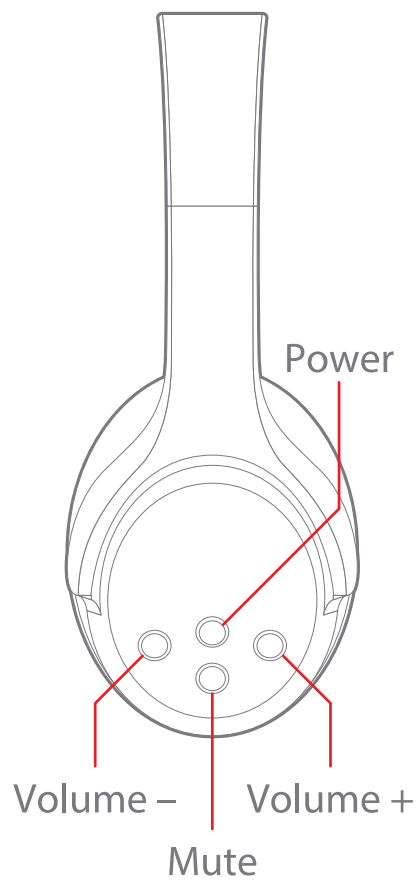

# LOCATION OF CONTROLS – CHARGING BASE

TOP

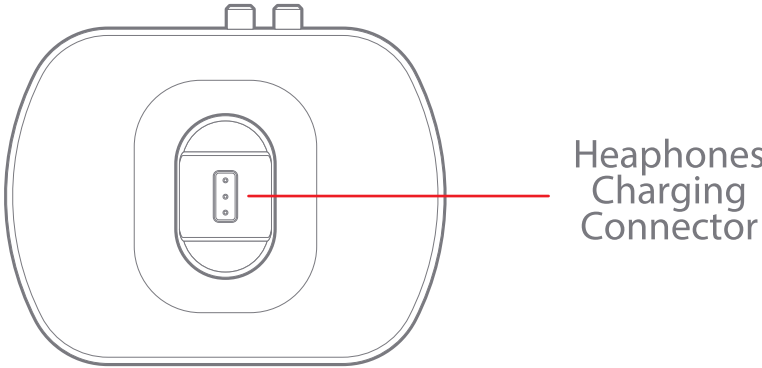

FRONT

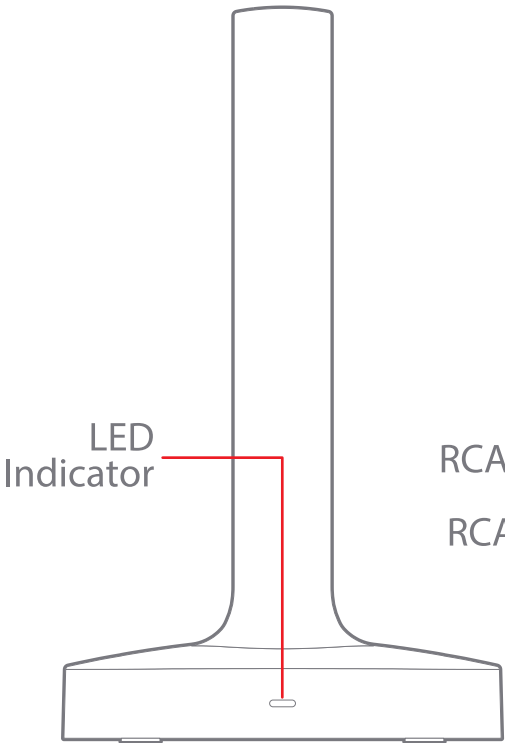

BACK

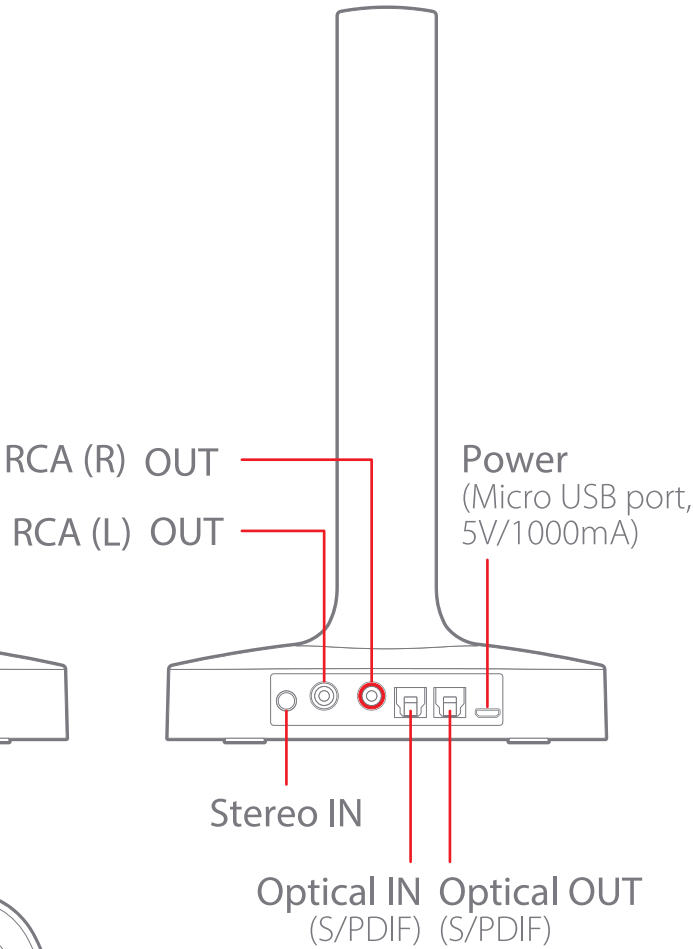

BOTTOM

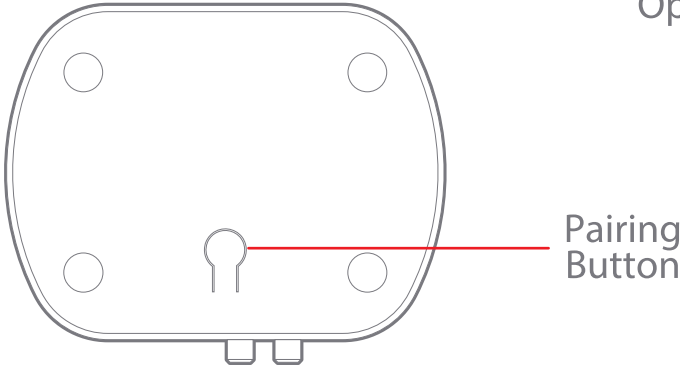

## CHARGING

1. Connect the supplied USB charger to the Charging Base's USB port.

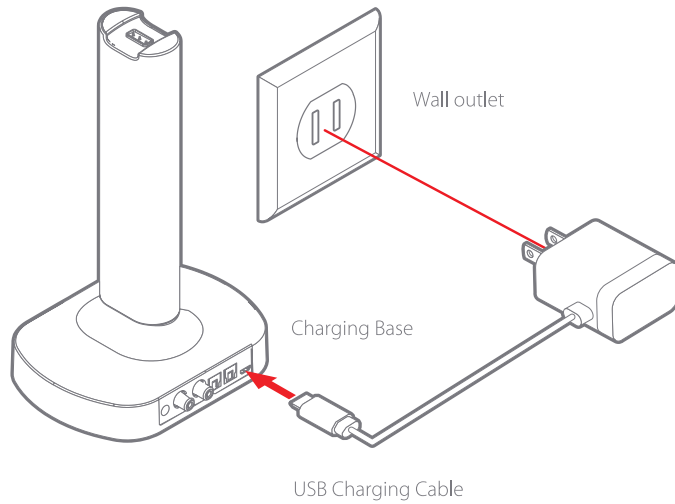

2. Place the headphones on the Charging Base, the headphones and Charging Base LED indicators will light red. Once the headphones are fully charged, both the headphones and the Charging Base's LED indicators will turn off.

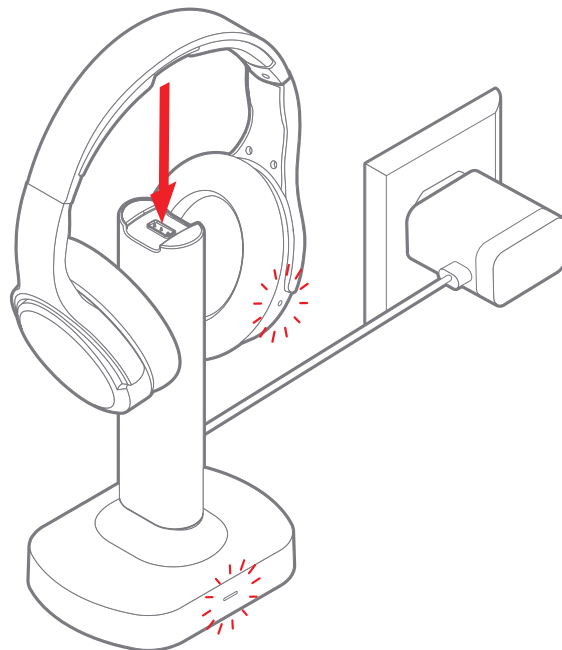

**Note:**

- Loss of sound quality is an indication that your headphones require charging
- The headphones will automatically power off after 5 minutes of inactivity

## CONNECTING THE CHARGING BASE TO A TV

### Using the RCA/3.5mm Audio Cable

1. Connect the white and red plugs of the supplied RCA/3.5mm Audio Cable to the (L) and (R) audio out on your television's connection panel.

**Note:** Ensure the cables are NOT plugged into the TV's audio input.

2. Connect the 3.5mm stereo plug to the Charging Base's Stereo In 3.5mm audio jack as shown below.

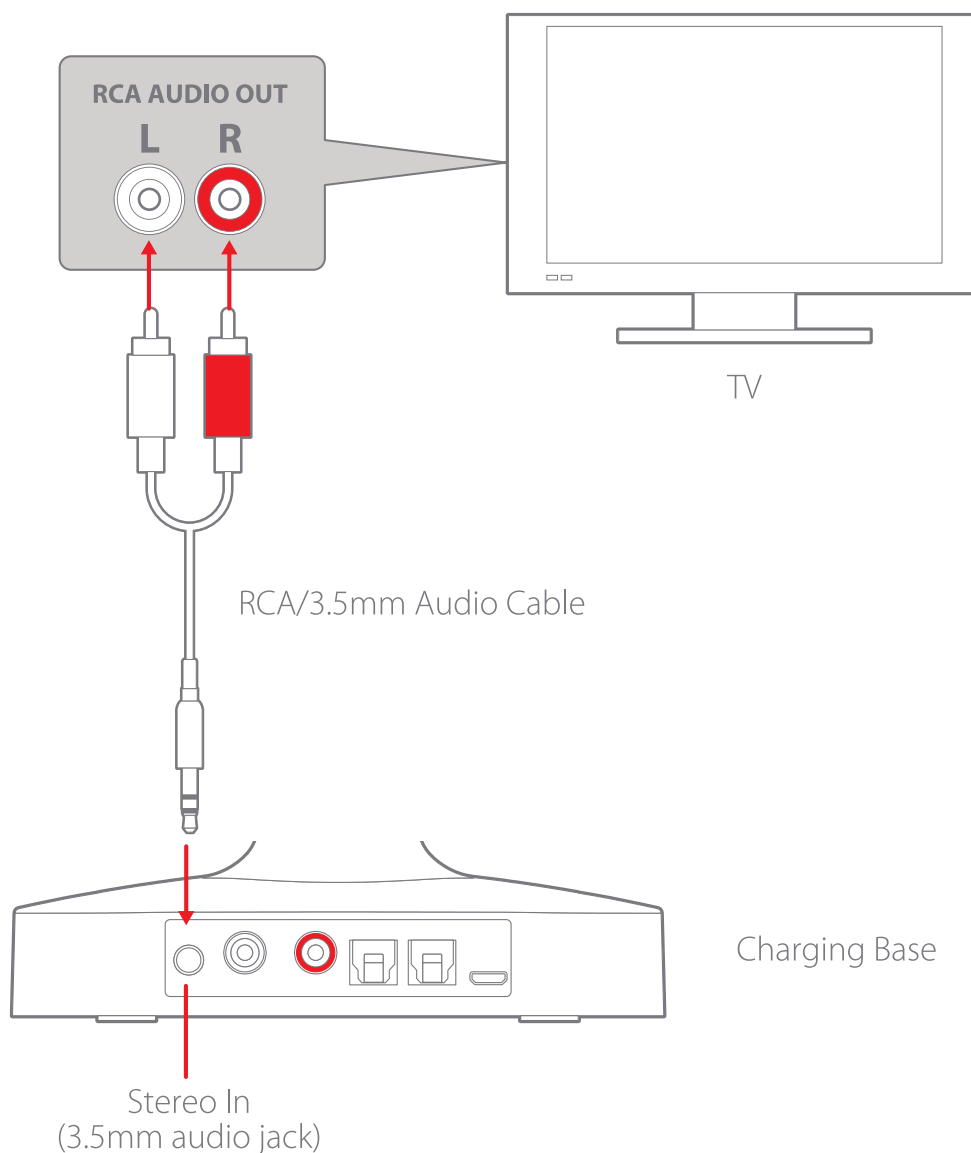

**Note:** You can also use a 3.5mm/3.5mm audio cable (not included) to connect from a TV's 3.5mm output to the Charging Base's 3.5mm stereo input.

## Passthrough

After connecting your TV to the Charging Base's 3.5mm stereo input, you can passthrough the sound to your soundbar or other audio device as shown below.

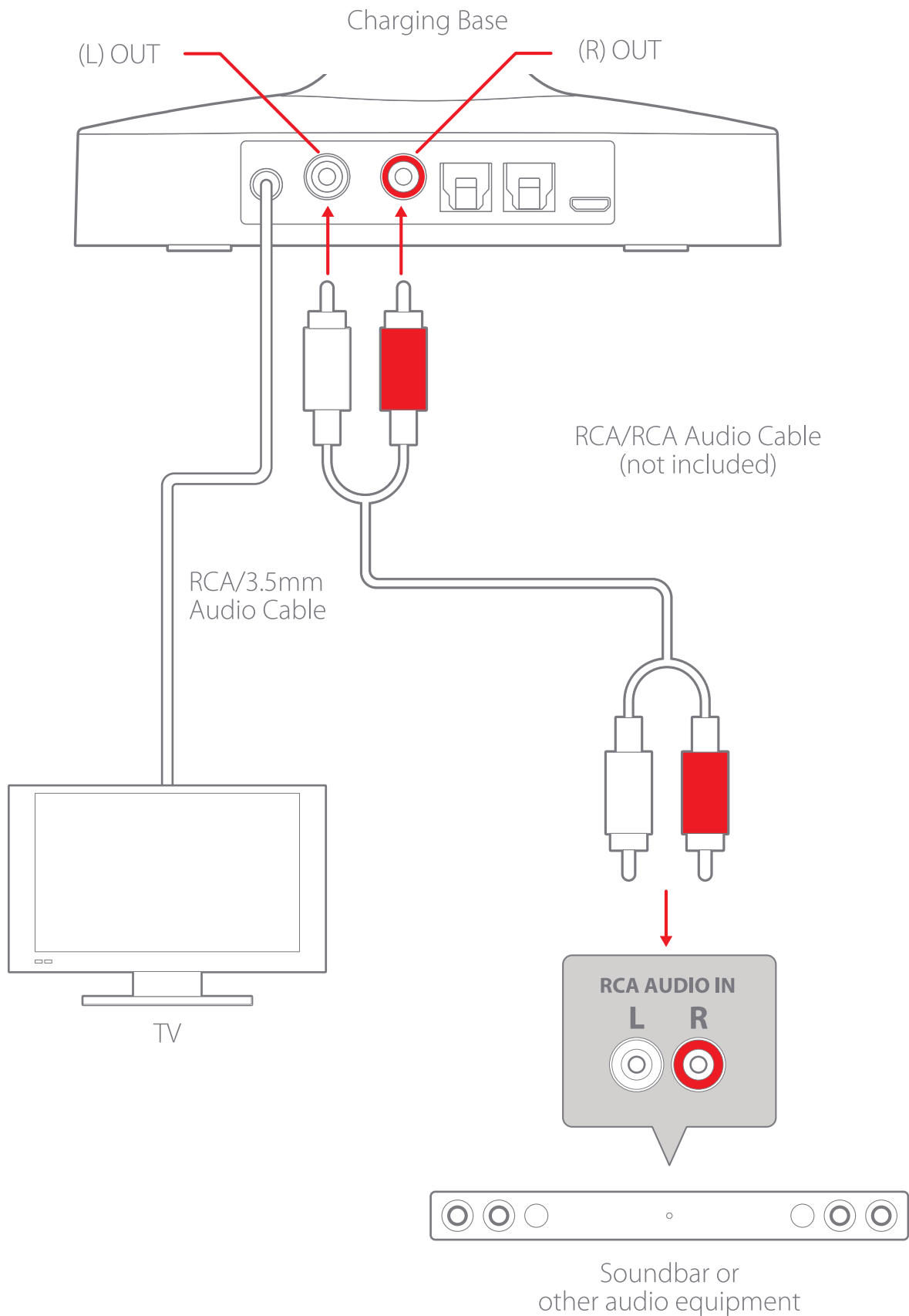

## Using the S/PDIF optical cable for digital audio

For televisions equipped with an S/PDIF optical output, you may connect the included Optical Cable to the TV's connection panel. Connect the other end of the Optical Cable into the Charging Base's "Optical IN" port (supports 96kHz/24bit).

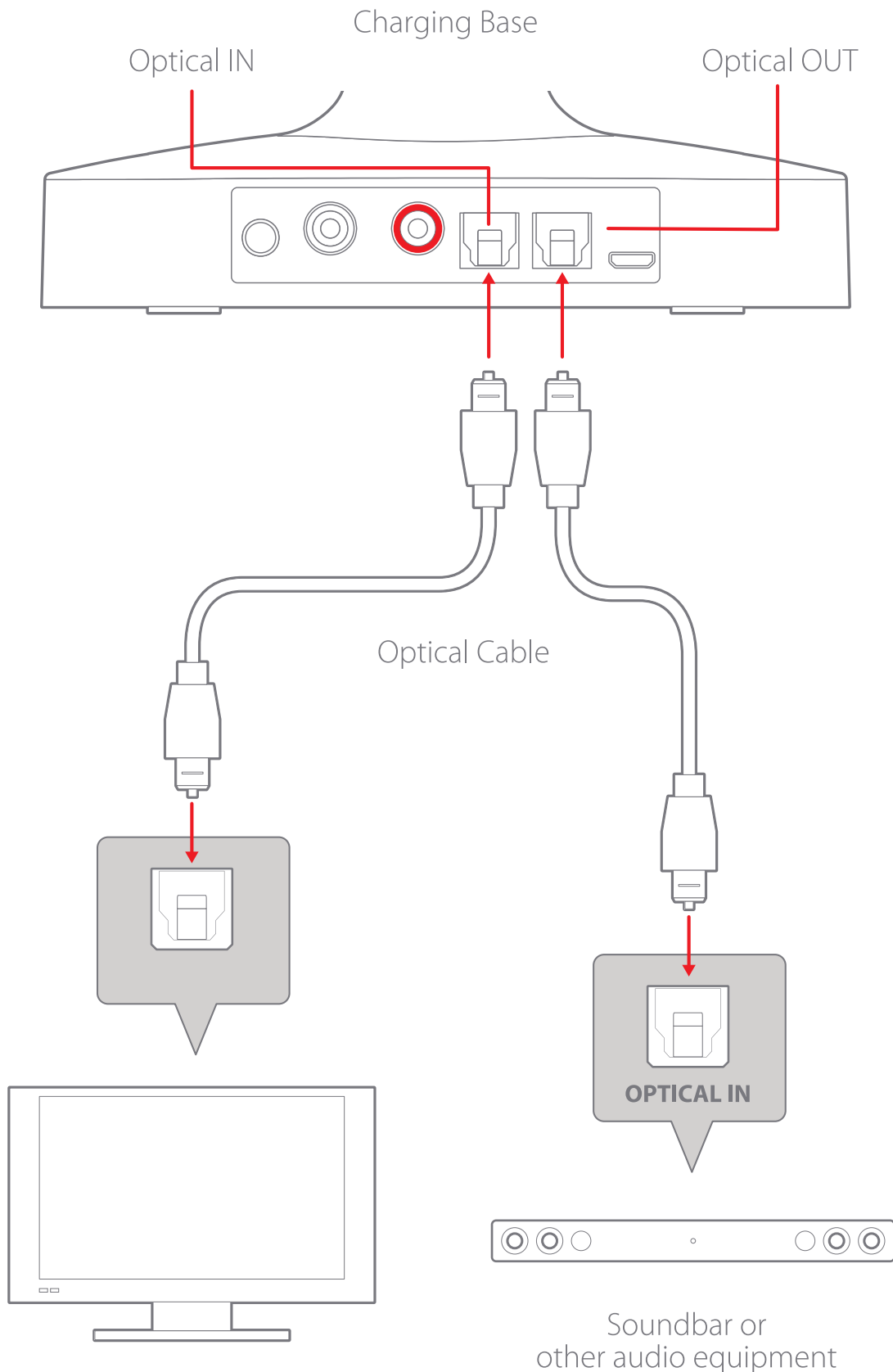



If you have a sound bar or other audio equipment already connected to your television, you can use the Charging Base's audio passthrough connection labeled "Optical OUT" to connect to your other audio equipment.

When an audio source is connected to the Charging Base's "STEREO IN", the optical ports will not function.

**Note:** If you connect the Charging Base to your TV using the Optical Cable and you notice that there is either no sound or no sound on certain content, please follow the steps below.

1. Make sure your home theater or stereo system is set to the appropriate audio output for the optical connection and that the Optical Cable is securely connected to the TV and Charging Base.
2. Go into the "SOUND", or "SPEAKERS" menu of the TV, and select "EXTERNAL SPEAKERS" or "AUDIO SYSTEM".  
*Some TVs require that the internal speakers be turned off before outputting the audio signal to another device.*
3. Set the "DIGITAL AUDIO OUT" setting on the TV to "PCM".

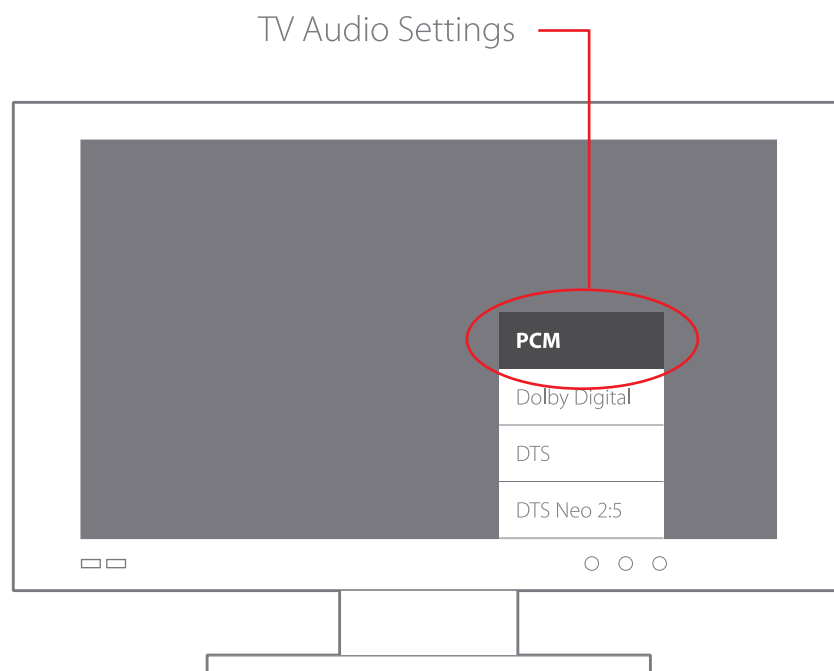

## POWER ON/OFF

### Power On:

Press and **HOLD** the power button (about 2 seconds), until the headphone's LED Indicator turns blue.

### Power Off:

Press and **HOLD** the power button (about 2 seconds), until the headphone's LED Indicator flashes blue and turns off.

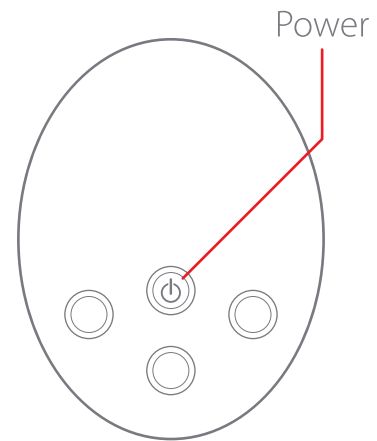

**Note:** If the headphones are powered on and placed on the Charging Base, the headphones will automatically power off.

After powering on the headphones, they will wirelessly connect to the Charging Base (about 5-10 seconds). The Charging Base's LED Indicator will light up solid blue and the headphones will beep three times, its LED Indicator will also flash blue.

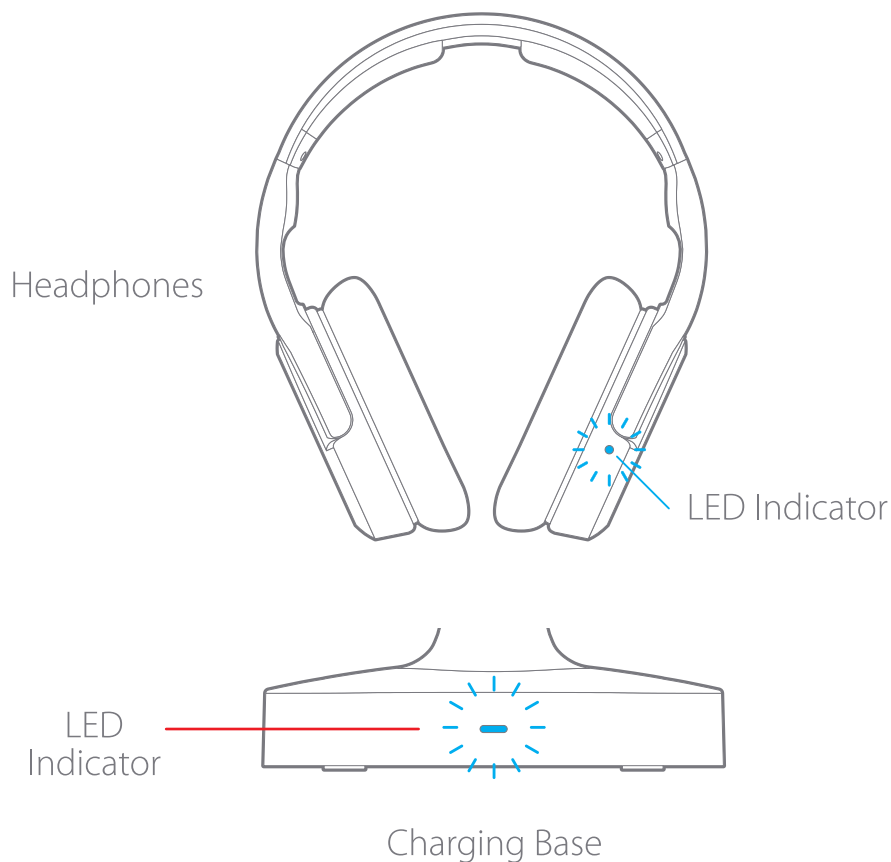

Under ideal conditions, it's possible to achieve a wireless connection of approximately 100 feet\*.

#### FCC Statement

This equipment has been tested and found to comply with the limits for a Class B digital device, pursuant to part 15 of the FCC Rules. These limits are designed to provide reasonable protection against harmful interference in a residential installation. This equipment generates, uses and can radiate radio frequency energy and, if not installed and used in accordance with the instructions, may cause harmful interference to radio communications. However, there is no guarantee that interference will not occur in a particular installation. If this equipment does cause harmful interference to radio or television reception, which can be determined by turning the equipment off and on, the user is encouraged to try to correct the interference by one or more of the following measures:

- Reorient or relocate the receiving antenna.
- Increase the separation between the equipment and receiver.
- Connect the equipment into an outlet on a circuit different from that to which the receiver is connected.
- Consult the dealer or an experienced radio/TV technician for help.

Caution: Any changes or modifications to this device not explicitly approved by manufacturer could void your authority to operate this equipment.

This device complies with part 15 of the FCC Rules. Operation is subject to the following two conditions: (1) This device may not cause harmful interference, and (2) this device must accept any interference received, including interference that may cause undesired operation.