

Front

FCC Information

This device complies with Part 15 of the FCC rules.

Operation is subject to the following two conditions: (1) this device may not cause harmful interference, and (2) this device must accept any interference received, including interference that may cause undesired operation.

Federal Communications Commission (FCC) Statement

This Equipment has been tested and found to comply with the limits for a Class B digital device, pursuant to Part 15 of the FCC rules. These limits are designed to provide reasonable protection against harmful interference in a residential installation. This equipment generates, uses and can radiate radio frequency energy and, if not installed and used in accordance with the instructions, may cause harmful interference to radio communications. However, there is no guarantee that interference will not occur in a particular installation. If this equipment does cause harmful interference to radio or television reception, which can be determined by turning the equipment off and on, the user is encouraged to try to correct the interference by one or more of the following measures:

- Reorient or relocate the receiving antenna.
- Increase the separation between the equipment and receiver.
- Connect the equipment into an outlet on a circuit different from that to which the receiver is connected.
- Consult the dealer or an experienced radio/TV technician for help.

Warning: Changes or modifications to this unit not expressly approved by the party responsible for compliance could void the user authority to operate the equipment.

Tested to comply with FCC standard, FOR HOME OR OFFICE USE.

Warning :

This equipment complies with FCC RF radiation exposure limits set forth for an uncontrolled environment. This device and its antenna(s) must not be co-located or conjunction with any other antenna or transmitter.

FCC ID: 2AML6BB896

Wireless Earbuds

Thank you for choosing a Billboard® Bluetooth™ earbuds. For best use of your new device we recommend carefully reading the user manual and keeping it for your records

Package contains

- a. Wireless earbuds
- b. Soft rubber ear tips
- c. USB charging cable
- d. Extra ear cushions
- e. Instruction manual

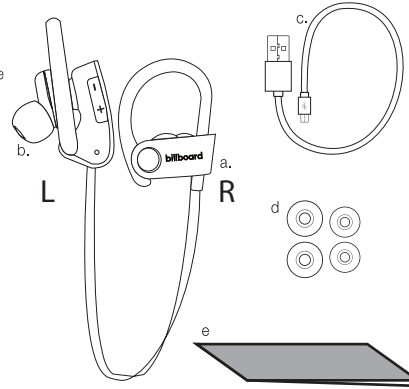

CONTROLS

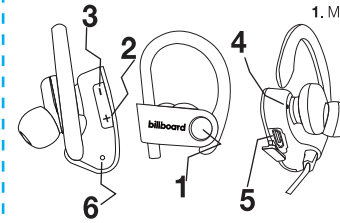

1. Multifunction Button (MFB) Answer, end, reject call, Play, Pause, ON/OFF
2. Next song/Volume up
3. Previous song/Volume down
4. Microphone
5. USB Charging Port
6. Indicator Light

Charging the battery

This device has an internal, rechargeable battery.

1. Connect the charger cable to the charging port on the left side of the earbuds.
2. Then connect the charger cable to a USB power source. The red indicator light will display during charging. If charging does not start, disconnect the charger, plug it in again, and retry. Charging the battery fully may take up to 2 hours.
3. When the battery is fully charged, the red indicator light will turn off. Disconnect the charger from the USB power source and the earbuds. The fully charged battery has power for up to 6 hours of talk-time, 6 hours music time and up to 120 hours of standby time. However, the talk, music and standby times will vary from different devices, settings, and environments.

Pairing the Earbuds with a compatible phone

1. Make sure your earbuds is turned off.
2. Push the MFB key for about 3 seconds until the light flashes blue and red alternately.
3. Activate the Bluetooth® feature on the device, and set the device to search for Bluetooth® devices. The name of the Wireless earbuds is BB-BT-EP. See the user guide of your device for instructions.
4. If the pairing is successful, the earbuds's blue light will flash every 4 seconds.
5. If pass code is requested enter (0000) Once the earbuds has paired with your device, no password will be needed to reconnect. If not paired, the earbuds will turn off automatically after 3 minutes.

Power ON/OFF & Reconnecting

- To switch on**, press and hold the MFB key until the blue indicator light blinks on and off.
- To switch off**, press and hold the MFB key until the red indicator light blinks on and off.
- Adjust volume**, Press and hold the **+** to increase and the **-** to decrease volume.
- Next song**, Momentarily press the **+**
- Previous song**, Momentarily press the **-**
- Pause song**, press the MFB key while music is playing.

Answer a Call

- To answer and end a call** Press the MFB key, or use the phone keys. (music will automatically pause during phone calls)
- To reject a call** Press and hold MFB key, or use the phone keys.
- Redial the last number you called**, press the Multifunction button twice quickly.

Back

BATTERY INFORMATION

Your device is powered by a rechargeable battery. The full performance of a new battery is achieved only after two or three complete charge and discharge cycles. The battery can be charged and discharged hundreds of times, but it will eventually wear out. Recharge your battery only with USB charge ports.

Do not leave a fully charged battery connected to a charger, since overcharging may shorten its lifetime. If left unused, a fully charged battery will lose its charge over time. Never use any charger that is damaged.

Leaving the device in hot or cold places will reduce the capacity and lifetime of the battery. Optimal temperature for the battery is between 15°C and 25°C (59°F and 77°F). A device with a hot or cold battery may not work temporarily, even when the battery is fully charged.

Do not dispose of batteries in a fire as they may explode. Batteries may also explode if damaged. Always dispose of batteries according to local regulations. Please recycle when possible. Never dispose as household waste.

Technical Support: techsupport@esicellular.com or call 212 883-8838
© 2018 Billboard IP Holdings, LLC.

All rights reserved. Billboard®, the Billboard logo, HOT 100 and associated characters, trademarks and design elements are owned and licensed by Billboard IP Holdings, LLC and used under license by ESI Cases & Accessories, 44 East 32nd Street, New York, NY 10016
Bluetooth® is a registered trademark of Bluetooth SIG, Inc.



PLEASE READ THESE INSTRUCTIONS CAREFULLY BEFORE USING YOUR WIRELESS EARBUDS

KEEP THESE INSTRUCTIONS FOR FUTURE REFERENCE

Your Wireless earbuds has an internal rechargeable battery. Improper usage may result in the Wireless earbuds becoming hot, ignite or burst and cause injury if exposed to conditions of abuse. Be sure to follow the safety warnings listed below:

1. Do not disassemble, throw away or damage the Wireless earbuds.
2. Store the Wireless earbuds in a dry place, keeping it away from damp corrosive materials and environments such as salt air.
3. Keep the Wireless earbuds away from direct sunlight, fire and high voltage equipment. Do not store the Wireless earbuds inside a car during hot weather. Remember a closed car acts as a green house allowing the inside temperature to possibly reach over 200F.
4. The Wireless earbuds is not a toy. Please keep it out of the reach of young children.
5. Please do not discard the Wireless earbuds. Consult your local waste collection agency for proper disposal or recycling methods. You may also contact "Call2Recycle" at 877-273-2925 or online at "call2recycle.org" for a battery recycling drop off location near you.



It may damage your hearing if you listen with high volume for a long time. It is recommended you use the lowest volume possible for speaking and listening to music.

LIMITED WARRANTY

ESI Cases and Accessories warrants to the first consumer purchaser that this product, when shipped in its original container to the original purchaser, will be free from defective workmanship and materials for one year and agrees that it will, at its option, either repair the defect or replace the defective product or part thereof at no charge to the purchaser for parts or labor for the time periods described.

This warranty does not apply to any appearance items of the product nor to the additional excluded item(s) set forth below nor to any product the exterior of which has been damaged or defaced which has been subjected to misuse, abnormal service or handling or which has been altered or modified in design or construction. The limited warranty described herein is in addition to an applicable law. ALL IMPLIED WARRANTIES INCLUDING THE WARRANTIES OF MERCHANTABILITY AND FITNESS FOR USE ARE LIMITED TO THE PERIOD FROM THE DATE OF ORIGINAL PURCHASE SET FORTH BELOW. Some states do not allow limitations on how long an implied warranty last, so the above limitation may not apply to you. Neither the sales personnel of the seller nor any other person is authorized to make any warranties other than those described herein or to extend the duration of any warranties beyond the time period described herein on the behalf of ESI Cases and Accessories.

The warranties described herein shall be the sole and exclusive warranties granted by ESI Cases and Accessories and shall be the sole and exclusive remedy available to the purchaser corrections of defects, in the manner and for the period of time described herein, shall constitute complete fulfillment of all liabilities and responsibilities of ESI Cases and Accessories to the purchaser with respect to the product and shall constitute full satisfaction of all claims, whether based on contract negligence, strict liability or otherwise, in no event shall ESI Cases and Accessories be liable or in any way responsible, for any incidental or consequential economic or property damage. Some states do not allow the exclusion of incidental or consequential damages, so the above exclusion may not apply to you. THIS WARRANTY GIVES YOU SPECIFIC LEGAL RIGHTS, YOU MAY ALSO HAVE OTHER RIGHTS, WHICH VARY FROM STATE TO STATE.

Send product with \$11.95 shipping & handling fee to:
ESI Cases and Accessories,
44 East 32nd Street, 6th floor
New York, New York 10016

TECHNICAL SUPPORT: 212 883-8838
E-MAIL: techsupport@esicellular.com

WIRELESS EARBUDS

billboard®



WIRELESS EARBUDS



for use with
Bluetooth® enabled devices