

G69 Smart Watch User Manual



Thank you for choosing our product!

To have a comprehensive understanding and using this device, to know all the features and simple operation method, please read this manual first.

This equipment is mainly matching with smart phone via bluetooth connection .firstly you need todownload the “心护通” APP in your cell phone, and then connect the bluetooth of the watchand the cell phone .once the connection is successful, you can sync the date and time in the phone,also you can sync the data in the watch into the APP in the cell phone. The detail of the bluetoothconnection please refer the below point 4.

Our company reserve the right of modify the content of the manual without prior notice.

1. Functional Buttons

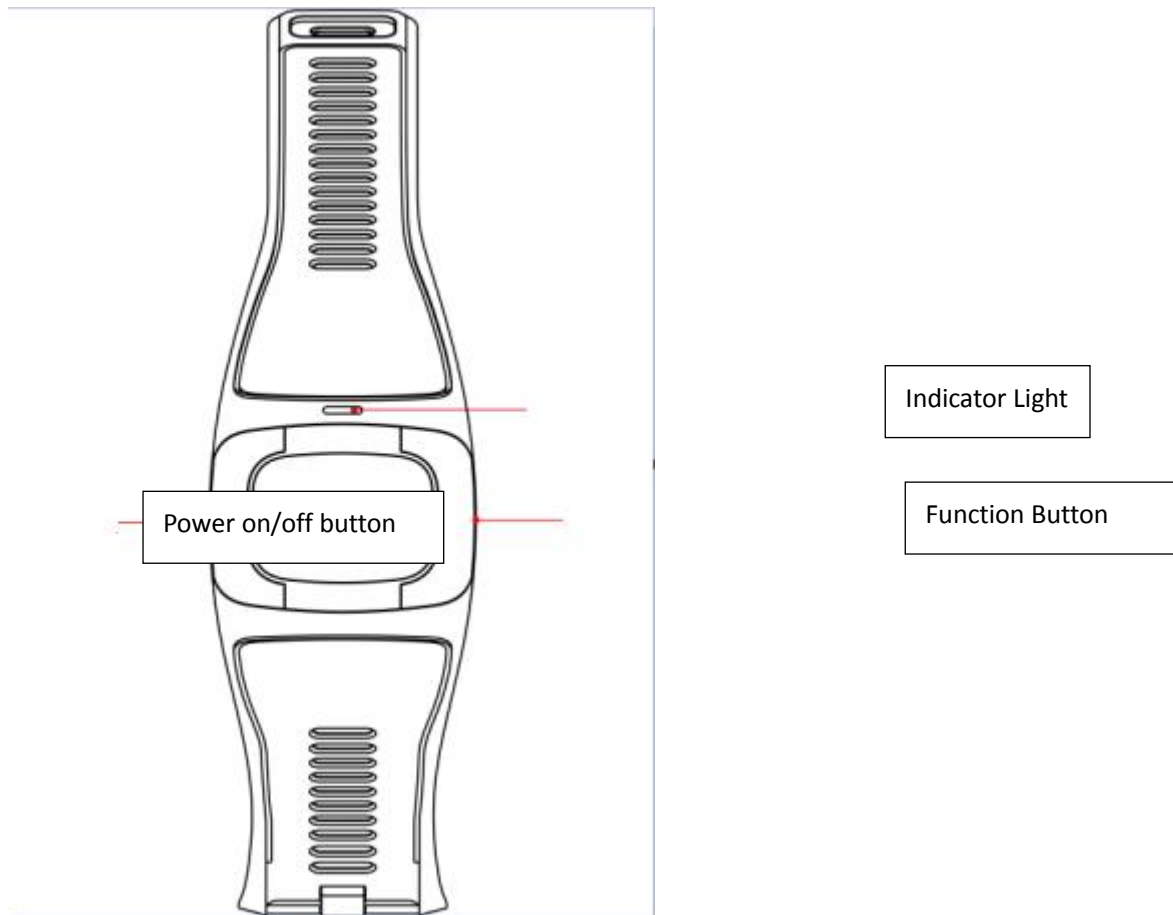

2. Power on/off

Power on: Long Press the power on/off button for 3 seconds

Power off: Long Press the power on/off button for 3 seconds

Press Function Button to Switch Menu

3. Major Functions

1. Heart rate

Enter the smart watch heart rate menu, long press the function button for 3 seconds, you will see a countdown interface, 3, 2, 1, and then it will automatically enter the measurement interface, the watch will automatically measure the heart rate value (when the red light indicates that the measurement has been completed).

2. Pedometer

Press the function button to enter into the Pedometer Menu, wearing the smart watch onto your hand, the watch will automatically count the steps;

3. Blood pressure Monitoring

Firstly, wearing the smart watch onto your hand, press the function button for 3 seconds to enter into the blood pressure measurement interface, the smart watch will showing an countdown interface, after the countdown ended, the smartwatch will automatically measure the blood pressure value. (when the indicate light turns to red, that indicates the measurement has been completed)

4. Connect to Bluetooth

1) turn on the Bluetooth of the smart watch (setting -> open Bluetooth)

2). Turn on the Bluetooth of your smart phone, enter into the Bluetooth notification application APP binding menu

Step 1: Click "+" of your smart phone, the phone will automatically search for the nearby Bluetooth device, find the watch name " G69" and start pairing, after pairing successfully, it will appear on the right corner of your smartphone showing the device has being connected successfully, as shown below:

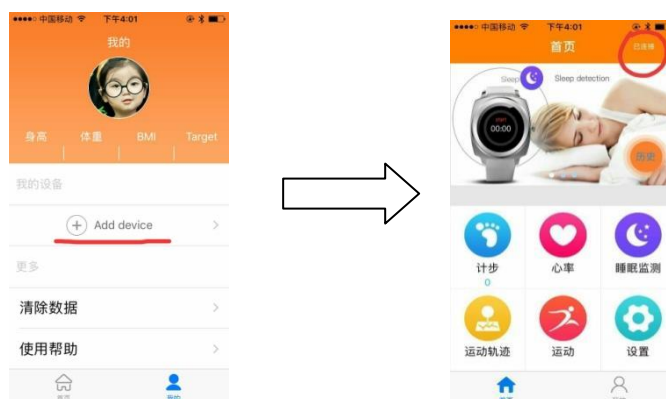

Step two: find the BT connection icon of the smart watch, click "search new device", find the device name of your smart phone to start pairing, once pairing successfully, there will be a notification showing the device has been connected

5. Product Specification Sheet

Basic Information	Dimension	36.2*41*15.8mm
	Weight	48g
	Watchband Type	Silica
HW Configuration	Chipset	MT2523D+MT2511
	Main Frequency	208MHZ
	Display	0.96" OLED
	Resolution	128*64
	Memory	4Mb+4Mb
	Camera	N/A
	2G Band(MHz)	No
	BT	BT2.1+ BLE 4.2
	WIFI	No
	GPS	No
	Battery	200mAh Li-polymer (4.2V)
	Stand-by Time	168Hrs
SW Configuration	OS	FREE RTOS
	Language	English
	Audio Player	MIDI/MP3
	Engineering Mode	Yes
MD Configuration	Button	Power on/off, Function Button
	Speaker	No
	MIC	No
	Camera	No
	Vibrator	Yes
	Watchband Type	Silica
Feature	Dynamic Heart Rate Monitoring	Yes
	ECG Monitoring	Yes
	Blood Pressure Monitoring	Yes
	Sedentary Reminder	Yes
	Sleep Monitoring	Yes
	GPS/WIFI/LBS precise location	No
	Proximity Sensor	No
	Light Sensor	No

	Gravity Sensor	Yes
	Gyro	No
	Compass	No
Connector	RF Test Connector	No
	SIM Card Slot	No
	I/O Port	No
	Audio Jack	No
Accessory	USB Cable	Yes
	Charger	No
	Giftbox	Yes

6. Notifications:

1、Support devices which with Bluetooth 2.1/4.2;

2、Bluetooth Connection:

A) Please make sure the bluetooth of mobile phone and the watch is turned on. If Bluetooth connection icon blinks, the watch's Bluetooth is turned on and is ready. If the icon is always on, Bluetooth connection is OK. If there is no bluetooth icon, bluetooth is turned off.

B)When searching Bluetooth, please make sure the watch has not been bind by another account;

C)When searching Bluetooth, please make sure the watch and mobile phone are nearby.

3、 If the watch is not receiving message notification, please make sure the APP is logged in and message notification function is turned on;

4、 When Bluetooth connection abnormal and unable to enter the APP. Please try to enter into the Application Management of the Mobile phone and clear the cache data of the App.

5、 if watches and cell phone bluetooth connection often disconnected automatically. Please check if the phone is equipped with a software which will clean up the background program and clean up the App by mistake. You need to “lock” the App in the phone ,or unload the firmware to make sure the APP can stable running in the background.

6.If one watch has been bind with one account, it cannot be bind with another account unless it is unbind with the current account;

7. Warranty

1. If it appears quality problems caused by manufacturing, materials, and design within one year (since the day of purchase) , we will offer free warranty. Premise is using normally and correctly.

2. About the fault caused by the user personal reasons, we don't offer free warranty, as follows:

1). Disassemble or refit the product.

2). Caused by immodesty drop

3). All artificial damage or misuse (such as: the external force shatter,scratch damage of peripheral components, etc.), all these are beyond the scope of the warranty.

If you met problems during use, please contact with our customer service

This device complies with Part 15 of the FCC Rules. Operation is subject to the following two conditions:(1) this device may not cause harmful interference, and (2) this device must accept any interference received, including interference that may cause undesired operation.

Changes or modifications not expressly approved by the party responsible for compliance could void the user's authority to operate the equipment.