



INFORTAP-READY

USER MANUAL

Version 2.0

2021

ESL Introduction

Electronic Shelf Label System (ESL) provides product information by replacing series of task which is printing attaching price, and merchandise information in paper to electronic display.

Manual Content

1. InforTab-Ready Preparation

1- 1 InforTab-Ready Composition Check
...p.3

1- 2 Network, UI Setting ...p.4

1- 3 Confirm InforTab Assign ...p.6

2. InforTab Update

2- 1 Confirm InforTap Layout ...p.7

2- 2 Update Product Information ...p.8

2- 3 Confirm InforTap Update Result
...p.9

3. InforTab De-Assign, and Re-Assign

3- 1 InforTab De-Assign ...p.10

3- 2 InforTab Re-Assign ...p.10

Appendix ...p.11

1. InforTab-Ready Preparation

In order to set and monitor InforTab-Ready, Personal computer with network is required.

1-1 InforTab-Ready Composition

Compositions of InforTab-Ready are,

- 1.54 Inch InforTab(R154) 1EA
- 2.13 Inch InforTab(R213) 1EA
- 2.90 Inch InforTab(R290) 1EA
- 4.20 Inch InforTab(R420) 1EA
- 7.50 Inch InforTab(R750) 1EA
- Gateway 1EA, Antenna 4EA
- 5V Power cable 1EA, LAN cable 1EA
- Remote Control 1EA, UnlockTool 1EA



1. InforTab-Ready Preparation

1-2 Network, UI setting

■ PC Network setting

For connecting Gateway and User.

Gateway IP is set by 192.168.220.236 in advance.

Setting a PC network fixed IP is required. For instance, 192.168.220.45 can be set as PC network IP.

To change PC network IP,

Control Panel > Network Internet > Network settings > Ethernet Properties > Internet Protocol version 4(TCP/Pv4) > Use following IP > Confirm

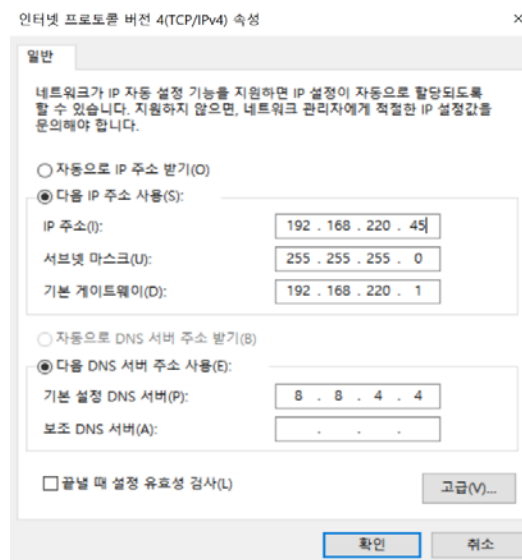

1. InforTab-Ready Preparation

■ Connect InforTap UI

- 1 Plug in Gateway with power cable, and connect to PC by LAN cable. If all of these connected properly, Red, Green, and Blue lights will go on.
- 2 Run internet browser in PC, and write Gateway fixed IP (192.168.220.236) on address bar.
- 3 If connected properly, InforTab UI screen will appear.
- 4 Change Password in Menu 'Account Setting'. Initial ID is 'admin' and password is '1234'.

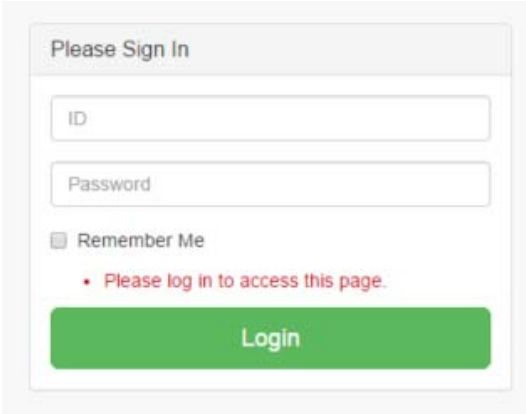

The screenshot displays a web interface for signing in. At the top, it says "Please Sign In". Below this are two input fields: "ID" and "Password". There is a checkbox labeled "Remember Me". A red error message reads "Please log in to access this page." At the bottom is a prominent green button labeled "Login".

1. InforTab-Ready Preparation

1-3 InforTab Assign

InforTab and specific product work together showing the product information. This system is operated by 'Assign' process.

■ Assign confirmatory

InforTab-Ready's 4 InforTabs are already assigned.

Assigned InforTab in Gateway can be verified by

'Status > Tag' in UI.

The screenshot shows the 'Rainus Infortab Admin' interface. On the left is a navigation menu with options like Home, Store, Status, Gateway, Tag, Task, Setting, Product Update, PIC Upgrade, CM Tool, Replication, and Account Setting. The main area displays the 'Tag Status' page with two buttons: 'Tag Assign' and 'De-assign'. Below these is a table with the following data:

	Tag MAC	Store Code	Gateway IP	Operation	Result	Battery	Temperature	RSSI
1	78E980FFFE004DD2	store-1	localhost:8080	UPDATE	ok	32	26	-40
2	78E980FFFE004DD9	store-1	localhost:8080	UPDATE	ok	30	25	-46
3	78E980FFFE004DE4	store-1	localhost:8080	UPDATE	ok	32	25	-37
4	78E980FFFE004DE5	store-1	localhost:8080	UPDATE	ok	30	26	-45
5	78E980FFFE004DE7	store-1	localhost:8080	UPDATE	ok	32	25	-37
6	78E980FFFE004DE9	store-1	localhost:8080	UPDATE	ok	30	25	-40

■ InforTap Mac Address check

InforTab Mac address is displayed as barcode when you press '>' or '<' buttons of remote controller in front of tag.

*Assign: Connect
InforTab and
Product in
Gateway.*

Delete 2 digits and leave 4 digits from the back in order to search Mac address in UI.

*Update: To change
product
information
withAssigned
InforTab*

For further more explanation, if Mac address is '78E980FFFE004C4B', can be searched by '004C'.

*De-Assign:
Disconnect
InforTab and
Product in
Gateway.*

2. InfoTab Update

2-1 Confirm InfoTab Layout

InforTap Layout can be found at 'Product Update' menu.

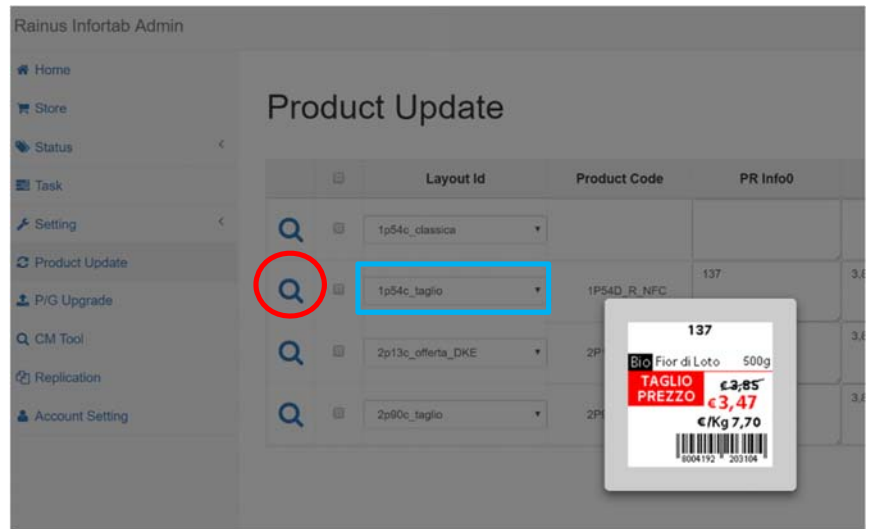

: Layout choice

: Layout look preview

Layout is location of information and design which shows in tag display. It can be adjusted in 'Layout Designer'.

We provide 'Layout Designer Manual' in addition which guides how to use 'Layout Designer'.

2. InfoTab Update

2-2 Product information Update

Product Update window is as below picture.

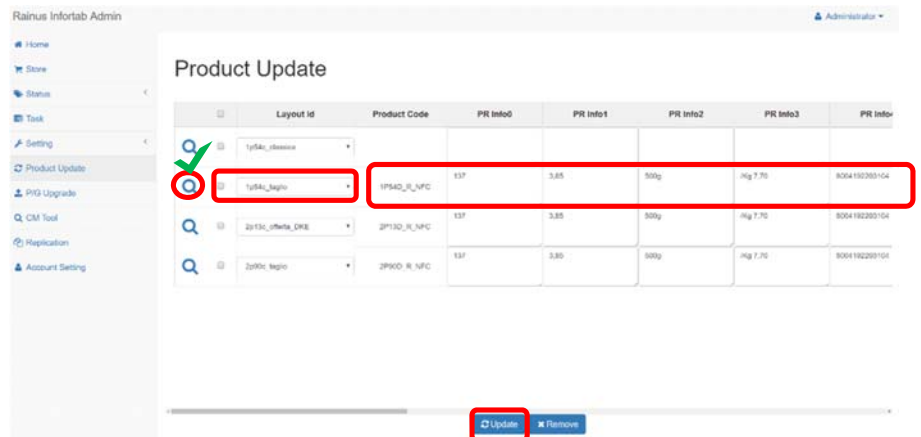

- 1 Choose proper Layout and put appropriate InforTab information.
- 2 Check the square box in the right side and click 'Update' in the bottom side of page.

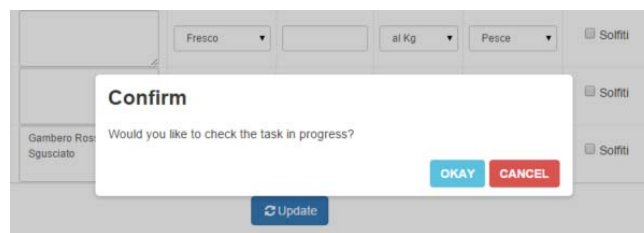

- 3 Press 'Okay' to confirm the procedure.

2. InfoTab Update

2-3 Confirm InfoTab Update Result

After the update, the page automatically moves to 'Task' menu in UI and it is available to check update status in real time.

Task ID	Store Code	Operation	Progress(%)	Start Time	End Time	Detail
1442581903	Store-T	UPDATE	<div style="width: 100%; background-color: green;">100%</div>	2015-09-18 16:38:13	In progress	
	None	LAYOUT	<div style="width: 100%; background-color: green;">100%</div>	2015-09-18 16:36:30	2015-09-18 16:39:13	
	None	LAYOUT	<div style="width: 100%; background-color: green;">100%</div>	2015-09-18 16:35:41	2015-09-18 16:36:30	
	None	LAYOUT	<div style="width: 100%; background-color: green;">100%</div>	2015-09-18 16:10:10	2015-09-18 16:10:46	
	None	LAYOUT	<div style="width: 100%; background-color: green;">100%</div>	2015-09-18 10:09:35	2015-09-18 10:09:45	
	None	LAYOUT	<div style="width: 100%; background-color: green;">100%</div>	2015-09-18 16:06:38	2015-09-18 16:08:57	
1482108472	Store-T	UPDATE	<div style="width: 100%; background-color: green;">100%</div>	2015-09-18 15:41:12	2015-09-18 15:41:37	
	Store-T	ASSIGN	<div style="width: 100%; background-color: green;">100%</div>	2015-09-18 15:41:12	2015-09-18 15:41:12	

InforTab update generally completes in 5 minutes, but time it can be delayed by network circumstance.

To make InforTab update on purpose, Remote Controller.



After flicker light, update process will be operated when press the 'R' button of remote controller.

3. InforTab De-Assign, Re-Assign

3-1 InforTab De-Assign

'De-Assign' is process that to de-assign InforTab and product from Gateway. De-assigned InforTab cannot be updated unless re-assign it back.

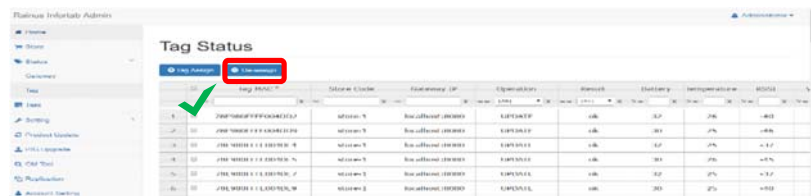

For de-assign, select 'Status > Tag' menu in UI and press 'De-assign'.

3-2 InforTab Re-Assign

If need to update back, 'Re-Assign' work is required. Choose 'Status > Tag' Menu in UI and click 'Assign'.

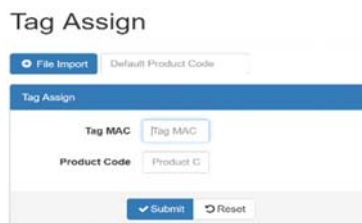

After click 'Assign' button, write down the InforTab Mac address and product code. Then press the 'Save' to make procedure complete.

4. Appendix

4-1 Wireless Network Circumstance

InforTab system uses two channels of wireless 2.4GHz, so that it can effect updating speed of InforTab according to wireless network environment.

■ Wireless Channel

According to wireless circumstance, InforTab system may not be operated properly by influence with other wireless

Rainus Infortab Admin

Home
Store
Status
Task
Setting
Server Config
Store Config
Gateway Config
Embedded Ford Config
Product Update

Administrator

Gateway Config

Gateway MAC	Store Code	GW Index	Gateway IP	Netmask	Default GW	DNS IP	ESL Server IP	ESL Server Port	Data Channel	Event Channel	Radio Power	OP Mode	Note	Channel Mask	Radio Baud	GMP Version	GRM Version	Updated
762C1F031A21	store-1	0	localhost:8080	255.255.255.0	192.168.220.1	203.249.252.2	localhost	80	13	14	100	norm	Note something	12	250	2.1.0	4	2016-11-08 02:38:29

instruments. In this case, changing channel is required. In

order to change channel, click 'Gateway Config' menu in UI

and press 'Setting' Icon in right side of the page.

Gateway Config

Gateway Config Update

Gateway MAC: 70.2C.1F.03.1A.21

Store Code: store-1

GW Index: 0 (must be a unique value in a store)

IP Address: localhost:8080 (Gateway IPv4 address)

Netmask: 255.255.255.0

Default GW: 192.168.220.1 (Default GW IPv4 address)

DNS IP: 203.248.252.2

ESL Server IP: localhost (ESL Server IPv4 address)

ESL Server Port: 80

Data Channel: 13 (IEEE 802.15.4 channel(11-26))

Event Channel: 14 (channel(11-26), should use one value for all gateways in a store)

Radio Power: 100 (Radio power in percentage(1-100))

OP Mode: norm (Use "Normal Operation")

Channel Mask: 12 (Calculated by system on data channel change)

Radio Baud: 250 (Gateway Ethernet MAC)

GMP Version: 2.1.0 (Gateway Main Processor Version)

GRM Version: 4 (Gateway Radio Module FW Version)

Note: Note something

Submit Reset

Date channel, Event channel are composited with 11~26 channels..

Begin with 11 channel and go up until finding a proper one.

Press 'Save' button to confirm the channel.

Information to user

WARNING: This equipment may generate or use radio frequency energy. Changes or modifications to this equipment may cause harmful interference unless the modifications are expressly approved in the instruction manual. The user could lose the authority to operate this equipment if an unauthorized change or modification is made.

This device complies with part 15 of the FCC Rules. Operation is subject to the following two conditions: (1) This device may not cause harmful interference, and (2) this device must accept any interference received, including interference that may cause undesired operation.

NOTE: This equipment has been tested and found to comply with the limits for a Class B digital device, pursuant to part 15 of the FCC Rules. These limits are designed to provide reasonable protection against harmful interference in a residential installation. This equipment generates, uses and can radiate radio frequency energy and, if not installed and used in accordance with the instructions, may cause harmful interference to radio communications. However, there is no guarantee that interference will not occur in a particular installation. If this equipment does cause harmful interference

to radio or television reception, which can be determined by turning the equipment off and on, the user is encouraged to try to correct the interference by one or more of the following measures:

- Reorient or relocate the receiving antenna.
- Increase the separation between the equipment and receiver.
- Connect the equipment into an outlet on a circuit different from that to which the receiver is connected.
- Consult the dealer or an experienced radio/TV technician for help.

-IMPORTANT NOTE: FCC RF Radiation Exposure Statement

This equipment complies with FCC RF radiation exposure limits set forth for an uncontrolled environment. This equipment should be installed and operated with a minimum distance of 20 centimeters between the radiator and your body. This transmitter must not be co-located or operating in conjunction with any other antenna or transmitter.