



Quick Guide

售后服务

R3 Racing Wheel and Pedals



FOR XBOX SERIES X|S, XBOX ONE, AND PC

User manual 使用说明书

CONTENTS

ENGLISH.....	1
简体中文.....	13
繁體中文.....	25

01 R3 Wheel Base

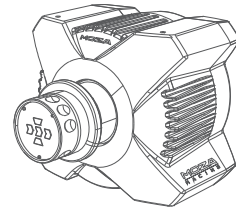

02 ES Steering Wheel

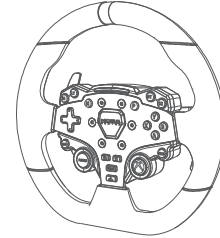

03 SR-P Lite Racing Pedals

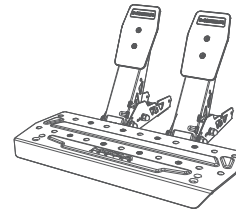

01 R3 WHEEL BASE

Product Introduction

- 3.9 N-m Peak Torque
- Intelligent Temperature Control System
- Servo Direct Drive System
- Ultra-low Static Torque
- Lightweight Design
- MOZA Pit House Control Center Software
- Aviation-grade Aluminum Body
- MOZA App Cloud Control

Connection Ports

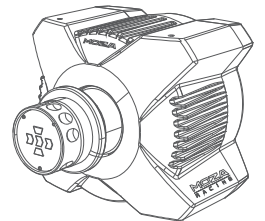
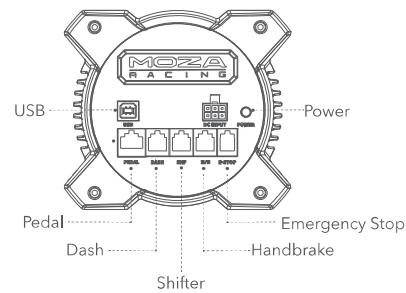

Dimension

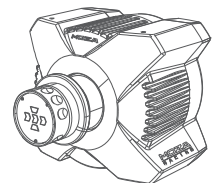
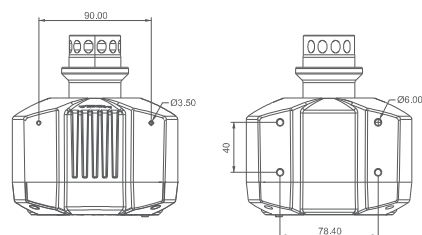

Xbox Console Connection Guide

1. Connect the SRP Lite pedal set to the PEDAL port on the base.
2. Plug the power cord into an electrical outlet.
3. Plug the supplied usb cable into the corresponding ports on base and Xbox.
4. Turn on the base by pressing the power button located at the rear and then turn on the Xbox console. If the rpm light on the wheel is in flow breathing mode, it indicates that you have successfully connected to Xbox. However, if the rpm light is in flashing mode, it means that you are in PC mode. In this case, press and hold the Xbox and Radio buttons on the steering wheel simultaneously for 3 seconds to switch to Xbox mode.

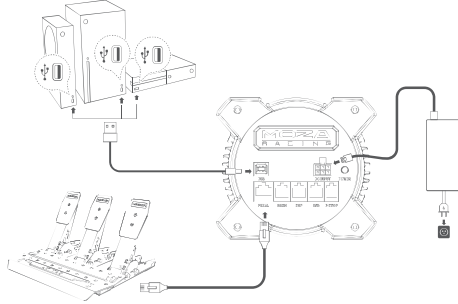

PC Connection Guide

1. Attach the base to the rig mount using either 2 or 4 screw holes on the bottom.
2. Plug in both the power supply and USB cable into their corresponding ports located at the rear of R3 base. Then connect the USB cable to an available port on your PC.
3. Briefly press down on the power button located at the back of R3 base to switch it on.
4. Download the latest version of Moza Pit House from the help center on the Moza Racing website (www.mozaracing.com)
5. For more information and instructional videos, please visit our official website at www.mozaracing.com

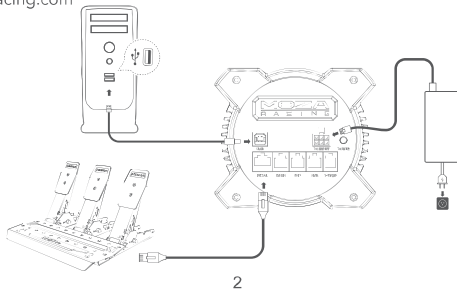

2

Software Introduction

The main page allows you to check the working status of your connected devices and adjust settings. Additionally, you can quickly start games from this page.

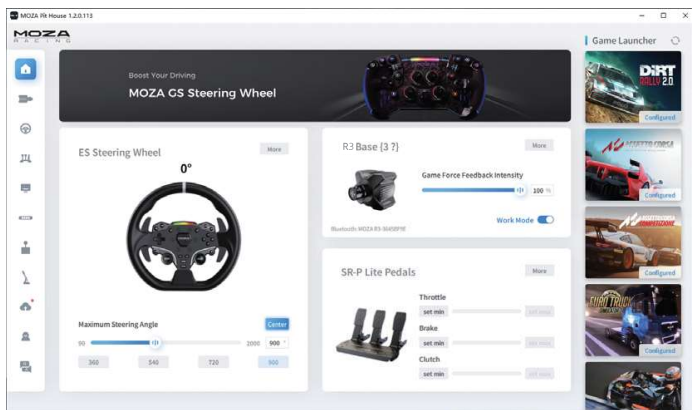

With both click and go presets to fully customizable advanced tuning, everyone from beginners to pro drivers can easily find that perfect setup.

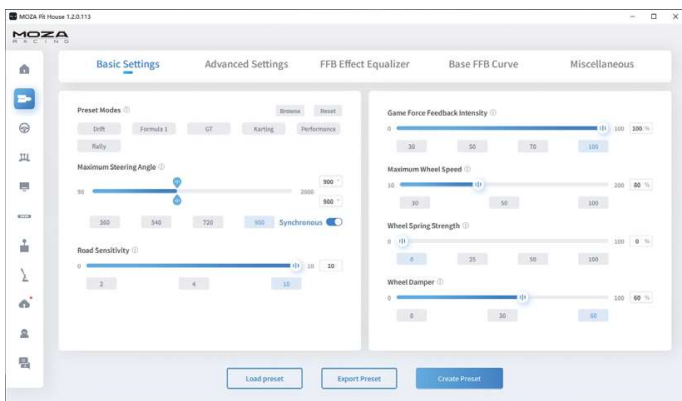

4

Desk Clamp Installation Guide

Attach the base to the clamp using the 4 mounting holes located on the underside of the base. Tighten the clamp to the desk securely to prevent any movement during use.

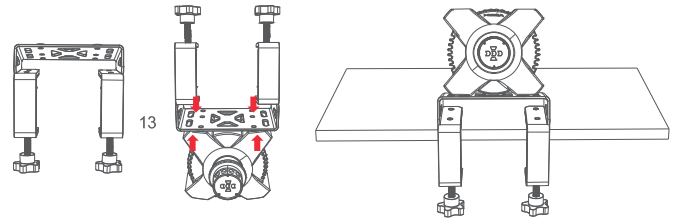

More information and tutorial videos are available on the official website (www.mozaracing.com)

Precautions

- Do not expose the equipment to liquids and moisture to avoid fire/electric shock.
- Avoid using the equipment in direct sunlight.
- For your safety and well-being, please monitor your gaming time and take breaks as needed.
- The device is not suitable for children under 6 years old, small accessories may cause a choking hazard!
- Children under 13 years old must be accompanied by their parents.
- Do not dismantle the equipment without the manufacturer's permission, otherwise you will lose your warranty.
- The equipment must be connected using the factory-supplied power supply to prevent an electrical hazard.
- To ensure safety, repair or replacement of parts should only be carried out by an authorized repair centre.
- The use of non-standard power supplies is prohibited even if the relevant voltage and other data match.
- Only use AC power supplied by a standard wall outlet to avoid damage to the product.
- Exposure of the equipment to heat sources is prohibited.
- Unplug the unit from the power cord and disconnect it if it is not to be used for a long period of time.
- If you observe any abnormalities, please stop using it immediately and seek assistance from MOZA officials or the authorized center relevant to your concern.
- Stay tuned to the MOZA website and public platform for the latest product information.

⚠ This product is intended solely for use in simulated driving activities. It is important to distinguish between simulated games and real-life driving to ensure safety on the road.

3

Customize force feedback in our FFB Effect Equalizer section, to ensure you get exactly the right feel for every condition.



One click updates the MOZA Racing ecosystem, enjoy the latest features with ease.

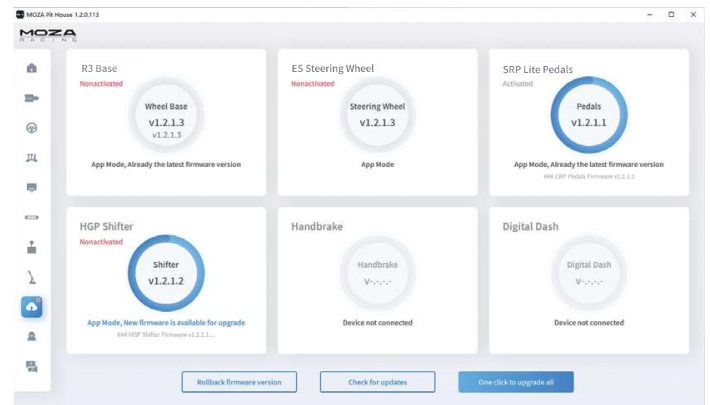

For more detailed instructions, please visit the MOZA website (www.mozaracing.com) and download the user manual from our help center page.

5

Bluetooth connection

1. Download the MOZA RACING App from the App Store and open it. Tap on "Connect to the device" to begin searching for your device.
2. Once you have found your device, click on "Connect."
3. Click on "Enter the car" to access the settings page.
4. On the setting page, you can configure and adjust the parameters for both the base and steering wheel.

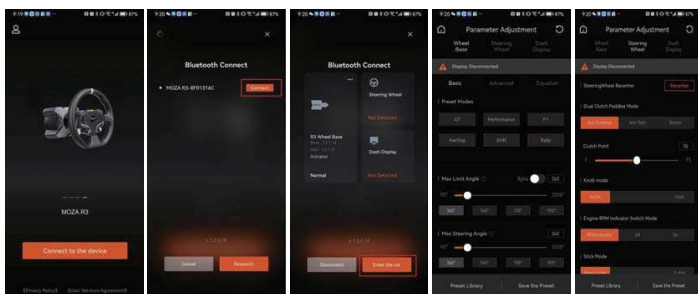

Specs

Supported Platforms: Xbox Series X|S, Xbox One, Windows 10/11
 Drive Type: Direct Drive
 Max Wheel Rotation: Limitless
 Housing Material: Aviation-grade Aluminum Alloy
 Housing Color: Black
 Peak Torque: 3.9 N·m
 Input Voltage: 110V~240V AC -> 12V DC
 USB Refresh rate: 1000Hz
 APP Function: Supported
 Connection Ports: power, USB, dash, pedals, emergency stop, shifter and handbrake
 Accessories: user manual and warranty card, power supply, data cable, and tool kit.
 Fixing Method: bottom mount with 2/4 holes
 Upgradable firmware: supported

6

FCC Warning

This device complies with part 15 of the FCC Rules. Operation is subject to the following two conditions: (1) This device may not cause harmful interference, and (2) this device must accept any interference received, including interference that may cause undesired operation. Any Changes or modifications not expressly approved by the party responsible for compliance could void the user's authority to operate the equipment. This equipment has been tested and found to comply with the limits for a Class B digital device, pursuant to part 15 of the FCC Rules. These limits are designed to provide reasonable protection against harmful interference in a residential installation. This equipment generates uses and can radiate radio frequency energy and, if not installed and used in accordance with the instructions, may cause harmful interference to radio communications. However, there is no guarantee that interference will not occur in a particular installation. If this equipment does cause harmful interference to radio or television reception, which can be determined by turning the equipment off and on, the user is encouraged to try to correct the interference by one or more of the following measures:

- Reorient or relocate the receiving antenna.
- Increase the separation between the equipment and receiver.
- Connect the equipment into an outlet on a circuit different from that to which the receiver is connected.
- Consult the dealer or an experienced radio/TV technician for help.

FCC RF exposure statement:

The device has been evaluated to meet general RF exposure requirement. The device can be used in portable exposure condition without restriction.

IC Caution:

Radio Standards Specification RSS-Gen, issue 5
 This device contains licence-exempt transmitter(s)/receiver(s) that comply with Innovation, Science and Economic Development Canada's licence-exempt RSS(s). Operation is subject to the following two conditions:
 This device may not cause interference.

This device must accept any interference, including interference that may cause undesired operation of the device.

RF exposure statement:

The device has been evaluated to meet general RF exposure requirement. The device can be used in portable exposure condition without restriction.

7

02 ES Steering Wheel

Product Introduction

- Aluminum Wheel Rim
- Racing Level QR System
- Aluminum Alloy Shifters
- 22 Programmable Buttons
- RGB Sequential Shift Light Indicator

Xbox Console buttons

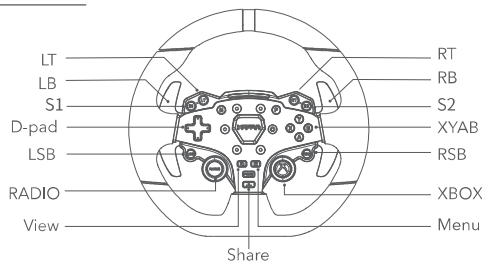

1. Please note that the RPM LEDs are designed to work with games that support the R3 RACING WHEEL AND PEDALS. Please visit www.mozaracing.com/ to see a regularly updated list of compatible games at the bottom of the page.
2. To switch between Xbox mode and PC mode, please follow these steps: Press and hold the **S1** and **S2** buttons simultaneously for more than 3 seconds to switch between Xbox and PC mode. When the rpm light flashes at high frequency, it means that you have successfully switch to the other mode. When the rpm light is in the flowing breathing mode, it indicates that the steering wheel is in Xbox mode; When the rpm light is in flashing mode, it indicates that the steering wheel is in PC mode.
2. It's important to note that the LSB and RSB buttons on the Xbox console's steering wheel only function in specific games.
3. The list of Xbox Series X|S and Xbox One games that are compatible with R3 is located at the bottom of the page: www.mozaracing.com

QR Use Guide

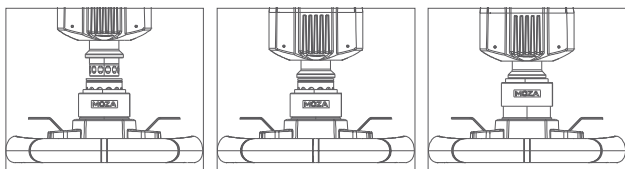

1. Align the 6 ball bearings on the wheel QR with the 6 notches on the base QR mount.
2. Press the quick release onto the base mount, keeping the bearings and notches aligned.

8

3. The quick release will automatically lock into place, if it does not remove it, recheck the alignment and try again.
4. To remove the wheel, squeeze the black quick release part with the MOZA logo towards the wheel with both hands and pull out the wheel at the same time.

Steering Wheel Configuration

- The ES steering wheel can be set up easily and quickly in the MOZA Pit House software.
- Joystick mode: can be set to button and D-pad
 - RPM indicator switch mode: choice of three modes; in-game rpm, off and constant
 - Indicator modes: there are two modes, mode 1 and mode 2, which are explained in detail, when the mouse is moved over the option.
 - RPM indicator timing: choose between early, normal, late or custom to fully match in-game RPM timing.
 - Brightness: adjust the brightness of the RPM/shift LEDs

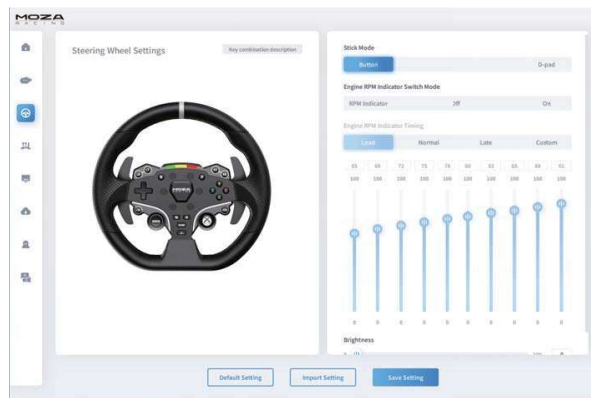

(For detailed steering wheel settings and functions, please visit the Moza Racing official website)

Specs

Wheel Rim Material: Aluminum Alloy
 Shifter Paddle Material: Aluminum Alloy
 Size: 280mm
 Buttons: 22
 High Brightness LEDs: 10 Pcs
 Intelligent Telemetry: Supported
 RPM LEDs Fully Adjustable through MOZA Pit House: Supported
 Release Method: Quick Release

9

03 SR-P Lite Racing Pedals

Product Introduction

- High Strength Steel
- High Precision Hall Sensors
- A Wide Range of Use Scenarios
- Detachable
- Adjustable Pedal Output Curve

Pedal Installation Guide

1. Mount the pedal on the footrest and adjust the mounting holes, fix the M4*10 screws to the footrest using a 2.5mm hexagonal spanner. To ensure stability in use, it is recommended that all 4 screws of each pedal are fitted in place.
2. Connect the connecting cable to the corresponding mounting connector, you can use the cable clip under the pedal base to keep cabling tidy.

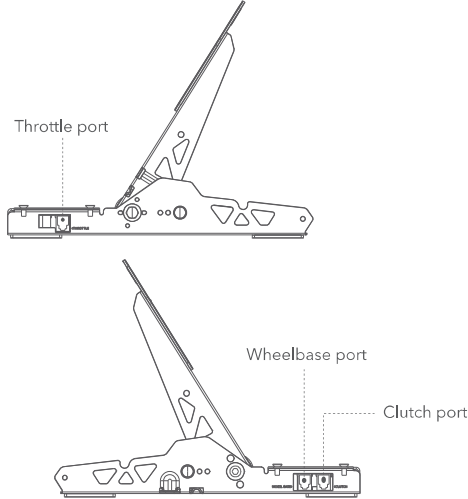

10

Instructions for Adjusting the Height of the Pedal Plate

Use a 2.5mm hexagonal spanner to turn the screws on the face of the pedal plate counter-clockwise and use a 7mm open-end spanner to remove the back nut from the plate screws, move the plate up and down to adjust the plate height according to your needs, then tighten the nuts and screws until they fit the plate and fix it (the plate is adjusted in the same way for the throttle, brake and clutch)

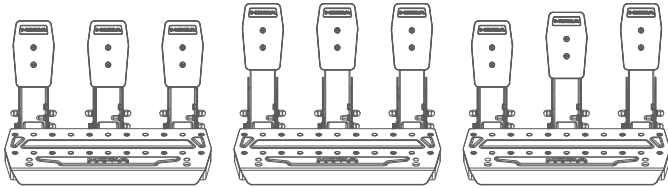

Specs

- Pedal Material: High Strength Steel
- Pedal Plate Material: High Strength Steel
- Color: Black
- Sensing Method: Hall Sensor
- Pedal Spacing: Adjustable
- Pedal Plate Height: Adjustable
- Pedal Travel Software Adjustment: Supported
- Pedal Travel Reversal Function: Supported
- Pedal Output Curve: Supported
- Anti-slip Pedal Pad: Supported

04 Packing List

- R3 DD Base
- ES Steering Wheel
- SR-P Lite Racing Pedals
- 15 Degree Desk Clamp
- Power Adapter
- Power Cord
- Wire Harness x2
- Screws (multiple sizes)
- Spanners (multiple sizes)
- Nuts
- Cable Clip
- Anti-slip Silicon Pad x2
- M6 Flat Pad x4
- Moza Logo Stickers

12

3. To connect the steering wheel to the pedal, please follow these steps: connect one end of the RJ45 cable to the Wheel Base port and the other end to the Pedal port on the base.
4. The working status of the pedal can be seen in the MOZA Pit House. (If the unit is still grey or does not respond when pressed, unplug the base, close MOZA Pit House, reconnect the base and open Moza Pit House)
5. The start, end and travel of the pedal can be set in the MOZA Pit House.

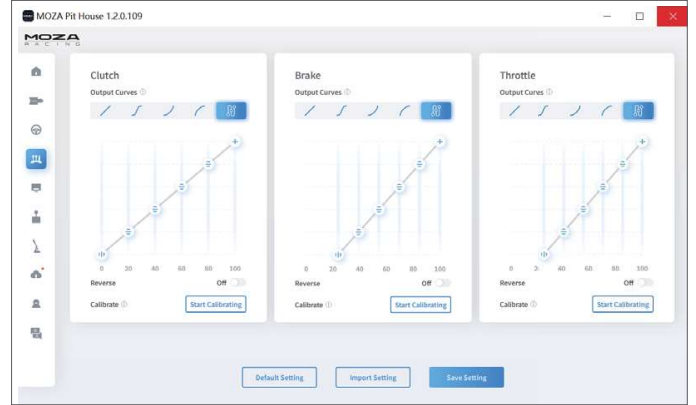

Pedal Spacing Adjustment Instructions

Move the pedal left and right to adjust the distance between the pedal and the base holes, align the holes and tighten the screws, (the same for the throttle, brake and clutch)

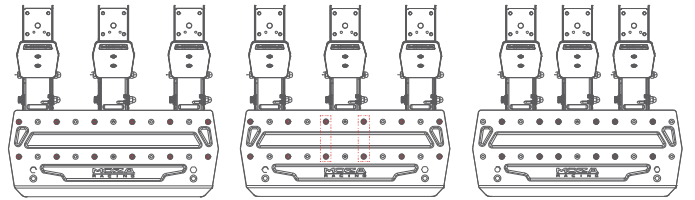

11

01 R3直驱赛车模拟器

产品介绍

- 3.9牛米强劲扭矩
- 专业伺服直驱系统
- MM轻量化高扭矩设计
- 航空级铝合金机身
- 智能电机温控系统
- 超低转矩脉动和齿槽转矩
- MOZA Pit House专业模拟控制中心
- 手机APP云端控制

基座接口介绍

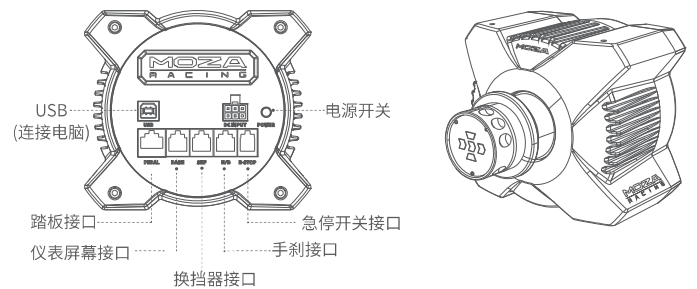

基本参数

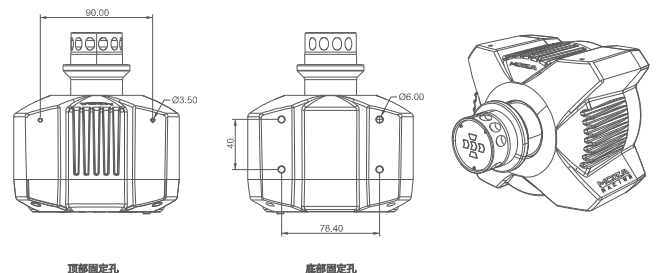

13

安装XBOX主机教程

1. 将 SRP Lite踏板组连接到基座的PEDAL接口
 2. 将电源线和电源适配器插入电气插座中
 3. 将 USB-B/USB-A 连接线的USB-B端连接到基座尾部的 USB-B接口
 4. 将 USB-B/USB-A 连接线的USB-A端连接到Xbox 主机上的 USB-A接口
- 在按下基座尾部的电源开关后,基座和方向盘会上电。当开启Xbox主机后,若方向盘换挡提示灯为流动的呼吸模式,则处于Xbox模式,即可自动识别使用。若方向盘换挡提示灯为明暗呼吸模式,则处于PC模式,此时需同时长按Xbox和Radio两个按键3秒以上切换为Xbox模式,即可自动识别使用

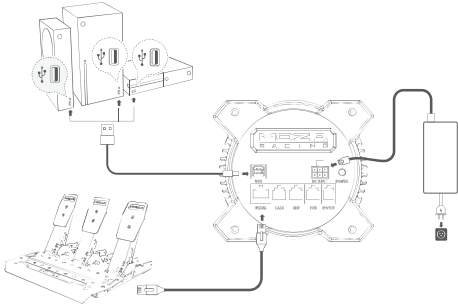

安装PC主机教程

1. 将基座通过底部2~4个螺丝孔固定到模拟器支架上
2. 将电源线、USB线Type-B端分别插入R3基座尾部对应接口上,电源线另一端接入220V电源插口,USB线Type-A端接入PC
3. 短按R3基座尾部的电源按钮开机
4. 在MOZA Racing官网(www.mozaracing.com)的帮助中心下载最新版本的MOZA Pit House软件并安装,即可开启您的赛车之旅
5. 更多信息和教学视频请登录官网(www.mozaracing.com)进行查阅

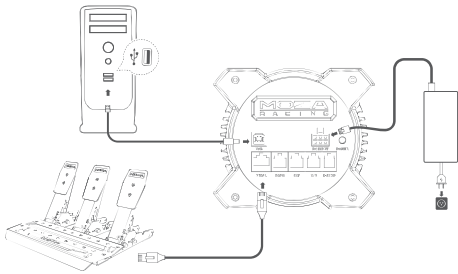

14

桌面夹安装教程

将基座底部的四个螺丝孔对准桌面夹上的安装孔位,然后使用4颗螺丝将其固定到桌面夹上,调整桌面夹上的旋钮并使其夹紧到桌面上,夹住桌面后务必再次拧紧旋钮使其彻底固定,以免在激烈的模拟驾驶中桌面夹松动与脱落

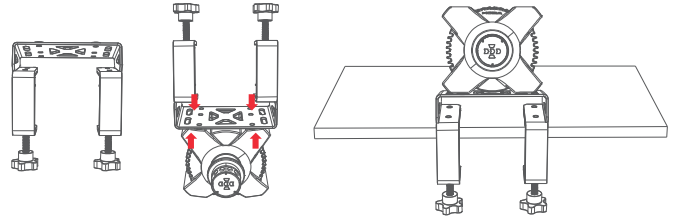

更多信息和教学视频请登录官网(www.mozaracing.com)进行查阅

注意事项

- 严禁将设备暴露在雨水以及潮湿的环境中,以避免发生火灾/电击
- 严禁在太阳直射的条件下使用设备
- 为了您的健康,请合理控制游戏时间
- 设备不适用于6岁以下儿童,小配件可能造成窒息的危险!
- 13岁以下孩童需在家长陪同下使用
- 未经厂商允许的情况下,严禁自行拆解设备,否则将失去质保资格
- 设备必须使用配套出厂的电源进行连接,以保障用电安全及用户权益得到保障
- 为保障相关安全,零部件维修或者更换只能由官方授权维修中心进行
- 即使相关电压等数据匹配,亦禁止使用非标准电源
- 只能使用标准壁式电源插座提供的交流电源以避免对产品造成损坏
- 禁止将设备暴露在热源中。
- 长期不使用的情况下,请拔出设备电源线断电
- 如发现有任何异常,请立即停止使用并寻求 MOZA 官方或相关授权中心的帮助
- 请关注 MOZA 官网及公众平台以了解最新的相关产品信息

⚠ 本产品仅限于模拟驾驶相关活动,请区别模拟游戏与现实,安全驾驶。

15

软件介绍

主页面查看已连接的设备工作状态,设置基座转角,力反馈,踏板,方向盘与仪表等,同时可以快捷启动游戏

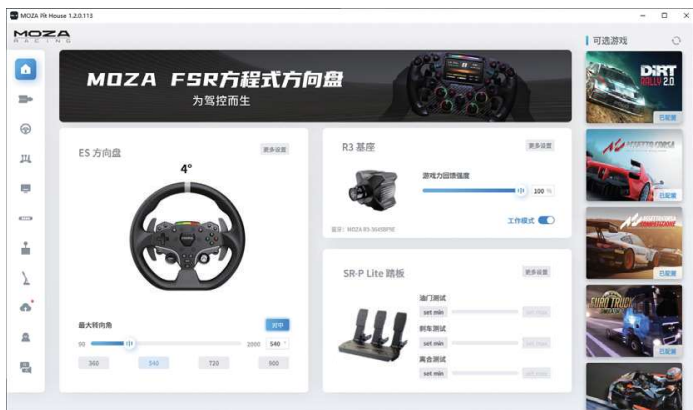

基础设置帮助入门玩家快速匹配合适的手感;专业设置让高阶玩家调出惊喜的专属力反馈效果。

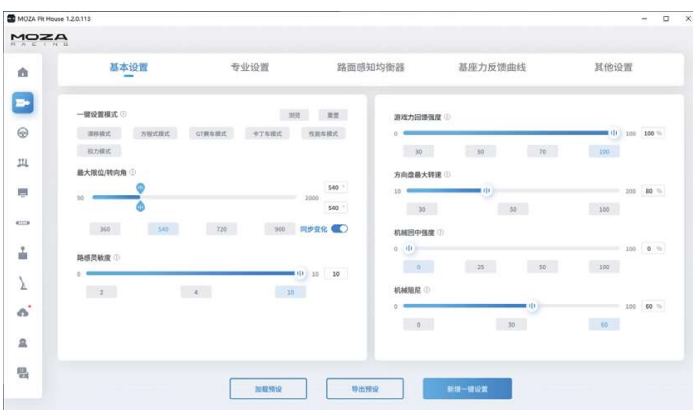

16

创新性的推出路感均衡器系统,用户可以根据喜好与不同场地环境调节方向盘的路感反馈

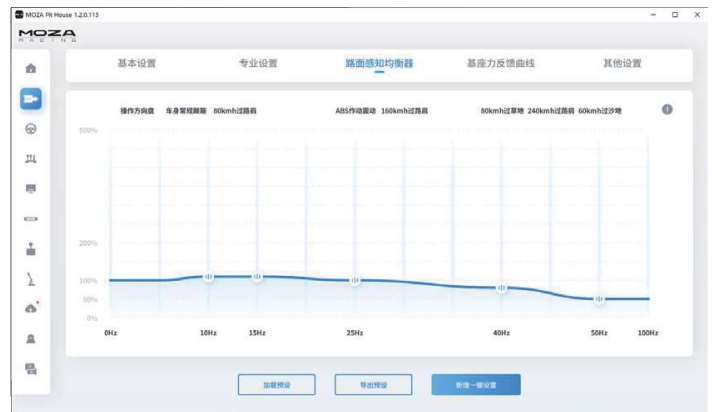

一键完成MOZA Racing套件生态系统升级,轻松享受最新的功能体验

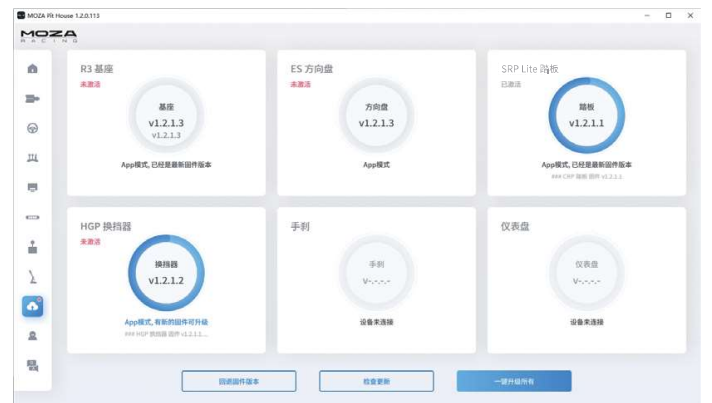

*详细软件使用说明,请访问MOZA官网(MOZARACING.COM)帮助中心页面下载详细说明书

17