

iMagic Camera instructions



©2017 Hangzhou Great Star Industrial Co., Ltd.

02 Welcome to use

Welcome to use iMagic Camera

Thank you for choosing iMagic Camera!

FCC Statement

Any Changes or modifications not expressly approved by the party responsible for compliance could void the user's authority to operate the equipment.

This device complies with part 15 of the FCC Rules. Operation is subject to the following two conditions:

- (1) This device may not cause harmful interference, and
- (2) This device must accept any interference received, including interference that may cause undesired operation.

FCC Radiation Exposure Statement:

This equipment complies with FCC radiation exposure limits set forth for an uncontrolled environment. This equipment should be installed and operated with minimum distance 20cm between the radiator& your body.

ISED RSS Warning:

This device complies with Innovation, Science and Economic Development Canada licence-exempt RSS standard(s). Operation is subject to the following two conditions: (1) this device may not cause interference, and (2) this device must accept any interference, including interference that may cause undesired operation of the device.

Le présent appareil est conforme aux CNR d'ISED applicables aux appareils radio exempts de licence.

L'exploitation est autorisée aux deux conditions suivantes:

- (1) l'appareil ne doit pas produire de brouillage, et
- (2) l'utilisateur de l'appareil doit accepter tout brouillage radioélectrique subi, même si le brouillage est susceptible d'en compromettre le fonctionnement.

ISED RF exposure statement:

This equipment complies with ISED radiation exposure limits set forth for an uncontrolled environment. This equipment should be installed and operated with minimum distance 20cm between the radiator& your body. This transmitter must not be co-located or operating in conjunction with any other antenna or transmitter.

Le rayonnement de la classe b respecte ISED fixaient un environnement non contrôlés. Installation et mise en œuvre de ce matériel devrait avec échangeur distance minimale entre 20 cm ton corps. Lanceurs ou ne peuvent pas coexister cette antenne ou capteurs avec d'autres.

Content

- 04 Packaging components
- 05 Product introduction
- 07 User guide
- 15 Subscription Plan
- 16 Recommendation of video parameter configuration
- 17 Indicator state description
- 18 Safety and warnings of battery use
- 20 Contact us

04 Packaging components

Packaging components

(1)Camera (1)Magnetic wall mount (1)Non-magnetic wall mount (4)expansion screws
(1)Protective case (4)AA Alkaline batteries (1)User guide



(1)Camera



(1)Magnetic wall mount



(1)Non-magnetic wall mount



(4)Expansion screws



(1)Protective case



(4)AA Alkaline batteries



(1)User guide

Product introduction

iMagic Wirefree HD Camera (iMagic Camera) is a smart security camera developed by Hangzhou Great Star Industrial Co., Ltd.

The system works in the sequence: PIR detects motion, sends alerts to App, and triggers video stream recording. Meanwhile, video records are listed in the server and stored on the cloud. It can be used for security monitoring around house, stores, small offices, etc.

Product use scenario:

- **View home.** Whenever and wherever you want to view your home. Support multi-user online live view simultaneously. WiFi connection, low delay, more stable than P2P connection.
- **Monitor your store.** Reliable and secure. Support both T-card local storage and cloud storage. A cheaper cloud subscription plan. Support play historical video records with local LAN connection.
- **View who you love.** Free App, no constraints, support two-way voice call with App.
- **View your pets.** Share pets video with friends happily. Weather resistant, no weather concerns



Product characteristics and properties

100% wireless, no base station! 10 times faster motion detection, trigger to wake up in one second.

Supports both 4x AA alkaline battery power supply and DC 5V (Micro USB) power supply.

Can be transferred to 24 hours continuous recording mode.

Support local LAN playback. Support alarm (rich text) with pushing picture.



100% pure wireless



Real-time view



Two way audio communication



Motion monitoring



Cloud and local storage



Low power consumption



1 Infrared night vision



Historical replay



135° view angle



High definition picture quality



Battery /USB power supply



Protective case

Use help A simple 4 step easy

Then go into the quick use guide

Use guide 1 Download the mobile App and register the account number

- ▣ Search iMagic iCamera in Apple App store or Google play, download the App
- ▣ Select and confirm the location of the corresponding device (please select the region corresponding to your device)
- ▣ Register user account



iMagic iCamera



Use guide 2 Power up the device

Install 4x AA batteries (alkaline) in the battery compartment correctly or connect to the USB power cord of the device

The device will initiate automatically when powered up, and blue indicator will keep lit constantly.

or



Use guide 2 Power up the device – Reminders of



a. Use thumb to push upward open the cover of the battery compartment



b. Install the batteries according to the label indication

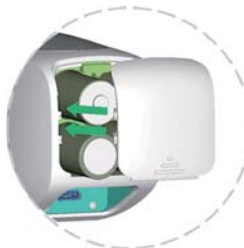

c. Push close the cover of the battery compartment

Use guide 3 Bind the device in the App

① Awaken the device

Press SN button 5 seconds, the device enters the AP pairing mode with voice reminder: welcome to use iMagic Wire free Camera, and the purple indicator will keep lit constantly



② Add network

Select the WLAN that you want to connect, enter the password to access the WLAN.

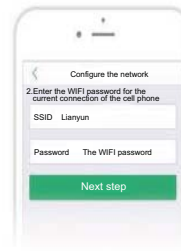

Use guide 3 Bind device in the App

③ Synchronize device

In iOS App: Go to [set] – [wireless local area network], find [iMagic-xxxx] in the list, Input password [123456789]

In Android App: if you are using an Android phone, the cell phone will be connected on its own and do not require you to perform any operations.

o

④ Bind the device

Once the network configuration is successful, the App is associated with the device, the binding operation is done.

If any error happened in the binding operation, please follow the App suggestions!

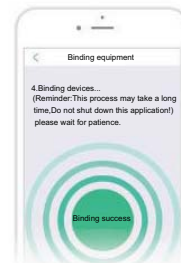
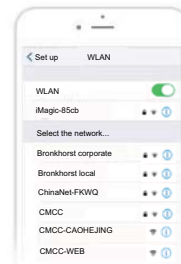

Use guide 4 Install the camera and adjust the orientation

The Wire free Camera has the following ways of placement:

- Naturally placed on a flat surface horizontally
- Install the camera on wall with wall mount
- Install the device on wall with magnet mount

Before getting the iMagic Wirefree Camera fixed with wall/ magnet mount, please make sure you can watch live video in your smart phone Apps (iMagic iCamera), verify whether the camera is directly facing the areas where the moving objects are to be monitored; if not, please adjust and confirm the camera is facing correctly. Fix the camera when you get the things above done.



Complete the installation Open the wonderful world of iMagic

For more details, please access the official network www.greatstartools.com

Cloud subscription plan

When iMagic Wirefree Camera detects the motion, it will trigger the video record system and start the recording, save to the cloud (or local T-card). Video record stored in the cloud is able to be viewed, edited and shared via the smart phone App! The total length of video recording time stored in the cloud storage is determined by the subscription plan that you choose..

Basic plan

- 1 Camera
- 30 Days of Cloud Recordings
- \$2.8 / month Per Camera Billed Monthly
- \$28 / year Per Camera Billed Annually

Value added plan

- 24/7 CVR
- 30 Days of Cloud Recordings
- \$17.9 / month Per Camera Billed Monthly
- \$179 / year Per Camera Billed Annually

Recommendation of video parameter configuration





In order to optimize your iMagic Wirefree Camera to meet your needs and match your preference, you can configure the parameters for video recording in the iMagic iCamera App. Based on thousands of tests, we recommend configure the parameters as below:

Save setting	Cloud
PIR trigger interval	3 minutes
Length of automatic recording time	3 minutes
Sensitivity of motion detection	Medium



Status description of indicator lights

In order to make your iMagic wirefree camera easier to use, we have designed it to respond to your operation through the indicator light and voice prompts! The following is the indicator light status description, hope it helps!

Automatically initiate when the device is powered up	 Blue light keeps lit constantly	
Press SN button 5 seconds to enter the pairing mode	 Purple light keeps lit constantly	
Network abnormal	 Purple light flickers	

Battery use warning message

Do not use rechargeable batteries. Warning: the use of substandard or rechargeable batteries may cause personal injury or property damage. Due to many rechargeable batteries on the market are counterfeit or inferior goods, we strongly suggest not to use of any rechargeable battery in the iMagic camera, because these batteries may damage your camera, and may even cause a fire hazard.

Do not use any fake or poor quality AA batteries. Fake or poor quality batteries usually are lack of built-in failure proof and thermal protection that the high-quality batteries guarantee. The use of fake or poor quality batteries may cause short circuits within the device, or may even cause the risk of fire or combustion.

Within the permitted scope of the applicable law, iMagic claims free of any responsibilities to any danger and hazards caused by any form of the consumer activities of using rechargeable batteries, counterfeit or inferior batteries in the iMagic camera, these danger and hazards include property damage, personal injury and / or death caused. The use of improper batteries may damage the camera and this is not included in the warranty. For any risk of fire, property damage, personal injury and / or death caused by using rechargeable batteries, counterfeit or inferior batteries in the camera, it will be the consumer's sole responsibility.

Due to the above reasons, we suggest that you choose buy well known qualified batteries manufactured by Panasonic, Energizer or Duracell.

Safely use and handling of batteries

Batteries may cause explosion, fire, and / or burns if they are dismantled, damaged, cut, impacted, short circuited, incinerated, charged (primary battery), or exposed to water, fire or high temperature.

Please maintain the performance of the batteries and use it safely:

- Only use those batteries with built-in failure proof and heat protection
- Do not use a fake or inferior battery in the camera
- Do not use rechargeable batteries
- Do not put spare batteries into your pockets, purses, or other containers together with metal items
- Do not store batteries made of hazardous or flammable materials
- Store batteries in cool, dry and well ventilated place
- Ensure the battery compartment and batteries are free from water before and during the outdoor use
- Keep the batteries free from children's reach
- Ensure all batteries' size and models installed in the same camera are the same
- Before installing the batteries, make sure that the battery compartment is empty and no debris exist
- Operates according to the user manual and / or the instructions in the camera App
- Handle used batteries in accordance with your local legislation and guidelines

Contact us

Company name: Hangzhou Great Star Industrial Co., Ltd.

Contact: +86 571-81601188

Official website: <http://www.greatstartools.com>

Contact address: No.35, Jiuhuan Road, Jianggan District, Hangzhou, China

Certifications

FCC ID: 2AMI2-IM9005

IC: 22853-IM9005

ID: 2017MC10009

