

Can't connect?
Need help?

**WE
CAN
HELP**

DO NOT
RETURN THIS
PRODUCT TO
THE STORE

•
support.mygeeni.com
or tap 'support' for help in the Geeni app.

geeni.
START
GUIDE

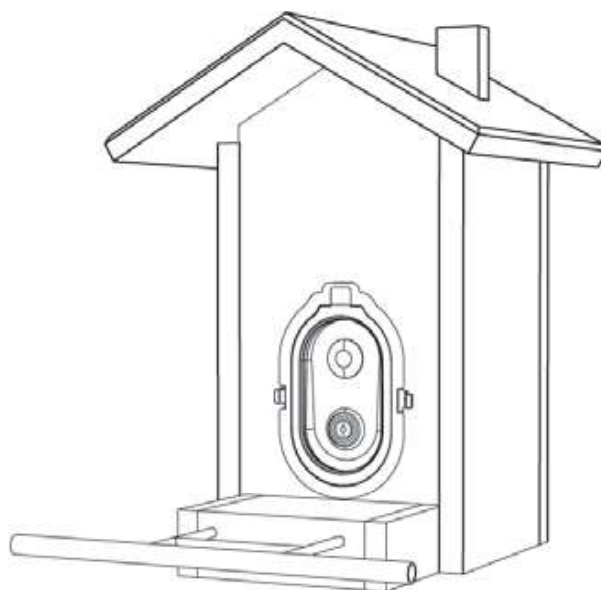

FEATHERCAM
SMART BIRD FEEDER WITH AI
BIRD IDENTIFICATION

Thank you for purchasing your GEENI smart home product.

Get started using your new devices by downloading Geeni, one convenient app that manages everything straight from your phone or tablet. Easily connect to your home Wi-Fi, and control multiple devices from the touch of your fingertips.

Contents

■ Start Guide	
Download & Register	01
Assembly	02
Mounting	04
Installing the Solar Panel	05
Connect (QR Code)	08
Settings	10
Questions, Troubleshooting, Notices	12
■ Voice Control Guide	
Google Home	16
Amazon Alexa	18

FCC Notice:

This equipment has been tested and found to comply with the limits for a Class B digital device, pursuant to part 15 of the FCC Rules. These limits are designed to provide reasonable protection against harmful interference in a residential installation. This equipment generates, uses and can radiate radio frequency energy and, if not installed and used in accordance with the instructions, may cause harmful interference to radio communications. However, there is no guarantee that interference will not occur in a particular installation. If this equipment does cause harmful interference to radio or television reception, which can be determined by turning the equipment off and on, the user is encouraged to try to correct the interference by one or more of the following measures:

- Reorient or relocate the receiving antenna.
- Increase the separation between the equipment and receiver.
- Connect the equipment into an outlet on a circuit different from that to which the receiver is connected.
- Consult the dealer or an experienced radio/TV technician for help.

Caution: Any changes or modifications to this device not explicitly approved by manufacturer could void your authority to operate this equipment.

This device complies with part 15 of the FCC Rules. Operation is subject to the following two conditions: (1) This device may not cause harmful interference, and (2) this device must accept any interference received, including interference that may cause undesired operation.

This equipment complies with FCC radiation exposure limits set forth for an uncontrolled rolled environment. This equipment should be installed and operated with minimum distance 20cm between the radiator and your body.

03

- Authorize your account with Smart Home Skills using the username and password from your Geeni app.

04

- Choose "Discover Devices." After a few seconds your GEENI devices will be displayed under Smart Home in the Alexa app.

Discover Devices

Smart Home devices must be discovered before they can be used with Alexa.

- You can rename your devices in the Geeni app, and Alexa will refer to them by the same name.

So if you rename a smart bulb to "Living Room" or a nickname like a smart camera to "Living Room Camera" or "Baby's Room,"

Alternatively, you can create an Alexa group, like "Bedroom" or "Downstairs," and add the device to the group.

Alexa will recognize the group name in the Alexa app, or the device name in the Geeni app.

Amazon Alexa



To control your GEENI smart home products, just ask Alexa.
Make sure your devices are already set up using the Geeni app.

Things you can say*:

"Alexa, show Living Room Camera."
"Alexa, show me the kids room Camera."



*Some commands require compatible devices.

Stream to:

Amazon Echo Show, Amazon Fire TV, and any Alexa-enabled TV or screen.

01

- Open the Alexa app and go to Skills in the menu.

Routines

Things to Try

Skills & Games

Activity

02

- Search for Geeni then tap Enable.

ENABLE TO USE

Account linking required

Search

geeni

1 Result

Sort: Relevance ▾

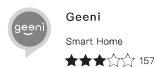

Use Geeni with Alexa to control your Geeni smart lights and plugs:
Alexa, set living room to 50%

Support:

If you encounter any issues, please contact us at support.mygeeni.com for help.

To explore our full selection of products, visit us at: www.mygeeni.com

© 2024 Merkury Innovations • 45 Broadway 3rd FL, New York NY 10006.

The illustrated product and specifications may differ slightly from those supplied. Geeni is a registered trademark of Merkury Innovations LLC. iPhone, Apple and the Apple logo are trademarks of Apple Inc., registered in the U.S. and other countries. App Store is a service mark of Apple Inc. Google, Android, Google Play and Google Home are trademarks of Google LLC. iOS is a registered trademark of Cisco in the U.S. and other countries and is used under license. Amazon, Alexa and all related logos are trademarks of Amazon, com, Inc. or its affiliates. All other trademarks and trade names are those of their respective owners.

Made in China

START GUIDE

What's in the Box:

- Bird Feeder
- Smart Camera
- Charging Cable
- Mesh Base
- Hanging Bracket
- Bird Perch
- Strap
- Drilling Template
- 2x Anchor
- 2x Screw A
- 2x Screw B
- 2x Screw C
- Solar Panel + Installation Kit
- User Manual

Get Ready

- Know your Wi-Fi network and password
- Turn ON Wi-Fi
- Make sure your mobile device is running iOS® 9 or higher or Android™ 5.0 or higher

03

- Choose "Geeni" from the list of Home Control partners.

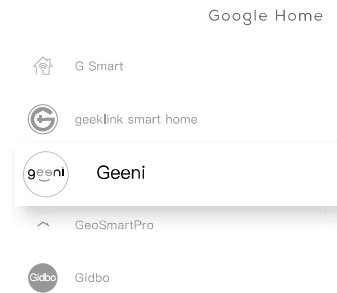

04

- Authorize your account with Google Home using the username and password from your Geeni app.

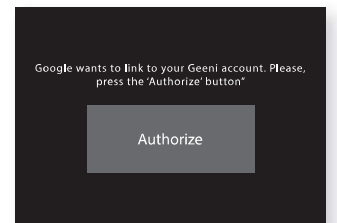

Now your Google Home app and GEENI devices are linked!

You're now able to say "Hey Google" and control your GEENI devices.

- At any time, go into the "Home Control" section of the Google Home app to set nicknames and rooms for your devices. **You can rename your devices in the Geeni app, and Google Home will refer to them by the same name.**

So if you rename a camera to 'Living Room Camera' or 'Baby's Room,' then Google Home will use that same name later on. You can always give it a nickname using the Google Home app as well.

Google Home will be able to control devices by room.



To control your GEENI smart home products, just say "OK Google," or "Hey Google," and ask. Make sure your devices are already set up using the Geeni app.

Things you can say*: Stream to:

"Hey Google, show me the Living Room Camera."
"Hey Google, what's on Kid's Room Camera?"

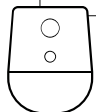

Google Home Hub, Google Home Smart Displays, Google Nest Hub, and any Google Chromecast-enabled TV, screen, or PC

*Some commands require compatible devices.

01

- Open the Google Home app and go to Home Control in the menu.

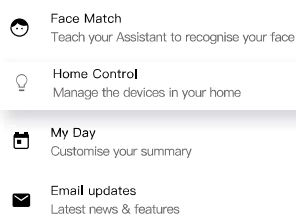

02

- Tap the "+" button.

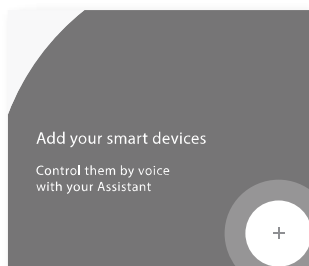

STEP 1

- Download the Geeni App from App Store or Google Play.



- Register an account on your Geeni App.

01.
Enter your email address.

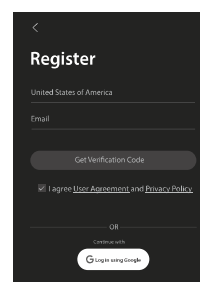

02.
Enter the verification code and create a password.

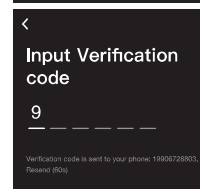

03.
Log into the App.

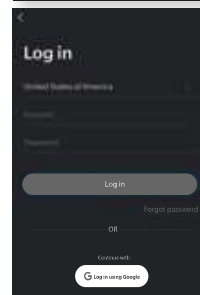

Assemble

STEP 2

- Assemble the bird feeder.

1. Insert the mesh board into the base.



2. Using B screws, install the bird perch at the bottom of the feeder.

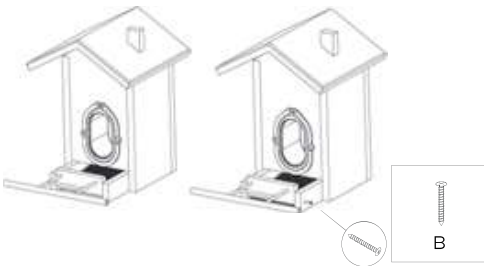

VOICE CONTROL GUIDE

Thank you for purchasing your GEENI smart home product. Make sure your devices are already set up using the Geeni app, then follow these steps.

Your video device is able to stream video to these leading smart assistants.

Name and Control Each Device by Voice



Contents

- Voice Control Guide
 - Google Home 16
 - Amazon Alexa 18

3. Secure the hanging bracket in the correct position on the back using C screws.

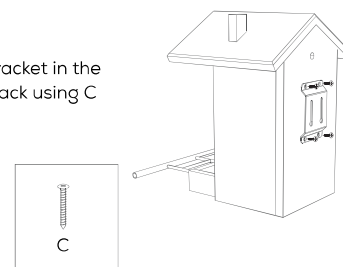

4. Open the buckle of the camera box, put the camera into the camera box, and secure it with the buckle.

5. Pull the solar panel charging cable through the access port at the back of the bird feeder.

6. Connect the solar panel charging cable to the camera's charging port.

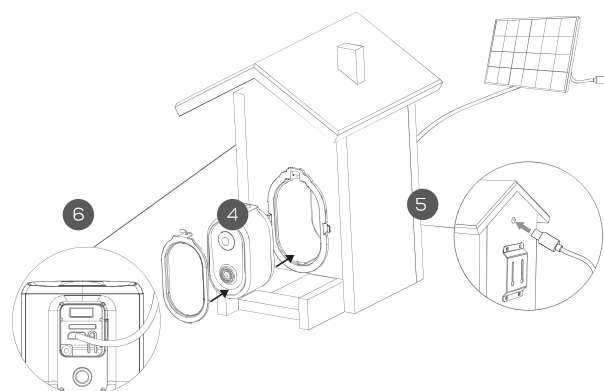

STEP 2 - Wall or Tree Mount

■ Wall Mounting

1. Use the provided drill template to mark the location of the holes, then use an electric drill (15/64", 6mm) to drill two holes.

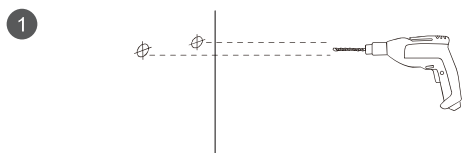

2. Drive the plastic anchors into the holes, and then insert and tighten 2x Screw A.



3. Hang the bird feeder securely on the wall using the mounting holes on the back.

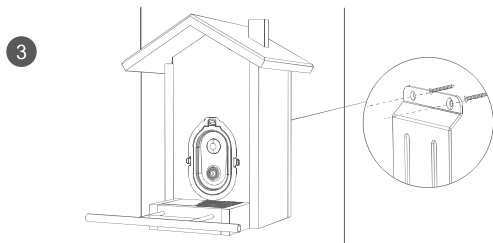

Troubleshooting

■ Cannot connect to your Wi-Fi network.

Make sure you entered the correct Wi-Fi password during the Wi-Fi setup. Check whether there are any Internet connection problems. If the Wi-Fi signal is too weak, reset your Wi-Fi router and try again.

Reset the device

- Press and hold the reset button on the camera for 5 seconds.

System Requirements

- Mobile device running iOS® 9 or higher or Android™ 5.0 or higher
- Existing Wi-Fi Network

Technical Specifications

- Dimensions: 8.2in x 11.2in x 11.8in
- Food Capacity: 2 L
- Resolution: up to 1080p (1920 x 1080) at 15 fps
- Viewing Angle: 144°
- Battery Capacity: 5200 mAh
- Charge Time (With sunlight): 5 days
- Night Vision Distance: 5m
- Power Cable Length: 1m
- Weatherproof: IP65
- Storage: supports up to 128GB microSD card (not included)
- Wi-Fi: IEEE 802.11n, 2.4GHz
(Does not support 5GHz)

Frequently Asked Questions

■ Can I share with family and friends?

Yes! You can share access to all Geeni devices— cameras, plugs, bulbs, doorbells, etc.— with family & friends. In the Geeni app, press the "Profile" button and click on "Device Sharing" to give or revoke sharing permissions. In order to share, the other user should have already downloaded the Geeni app and registered an account.

■ Recording and microSD Card Usage:

Without a microSD card (optional, sold separately), the smart Wi-Fi camera can show live camera video, save screenshots or videos of the camera stream to your phone for later, and record still snapshots of motion alerts when notifications are turned on. Installing a microSD card will further enable video recording and playback of motion alerts from your phone. When the card is installed, the camera will continuously record and play back video to your phone until the card is full (up to 128GB supported). Video is encrypted and only viewable through the Geeni app on your phone, so do not try removing the microSD card to view video.

■ How much video can the camera record?

Depending on video quality, the camera will use around 1GB of storage per day, so a 32GB card can provide weeks of continuous video. As the card fills up, the oldest footage will automatically be replaced by new video, so you don't have to ever worry about running out of storage space.

■ How many devices can I control?

Geeni app can control an unlimited amount of devices in an unlimited amount of locations. Your router may have a limit of how many devices can be connected to one router.

■ My Geeni device has a funny name. How do I rename it?

From your main device list, click on one of the devices you want to rename, press the "... " button on the top right for advanced settings, and click Modify Device Name (or Modify Group Name, if applicable). You'll then be able to choose a more familiar name.

■ What's the wireless range?

The range of your home Wi-Fi is heavily dependent on your home router and the conditions of the room. Check with your router specifications for exact range data.

■ If my Wi-Fi/Internet goes down, will Geeni still work?

Geeni products need to be connected to Wi-Fi in order to use them remotely.

■ Tree Mounting

Secure the bird feeder to the tree using the provided strap.

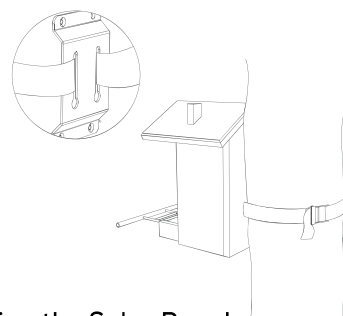

STEP 3 - Installing the Solar Panel

1. Drill 3 holes into the desired surface, using the solar panel mount as a guide.

2. Drive the plastic anchors into the holes.

3. Place the solar panel mount over the plastic anchors, then insert and tighten the provided screws.

4. Attach the solar panel to the head of the mounting bracket.

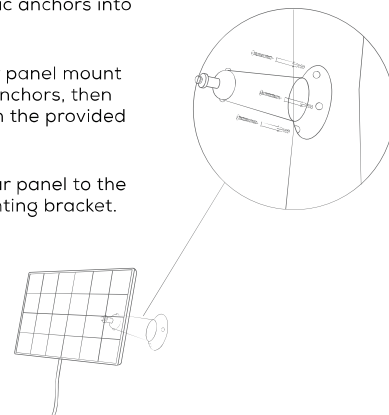

Note:

Place your solar panel in a sunny spot that gets the most direct sunlight. Angle the solar panel between 30°-45° upward and ensure it points south.

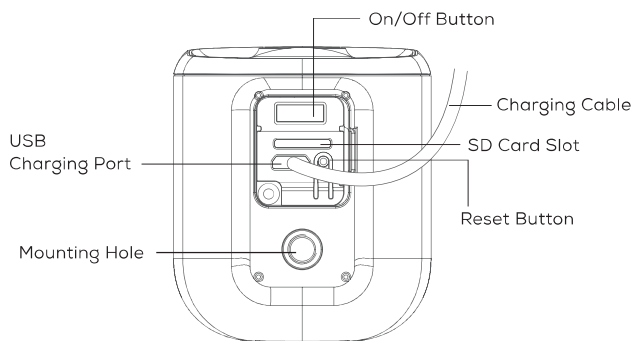
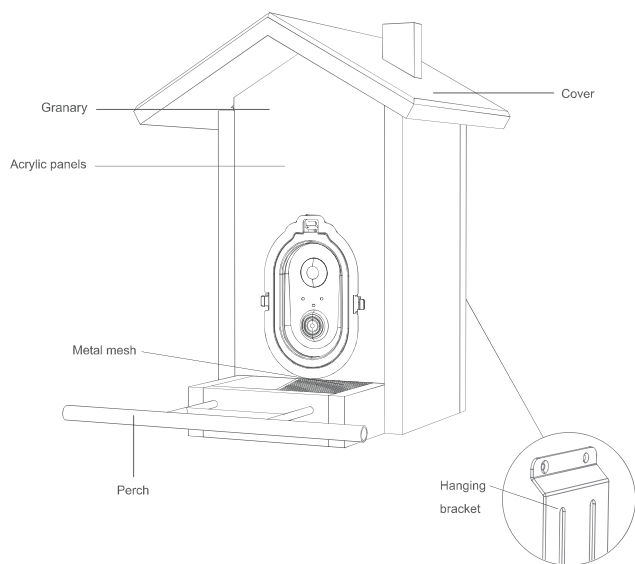

Indicator Light:

By default, the camera's LED is on. Switch "Indicator Light" off to deactivate the LED.

Flip:

If you mount your camera upside down, toggling the "Flip" function will rotate the image so that it's right side up.

Time Watermark:

Turn the time watermark on to always see a time stamp of when video is taking place.

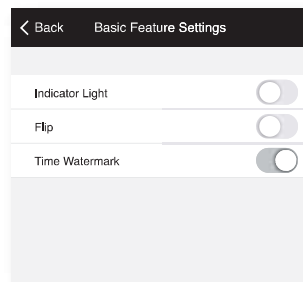

Settings

■ Access Camera Settings:

From your main device list, click on the camera you want to edit, then press “...” button on the top right for advanced settings.



■ Device Name:

Press to rename your device to something like “Bedroom” or “Kids’ Room”.

■ Device Sharing:

Let friends, spouse, roommates, or family keep an eye on what your cameras see. Whether it’s a baby’s crib or the family dog, you can decide who gets to check in, access the camera, and set notifications.

■ Remove Device:

Delete the camera from your account. Until it’s deleted, it will always be linked to your account.

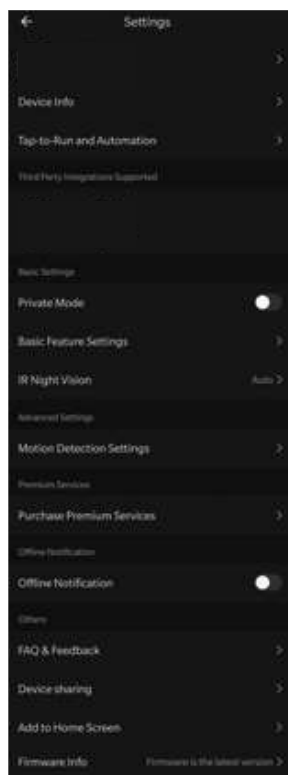

■ Indicator Light Meaning

Red Light:

Flashing Quickly: Waiting for network connection.
Flashing Slowly: Network connection failed
Always On: Device malfunction

Green Light:

Flashing Quickly: Network connected successfully
Always On: Motion detection

White Light:

Always On: Charging
Off: Charging complete
Flashing quickly: Charging abnormal

Yellow Light:

Flashing Slowly: Firmware update in progress

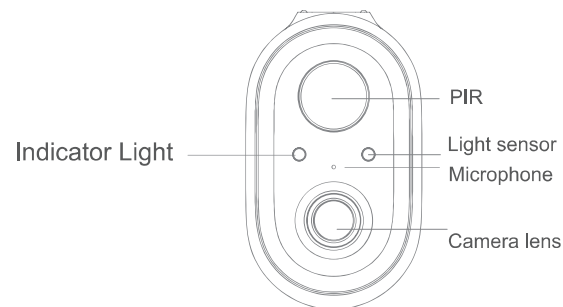

The camera does not come fully charged due to safety regulations. Before first use, please fully charge the device with the charging cable.

Add Device (QR Code)

■ Add device: QR Code Mode

01.
Be sure to reset camera by pressing and holding the reset button for 5 seconds.
02.
In the Geeni app, on the top corner of the Devices screen, click . Choose "Wi-Fi Camera"
03.
Click Next and enter your Wi-Fi details.
04.
Scan the QR code with the camera. When you hear the camera beep, select 'I heard the beep' and it will add your camera.
05.
The indicator light will quickly flash green when device was connected successfully!

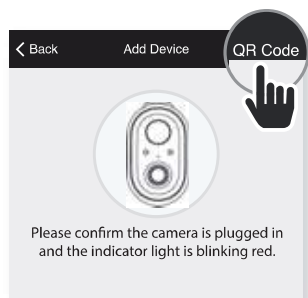

Main Screen

Main Screen

- **Motion Alerts:** Turn on Motion Detection to be notified when motion is detected.
- **Speak:** Press here to speak, and your voice will come out of the camera's speaker. Note: If there is a lot of echo, change the audio mode to one-way audio. See page 10 for more information.
- **Record:** Press here to start video recording. Press again to stop the recording. Note: the video files are saved to your phone's memory. Please use your photo/video viewer on your phone to watch the videos.
- **Screenshot:** Press here to take a screenshot. Note: the photos are saved to your phone's memory. Please use your photo viewer on your phone to see the pictures.
- **AI Bird Recognition:** Identify birds at your feeder: The BirdConnect Feeder uses AI to recognize different bird species visiting your feeder, letting you learn more about them. (Note: AI bird recognition requires a subscription service. Activate your 3-month free trial now!)
- **Squirrel expulsion:** Stop pesky squirrels: Deter squirrels from stealing birdseed e built-in Squirrel Expulsion feature. When the camera detects a squirrel, it activates a siren to frighten them away.

