

MPOW
DREAM · EXPLORE · INSPIRE

MPOW H12 ANC WIRELESS HEADPHONES

MPOW AUDIO WIRELESS



MODEL: BH366A
FOR MORE INFORMATION PLEASE VISIT
<https://www.mpow.com/>

1 Package

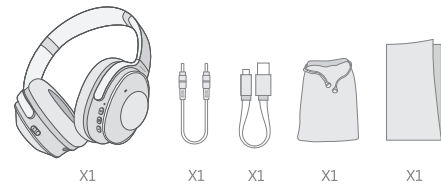

2 Diagram

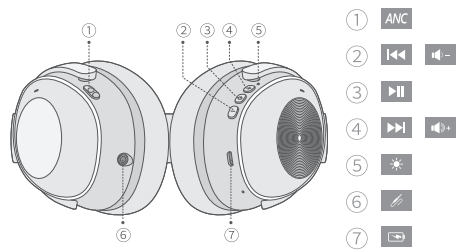

3 Power ON / OFF

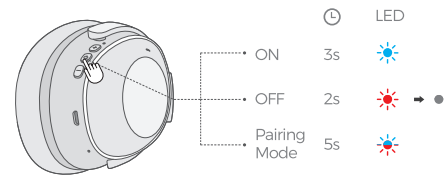

- EN** Long press for 5 s to enter pairing mode with red and blue indicator lights flashing.
- DE** Drücken Sie für 5 Sekunden, um in den Kopplungs-Modus zu gelangen, wobei die rote und die blaue Kontrollleuchte blinken.
- FR** Appuyez longuement sur bouton d'alimentation pendant 5 secondes pour passer en mode de couplage avec les voyants lumineux rouge et bleu clignotants.
- ES** Mantenga presionado durante 5 segundos para ingresar al modo de emparejamiento con las luces indicadoras rojas y azules parpadeando.
- IT** Long press for 5 s to enter pairing mode with red and blue indicator lights flashing.

4 How To Pair

- EN** Enable Bluetooth on your smartphone. Search "Mpow H12" and click to connect.
- DE** Aktivieren Sie Bluetooth auf Ihrem Smartphone. Suchen Sie "Mpow H12" und klicken Sie, um eine Verbindung herzustellen.
- FR** Activez Bluetooth sur votre smartphone. Recherchez "Mpow H12" et cliquez pour connecter.
- ES** Habilita Bluetooth en tu teléfono inteligente. Busque "Mpow H12" y haga clic para conectarse.
- IT** Abilitare il Bluetooth sul Telefono. Cerca "Mpow H12" e lo clicca per connettersi.

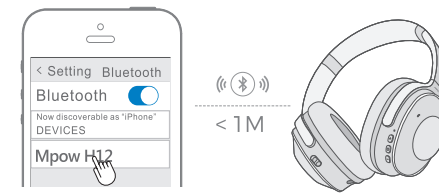

5 Noise Cancelling Switch

- Rauschunterdrückung Schalter
Interrupteur de Réduction du Bruit
Interruptor de Cancelación de Ruido
Nosit cancellazione interruttore

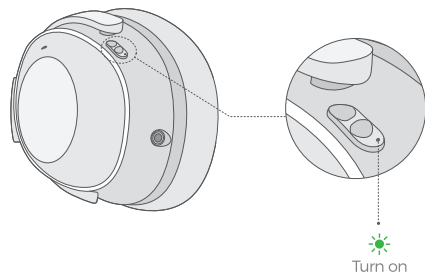

6 Volume Control / Music Control

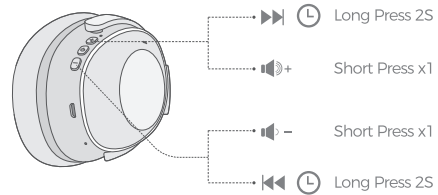

7 Play/ Pause/Answer a Call/ Hang up a Call/ Reject a Call

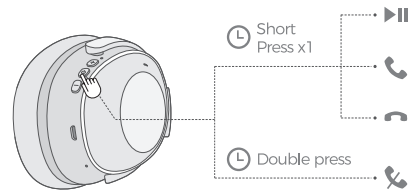

8 Charge Battery

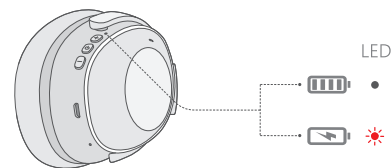
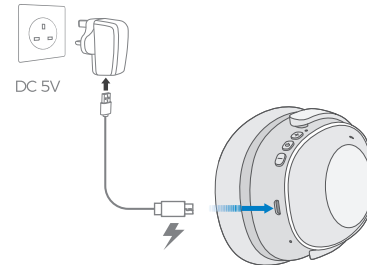

FCC STATEMENT

- Operation is subject to the following three conditions:
- (1) This device may not cause harmful interference.
 - (2) This device must accept any interference received, including interference that may cause undesired operation.
 - (3) This device has been evaluated to meet general RF exposure requirement. The device can be used in portable exposure condition without restriction.

Note:

This equipment has been tested and found to comply with the limits for a Class B digital device, pursuant to part 15 of the FCC Rules. These limits are designed to provide reasonable protection against harmful interference in a residential installation. This equipment generates, uses and can radiate radio frequency energy and, if not installed and used in accordance with the instructions, may cause harmful interference to radio communications. However, there is no guarantee that interference will not occur in a particular installation. If this equipment does cause harmful interference to radio or television reception, which can be determined by turning the equipment off and on, the user is encouraged to try to correct the interference by one or more of the following measures:

- Reorient or relocate the receiving antenna.
- Increase the separation between the equipment and receiver.
- Connect the equipment into an outlet on a circuit different from that to which the receiver is connected.
- Consult the dealer or an experienced radio/TV technician for help.

Any Changes or modifications not expressly approved by the party responsible for compliance could void the user's authority to operate the equipment.