

# REDMOND

Coffee Maker

SkyCoffee RCM-M1509S-A

User manual

A1

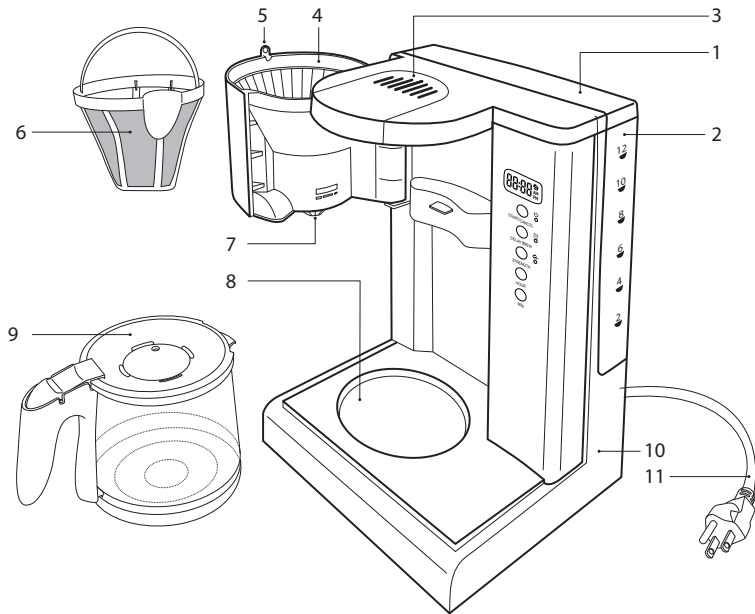

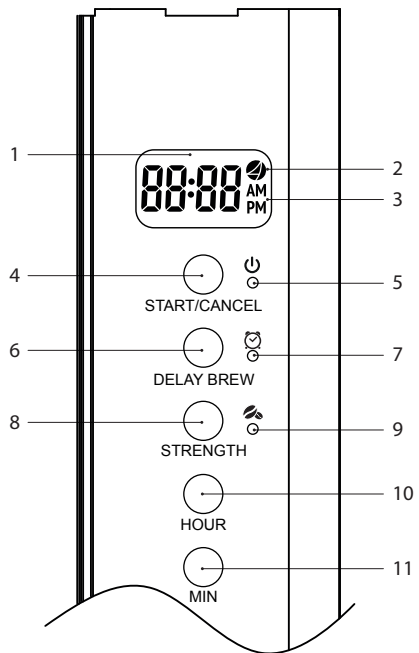

# CONTENTS

IMPORTANT SAFEGUARDS .....	5
READ ALL INSTRUCTIONS .....	5
SAVE THESE INSTRUCTIONS FOR HOUSEHOLD USE ONLY .....	7
Technical characteristics.....	8
Package contents .....	9
Parts of the appliance .....	9
Control panel with display .....	9
I. PRIOR TO THE FIRST USE.....	9
II. USING THE APPLIANCE.....	9
Ready for Sky Technology.....	9
Bluetooth function .....	10
To adjust the current time.....	10
Time Delay.....	10
"Strength" function.....	11
Coffee brewing .....	11
III. CLEANING AND MAINTENANCE .....	12
Storage and transportation .....	12
IV. BEFORE CONTACTING SERVICE CENTRE.....	12



*Carefully read all instructions before operating the unit and save them for future reference. By carefully following these instructions you can considerably prolong the service life of your appliance.*

#### NOTE:

This equipment has been tested and found to comply with the limits for a Class B digital device, pursuant to Part 15 of the FCC Rules. These limits are designed to provide reasonable protection against harmful interference in a residential installation. This equipment generates uses and can radiate radio frequency energy and, if not installed and used in accordance with the instructions, may cause harmful interference to radio communications. This device complies with Part 15 of the FCC Rules and Industry Canada licence-exempt RSS standard(s). Operation is subject to the following two conditions: (1) this device may not cause interference, and (2) this device must accept any interference, including interference that may cause undesired operation of the device. However, there is no guarantee that interference will not occur in a particular installation. If this equipment

does cause harmful interference to radio or television reception, which can be determined by turning the equipment off and on, the user is encouraged to try to correct the interference by one or more of the following measures:

- Reorient or relocate the receiving antenna.
- Increase the separation between the equipment and receiver.
- Connect the equipment into an outlet on a circuit different from that to which the receiver is connected.
- Consult the dealer or an experienced radio/TV technician for help.

## IMPORTANT SAFEGUARDS

- When using electrical appliances, basic safety precautions should always be taken including the following:

## READ ALL INSTRUCTIONS

- Do not use the appliance for other than intended use or specified purposes. Failure to follow product

instructions may result in damage that will not be covered by the warranty. The manufacturer is not responsible for the consequences of improper use.

- Before installing the appliance, ensure that its voltage corresponds with the supply voltage in your home (refer to the specifications on the appliance rating plate or technical data). Using a different voltage may result in fire, accident or damage to the appliance.
- When using the extension cord, ensure that its voltage is the same as specified on the appliance. The appliance must be grounded. Ensure that it is connected to a properly grounded power outlet. Failing to do so may result in electric shock. Use only grounded extension cords.

### *CAUTION!*

- While in use the appliance heats up! Do not touch the housing while the appliance is operating.
- Unplug from outlet when not in use and before cleaning. Allow the appliance to cool before putting

on or taking off parts. Never handle the plug with wet hands. Do not pull power cord to disconnect from the outlet; instead, grasp the plug and pull to disconnect.

- Always attach plug to appliance first, then plug cord into the wall outlet. To disconnect, turn any control to “off”, then remove plug from wall outlet.
- Do not let cord hang over edge of table or counter, or touch hot surfaces. Damaged cord may cause a shock, fire, or lead to a failure that will not be covered by the warranty.
- Do not operate any appliance with a damaged cord or plug or after the appliance malfunctions or has been damaged in any manner. Return appliance to the nearest authorized service facility for examination, repair, or adjustment. Any kinds of modifications or adjustments to the product are not allowed. All the repairs should be carried out by an authorized service repair center.

- Never operate the appliance on soft surfaces.
- Do not cover the unit with any cloth or material during operation. Failure to do so may result in overheating or malfunction.
- Do not open the lid of the appliance during the making coffee.
- Do not use outdoors.
- Follow cleaning and general maintenance guidelines when cleaning the unit.
- To protect against electrical shock do not immerse cord, plugs, or appliance in water or other liquids. Do not wash the device under running water.
- Close supervision is necessary when any appliance is used by or near children.
- This appliance can be used by children aged 8 years and older and people with reduced physical, sensory, or mental capabilities or lack of experience and knowledge if they have been given supervision or instruction concerning use of the appliance in

a safe way and understand the hazards involved. Children shall not play with the appliance. Keep the appliance, its cord, and all packaging materials out of reach of children aged less than 8 years. Cleaning and user maintenance shall not be made by children without supervision.

- The use of accessory attachments not recommended by the appliance manufacturer may cause injuries.
- Do not place the appliance on or near a hot gas, an electric burner, or in a heated oven.

## SAVE THESE INSTRUCTIONS FOR HOUSEHOLD USE ONLY

### *CAUTION!*

- If a longer detachable power-supply cord or extension cord is used:
- The marked electrical rating of the cord set or extension cord should be at least as great as the

electrical rating of the appliance. Using different voltage may result in a fire or other accident, causing the device damage or shorting the circuit.

- The cord should be arranged so that it will not drape over the countertop or tabletop where it can be pulled on by children or tripped over unintentionally.
- If the appliance is of the grounded type, the extension cord should be a grounding-type 3-wire cord.

**WARNING!**

- Changes or modifications to this unit not expressly approved by the party responsible for compliance could void the user's authority to operate the equipment.

**Technical characteristics**

Model.....	SkyCoffee RCM-M1509S-A
Power.....	1000 W
Voltage.....	120 V, 60 Hz
Electrical safety.....	class I
Type of coffee maker.....	drip
Type of control.....	electronic
Remote control.....	Ready for Sky technology
Housing material.....	plastic / stainless steel
Carafe material.....	heat-resistant glass / plastic
Filter.....	removable
Water tank capacity.....	1.6 Qt (1.5 L)
Carafe capacity.....	1.6 Qt (1.5 L)
Use of paper filters.....	yes
Display.....	LCD
Continuous operation time.....	up to 40 min
Data communication protocol.....	Bluetooth v4.0
Devices enabled:	
Supported operating systems.....	iOS, Android
Carafe reheating.....	yes
Auto shut-off.....	yes
Strength adjustment.....	yes
"Anti-drip" function.....	yes
Overheat protection.....	yes
Time Delay function.....	yes
Overall dimensions.....	8.5 × 8.5 × 13.1 in (215 × 215 × 332 mm)
Net weight.....	5.3 lb (2.4 kg)
Power cord length.....	2.6 ft (0.8 m)



## Package contents

Coffee maker .....	1 pc.
Carafe .....	1 pc.
Cleaning brush.....	1 pc.
User manual .....	1 pc.
Service booklet.....	1 pc.

*In accordance with the policy of continuous improvement, the manufacturer reserves the right to make any modifications to design, packaging arrangement, or technical specifications of the product without prior notice.*

## Parts of the appliance **A1**

1. Water tank lid
2. Removable water tank with graduated scale
3. Steaming outlets
4. Filter holder
5. Fixator of filter holder
6. Removable filter with handle
7. Coffee spout with spill protection
8. Metal plate for carafe reheating
9. Coffee carafe
10. Housing with power cord storage compartment
11. Power cord

## Control panel with display **A2**

1. Current time/Time Delay indicator
2. Connection to Ready for Sky application indicator
3. 12-hour time format indicators

4. "Start/Cancel" button
5. Cooking indicator
6. "Delay brew" button
7. Time Delay function indicator
8. "Strength" button
9. Strength adjustment indicator
10. "Hour" button
11. "Min" button

## I. PRIOR TO THE FIRST USE

Carefully take the appliance and its detachable parts out of the package. Remove all wrapping materials and stickers except for the serial number identification sticker.



*The absence of the serial number identification sticker on the appliance automatically disables the user's right to aftersales service.*

*After the appliance transportation or storage at low temperature keep it at room temperature for at least two hours before plugging in.*

Wipe the housing with a moist cloth. Rinse the removable parts with warm water, let dry properly before plugging in.

## II. USING THE APPLIANCE

### Ready for Sky Technology

The Ready for Sky technology enables to use the software app of the same name to control the appliance remotely from a smartphone or tablet.

1. Enable the Bluetooth function on the electric kettle (see «Bluetooth function»).



*The remote control of the coffeemaker SkyCoffeemaker RCM-M1509S-A is only possible when the Bluetooth function is on.*

2. Download the software from the App Store or Google Play (depending on your operating system) onto your smartphone or tablet.



*For the minimum supported OS version, see the company's official website [www.redmond.company](http://www.redmond.company) or the application description at the App Store and Google Play.*

3. Start the Ready for Sky app, create an account, and follow the prompts appearing on the screen.
4. To the standby mode press and hold down "Hour" button until three audible signals are heard.  indicator will light up on display.



*After connection is made the indicator will light up constantly. If within 10 seconds connection won't be made, the appliance will switch to the standby mode.*

5. To disable remote control press and hold the "Min" button until the longer sound signal.



*To provide a stable connection, your mobile device should be located no more than 49 ft 15 (meters) away from the appliance.*

### Bluetooth function

1. Press and hold down the "Strength" button for 3 seconds on the control panel of the coffeemaker.
2. The changing symbols and will be displayed during connection on the coffeemaker display. After the connection is made an audible signal will be heard and appliance will switch to the standby mode.

### To adjust the current time

1. Plug in the appliance. An audible signal will be heard, the default time value will be displayed (12:00).
2. To change the time value press and hold down the "Delay brew" button. The hour value on display will start flashing.
3. To set the hour value press HOUR, minute value – press MIN. Press and hold the corresponding button to scroll through the digits. The hour value changes irrespective of the minute value. After the maximum value is reached the adjustment starts again.
4. After setting is complete do not press the buttons on the panel for 5 seconds. Settings will be saved automatically.



*The default time value is displayed in 24-hour format. To switch the clock into 12-hour format in the current time setting mode simultaneously press and hold "Hour" and "Min" buttons. The current time value in 12-hour format and AM or PM indicators will be displayed.*

*The REDMOND coffee maker SkyCoffee RCM-M1509S-A does not have non-volatile memory, that's why in case of the temporary disconnection from the power supply it's necessary to readjust the clock.*

### Time Delay

The time delay function allows setting the start time of making the drink.



1. To switch to the time delay setting mode to the standby mode, repress "Delay brew".  indicator will light up solid, the hour value on display will start flashing.

- To set the hour value press HOUR, minute value – press MIN. Press and hold the corresponding button to scroll through the digits. The hour value changes irrespective of the minute value. After the maximum value is reached the adjustment starts again.

**i** After 1 minute of idle time, the appliance will switch into the standby mode.



- After the end of adjustment press “Start/Cancel”. The Time Delay function will start its operation.

**i** During the operation of the function the current time value is displayed. To see the set Time Delay value, press “Hour” or “Min”.

- After the end of the function operation the appliance will make three audible signals,  indicator will go out. The drink-making process will start.
- To disable the Time Delay function repress “Start/Cancel”. A long audible signal will be heard,  indicator will go out, the appliance will switch to the standby mode.

### “Strength” function

This function allows to increase the intensity of the ready drink. The hot water is supplied into the filter with coffee by 10 second periods with 10-second breaks during the function operation. Thanks to that the flavour and aroma of the ready drink become more intense.

To enable the function in any mode of the appliance operation press “Strength” button.  indicator will light up on the panel. To disable the function repress the “Strength” button,  indicator will go out.

**i** It is not recommended to use the strength adjustment button when making more than 10 cups of coffee as it may lead to the appliance overheating.

### Coffee brewing

- Open the lid of the water tank and remove it by pulling upwards by the handle. Fill the tank with clear water. Fill the tank with clean cold water not exceeding the maximum mark and install it to the housing until tight. Close the lid.
- Open the filter holder by pulling it by the lock to the left. Install the removable filter into the filter holder. Add the ground coffee into the filter so that no less than a half of the container was empty. Set the filter holder into the working position, by turning it to the right until it clicks.



It is not recommended to tamp ground coffee in the filter. Use medium ground coffee, suitable for the drip coffee makers. When making coffee from beans of different grinding, the filter filling degree may be slightly different.

- Set the carafe onto the metal plate for heating. Plug in the appliance.
- To brew coffee in the automatic mode press the  indicator will light up.
- After water tank is empty, the appliance will finish operation in coffee making mode and switch to the mode of keeping the ready drink warm.
- After the end of operation the appliance will make three audible signals and switch into the standby mode, the indica-

tion will go out. To turn the appliance into the standby mode manually, press "Start/Cancel".

## III. CLEANING AND MAINTENANCE

Before cleaning please make sure the appliance is unplugged and has cooled down.

**STOP** *DO NOT wash the appliance under running water, immerse into water or wash in dishwasher.*

*DO NOT use abrasives and chemically aggressive substances, sponges with hard coating when cleaning the appliance.*

Removable parts under running warm water after each use. Soft detergent can be used. Clean the housing and metal plate for reheating when required.

During operation, depending on the composition of usable water, oxide spots and scale can appear on the heating element and inner walls of the appliance. To remove it use special nonabrasive cleansers for scale cleaning and removal from kitchen appliances.

### Storage and transportation

Before repeated operation or storage completely dry all parts of the appliance. Store the assembled appliance in a dry, ventilated place away from heating appliances and direct sunlight. During transportation and storage, do not expose the device to mechanical stress, that may lead to damage of the device and/or violation of the package integrity.

Keep the device package away from water and other liquids.

## IV. BEFORE CONTACTING SERVICE CENTRE

Problem	Possible cause	Solution
Pump makes noise	Empty water tank	Fill the water tank
Water doesn't flow through	Empty water tank	Fill the water tank
	The appliance wasn't properly cleaned after last use	Check the appliance cleaning according to recommendations of the section "Cleaning and maintenance"
	The appliance is heavily clogged	
	You use coffee of too fine grinding	We recommend you to use ground coffee, intended for use in the coffee-makers of this type
Water runs too fast	Coffee in the filter is too tamped	When adding coffee to the filter do not apply too much force
	Coffee is too coarsely ground	Try to use fine ground coffee
Appliance doesn't function	There isn't enough ground coffee in the filter	Put more ground coffee into the filter next time
	Appliance is not plugged in	Plug in the appliance to the working outlet
Plastic odour appeared during operation	There is no power supply in the electrical outlet	
	Appliance is new, the smell comes out of protective cover	The smell will disappear after a few uses
Synchronization attempt failed	Bluetooth function on the mobile device is disabled	Enable Bluetooth function on the mobile device
	Ready for Sky app on the mobile device is deactivated	Run the Ready for Sky app on the mobile device
	Sync devices are located too far	Ensure devices are located within 49 ft (15 meters) from each other

Problem	Possible cause	Solution
The connection with mobile device is broken	When removing the lid the coffee-maker power is cut off, that leads to connection breakdown with mobile device	To resume the connection set the lid into place and reselect the appliance in the mobile app

*The packaging, user manual and the device itself may not be treated as household waste. Instead, it shall be taken to the applicable collection point for the recycling of electrical and electronic equipment.*

**Bluetooth** is the registered trademark of Bluetooth SIG, Inc.

**App Store** is the service mark of Apple Inc., registered in the USA and other countries.

**Google Play** is the registered trademark of Google Inc.



Manufacturer: GOTECH ELECTRIC APPLIANCE CO., LTD.

Address: No.3, Xinfanan road, Huangpu town, Zhongshan city, Guangdong, 528429, China.

© REDMOND. All rights reserved. 2019.

Reproduction, transfer, distribution, translation or other reworking of this document or any part thereof without prior written permission of the legal owner is prohibited.

