

## SPEAKER LANTERN

### **Product specification**

Brand Name:Speaker lantern

Use:Home Theatre, Mobile Phone, Portable Audio Player

Special Feature:Portable, Wireless

Place of Origin:Dongguan, China (Mainland)

Product name:SPEAKER LANTERN

Wireless:Version 4.2

Speaker:3W

Battery:2400mah

Playing time:4-6hours

Frequency:20hz-20khz

Distance:10M

Products size:95\*95\*194cm

Function:BT, TF card, Aux-in, FM, LED Lantern



## WIRELESS RECHARGEABLE LANTERN SPEAKER

Wireless speaker lantern provides deep rich sound and powerful LED light in a compact portable size that goes anywhere. Connects to smartphones, tablets, computers or other compatible. Audio devices via Bluetooth or auxiliary 3.5mm input

LED lantern shines ght 360 degrees and dims with the press of a button .USB rechargeable battery for up to 6 hours of light and 4 hours of music.Integrated microphone for answering incoming calls. IPX4 water resistance for added protection in wet environments

For your Iphone, Pad, Android device, computer and other Bluetooth enabled electronics. Auxiliary cable, USB charging cable and instruction manual included .

### Package Includes:

- 1 x Product
- 1 x Micro-USB Cable
- 1 x Aux-in cable
- 1 x User Manual

Front View



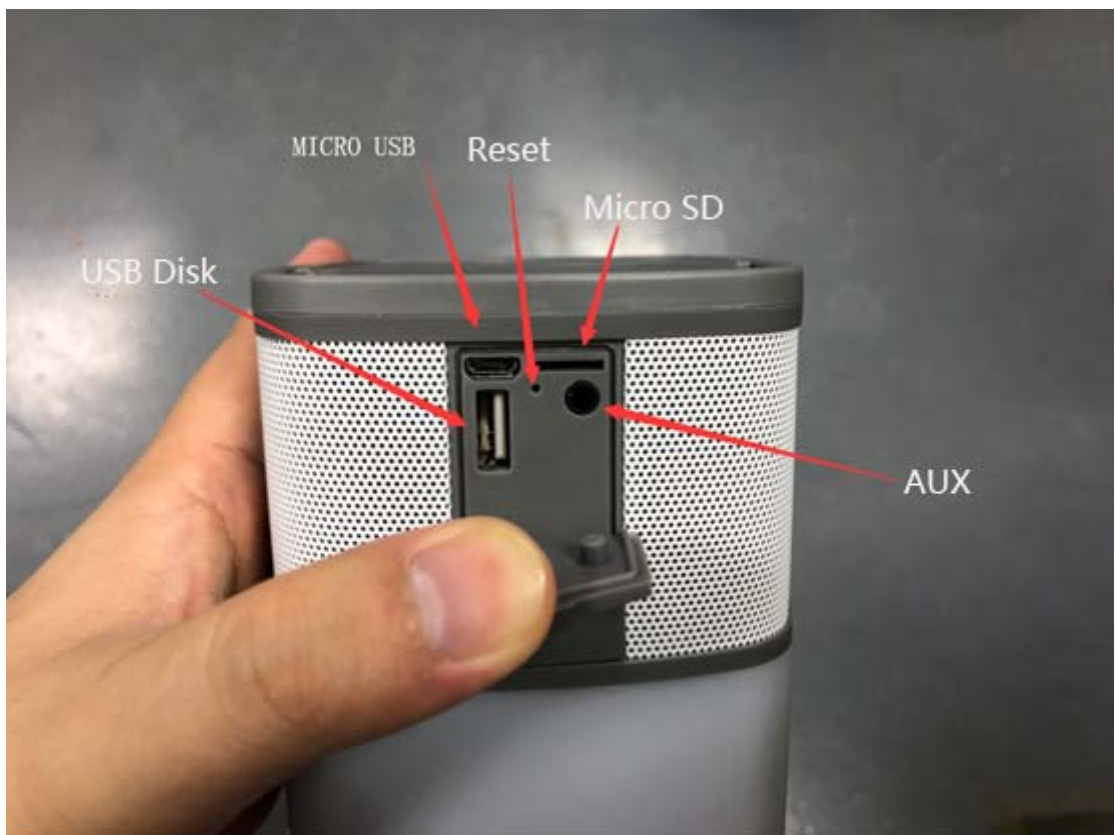
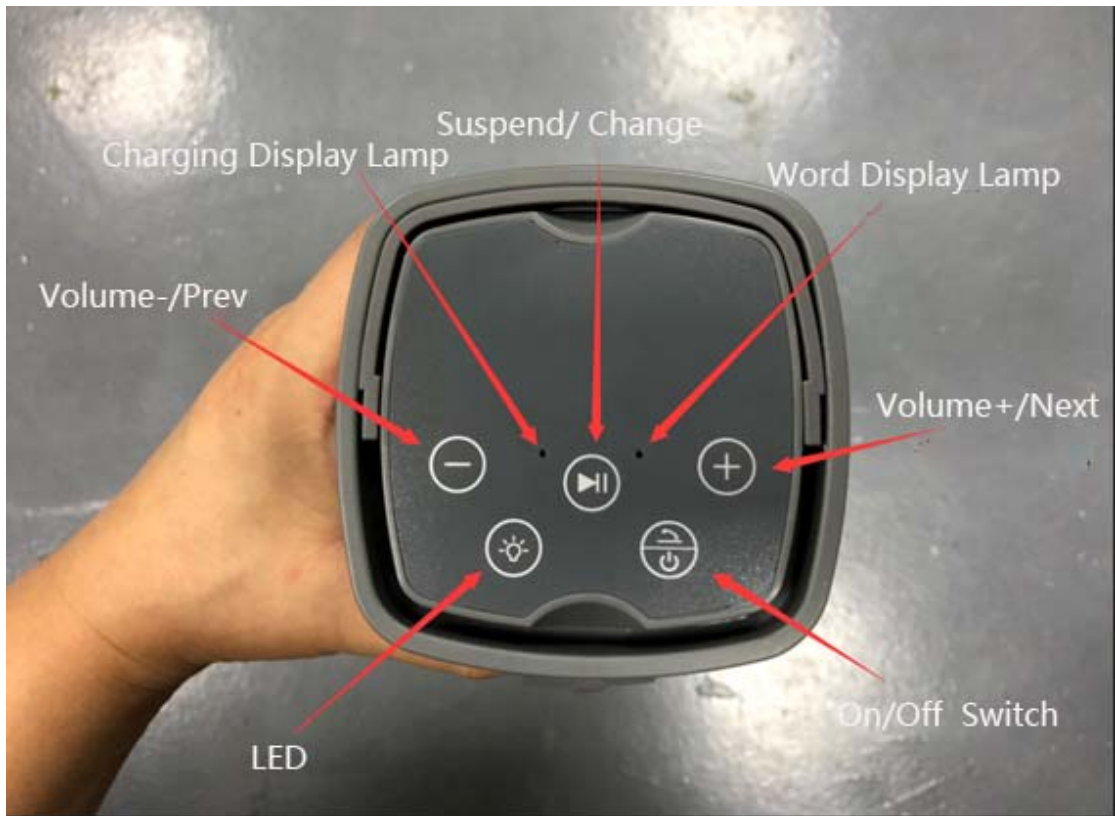



**FCC Caution:**

Any Changes or modifications not expressly approved by the party responsible for compliance could void the user's authority to operate the equipment.

This device complies with part 15 of the FCC Rules. Operation is subject to the following two conditions: (1) This device may not cause harmful interference, and (2) this device must accept any interference received, including interference that may cause undesired operation.

**IMPORTANT NOTE:**

Note: This equipment has been tested and found to comply with the limits for a Class B digital device, pursuant to part 15 of the FCC Rules. These limits are designed to provide reasonable protection against harmful interference in a residential installation. This equipment generates, uses and can radiate radio frequency energy and, if not installed and used in accordance with the instructions, may cause harmful interference to radio communications. However, there is no guarantee that interference will not occur in a particular installation. If this equipment does cause harmful interference to radio or television reception, which can be determined by turning the equipment off and on, the user is encouraged to try to correct the interference by one or more of the following measures:

- Reorient or relocate the receiving antenna.
- Increase the separation between the equipment and receiver.
- Connect the equipment into an outlet on a circuit different from that to which the receiver is connected.
- Consult the dealer or an experienced radio/TV technician for help.

**FCC Radiation Exposure Statement:**

This equipment complies with FCC radiation exposure limits set forth for an uncontrolled environment.

This transmitter must not be co-located or operating in conjunction with any other antenna or transmitter.