

DISCO BALL SPEAKER

SG-1765

Product Instruction Manual

Please read carefully prior to use.



Includes Disco Ball Speaker
 1.5m Auxiliary cord and
 USB charging cable

For your iPhone, iPad™,
 Android™ phone or tablet device
 (iPhone and Android™) use the
 the App Store™ and Google Play™.



Please call customer
 service at **1-800-254-0111**
 with any questions

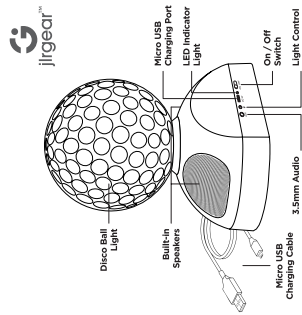

- Features**
- Global LED disco light show, rotate and streams music for an instant party anywhere
 - Manual and automatic controls for color, hue, saturation, and brightness
 - Lights to the beat of the music (automatic mode to move the lights to the beat of the music)
 - Control from your iPhone™ or ANDROID™ device with the free app download

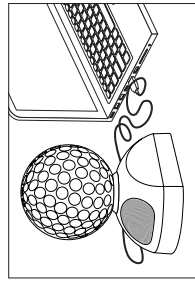

- Operating Instructions**
1. Connect micro USB charging cable (included) to charging port on speaker and any USB power source including computer USB ports (not recommended for extended use).
 2. Charge for approximately 2 to 3 hours or until LED indicator light turns off.
 3. Disconnect and switch speaker on to test.
- Pairing the SG Party Speaker**
1. Turn on speaker. Speaker will sound indicating that it is in pairing mode.
 2. Enter your device's Bluetooth® settings to pair with speaker.
 3. Search for new devices and connect to SG Party Speaker. Speaker will sound indicating that it is in pairing mode.
 4. Play music via your device's music player or using the SG Party Speaker app.

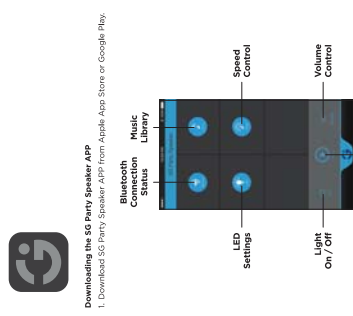

- Downloading the SG Party Speaker APP**
1. Download SG Party Speaker APP from Apple App Store or Google Play.
 2. Open APP on mobile device and follow the prompts to allow access to your device's music library.

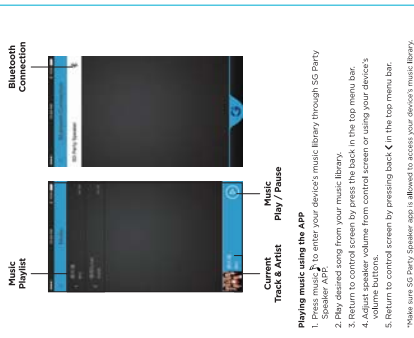

- Playing music using the APP**
1. Tap on 'Music Playlist' to enter your device's music library through SG Party Speaker APP.
 2. Play desired song from your music library.
 3. Return to control screen by press the back in the top menu bar.
 4. Adjust speaker volume from control screen or using your device's volume control.
 5. Return to control screen by pressing back in the top menu bar.
- *Make sure SG Party Speaker app is allowed to access your device's music library.

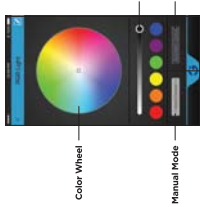

- Preset Colors**
- APP Disco Ball Light Controls**
1. Turn disco ball light on by pressing the power button in lower left of the app screen.
 2. Press LED button in the control screen to customize the lighting effects.
 3. Change to manual control in APP to customize colors beyond the presets.
 4. Press the desired function on the color wheel to change light to any color.
 5. Adjust light output by using the dimmer slide control below the wheel.
 6. Select from the preset colors below the wheel.
 7. Change to automatic control to cycle through the colors to the beat of the music.
 8. Press the power button to turn off the light.
- Note: The disco ball light will cycle through red, green, or blue light only while the disco ball light glows with music color.

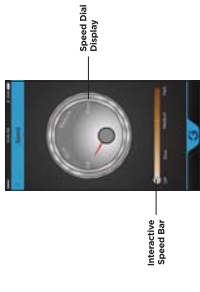

- APP Disco Ball Speed Controls**
1. Press speed button in APP control screen.
 2. Set to slow, medium, fast, or off as desired.
- Please call customer service at **1-800-254-0111** with any questions

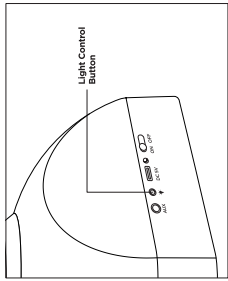

- Using the Light Control Button**
1. Press and hold light control button for 3 seconds to control rotation of the light control button, fast, and off. Light will rotate in a clockwise direction only.
 2. Control pattern and color of the light manually with short presses of the light control button.
- Short press 1:** light cycles through colors.
Short press 2: red breathing light.
Short press 3: red breathing light.
Short press 4: red breathing light.
Short press 5: red breathing light.
Short press 6 thru 12: preset light systems and disco ball colors.
Short press 13: disco ball light turns off.



- Legal Disclaimers**
- Bluetooth® word mark and logos are registered trademarks owned by Bluetooth SIG, Inc. Apple, the Apple logo, iPhone and iPad are trademarks of Apple Inc., registered in the U.S. and other countries. App Store is a service mark of Apple Inc. Android, Google Play and the Google Play logo are trademarks of Google Inc.
- WARNING! IMPORTANT CARE AND SAFEGUARDS**
- DO NOT touch ball while rotating. Preventing rotation could damage the motor.
 - Keep hair and other materials away from the rotating disco ball.
 - DO NOT drop disco ball speaker.
 - Do not use in wet areas.
 - Built-in battery. Please observe all product safety warnings.
- See these instructions on product placement.
- jigear™**
 10150 - 10th Avenue, Fresno, CA 93720
 © 2017 Jigear - Made in China

FCC Disclaimer:
 Changes or modifications not expressly approved by the party responsible for compliance could void the user's authority to operate the equipment. This device complies with the following Federal Communications Commission (FCC) Class B digital device, pursuant to Part 15 of the FCC Rules. These limits are designed to provide reasonable protection against interference with other radio communications. However, there is no guarantee that interference will not occur in a particular installation. If this interference does occur, you may wish to take the following steps: --Reorient or relocate the receiving antenna. --Increase the separation between the equipment and the receiver. --Connect the equipment into an outlet of a circuit different from that to which the receiver is connected. --Consult the dealer or a qualified technician for help. This device complies with part 15 of the FCC rules. Operation is subject to the following two conditions: (1) This device may not cause interference, and (2) this device must accept any interference that may be received, including interference that may cause undesired operation.

IC Disclaimer
 Operation is subject to the following two conditions:
 (1) This device may not cause interference, and
 (2) this device must accept any interference that may be received, including interference that may cause undesired operation of the device. The term "IC" refers to the Industry Canada technical specifications. However, there is no guarantee that interference will not occur in a particular installation. If this interference does occur, you may wish to take the following steps: --Reorient or relocate the receiving antenna. --Increase the separation between the equipment and the receiver. --Connect the equipment into an outlet of a circuit different from that to which the receiver is connected. --Consult the dealer or a qualified technician for help. This device complies with part 15 of the FCC rules. Operation is subject to the following two conditions: (1) This device may not cause interference, and (2) this device must accept any interference that may be received, including interference that may cause undesired operation.