

Wireless 2-Pack Headphone Earbud Set

Product Instruction Manual
Please read carefully prior to use.

Includes headphones, earbuds, USB charging cable and 3.5mm auxiliary cable

Connects to Bluetooth® compatible smart phones, tablets, computer and more
Works with micro SD cards up to 32GB in size



Please call customer service at **1-800-254-0111** with any questions

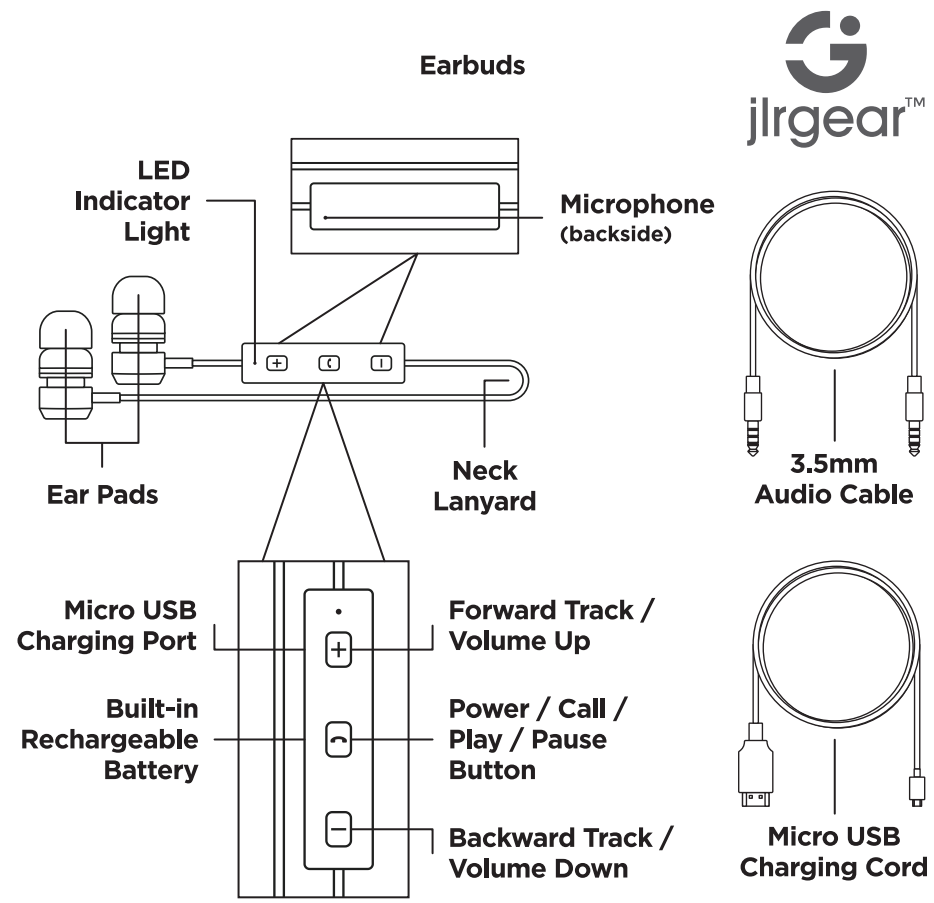
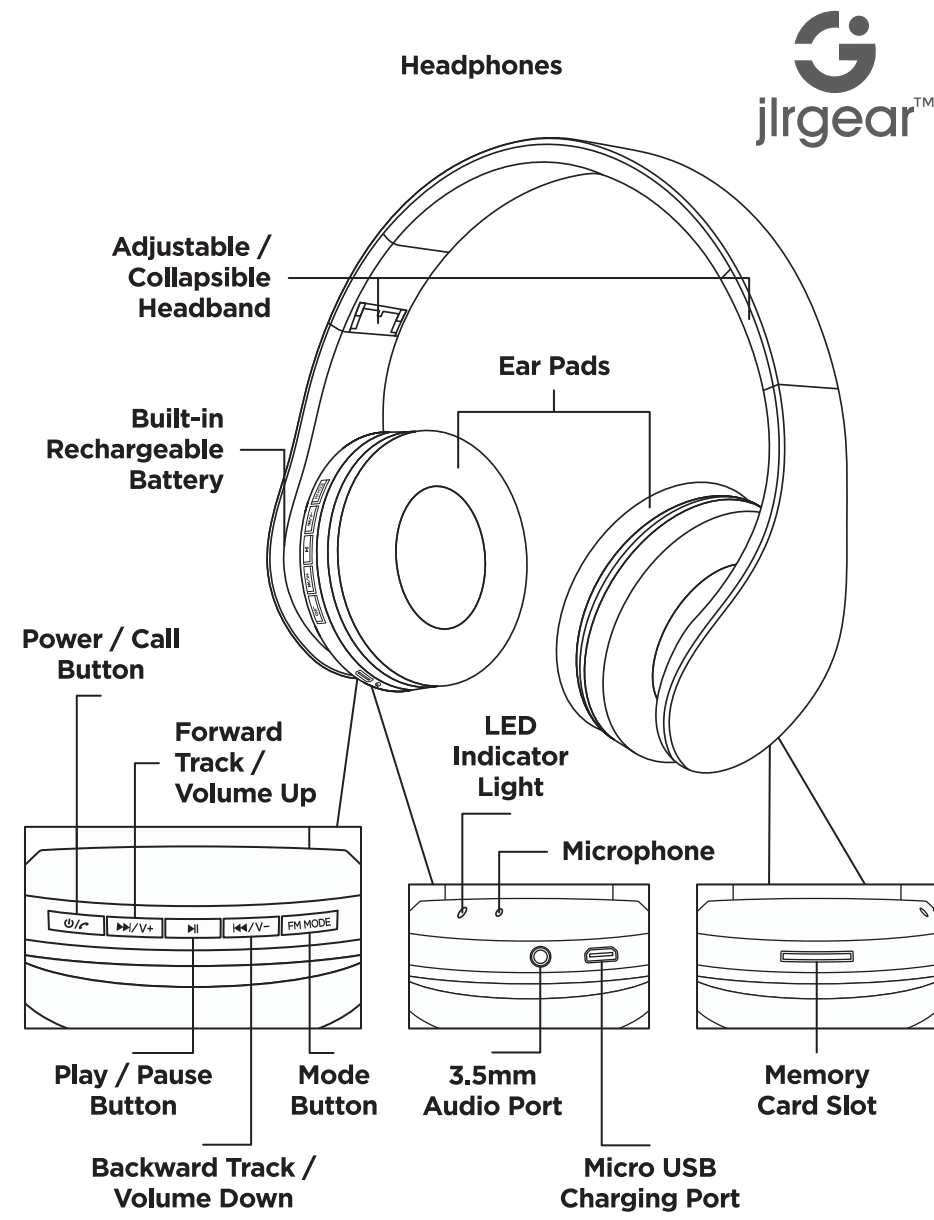

- Features**
- Rechargeable headphones with FM tuner, micro SD card slot, auxiliary input and wireless audio controls
 - Rechargeable earbuds with wireless audio controls
 - Bluetooth® wireless connectivity to smart phones, tablets, computers and other compatible devices
 - Built-in headphone and earbud microphones for voice commands and hands-free phone calls

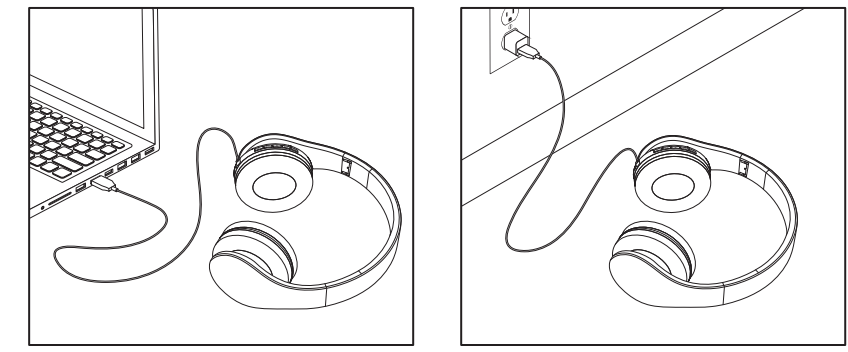

- Charging Instructions Headphones**
1. Connect micro USB charging cord (included) to headphones and USB power source such as a USB wall plug or computer (not included).
 2. Indicator light will illuminate red while charging. Charging is complete once the indicator light turns off. Allow up to 3 hours to charge completely.

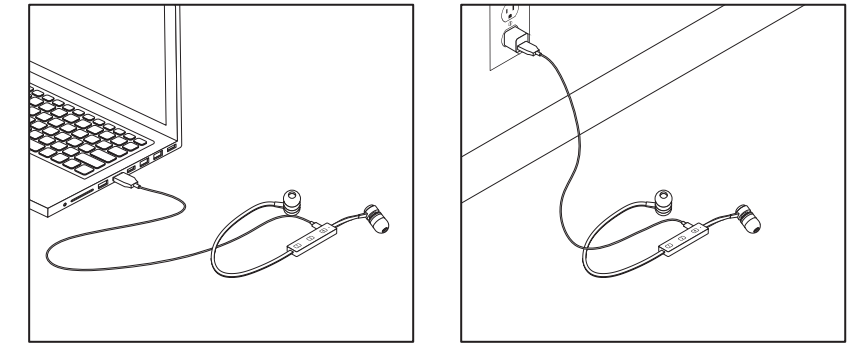

- Earbuds**
1. Connect micro USB charging cord (included) to earbuds and USB power source such as a USB wall plug or computer (not included).
 2. Indicator light will illuminate blue while charging. Allow up to 2 hours to charge completely.

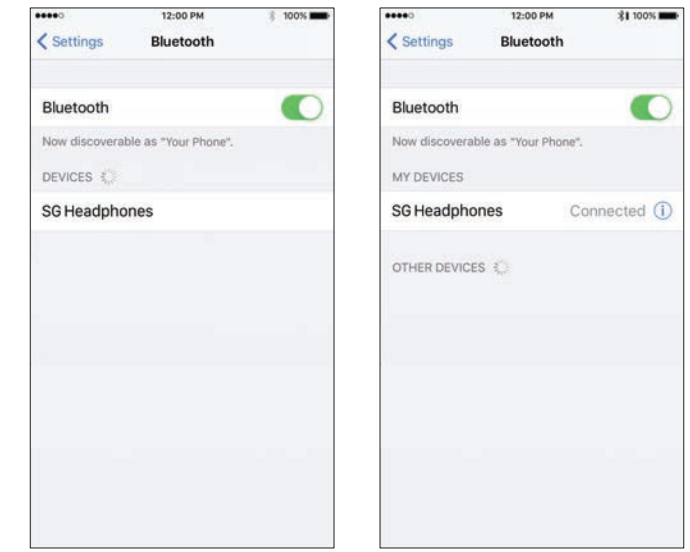

- Operating Instructions Headphones**
1. Turn on headphones by holding power / call button for 3 seconds. Headphones will announce that they are in Bluetooth® mode once they are ready to pair. Indicator light will illuminate blue and will flash quickly.
 2. Connect directly to smartphone, tablet, or computer using the 3.5mm audio cable.
 3. Connect wirelessly with Bluetooth® enabled devices.
 4. Enter Bluetooth® settings on device.
 5. Search for SG Headphones and connect.
 6. Headphones will beep and indicating your device is paired. Indicator light will flash blue slowly while connected and playing music. Device will reconnect automatically after pairing successfully the first time.
 7. Disconnect completely in settings on your mobile device.
 8. Hold power / call button for 3 seconds to power off.

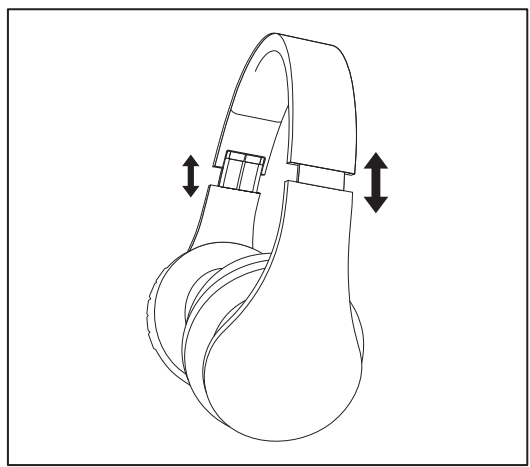

Operating Instructions (Continued)

- Headphones**
9. Adjust headband to fit head size by pulling the ear pads away from the band to extend.

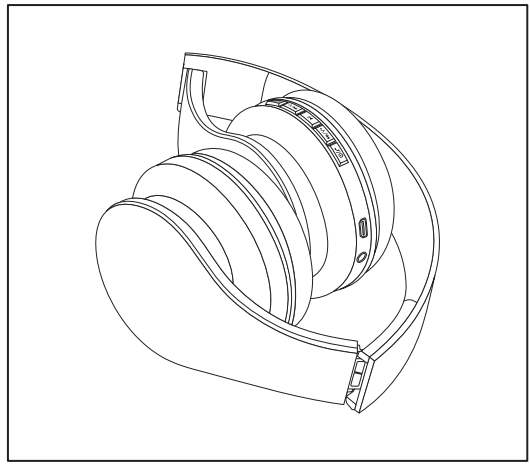

10. Headband folds and collapses for travel and storage.

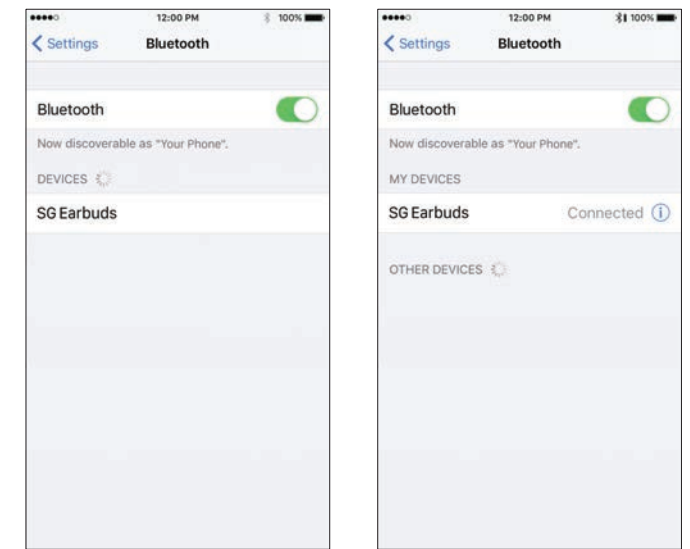

Operating Instructions (Continued)

- Earbuds**
1. Turn on earbuds by holding power / call button for 3 seconds. Earbuds will announce power on once they are ready to pair. Indicator light will flash red and blue.
 2. Connect directly to smartphone, tablet, or computer using the 3.5mm audio cable.
 3. Connect wirelessly with Bluetooth® enabled devices.
 4. Enter Bluetooth® settings on device.
 5. Search for SG Earbuds and connect.
 6. Earbuds will announce that they are connected indicating your device is paired. Indicator light will flash blue slowly once connected. Device will reconnect automatically after pairing successfully the first time.
 7. Disconnect completely in settings on your mobile device.
 8. Hold power / call button for 3 seconds to power off.

*Repeat procedure above if pairing is not successful in 3 minutes and the LED light turns off.

Playing Music

1. Connect to smartphone, tablet, or computer capable of playing music wirelessly via Bluetooth® or 3.5mm audio cable (included).
2. Choose song using desired music player app on your device.
3. Play, pause, select tracks, or adjust music volume on speaker using your device controls or the buttons on the backside of the housing.
4. Hold **>>| / V +** button to raise volume. Press quickly to skip track forward.
5. Hold **|<< / V -** button to lower volume. Press quickly to skip track backwards.

Answering Phone Calls

1. Answer incoming calls by pressing the call button .
2. End active calls by pressing the call button again.
3. Press and hold call button for 3 seconds to reject an incoming call.
4. Speak into the built-in microphone.

Headphones FM Mode and Memory Card Slot

1. Default mode is Bluetooth®.
2. Press mode button to switch from Bluetooth® to FM mode.
3. Tune into your favorite FM radio stations using the **|<< / -** and **>>| / +** buttons.
4. Press mode button again to return to Bluetooth® mode.
5. Insert SD memory card with pre-loaded music (not included) to play music wireless without Bluetooth® enabled device using the headphone controls.

Please call customer service at **1-800-254-0111** with any questions



- Specifications**
- Wireless: Bluetooth® 4.2
 - Wireless Range: 0-30 feet (0-10 meters)
 - Headphone Battery Capacity: 250 mAh
 - Earbuds Battery Capacity: 55 mAh
 - Power Input: DC 5V / 1000 mA (1A)

FCC Disclaimer:
This device complies with part 15 of the FCC Rules. Operation is subject to the following two conditions: (1) This device may not cause harmful interference, and (2) this device must accept any interference received, including interference that may cause undesired operation.
NOTE: THE MANUFACTURER IS NOT RESPONSIBLE FOR ANY RADIO OR TV INTERFERENCE CAUSED BY UNAUTHORIZED MODIFICATIONS TO THIS EQUIPMENT. SUCH MODIFICATIONS COULD VOID THE USER AUTHORITY TO OPERATE THE EQUIPMENT.



Wireless 2-Pack Headphone Earbud Set

Legal Disclaimers
The Bluetooth® word mark and logos are registered trademarks owned by Bluetooth SIG, inc.

- WARNING! IMPORTANT CARE AND SAFEGUARDS**
- Built in rechargeable battery. Maintain battery condition by charging periodically. Dispose of product and battery responsibly.
 - Charge with USB wall plug that is 1000mA (1A) or less to maintain optimal battery condition.
 - Headphones and earbuds should not be stored or used at temperatures below 14°F (10°C) or above 122°F (50°C). Extreme temperatures could shorten battery life.
 - Stop using headphones or earbuds if you experience discomfort, irritation, or have other adverse reactions.
 - Do not submerge headphones or earbuds in water.
 - Keep away from children.

(1)§ 15.19 Labelling requirements.

This device complies with part 15 of the FCC Rules. Operation is subject to the following two conditions: (1) This device may not cause harmful interference, and (2) this device must accept any interference received, including interference that may cause undesired operation.

§ 15.21 Changes or modification warning

Any Changes or modifications not expressly approved by the party responsible for compliance could void the user's authority to operate the equipment.

§ 15.105 Information to the user.

Note: This equipment has been tested and found to comply with the limits for a Class B digital device, pursuant to part 15 of the FCC Rules. These limits are designed to provide reasonable protection against harmful interference in a residential installation. This equipment generates uses and can radiate radio frequency energy and, if not installed and used in accordance with the instructions, may cause harmful interference to radio communications. However, there is no guarantee that interference will not occur in a particular installation. If this equipment does cause harmful interference to radio or television reception, which can be determined by turning the equipment off and on, the user is encouraged to try to correct the interference by one or more of the following measures:

- Reorient or relocate the receiving antenna.
- Increase the separation between the equipment and receiver.
- Connect the equipment into an outlet on a circuit different from that to which the receiver is connected.
- Consult the dealer or an experienced radio/TV technician for help.