

FCC ID: 2AMDTWCDB

This device complies with part 15 of the FCC Rules. Operation is subject to the following two conditions: (1) This device may not cause harmful interference, and (2) this device must accept any interference received, including interference that may cause undesired operation.

To ensure compliance with FCC and ISED RF exposure requirements this device must be installed to provide a minimum of 20cm between the device and people.

The FCC requires the user be cautioned that any changes or modifications made to this device that are expressly approved by Humanscale may void the user's authority to operate the equipment.

Note: This equipment has been tested and found to comply with the limits for a Class B digital device, pursuant to part 15 of the FCC Rules. These limits are designed to provide reasonable protection against harmful interference in a residential installation. This equipment generates, uses and can radiate radio frequency energy and, if not installed and used in accordance with the instructions, may cause harmful interference to radio communications. However, there is no guarantee that interference will not occur in a particular installation. If this equipment does cause harmful interference to radio or television reception, which can be determined by turning the equipment off and on, the user is encouraged to try to correct the interference by one or more of the following measures:

- Reorient or relocate the receiving antenna.
- Increase the separation between the equipment and receiver.
- Connect the equipment into an outlet on a circuit different from that to which the receiver is connected.
- Consult the dealer or an experienced radio/TV technician for help.

IC: 23760-WCDB

This device contains license-exempt transmitter(s)/receiver(s) that comply with Innovation, Science and Economic Development Canada's license-exempt RSS(s). Operation is subject to the following two conditions: 1. This device may not cause interference. 2. This device must accept any interference, including interference that may cause undesired operation of the device.

To ensure compliance with FCC and ISED RF exposure requirements this device must be installed to provide a minimum of 20cm between the device and people.

Pour garantir la conformité aux exigences d'exposition RF de la FCC et d'ISED Canada, cet appareil doit être installé de manière à laisser un minimum de 20 cm entre l'appareil et les personnes.

Cet appareil est conforme aux exigences des États-Unis en matière d'exposition aux ondes radioélectriques, de la FCC et d'ISED Canada. Il est conçu et fabriqué pour ne pas dépasser les limites d'émission imposées pour une exposition à l'énergie de radiofréquence (RF). Pour satisfaire aux exigences de conformité en matière d'exposition aux radiofréquences, les opérations portées sur le corps sont limitées aux pinces de ceinture, étuis ou accessoires similaires ne comportant aucun composant métallique dans l'assemblage et doivent ménager une distance minimale de xx mm entre l'appareil, son antenne, et le corps de l'utilisateur.

Nova

Wireless Charging Desktop Base

Base de chargement de bureau sans fil

INSTALLATION MANUAL / Manuel d'Installation

North America: +1 800 400 0625

Europe: +353 (0)1 858 0910

Asia Pacific: +8522581 0570

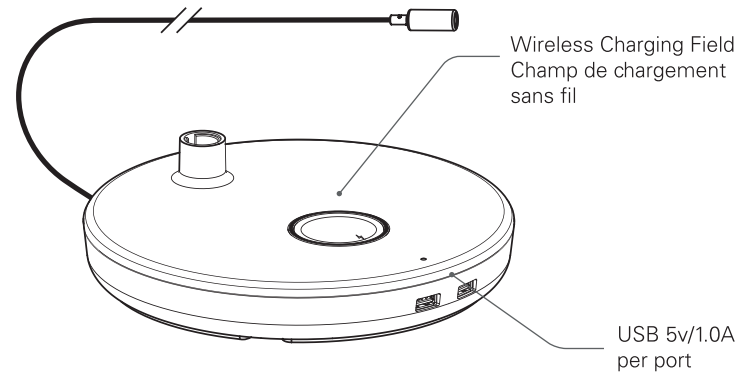

STEP 1

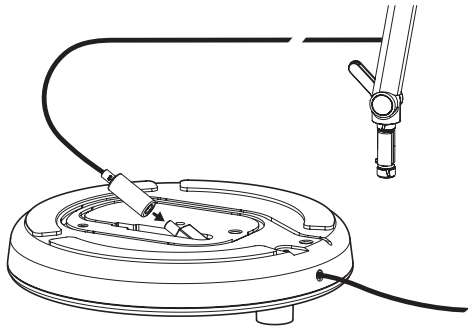

STEP 2

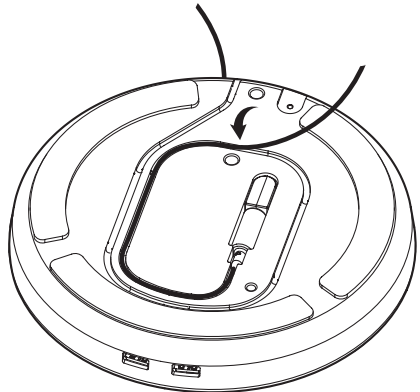

STEP 3

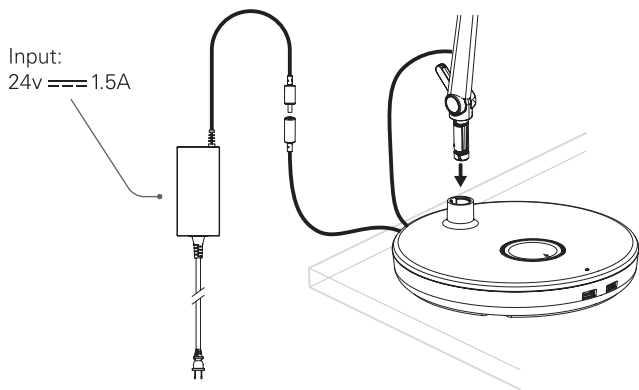

WIRELESS CHARGING / CHARGEMENT SANS FIL

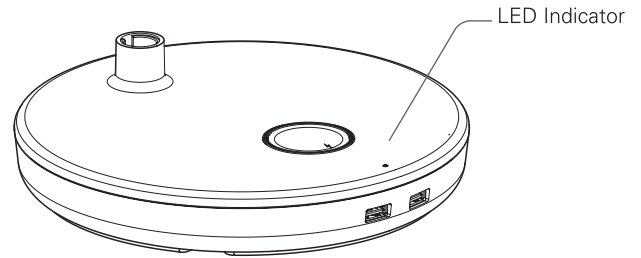

When chargeable device is placed on charging field, white LED will turn on while charging, and turn off* when fully charged. When chargeable is removed, LED will turn off.

*Depending on your phone manufacturer's settings, this may not apply.

Lorsque le dispositif à charger est placé sur le champ de chargement, une DEL blanche s'allumera pendant le chargement et s'éteindra* lorsque le dispositif sera complètement chargé. Lorsque le dispositif est retiré, la DEL s'éteindra.

*Selon les paramètres usine de votre téléphone, ceci pourrait ne pas s'appliquer.



LED Indicator will flash RED if foreign objects are placed on the charging field.

L'indicateur DEL clignotera ROUGE si des objets étrangers sont placés sur le champ de chargement.

CLEANING GUIDELINES / DIRECTIVES DE NETTOYAGE

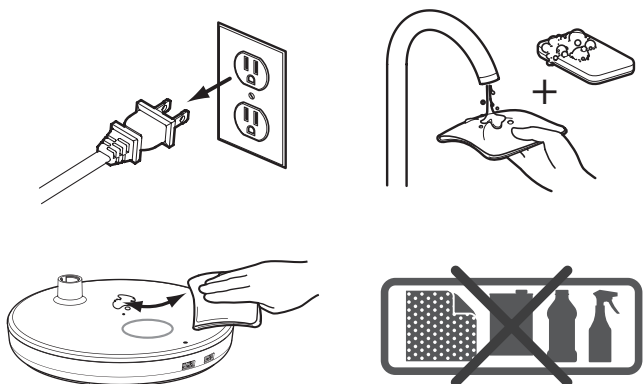

ATTENTION

