



# FREE FLOW

## TRUE WIRELESS ACTIVE HEADSET



User's Manual

BLUETOOTH v.4.2

Thank you for choosing the "Free Flow" True Wireless Active Headset. Please read this User's Manual carefully, before using the Earphones, and please save this Manual for further reference. Before operating, please read all the Safety notices to assure safe and appropriate use.

### Safety Notice:

- Please observe the rules of the Country or Region which you are in, while driving.
- Do not disassemble or modify the headset for any reason, as it may damage or burn the headset.
- Please keep the equipment along with all the accessories out of the reach of children and pets. It can cause suffocation and serious injury.
- Do not use or store this device in an environment where the temperature is too low or too high (Below 30°F or over 110°F).
- Please do not place the device in water, as the liquid can damage to the device.

Contents:  
Bluetooth Earphones  
Padded protective portable charging case  
USB Charging Cable  
Additional Earpieces



Listening at a high volume for a long time may damage your hearing. It is recommended that you use the lowest volume necessary, when speaking and listening to music.

## 1. Guide

### Earphones Introduction

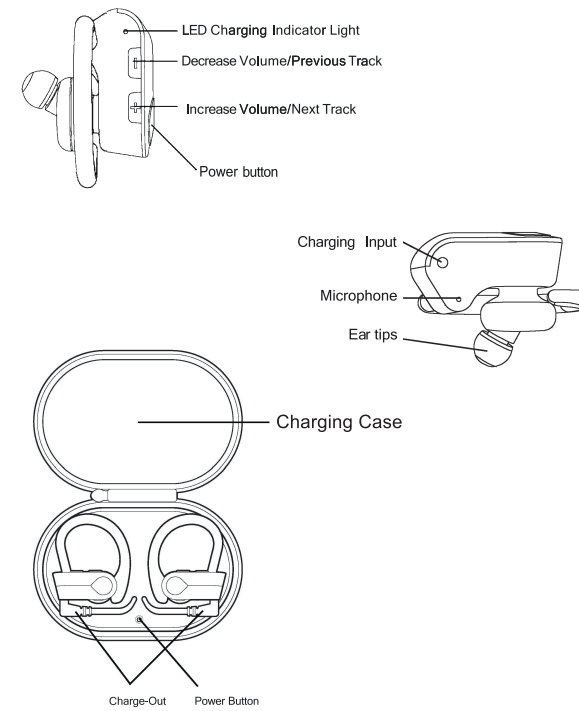

## 2. Instructions

First, make sure Bluetooth is turned on for the device you wish to pair.

### Key Functions

	<b>Power switch</b> Power on: Press and hold the center button on the right headset for about 3 seconds to power on, until the blue and red indicator flashes. Repeat the same process with the left Headset. The right and left Headset will automatically pair to each other. Pairing: Once the Headsets are paired to each other, make sure Bluetooth on your Smartphone/Bluetooth enabled device is turned on. Set the phone to search for the headset and search for the pairing name, "Free Flow" and select it to connect to the device. When paired, indicator light will flash blue. Power off: Press for about 4 seconds to power off.
	<b>Receive/Hang Up Phone Call/Redial</b> When receiving a phone call press the center button to answer the call, press it again to end the phone call. Hold it for 3 seconds to reject the phone call. Press it twice to re-dial the last phone number you called.
	<b>Play/Pause</b> In music mode, press 1 time to pause, and press again to play. (When there is an incoming call, the music will stop.)
	<b>Next Song Volume Increase</b> Press and hold to increase the volume while talking on the phone or in music mode. Short press the button to play the next song.
	<b>Previous song Volume Decrease</b> Press and hold to decrease the volume while talking on the phone or in music mode. Short press the button to play the previous song.

## 3. Product Specifications and Instructions

- Bluetooth Version : V4.2
  - Supported devices: Smartphones and other Bluetooth enabled devices
  - Rechargeable Lithium battery 3.7v
  - Battery capacity of each ear bud 70mAh
  - Play time: up to 4 Hours\*
  - Charging time: 1.5 Hours
  - Maximum working range: 33 Feet (10 Meters)
  - Charging Voltage: DC 5V
  - Input 1A
- \*The actual time may vary from mobile phone types and functions.

### 4. Earphone Charging

- Connect the included USB charging cable to the charging port of the padded protective charging case.
- Insert the other end of the charging cable into a standard USB charging plug in adapter (not included).
- While charging, indicator light will turn Red.
- When fully charged, the red LED indicator will turn off.

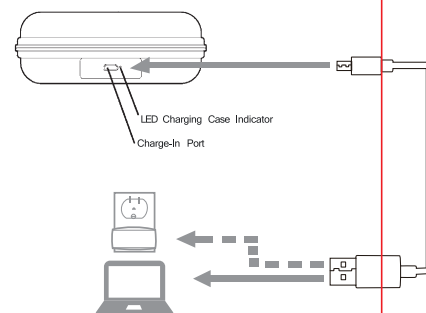

## 5. Charging on the go

To charge on the go, insert the cables from the padded protective portable charging case into the charging input of the wireless earphones. Press the power button on the charging case to begin charging. The charging case can charge the headsets up to 2 full times.

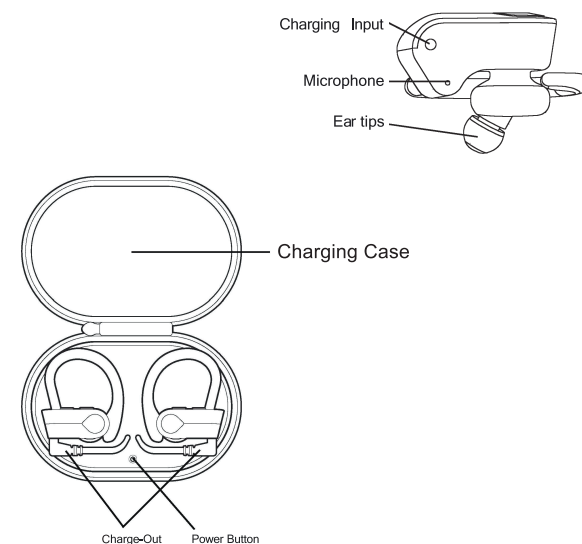

## Important Points

- Make sure the earphones are in pairing mode and your smartphone/Bluetooth enabled device has Bluetooth powered on and connected properly before using.
- Make sure the earphones are charged before using.
- Make sure the portable charging case is pre-charged before plugging in the earphones to charge.
- Keep the earphones and portable charging case away from extreme temperatures and water.

FCC ID :2AM08EP-015R

NOTE: This equipment has been tested and found to comply with the limits for a Class B digital device, pursuant to Part 15 of the FCC Rules. These limits are designed to provide reasonable protection against harmful interference in a residential installation. This equipment generates, uses and can radiate radio frequency energy and, if not installed and used in accordance with the instructions, may cause harmful interference to radio communications.

However, there is no guarantee that interference will not occur in a particular installation. If this equipment does cause harmful interference to radio or television reception, which can be determined by turning the equipment off and on, the user is encouraged to try to correct the interference by one or more of the following measures:

- Reorient or relocate the receiving antenna.
- Increase the separation between the equipment and receiver.
- Connect the equipment into an outlet on a circuit different from that to which the receiver is connected.
- Consult the dealer or an experienced radio/TV technician for help.

The device has been evaluated to meet general RF exposure requirement. The device can be used in portable exposure condition without restriction.

Warning: Changes or modifications to this unit not expressly approved by the party responsible for compliance could void the user's authority to operate the equipment.

This device complies with Part 15 of the FCC Rules. Operation is subject to the following two conditions :  
(1) this device may not cause harmful interference, and  
(2) this device must accept any interference received, including interference that may cause undesired operation.