



5.0

CONFIDENTIAL ARTWORK

DESIGNER: JERMAINE BLUM  
COMPANY: BOOMIE | AFH INDUSTRIES  
MODEL#: 14220

PRODUCT: UNIVERSAL AIR 2 MANUAL

SPEC INFORMATION

- DIELINE
- DIE CUT
- DIE FOLD

0-100% K

PACKAGED TYPEFACES | FONT

OSWALD DEMBOLD  
OSWALD MEDIUM  
OSWALD EXTRA LIGHT  
HELVETICA  
HELVETICA DOLD

CROP SIZE OF DIELINE

240mm x 135mm (9.4517" x 5.332")

PAPER | SUBSTRAT

SCALE: 100%  
SIZE: W H  
PAPER STOCK: 80g GlossPaper  
INK: CMYK

NOTES & REFERENCES

MOCK UP REFERENCE

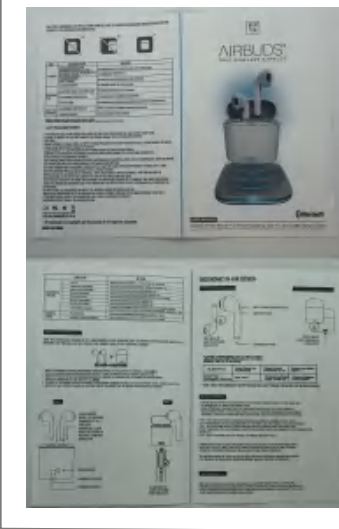

# DOUBLE SIDED PRINT

## AIRBUDS STYLE# 14230 & 14231 - MAGNETIC VERSION (5/20/2020) CVS PDQ BUNDLE

UNIT	LED INDICATION	MEANING
AIRBUDS	LED FLASHES RED/BLUE AFTER HOLDING MF BUTTON FOR 3 SECONDS.	THE AIRBUDS HAVE JUST POWERED ON AND ARE IN PAIRING MODE.
	LED FLASHES RED AFTER HOLDING MULTI-FN. BUTTON FOR 3 SECONDS.	THE AIRBUDS ARE POWERING OFF.
	LED FLASHES RED ONCE EVERY 5 SECONDS.	THE UNIT HAS LOW POWER AND SHOULD BE RECHARGED.
	LED GLOWS SLOW RED.	THE AIRBUDS AND/OR CASE ARE CHARGING.
CHARGING CASE	LED DOES NOT DISPLAY ANY COLORS/LIGHT.	THE AIRBUDS AND CASE ARE FULLY CHARGED.
	LED ILLUMINATES AND STAYS BLUE	THE CHARGING CASE IS CHARGING YOUR AIRBUDS.
WIRELESS CHARGER	LED FLASHES RED	THE CHARGING CASE IS CHARGING VIA WIRELESS CHARGER OR MICRO-USB CABLE.
	LED ILLUMINATES AND STAYS BLUE	WIRELESS CHARGER IS CHARGING AIRBUDS CASE OR DEVICE.
WIRELESS CHARGER	LED GLOWS SLOW RED.	WIRELESS CHARGER IS NOT CHARGING.

\*WIRELESS CHARGER INCLUDED WITH THE AIRBUDS® BUNDLE  
\*YOUR DEVICE MUST HAVE WIRELESS CHARGING FEATURE IN ORDER TO USE WITH BOOMIE WIRELESS CHARGER.

ONE STEP-CHARGING: JUST PLACE YOUR AIRBUDS CASE OR WIRELESS CHARGING-ENABLED DEVICE IN THE CENTER OF THE INCLUDED CHARGING PAD.



FUNCTION	ACTION	
BLUETOOTH CALLING	CALLER ID ANSWER A CALL (DUAL MODE)	WHEN RECEIVING AN INCOMING CALL, THE NUMBER WILL BE READ ALOUD. PRESS THE MULTIFUNCTION BUTTON ON EITHER SIDE WHILE RECEIVING A CALL.
	ANSWER A CALL (SINGLE MODE)	PRESS AND HOLD THE MULTIFUNCTION BUTTON DURING A CALL.
	END A CALL (DUAL MODE)	PRESS EITHER SIDE'S MULTIFUNCTION BUTTON ONCE DURING A CALL.
	REJECT/IGNORE A CALL	PRESS AND HOLD THE MULTIFUNCTION BUTTON ON EITHER SIDE FOR 1-2 SECONDS.
	END A CALL (SINGLE MODE)	PRESS THE MULTIFUNCTION BUTTON ONCE DURING A CALL.
	TO RETRIEVE THE LAST NUMBER IN YOUR SMARTPHONE'S CALL HISTORY, DOUBLE-CLICK THE MULTIFUNCTION BUTTON ON THE RIGHT OR LEFT AIRBUDD. THE NUMBER WILL AUTOMATICALLY DIAL.	
	LAST NUMBER CALLBACK	
MUSIC & AUDIO	PLAY OR PAUSE	PRESS THE MULTIFUNCTION BUTTON ONCE AIRBUDS ARE PAIRED TO A DEVICE.
	VOLUME & PLAYLIST CONTROLS	USE YOUR PAIRED DEVICE (SUCH AS A SMARTPHONE OR TABLET) TO CONTROL.

### SAFETY PRECAUTIONS/WARNINGS

FOR WIRELESS CHARGING, AVOID OVERHEATING AIRBUDS BY USING A Qi-CERTIFIED WIRELESS CHARGER.

IF YOU HAVEN'T USED YOUR AIRBUDS IN A WHILE OR PLAN TO GO LONG PERIODS OF TIME WITHOUT USING THEM, BE SURE TO CHARGE THE UNIT ONCE A MONTH TO PREVENT DAMAGE TO THE LITHIUM-ION BATTERIES OVER TIME. DO NOT ATTEMPT TO PIERCE, STRIKE, OR APPLY STRONG PRESSURE WITH SHARP OR HEAVY OBJECTS. STRONG IMPACT OR SHOCKS COULD CAUSE IRREVERSIBLE DAMAGE TO THE UNIT.

AVOID PROXIMITY TO HIGH FREQUENCIES AND STRONG MAGNETIC DEVICES WHEN POSSIBLE. DROPPING OR MISHANDLING THE AIRBUDS MAY CAUSE IRREPARABLE DAMAGE TO THE UNIT AND ITS BATTERIES. DO NOT EXPOSE TO OR SUBMERGE IN WATER.

KEEP EARBUDS AWAY FROM HEATING APPLIANCES AND SOURCES OF ELECTRICAL NOISE, SUCH AS FLUORESCENT LAMPS OR MOTORS. KEEP HANDS DRY AND CLEAN WHEN TOUCHING THE EARBUDS AND BUTTONS. KEEP THE EARBUDS AWAY FROM SMALL CHILDREN AT ALL TIMES OR ENSURE STRICT SUPERVISION BY AN ADULT AT ALL TIMES. THE UNIT CONTAINS SMALL PARTS AND MAY POSE A CHOKING HAZARD. DO NOT EXPOSE THE EARBUDS OR ANY ELECTRICAL PARTS TO EXTREMELY HIGH OR EXTREMELY LOW TEMPERATURES OR HIGH PRESSURE. DO TO EXPOSE THE EARBUDS OR CASE TO FIRE, DIRECT SUNLIGHT, DUST, HIGH LEVELS OF HUMIDITY, OR OTHER HOT LOCATIONS. THIS MAY CAUSE THE BATTERY TO GENERATE HEAT, IGNITE, OR EXPLODE. USING THE EARBUDS OR CHARGING CASE IN THIS MANNER MAY ALSO RESULT IN A LOSS OF PERFORMANCE IN A SHORTENED LIFE EXPECTANCY.

DO NOT ATTEMPT TO DISASSEMBLE OR MODIFY THE AIRBUDS OR CASE IN ANY WAY. IMMEDIATELY DISCONTINUE USE IF THE UNIT HAS ANY VISIBLY EXPOSED PARTS OR APPEARS MALFUNCTIONAL IN ANY WAY. IF THIS DOES OCCUR, ISOLATE THE EARBUDS IN A SAFE PLACE AND CONTACT THE AIRBUDS CUSTOMER SUPPORT TEAM AT SUPPORT@AFHINDO.COM.

### FCC STATEMENT :

This device complies with Part 15 of the FCC Rules. Operation is subject to the following two conditions:

- (1) This device may not cause harmful interference, and
- (2) This device must accept any interference received, including interference that may cause undesired operation.

Warning: Changes or modifications not expressly approved by the party responsible for compliance could void the user's authority to operate the equipment.

NOTE: This equipment has been tested and found to comply with the limits for a Class B digital device, pursuant to Part 15 of the FCC Rules. These limits are designed to provide reasonable protection against harmful interference in a residential installation. This equipment generates uses and can radiate radio frequency energy and, if not installed and used in accordance with the instructions, may cause harmful interference to radio communications. However, there is no guarantee that interference will not occur in a particular installation. If this equipment does cause harmful interference to radio or television reception, which can be determined by turning the equipment off and on, the user is encouraged to try to correct the interference by one or more of the following measures:  
Reorient or relocate the receiving antenna.

- Increase the separation between the equipment and receiver.
- Connect the equipment into an outlet on a circuit different from that to which the receiver is connected.

Consult the dealer or an experienced radio/TV technician for help.

### RF warning statement:

The device has been evaluated to meet general RF exposure requirement. The device can be used in portable exposure condition without restriction.

FCC ID:2AMD814231

#14230 #14231 #1423\_SERIES

© 2020 AFH INDUSTRIES INC. ALL RIGHTS RESERVED. AIRBUDS & IS A REGISTERED TRADEMARK OF AFH INDUSTRIES INC. OTHER TRADEMARKS AND TRADE NAMES ARE THOSE OF THEIR RESPECTIVE OWNERS. MANUFACTURED AND SERVICED BY AFH INDUSTRIES INC, 110 WEST 34TH STREET, 7TH FLOOR, NEW YORK, NY 10001 FOR PATENTS: AIRBUDSACC.COM/PATENTS - CONTENTS AND COLORS MAY VARY FROM ILLUSTRATED. THE BLUETOOTH WORD MARK AND LOGOS ARE OWNED BY THE BLUETOOTH SIG, INC. \*FOR AGES 12+. THIS IS NOT A TOY. MADE IN CHINA



## AIRBUDS® TRUE WIRELESS EARBUDS BUNDLE

WITH WIRELESS CHARGING CASE • WIRELESS CHARGER • ATHLETIC EARHOOKS



Qi CERTIFIED  
Bluetooth

### USER MANUAL

Includes: 1x Pair-Airbuds • 1x Portable Charging Case • 1x Micro-USB Charging Cable

### AIRBUDS IN-EAR DESIGN

- MULTIFUNCTION BUTTON
- MICROPHONE
- CHARGING PORT

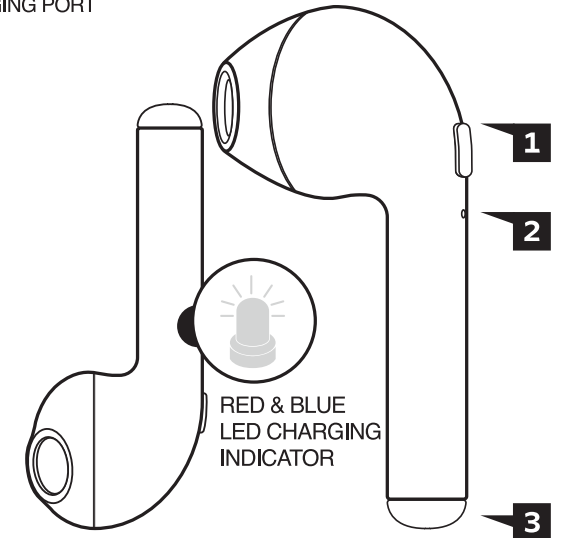

### TECHNICAL SPEC

BLUETOOTH 5.0	Playtime: 3 Hours (MUSIC & TALK @ MAX VOLUME)	Standby Time: Up to 100 Hours	Charges Provided (Case Power): Up to 4
Battery Type: Rechargeable Lithium-ion	Input: 5V/800mAh	Earbud Battery Life: 40 mAh (Each)	Frequency Response: 2.4GHz-2.485GHz

\*NOTE: USING YOUR AIRBUDS AT LOWER VOLUMES WILL HELP PROLONG THE BATTERY LIFE BETWEEN CHARGES

### PAIRING AND POWERING OFF AIRBUDS

#### NOTES FOR PAIRING:

- KEEP THE DISTANCE BETWEEN YOUR SMARTPHONE AND THE AIRBUDS WITHIN 3 FEET (FOR PAIRING ONLY).
- THE AIRBUDS MUST BE POWERED ON IN ORDER TO PAIR.
- BEFORE ATTEMPTING TO PAIR, MAKE SURE THAT YOUR SMARTPHONE OR TABLET'S BLUETOOTH FUNCTION IS ENABLED UNDER SETTINGS. SPECIFIC PAIRING PROCEDURES WILL BE DIFFERENT DEPENDING ON DIFFERENT BRANDS AND MODELS. FOR DETAILED INFORMATION ON BLUETOOTH PAIRING, PLEASE REFER TO YOUR DEVICE'S USER MANUAL.

**STEP 1:** PRESS AND HOLD THE MULTIFUNCTION BUTTONS ON EACH AIRBUDD FOR 3 SECONDS. YOU WILL SEE THE LED FLASH RED AND BLUE ON EACH SIDE, INDICATING THAT THE POWER IS ON. YOUR AIRBUDS ARE NOW IN PAIRING MODE.

**STEP 2:** OPEN YOUR SMART DEVICE'S SETTINGS MENU AND ACTIVATE BLUETOOTH PAIRING. YOUR SMART DEVICE (TABLET, SMARTPHONE, ETC.) WILL PERFORM A SEARCH FOR LOCAL DEVICES. AFTER A FEW SECONDS YOU'LL SEE "AIRBUDS" APPEAR ON THE LIST.

**STEP 3:** SELECT THIS OPTION. ONCE THIS HAPPENS, YOUR AIRBUDS ARE READY TO USE.\*

\*YOU MAY WISH TO ONLY USE ONE AIRBUDD (SINGLE MODE) INSTEAD OF USING THE PAIR TOGETHER (DUAL MODE) WHEN THIS IS THE CASE, SIMPLY TURN ON THE AIRBUDD YOU WISH TO USE AND FOLLOW THE SAME STEPS WHILE KEEPING THE OTHER AIRBUDD TURNED OFF. YOU WILL HAVE THE SAME GENERAL FUNCTIONALITY.

TO TURN YOUR AIRBUDS OFF, PRESS AND HOLD THE MULTI-FUNCTION BUTTON ON EITHER AIRBUDD FOR 3 SECONDS UNTIL BOTH AIRBUDS ARE POWERED OFF.

#### AUTO-PAIRING

ONCE YOU HAVE SUCCESSFULLY PAIRED YOUR AIRBUDS TO A BLUETOOTH-ENABLED DEVICE, THAT DEVICE WILL REMEMBER AND RECOGNIZE YOUR AIRBUDS FOR AUTOMATIC RE-PAIRING. THIS MEANS THAT THE NEXT TIME YOU WISH TO USE YOUR AIRBUDS WITH THAT SMART DEVICE, PAIRING WILL HAPPEN AUTOMATICALLY AND WITHOUT THE NEED FOR YOU TO REVISIT YOUR DEVICE'S BLUETOOTH DISPLAY SCREEN.

#### POWERING OFF AIRBUDS

**POWER OFF EACH INDIVIDUAL AIRBUDD:**  
PRESS AND HOLD THE MULTI-FUNCTION BUTTON ON EITHER AIRBUDD FOR 3 SECONDS UNTIL BOTH AIRBUDS ARE POWERED OFF.

**POWER OFF BOTH AIRBUDS BY CHARGE CASE:**  
DOCK BOTH AIRBUDS INSIDE THE CHARGING CASE. BOTH AIRBUDS WILL TURN OFF.

### 400mAh CHARGING CASE

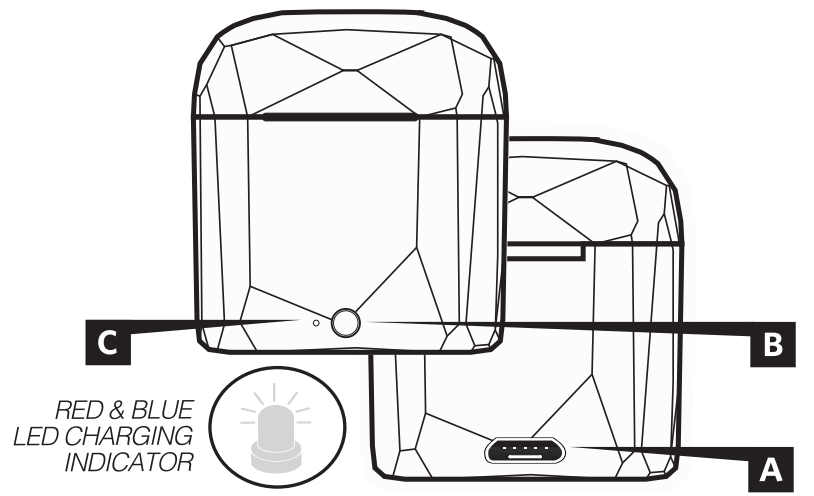

- A MICRO-USB CHARGING PORT
- B POWER BUTTON
- C LED INDICATOR

Battery Type: Rechargeable Lithium-ion	Charges Provided (Case Power): Up to 4	Charging Case Battery: Output - 5V/400mAh	Impedance: 32 Ω
---	---	--	-----------------

### CHARGING YOUR AIRBUDS & CASE\*

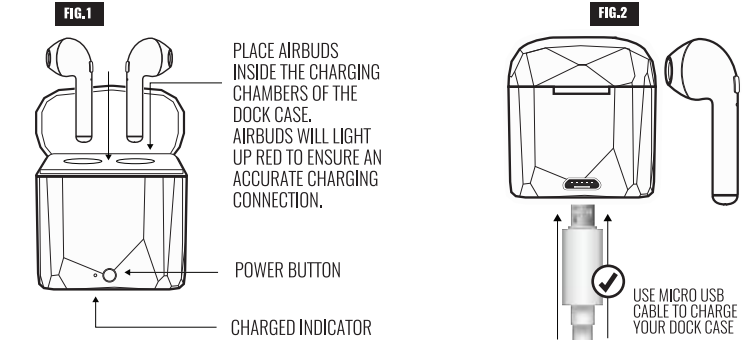

NOTE: THE AIRBUDS WILL REQUIRE UP TO 1 HOUR DOCKED IN THEIR CHARGING CASE TO RECHARGE THEIR BATTERIES. WHEN FULLY POWERED, THE PORTABLE CASE WILL PROVIDE THE AIRBUDS WITH UP TO 4 ADDITIONAL CHARGES.

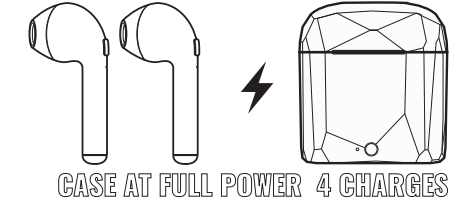

- INSERT THE AIRBUDS INTO THEIR CORRESPONDING CHARGING PORTS IN THE CASE, RESPECTIVELY MARKED L AND R (FIG1).
- THE AIRBUDS WILL MAGNETICALLY DOCK INTO THE CHARGING CASE. CLOSE THE CASE.
- INSERT THE INCLUDED MICRO-USB CHARGING CABLE INTO THE BACK OF THE CHARGING CASE AND CONNECT TO A POWER SOURCE (SUCH AS A POWER BANK, AC WALL ADAPTER, ETC.) (FIG2).
- YOU WILL SEE THE AIRBUDS FLASH RED TO INDICATE THAT AUTOMATIC CHARGING HAS BEGUN. THE CASE'S EXTERIOR LED WILL GLOW A STEADY BLUE.
- WHEN THEY HAVE FINISHED CHARGING, ALL LEDS WILL TURN OFF TO INDICATE THAT THE AIRBUDS AND CASE ARE FULLY CHARGED.