

VIOFO

MT1

MOTORCYCLE CAMERA SYSTEM

USER MANUAL

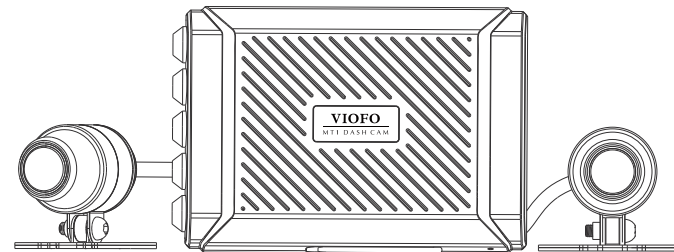

Copyright (c) 2019,Viofo Ltd, All rights reserved

Table of Contents

Product Overview	2
Standard Items		
Product Diagram		
Front/Rear camera		
Inserting / Removing the Memory Card		
Installation	6
Attach the Main Unit		
Attach the Remote Control		
Attach the GPS		
Installing the Front/Rear Camera		
Connecting with Camera Cable		
Connecting with Main Unit		
Connecting with Power Cable		
Operation	11
Recording		
LED Indicators		
VIOFO APP	13
VIOFO APP		
View the Videos		
System Settings	15
Firmware Upgrade	17
Notice	17
Customer Service	18

Product Overview

Standard Items

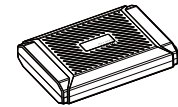

Main unit

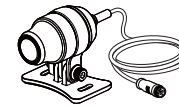

Front Camera

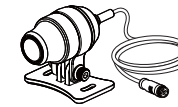

Rear Camera

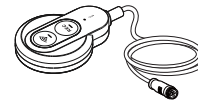

Remote Control

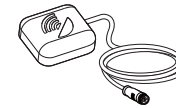

GPS Module

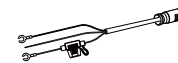

Power Cable



Plastic Mount



Metal Mount

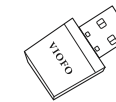

Car Reader Adapter

Product Diagram

Main Unit

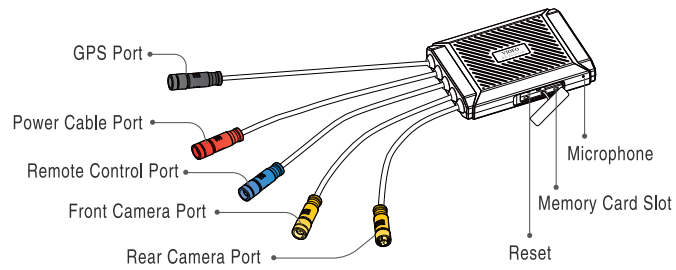

Note: The front camera and the rear camera are the same.

Front/Rear camera

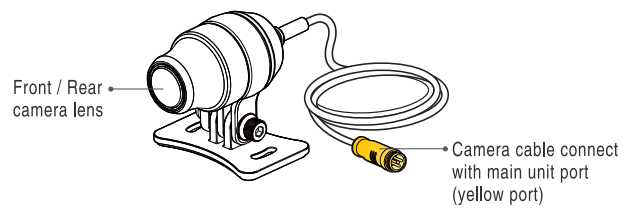

Bluetooth Remote Control

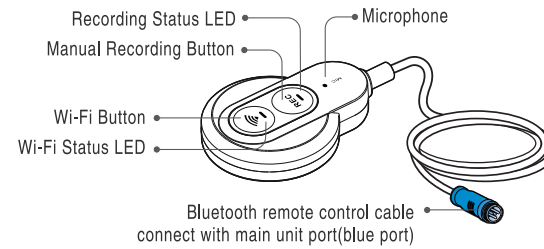

GPS Mount

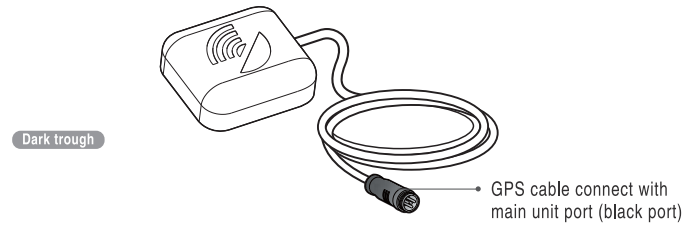

Power Cable

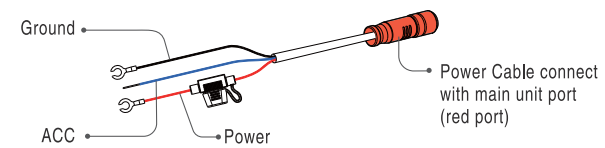

▲ Inserting / Removing the Memory Card

Inserting the memory card

Make sure the metal contacts on the memory card facing toward the VIOFO logo side of the main unit.

Ensure the camera is turned off and push the memory card into the card slot until you hear a click.

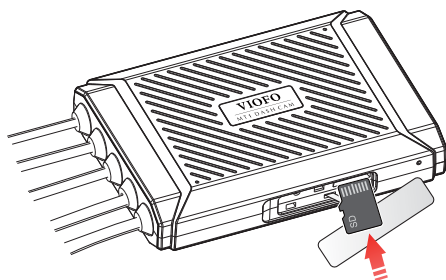

Removing the memory card

Ensure that the camera is turned off, and then push the edge of the memory card with your fingernail. The card will spring out far enough to be removed.

Note:

- The Micro SD card is sold separately. The microSD card must have a Class-10 or UHS-I rating and the capacity up to 256GB.
- We recommend you buy the VIOFO brand memory cards which are manufactured with top-tier MLC NAND flash, making them durable and reliable.
- Please format the card on a computer to the FAT32 file system.
- Formatting will permanently erase any data on the micro SD card. For best performance, format periodically (after backing up any important files).

Warning:

- Please turn off the MT1 before inserting or removing the SD card.
- Inserting or removing the micro SD card while recording may destroy the files.

Installation

Select the appropriate installation locations and follow the instructions to properly install each part of the product.

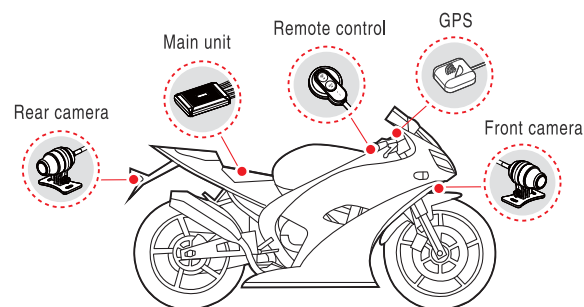

▲ Attaching the Main Unit

Use the Velcro at the bottom of the main unit to attach the main unit to the inner part of the motorcycle, such as the inside of the seat.

 **Note:** Firmly attach the product to the motorcycle to protect from detaching while driving.

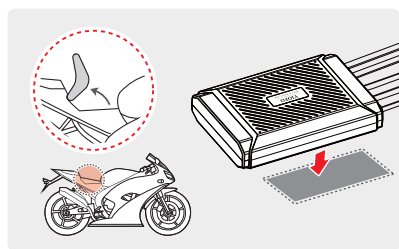

▲ Attaching the Remote Control

Remove the protective film from the remote control, and attach it where it can be used easily without obstructing vehicle operation.

 **Note:** Wipe the installation surface of the windscreen with a dry cloth. The surface must be grease free for the sticky pad to stick firmly.

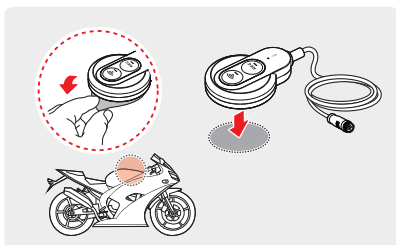

▲ Attaching the GPS

Remove the protective film from the GPS mount, and attach it where it can be used easily without obstructing vehicle operation.

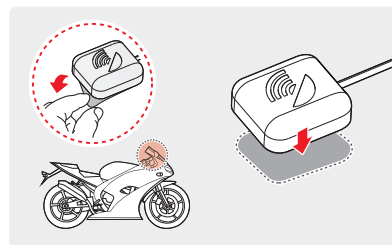

▲ Installing the Front/Rear Camera

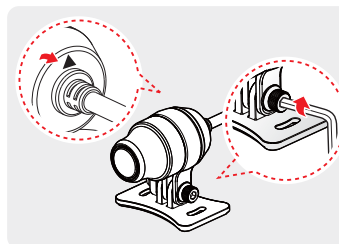

1. Attach the camera to the mount as indicated by the horizontal reference point, and firmly tighten the screws using a wrench.

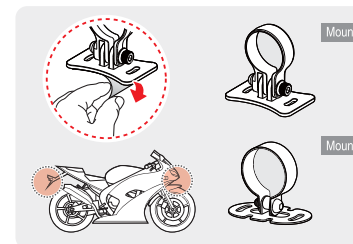

2. Remove the protective film from the mount and attach it to a place where the cameras can record both front and rear view.

Note: Two kinds of mounts are provided.

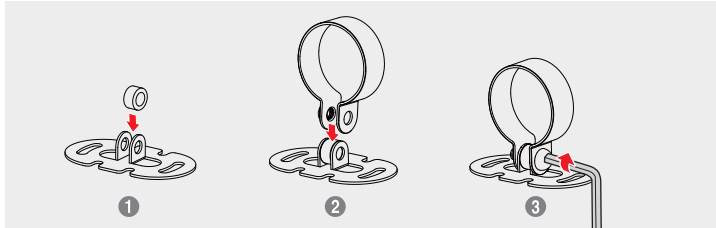

Tips: Install the metal mount

- ① Put the metal ring at the middle of the mount base.
- ② Put the Ω-shaped mount on the top of the mount base.
- ③ Insert the screw from the side that is not protruding as shown and tighten it.

▲ Connecting with Camera Cable

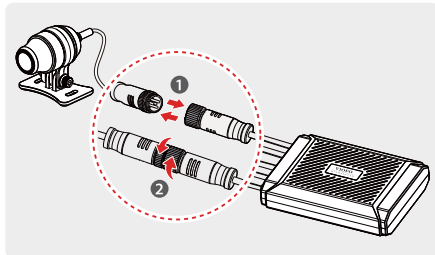

1. Connect with camera cable

Pair the right pin. Insert the camera cable into the camera port of the main unit. Rotate the port clockwise until it is tight to secure the connection.

2. Disconnect with camera cable

Rotate the port counterclockwise until it is loose and plug it out.

 **Note:** Connect with yellow cable of the main unit. The front and the rear camera are the same.

▲ Connecting with Main Unit

Reference the connection steps for camera cable to connect with other parts as the following picture.

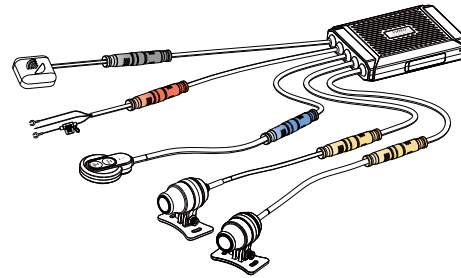

▲ Connecting with Power Cable

Connect the power cable (Ground, ACC, Power) to the motorcycle key-on wiring.

- Connect Ground (black wire), ACC (blue wire) and Power (red wire) correctly with the motorcycle key-on wiring.
- Ensure the power cable is connected correctly. A wrong connection may do damage to the dash camera or the motorcycle.
- Professional installation is a must. So, a trained mechanic is suggested.

Operation

The product turns on automatically and continuous recording starts when you turn on the ACC or start the engine. To turn off the product, turn off the ACC or stop the engine. The product will turn off automatically.

Recording

The recording includes three models: loop recording, manual recording, and emergency recording.

Loop Recording

1. Insert a micro SD card into the camera's card slot and automatic loop recording will begin once the camera detects power.
2. Time frame for each video file is 1 / 2 / 3 / 5 / 10 minutes. The default is 1 minute.
3. When there is insufficient space on the Micro SD card, loop recording will automatically overwrite the oldest files (one by one).

Manual Recording

Short press the REC button on the remote control to enter the manual recording. With indicated red LED light quick flashes, the dashcam saves last file and current file (which is extended by 20s) in manual_rec folder. After the manual video file is saved, the MT1 will automatically switch to loop recording.

Emergency Recording

When the G-sensor is activated by a collision, the current footage will be locked automatically to avoid being overwritten by loop recording.

Recording mode	Loop recording	Manual recording	Emergency recording
In the memory card	Cont_rec	Manual_rec	Event_rec

File Format Definition

Files recorded by front camera and rear camera are saved separately.

2018_1201_170010_062F.MP4 F for the front camera
 2018_1201_170010_063R.MP4 R for the rear camera

 Year Date Time Sequence Number

LED Indicators

Operation Status	LED Status
Power on	Blue + Red (slow flickers, once per second)
Power on, without recording	Slow flashing red (once per second)
Power on, normal recording	Solid red
Manual recording	Quick flashing red (once every 0.5s)
Wi-Fi on, disconnected	Slow flashing blue (once per second)
Wi-Fi on, connected	Solid blue
Firmware update	Slow flashing red first, then quick flashing red.
1. An error occurred with the connection between the front/rear camera and the main unit. 2. An error occurred with the connection between the memory card and the main unit. 3. No memory cards.	Blue + Red (quick flickers, once every 0.5s)

VIOFO App

VIOFO APP will allow live view of cameras and settings adjustable using a smart phone. Along with the live view, VIOFO APP also has a path to download videos/images directly to your phone, and even share with social networks.

Download VIOFO APP



IOS users could download it on the APP store.
Android users could download it on the Google Play or download APK directly from our official website <https://www.viofo.com/content/13-app>.
The app is free for Android devices or IOS devices.

Connect VIOFO APP

Short press the Wi-Fi button on the remote to enable Wi-Fi. The Wi-Fi status will be maintained the next time you turn it on. SSID of Wi-Fi is VIOFO_MC1_XXXX.

- Step1** Short press the Wi-Fi button on the remote, then the Wi-Fi Status LED will be flashing blue to enable connecting with Wi-Fi.
- Step2** Use the phone to connect VIOFO Wi-Fi. When the phone is connected with the dashcam, the LED lights on the remote shows solid blue.
- Step3** Open VIOFO app and choose "Connect your camera" to use your phone control the dashcam.
- Step4** Choose system settings to set the dashcam. And click connect your camera on the home page to see live view.

 **Note:** The original Wi-Fi password is 12345678. It could be changed on the VIOFO app.

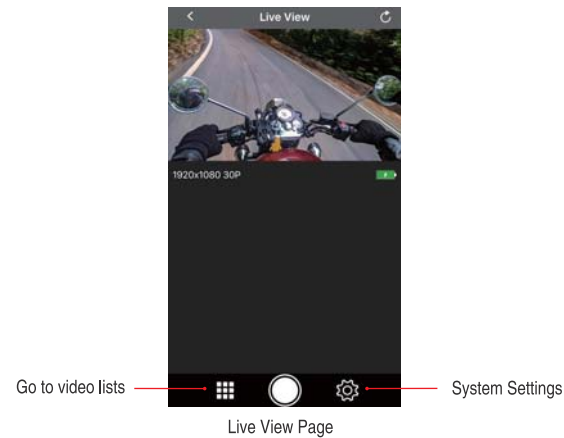

View the Videos

View on a computer

Use the car reader adapter could see recorded videos on a computer. Download "dashcam viewer" from this link <https://dashcamviewer.com/>. Using dashcam viewer could playback detailed information tracked by GPS on the computer. Or use other media player to playback the video files directly without GPS tracks.

View on a phone

Open the VIOFO app, connect with MT1 Wi-Fi to watch and download recorded videos in video lists.

System Settings

You can set the product features according to your needs and preferences using the VIOFO app. To enter the menu settings, please stop recording first.

- **Resolution:**

Setting video resolution of footage recorded,
Front + Rear Camera: 1920*1080P 30FPS

- **Bitrate:**

You can set the bitrate for video. High bitrate may improve the quality and smoothness of the video, especially when recording fast motion or high contrast scenes. Using high bitrate mode may decrease the amount of recording time available on your memory card. Using a low bitrate will save space and record for a longer time.

- **Live Video Source:**

Front camera / Rear camera / PIP mode 1 / PIP mode 2.

- **Loop Recording:** Off / 1 / 2 / 3 / 5 / 10 minutes.

A recording will begin automatically after powering on with a micro SD card in the device. Each recorded file is up to three minutes long, with old footage being replaced when micro SD card storage is full.

- **WDR (Wide Dynamic Range):**

On/ Off. The dynamic range is the ratio of the brightest portion of the image to the darkest portion of the image. WDR enables the camera to deliver video with a near perfect exposure in varying lighting situations.

- **Exposure:**

Adjusting the value of the EV (Exposure Value) properly can create better footage under different light sources. It ranges from -2.0 to +2.0. You can adjust the EV for the front and rear camera separately. The default is set at 0.0.

- **G-Sensor:**

The G-sensor measures shock forces and locks the video recorded at the time. The settings from "low to high" determine the amount of force needed to lock the file from being overwritten. We recommend that you set it at low.

- **G-sensor Sensitivity:** High, Medium, Low

- **Motion Detection:**

On/ Off. When activated, the camera will start recording if there is movement in front of the camera. Once the camera does not detect movement for 60 seconds, it stops recording and returns to "Motion Detection" mode. The camera will record again in the time of detecting a new movement.

- **GPS:**

Turn on / off GPS logger. A GPS module is used to include the location data in the recorded videos. If disabled, your camera will no longer measure your speed and position; nor synchronize the time /date. (Only available when connecting with GPS signal) Please use "Dashcam Viewer" to playback videos and to visualize your position.

- **Speed Unit:**

Kilometer per hour (KMH), miles per hour (MPH).

- **GPS Info Stamp:** Off/ All Info. Imprint the GPS information on the recorded video.

- **Date / Time:** Set system date / time.

- **Time Zone:** Set the current time zone for GPS time and date calibration.

- **Date Stamp:** On/ Off. Imprint the time and date on the recorded video.

- **Camera Model Stamp:** On/ Off. Imprint the camera model on the recorded video.

- **Beep Sound:** Off, Button Beep Only, Startup Sound only, All On.

- **Frequency:** 50Hz/ 60Hz. Set it to minimize flickering and banding in the recorded video.

- **Image Rotation:** Off, Front Only, Rear Only, Both.

- **Rear Camera Mirror:**

On/ Off. Rear Camera Mirror can make the image of the rear camera to be displayed and recorded as reversed compared to the actual view.

- **Format:** The operation will delete all data on the Micro SD card.

Note: Once you format the card, all information will be deleted and unrecoverable. Make sure to back up all files that you needed before formatting.

- **Default Setting:** Restore device to factory settings.

- **Car Number:** Imprint the car number on the recorded video.

- **Custom Text Stamp:** Imprint the customize text on the recorded video.

- **Firmware Version:** Check the current firmware version of the camera.

Firmware Upgrade

Follow the instructions on this website to upgrade the firmware:
(<https://support.viofo.com/support/solutions/19000101567>)



Note:

- Before using a Micro SD card to upgrade the firmware, formatting the card in the camera is necessary to ensure stable read and write operation.
- Do not unplug or power off the camera during a firmware upgrade, it may cause the camera to subsequently fail to boot.

Notice

FCC Statement

This equipment has been tested and found to comply with the limits for a Class B digital device, pursuant to part 15 of the FCC Rules. These limits are designed to provide reasonable protection against harmful interference in a residential installation. This equipment generates, uses and can radiate radio frequency energy and, if not installed and used in accordance with the instructions, may cause harmful interference to radio communications. However, there is no guarantee that interference will not occur in a particular installation. If this equipment does cause harmful interference to radio or television reception, which can be determined by turning the equipment off and on, the user is encouraged to try to correct the interference by one or more of the following measures:

- Reorient or relocate the receiving antenna.
- Increase the separation between the equipment and receiver.
- Connect the equipment into an outlet on a circuit different from that to which the receiver is connected.
- Consult the dealer or an experienced radio / TV technician for help.

Caution:

Any changes or modifications to this device not explicitly approved by the manufacturer could void your authority to operate this equipment.

This device complies with part 15 of the FCC Rules. Operation is subject to the following two conditions:

- (1) This device may not cause harmful interference, and
- (2) this device must accept any interference received, including interference that may cause undesired operation.

To maintain compliance with FCC's RF Exposure guidelines, This equipment should be installed and operated with minimum distance between 20cm the radiator your body: Use only the supplied antenna.

Shenzhen Viofo Technology Co.,Ltd, declares that this Radio Frequency peripheral is in compliance with the essential requirements and other relevant provisions of Directive 1999/5/EC.

Customer Service

- 12-month Limited warranty , Lifetime technical support
- support@viofo.com
- www.facebook.com/viofo.world
- +86 755 8526 8909 (CN)
- Mon-Fri 9am-6pm