

P300 User Manual (Overseas Version-FCC)

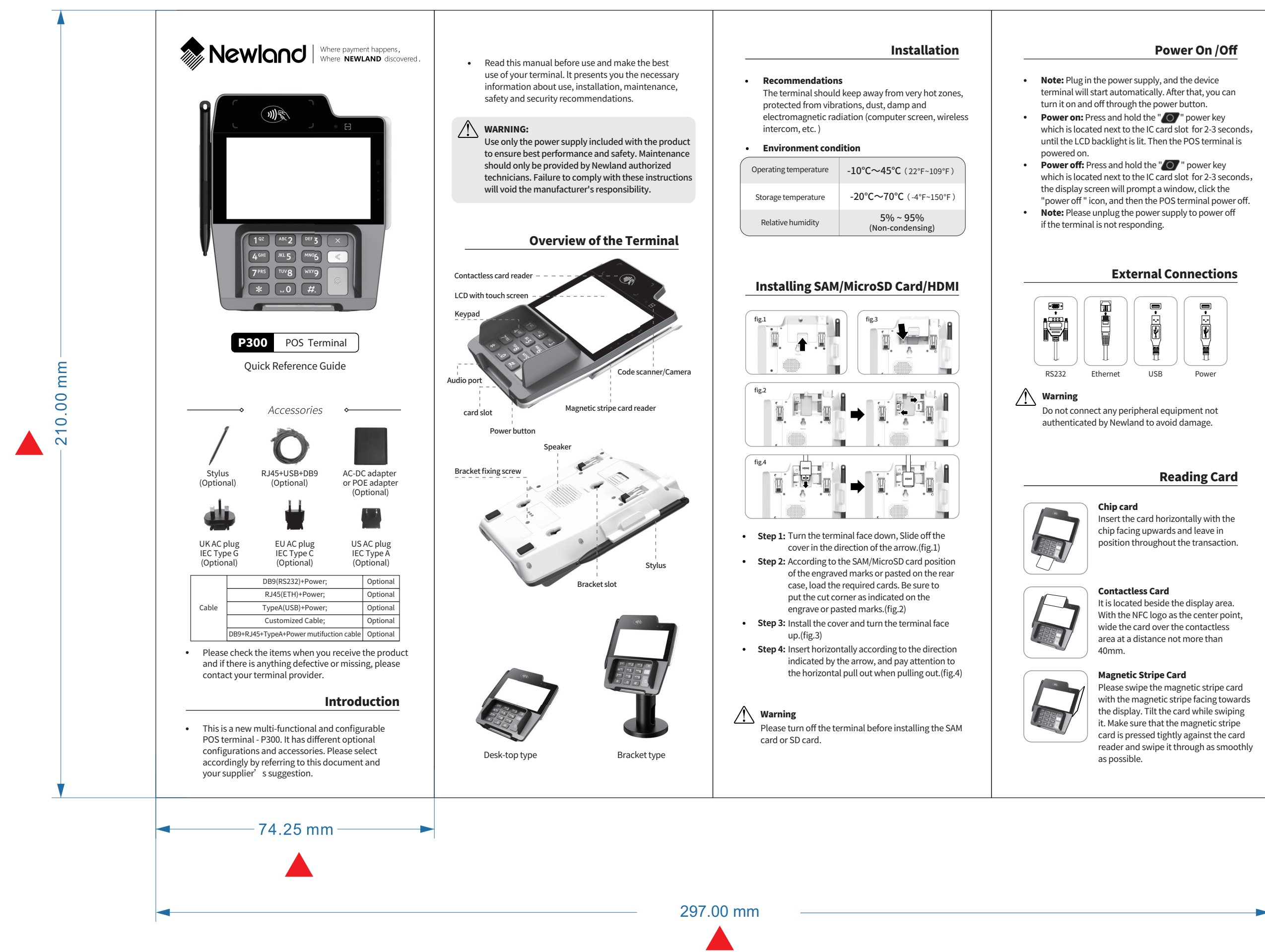

Troubleshooting

- **I. Can't read the magnetic card or the card swiping has a low success rate**
 - 1. Check that the magnetic card is swiped correctly (with magnetic band on terminal side).
 - 2. Check if there are any bugs or dirt on the magnetic head. Please clean it.
- **II. IC cards can't be read**
 - 1. Make sure you have inserted the chip card correctly into the chip card reader (with the chip facing up).
 - 2. Check whether the card slot is blocked or whether the card is in the correct position.
- **III. LCD screen not illuminated**
 - 1. Check whether the power supply is connected to the electrical output correctly.
 - 2. Check whether the power supply connector is connected to the POS terminal correctly.
- **IV. Communication failure**
 - 1. Check whether the cable is connected properly.
 - 2. Check whether the signal of handheld device is strong enough.

Safety

- 1. Please be sure to take to comply with the specifications in this document.
- 2. Do not use in proximity of potentially flammable gases or substances.
- 3. Do not disassemble the terminal and power adapter.
- 4. Cut off the power immediately, when there is unusual smell, overheating or smoke.
- 5. Do not use in a near water or humid environment to prevent liquid from entering the device.
- 6. Do not use the terminal in extremely cold and hot zones, such as near a fire.
- 7. Do not drop, throw or bend the device.
- 8. Use in clean environment to avoid entry of small objects into POS terminal.
- 9. Do not use near nearby hospital equipment without permission.
- 10. Do not use terminals with radio communication on and near their aircraft, or any other place where radio communication is prohibited.

Security of Your Terminal

Your device fulfills current applicable PCI PTS security requirements. Upon receipt your terminal you should check for signs of tampering of the terminal. It is strongly advised that these checks are performed regularly after receipt. Be sure the circumstance is brightness or you may use a light tool as well).

- 1. Check the product name and the hardware version on the label to ensure the product is correct.
- 2. Check if there are bugs hidden in the Chip card slot before Chip card is inserted.
- 3. Check whether the magnetic card slot has the exception of adding magnetic head.
- 4. Check the appearance of the product to guarantee the device would not be forged.
- 5. Before entering the PIN, the user should be aware of his/her surroundings and use the body, fingers or protection to block the peeper's sight.

FCC Statement

1. Any changes or modifications not expressly approved by the party responsible for compliance could void the user's authority to operate the equipment.
2. This device complies with part 15 of the FCC Rules. Operation is subject to the following two conditions:
 - (1) This device may not cause harmful interference, and
 - (2) this device must accept any interference received, including interference that may cause undesired operation.
3. This equipment complies with FCC radiation exposure requirements set forth for uncontrolled environments.
4. This equipment has been tested and found to comply with the limits for a Class B digital device, pursuant to part 15 of the FCC Rules. These limits are designed to provide reasonable protection against harmful interference in a residential installation. This equipment generates, uses and can radiate radio frequency energy and, if not installed and used in accordance with the instructions, may cause harmful interference to radio communications. However, there is no guarantee that interference will not occur in a particular installation. If this equipment does cause harmful interference to radio or television reception, which can be determined by turning the equipment off and on, the user is encouraged to try to correct the interference by one or more of the following measures:
 - Reorient or relocate the receiving antenna.
 - Increase the separation between the equipment and receiver.

—Connect the equipment into an outlet on a circuit different from that to which the antenna is connected.
—Consult the dealer or an experienced radio/TV technician for help.

FCC Radiation Exposure Statement

- This equipment complies with FCC radiation exposure limits set forth for an uncontrolled environment. This transmitter must not be co-located or operating in conjunction with any other antenna or transmitter. This equipment should be installed and operated with minimum distance 20cm between the radiator and your body.
- ©2018 Fujian Newland Payment Technology Co., Ltd. All rights reserved.
- This guide is for reference only. The actual product, including but not limited to color, size, and screen layout, may vary. All statements, information and recommendations in this guide do not constitute a warranty of any kind, express or implied.
- Fujian Newland Payment Technology Co., Ltd. retains full copyright ownership, rights and protection in this guide. No part of this guide may be copied, added or deleted, excerpted, reproduced or imitated partially and wholly in any form or by any means without prior written consent of Fujian Newland Payment Technology Co., Ltd. and its affiliates.
- Fujian Newland Payment Technology Co., Ltd.
No. 8602, Building 11, Hualin Jingma Plaza
Fuzhou Bonded Area 350015, Fujian, China
<http://www.newlandpm.com>