

SPECIFICATION

SHEET FOR APPROVAL

(Revision: R: A2)

CUSTOMER(客户名称)	Newland
CS P/N(客户机种)	P300
PART NAME(品名)	WIFI&BT
FREQUENCY(频率)	2400-2500; 5150-5850MHz。
ZTX NO.(物料编号)	E.03.00846
DATE(日期)	2023-4-11

CUSTOMER			
QA CHECKED	ME CHECKED	RF CHECKED	MANAGER CHECKED



福州中天迅通信技术有限公司

ZHONGTIAN XUN Communication Technology Co.,Ltd.

0591-83582969

0591-83583660

<http://www.chinaztx.com>

ANTENNA SPECIFICATION

CUS P/N : P300 WIFI&BT

ApplicationDate:Apr,11,2023

Rev: R:A2

ZTX P/N : P300 WIFI&BT

Editor:

1. Test equipment

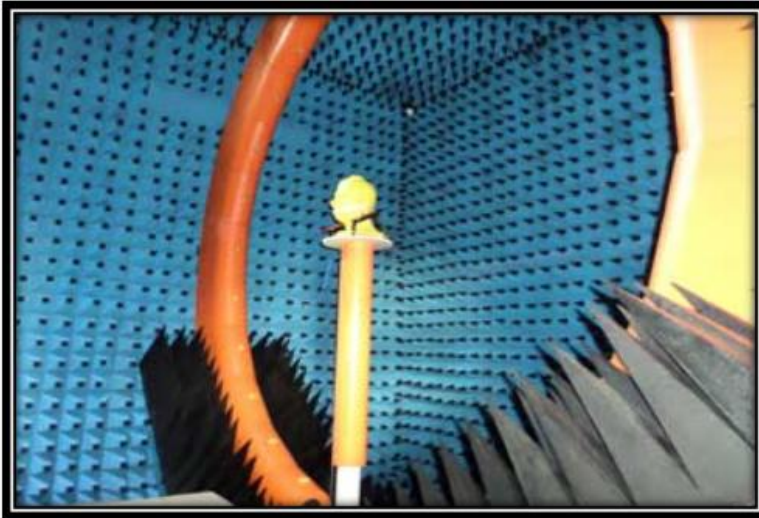

Owned 6 microwave dark room, equipped 2 sets world leading France Satimo SG24 OTA certification test systems (one in SHENZHEN, another one in Shanghai), ETS OTA Standard test system, Blue test reverberation test system which is High repeatability, high accuracy and high resolution. It can quickly provide accurate test reports, fully meet the CITA standards.

Testing range:

Support active, passive testing of GSM/CDMA/WCDMA/TD-SCDMA/LTE/WIFI/WLAN/WiMax/BT/GPS/MIMO/UWB within 0.4-6G.

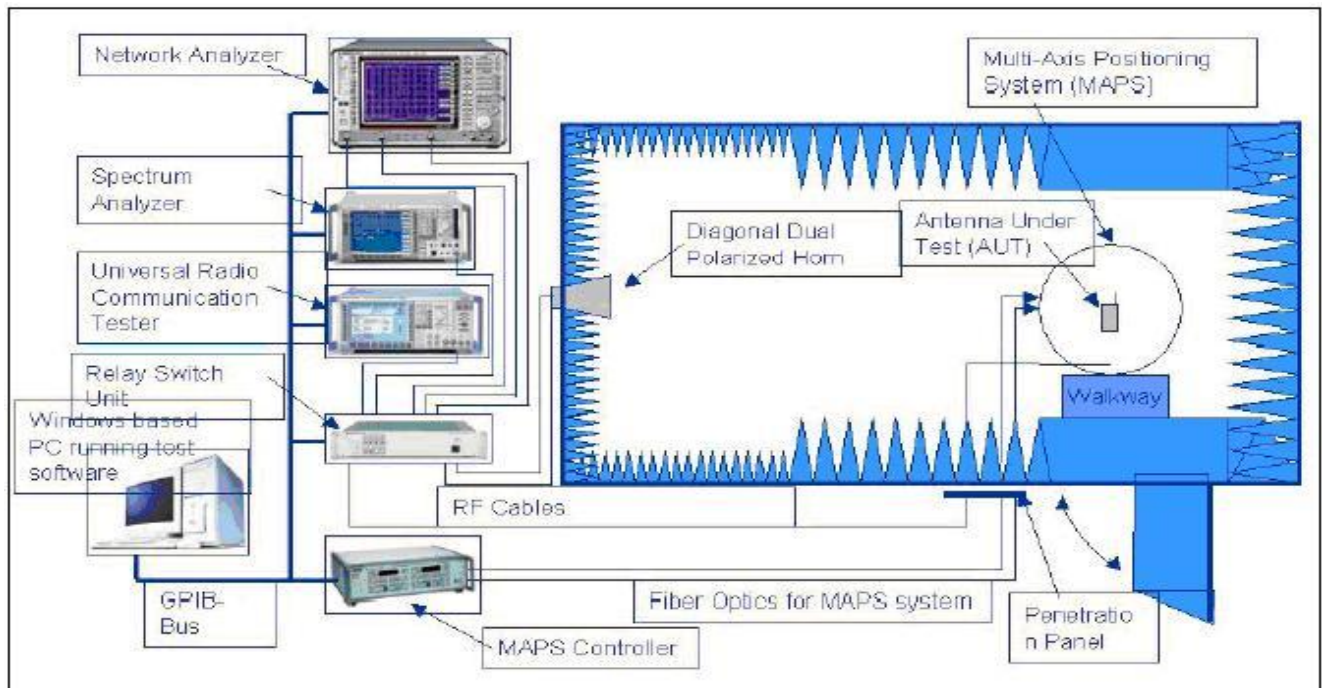

ANTENNA SPECIFICATION

CUS P/N : P300 WIFI&BT

ApplicationDate:Apr,11,2023

Rev: R:A2

ZTX P/N : P300 WIFI&BT

Editor:

2. Antenna test data

2-1 Antenna passive test

chNo	Freq (MHz)	Gain (dBi)	Efficiency (%)	chNo	Freq (MHz)	Gain (dBi)	Efficiency (%)
1	2400	0.700613	36.68845	14	5250	-0.21816	29.35735
2	2410	0.920495	37.07595	15	5300	-0.04295	30.90049
3	2420	1.035053	37.43773	16	5350	1.607861	37.28893
4	2430	0.928318	36.55397	17	5400	0.386412	32.63774
5	2440	0.617171	34.56904	18	5450	0.153869	30.15193
6	2450	0.65204	34.63328	19	5500	2.389826	34.27641
7	2460	0.338511	33.68398	20	5550	1.45063	35.70216
8	2470	0.616511	33.61077	21	5600	-0.40378	30.13587
9	2480	0.500804	31.82191	22	5650	-0.81202	31.36342
10	2490	0.551458	31.42544	23	5700	0.455491	38.63689
11	2500	0.802846	31.48932	24	5750	-0.48157	31.26063
12	5150	0.352192	25.7205	25	5800	-0.15291	28.53475
13	5200	-0.39394	27.0016	26	5850	0.296124	33.3353



ANTENNA SPECIFICATION

CUS P/N : P300 WIFI&BT

ApplicationDate:Apr,11,2023

Rev: R:A2

ZTX P/N : P300 WIFI&BT

Editor:

2-2 3D radiation drawing

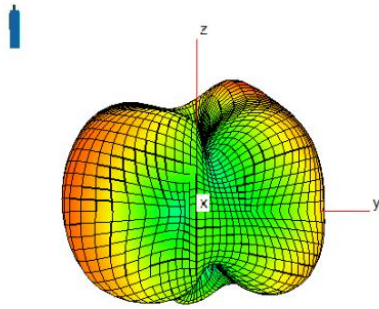

2450MHz

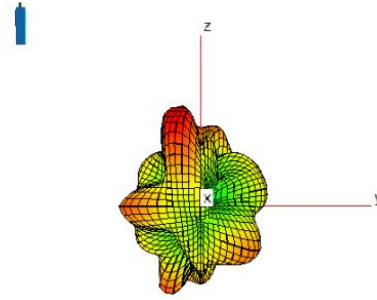

5500MHz



ANTENNA SPECIFICATION

CUS P/N : P300 WIFI&BT

ApplicationDate:Apr,11,2023

Rev: R:A2

ZTX P/N : P300 WIFI&BT

Editor:

2-3 Active test data

频段 (frequency)	参数\信道 Parameter/channel	1	7	13
11B	TRP (dBm)	13.78	13.52	13.32
	TIS (dBm)	-70.21	-71.15	-70.17
频段 (frequency)	参数\信道 Parameter/channel	36	100	165
11A	TRP (dBm)	13.48	15.38	12.39
	TIS (dBm)	-70.74	-72.33	-71.06



ANTENNA SPECIFICATION

CUS P/N : P300 WIFI&BT

ApplicationDate:Apr,11,2023

Rev: R:A2

ZTX P/N : P300 WIFI&BT

Editor:

2-4 Matching circuit

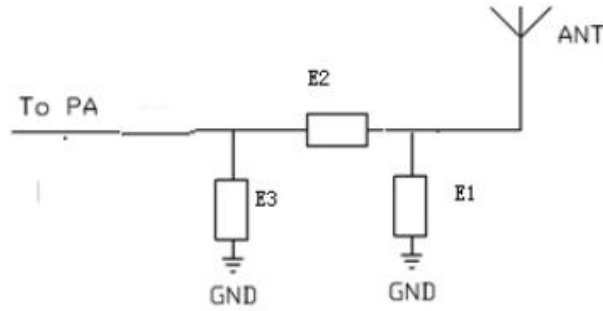

匹配说明 specification	
E1	NC
E2	0Ω
E3	NC



ANTENNA SPECIFICATION

CUS P/N : P300 WIFI&BT

ApplicationDate:Apr,11,2023

Rev: R:A2

ZTX P/N : P300 WIFI&BT

Editor:

3. Mechanical Specification

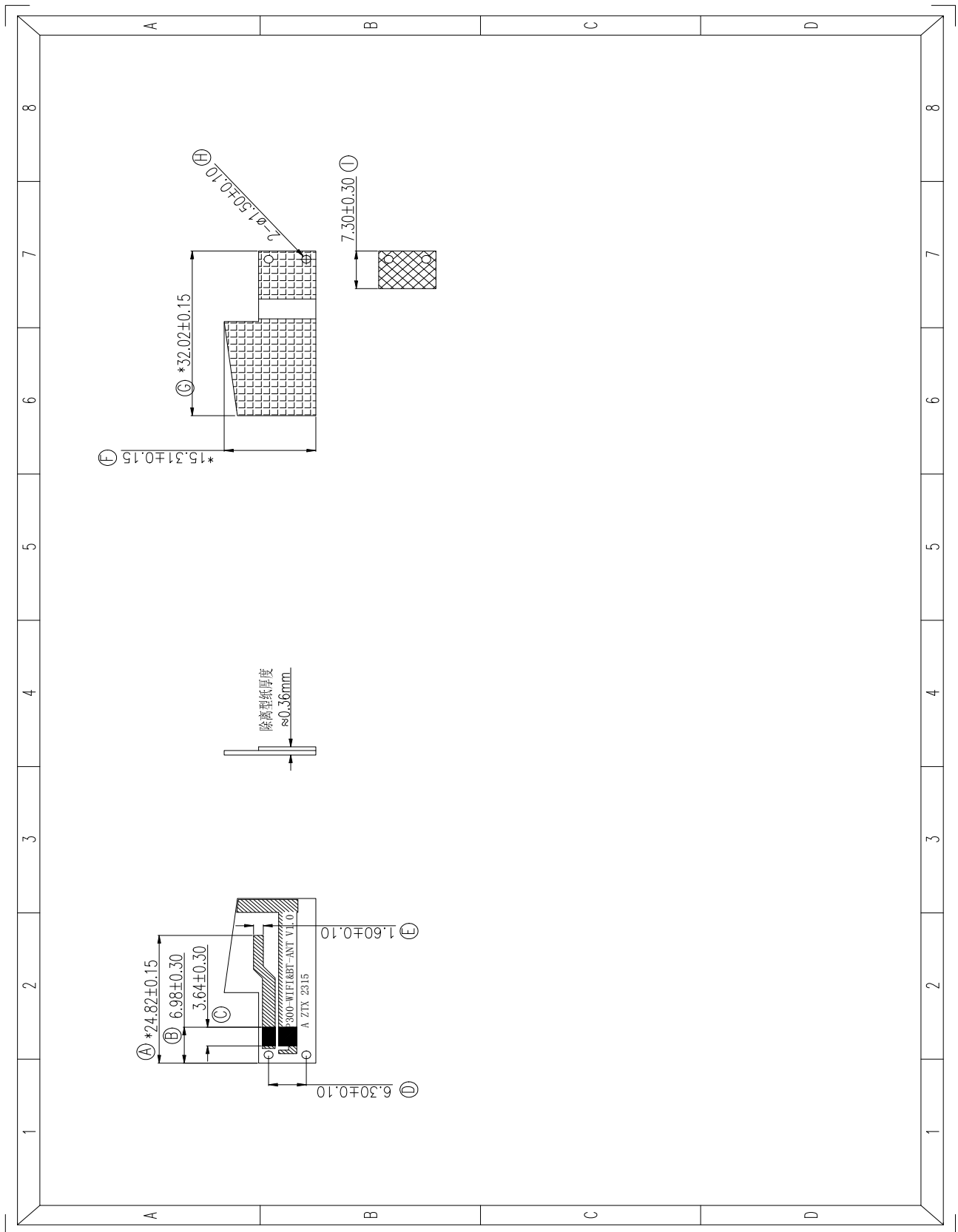

ANTENNA SPECIFICATION

CUS P/N : P300 WIFI&BT

ApplicationDate:Apr,11,2023

Rev: R:A2

ZTX P/N : P300 WIFI&BT

Editor:

4. Size report

5. Salt-Spray test

6. Environment Characteristic

NO.	ITEM	TEST CONDITION	SPECIFICATION
4-1	High Temperature/Humidity Storage Test(non operating)	1. Temperature: $+70 \pm 2^{\circ}\text{C}$ 2. Humidity: $90\sim 95\%RH$ 3. Time: 48hrs	No material deformation is allowed.
4-2	Low Temperature/Humidity Storage Test(non operating)	1. Temperature: $-30 \pm 2^{\circ}\text{C}$ 2. Humidity: $0\%RH$ 3. Time: 48hrs	The VSWR, Gain, Radiation Pattern must be met specifications after these test.

