

Where payment happens,
Where **NEWLAND** discovered.



MES1 POS Terminal

Quick Reference Guide

Accessories



- Please check the items when you receive the product and if there is anything defective or missing, please contact your terminal provider.

Introduction

- This is a new multi-functional and configurable retail/basic PINPAD - MES1. It has different optional configurations and accessories. Please select by yourself according to this document or supplier.
- Read this guide to understand and make the best use of your terminal. It presents you the necessary information about use, installation, maintenance, safety and security recommendations.

Overview of the Terminal

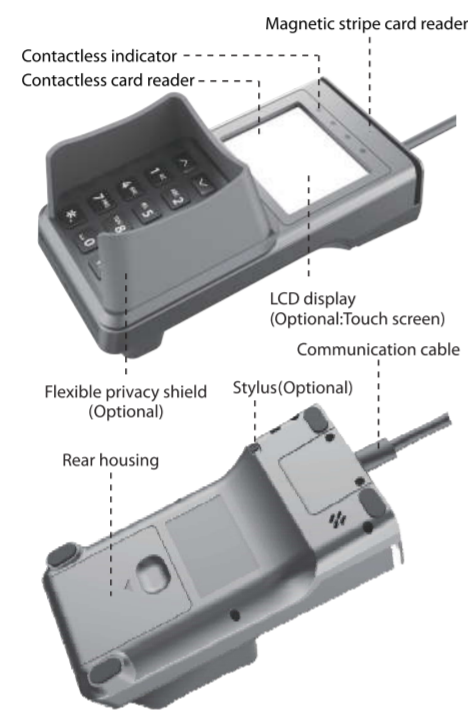

Installation

- Recommendations**
Don't use the terminal in very hot or damp environment, keep the terminal from dust, vibration and electromagnetic radiation (computer screen, wireless intercom, etc).

Specifications of the products

Power supply	DC 5.0V 1A
Display	320X240 LCD display (Optional: touch screen)
Operating temperature	-10 °C ~ -50 °C (14 °F ~ 122 °F)
Storage and transportation temperature	-20 °C ~ -60 °C (4 °F ~ 140 °F)
Relative humidity	5%~93% Non-condensing at +40 °C (104 °F)

Installing SAM/MicroSD Card

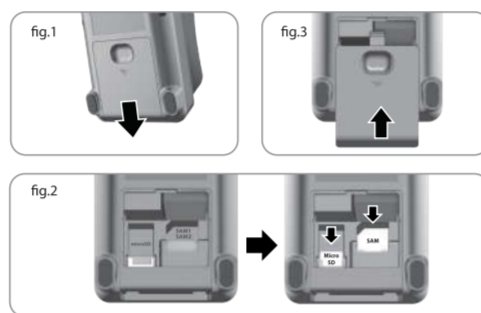

- Step 1:** Turn the terminal face down, Open the rear housing.(fig.1)
- Step 2:** According to the SAM/MicroSD card position of the engraved marks or pasted on the rear housing, load the required cards. Be sure to put the cut corner as indicated on the engraved or pasted marks.(fig.2)
- Step 3:** Install the rear housing and turn the terminal face up.(fig.3)



Warning

Please turn off the terminal before installing the SAM card or SD card.

Use of the Terminal

- Terminal will power on automatically once connected to the power supply; screen will turn to standby mode if not used for 30 Seconds, you can touch the button to bring the terminal back to the normal mode.

Reading Card



Chip card

Insert the card horizontally with the chip facing upwards and leave in position throughout the transaction.



Magnetic stripe card

The card can be read either from left to right or from right to left with the stripe facing the terminal. Use a regular movement in order to ensure a reliable card reading.



Contactless card

Put the card firmly on the RFID active zone and keep the card close to the reader during the transaction. The 4 LEDs on the top of the screen will indicate the status during the transaction.

External Connections

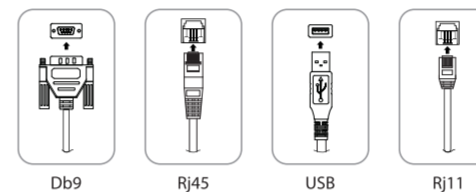

Warning

Do not connect any peripheral equipment not authenticated by the Newland to avoid damage.

Safety

1. Please be sure to take to comply with the specifications in this document.
2. Do not use in proximity of potentially flammable gases or substances.
3. Do not disassemble the terminal, power supply.
4. Cut off the power immediately, when there is unusual smell, overheating or smoke.
5. Do not use in a near water or humid environment to prevent liquid from entering the device.
6. Do not use the terminal in extremely cold and hot zones, such as near a fire.
7. Do not drop, throw or bend the device.
8. Use in clean environment to avoid entry of small objects into POS.
9. Do not use near hospital equipment without permission.
10. Do not use terminals with radio communication on and near the aircraft, or in any other place where radio communication is prohibited.

Security of Your Terminal

Your device fulfills current applicable PCI PTS security requirements. Upon receipt your terminal you should check for signs of tampering of the equipment. It is strongly advised that these checks are performed regularly after receipt (Be sure the circumstance is brightness or you may use a light tool as well).

1. Check the product name and the hardware version on the label to ensure the product is correct.
2. Check if there are bugs hidden in the Chip card slot before Chip card is inserted.
3. Check whether the magnetic card slot has the exception of adding magnetic head.
4. Check the appearance of the product to guarantee the device without being modified.
5. Before entering the PIN, the user should be aware of his/her surrounding and use the body, fingers or protection to block the peeper's sight.

FCC Statement

- Any Changes or modifications not expressly approved by the party responsible for compliance could void the user's authority to operate the equipment. This device complies with part 15 of the FCC Rules. Operation is subject to the following two conditions:

- (1) This device may not cause harmful interference, and
- (2) this device must accept any interference received, including interference that may cause undesired operation.

Note: This equipment has been tested and found to comply with the limits for a Class B digital device, pursuant to part 15 of the FCC Rules. These limits are designed to provide reasonable protection against harmful interference in a residential installation. This equipment generates, uses and can radiate radio frequency energy and, if not installed and used in accordance with the instructions, may cause harmful interference to radio communications. However, there is no guarantee that interference will not occur in a particular installation. If this equipment does cause harmful interference to radio or television reception, which can be determined by turning the equipment off and on, the user is encouraged to try to correct the interference by one or more of the following measures:

- Reorient or relocate the receiving antenna.
- Increase the separation between the equipment and receiver.
- Connect the equipment into an outlet on a circuit different from that to which the receiver is connected.
- Consult the dealer or an experienced radio/TV technician for help.

FCC Radiation Exposure Statement

- This equipment complies with FCC radiation exposure limits set forth for an uncontrolled environment. This transmitter must not be co-located or operating in conjunction with any other antenna or transmitter.

Troubleshooting

- I. The terminal does not powering on**
 1. Please make sure using Product-matched power supplies.
 2. Confirm the power is connected correctly.
- II. Can't read the magnetic card or the card swiping has a low success rate**
 1. Check that the magnetic card is swiped correctly (with magnetic band on terminal side).
 2. Check if there any bugs or dirt on the magnetic head. Please clean it.
- III. Chip cards are not read**
 1. Make sure you have inserted correctly the Chip card into the chip card reader (with the chip facing upwards).
 2. Check if the card slot is blocked or if the card is in correct position.
- IV. Can't read the RFID card**
 1. Check does the card used support RFID function.
 2. Check the card correctly placed in the RFID sensing area or not.

©2018 Fujian Newland Payment Technology Co., Ltd. All rights reserved

This guide is for reference only. The actual product, including but not limited to color, size, and screen layout, may vary. All statements, information and recommendations in this guide do not constitute a warranty of any kind, express or implied.

Fujian Newland Payment Technology Co., Ltd. retains full copyright ownership, rights and protection in this guide. No part of this guide may be copied, added or deleted, excerpted, reproduced or imitated partially and wholly in any form or by any means without prior written consent of Fujian Newland Payment Technology Co., Ltd. and its affiliates.

Fujian Newland Payment Technology Co., Ltd.
No. B602, Building #1, Haixia Jingmao Plaza
Fuzhou Bonded Area 350015, Fujian, China
<http://www.newlandpayment.com>