



Industrial Wireless Barcode Scanner Manual

List: Barcode scanner Base Battery
Manual USB/RS232 cable 12V Adapter

NO:1230332001 V1.0

Product Description

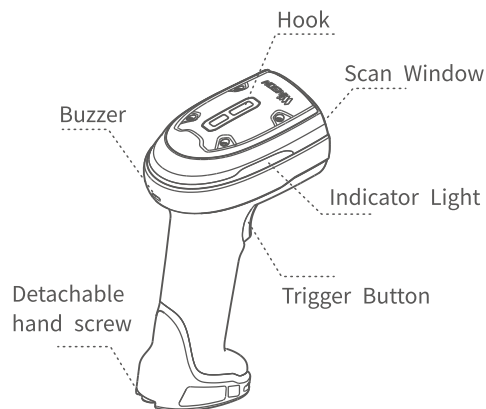

Barcode Scanner

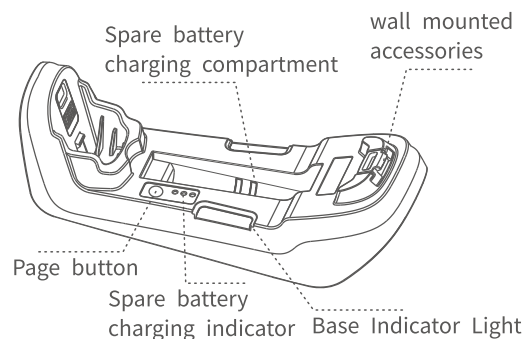

Base

Product Description

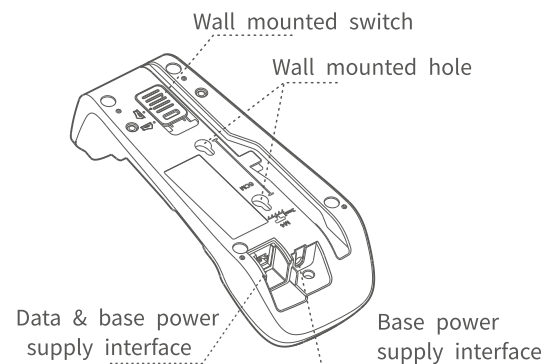

Base cable plug

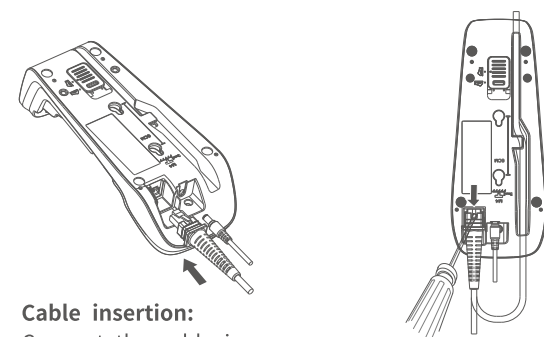

Cable insertion:
Connect the cable in the direction shown in the picture

Unplug the cable:
Press the buckle first as shown in the picture, Then unplug the cable

Battery Install & Remove

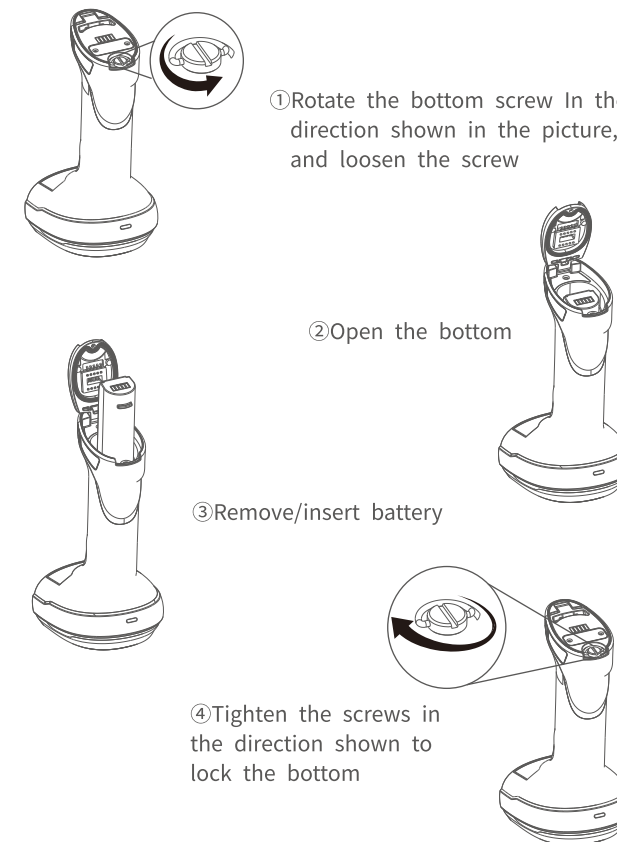

① Rotate the bottom screw in the direction shown in the picture, and loosen the screw

② Open the bottom

③ Remove/insert battery

④ Tighten the screws in the direction shown to lock the bottom

USB Connection Method

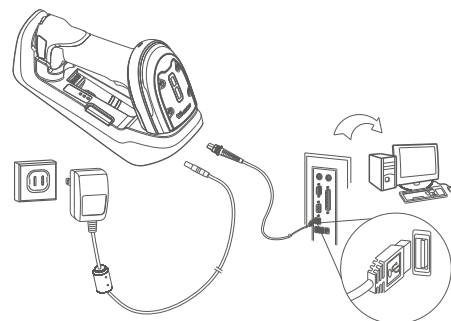

- Connect the PC/POS with USB cable
- Connect the power adapter to the socket, and connect the power supply cable to the base

RS232 connection method

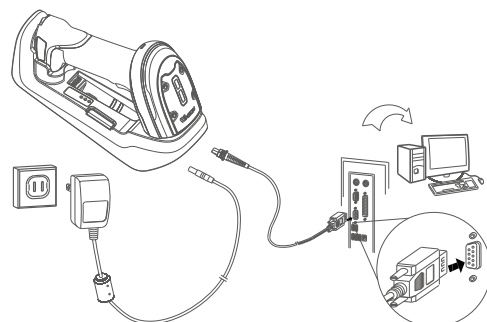

- Connect the PC/POS with RS-232 cable
- Connect the power adapter to the socket, and connect the power supply cable to the base

Pairing Method

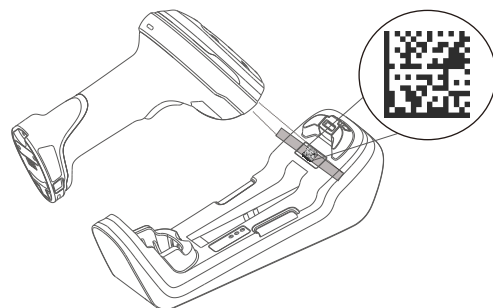

① Scan the pairing barcode which pasted on the front of the base

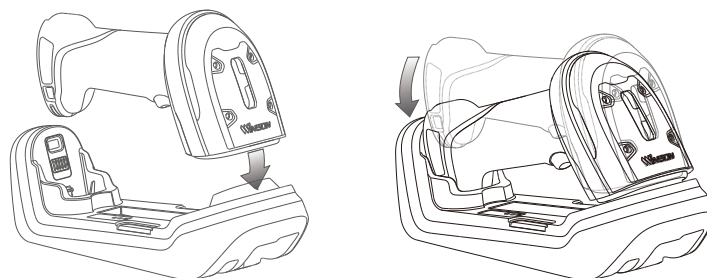

② Put the scanner into the base and wait for the sound and light prompt for successful pairing

Scanning Method & Scanning Distance

- Scanner aim at the center of the barcode
It is better to maintain a certain angle between the barcode and the scanner (Aiming light is subject to actual product)

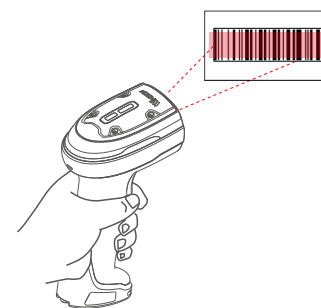

- If the bar code is highly reflective, pls try rotate scanning at a certain angle instead of scanning vertically.

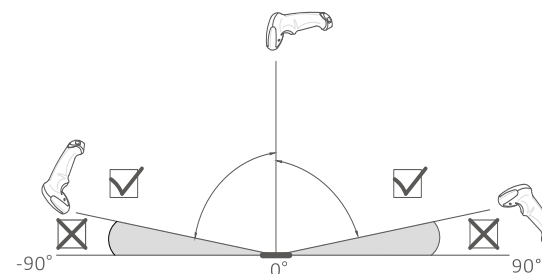

Charging Method

- One battery: charge the scanner through the base

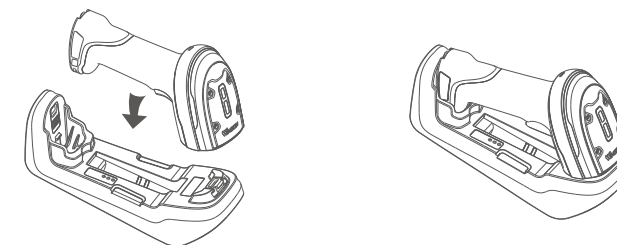

- Two Batteries: Charge the battery and the scanner simultaneously through the charging base (Base need to connect with power supply cable)

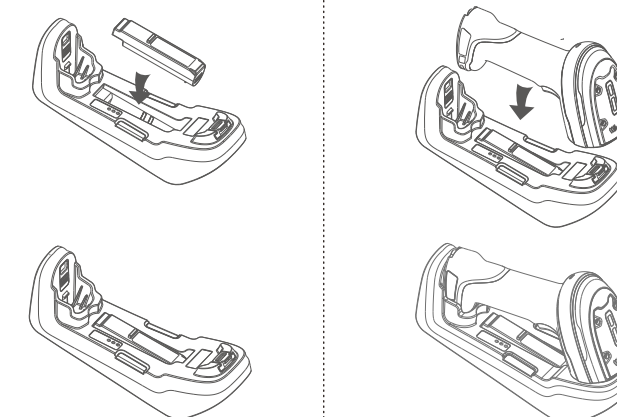

Use The Hook

The metal hook on the top of the scanner can be used for hanging

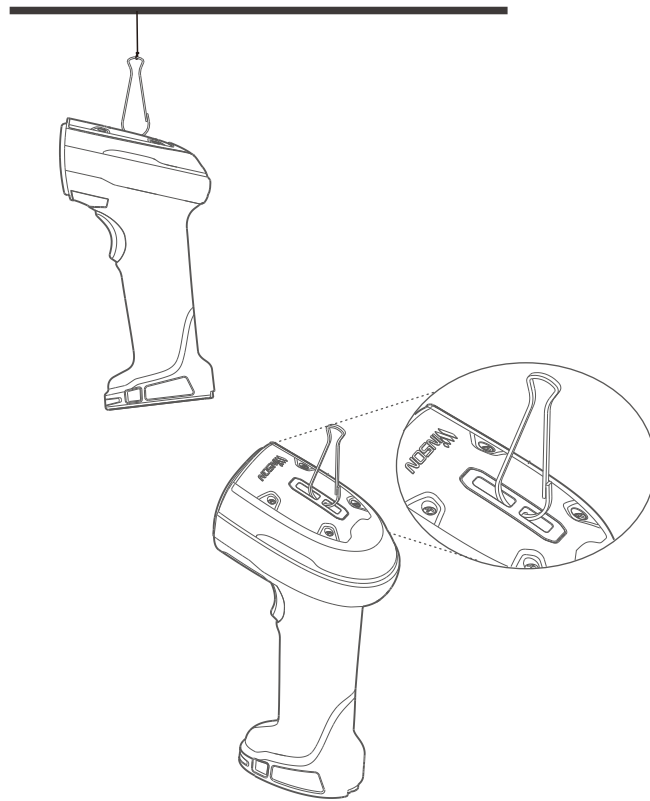

Use The Base

Flat Mode

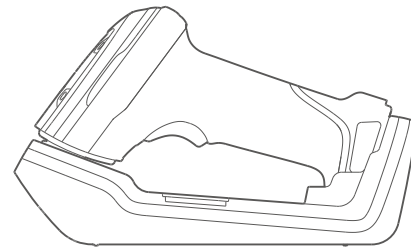

Wall mounted mode

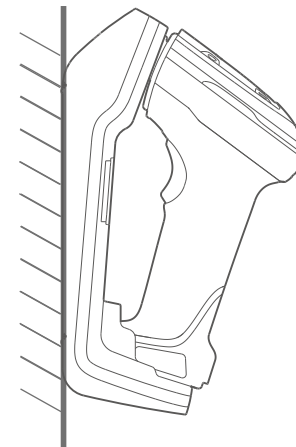

After the wall mounted switch is turned on, the scanner can be placed on the base without falling

How To Use The Wall Mounted

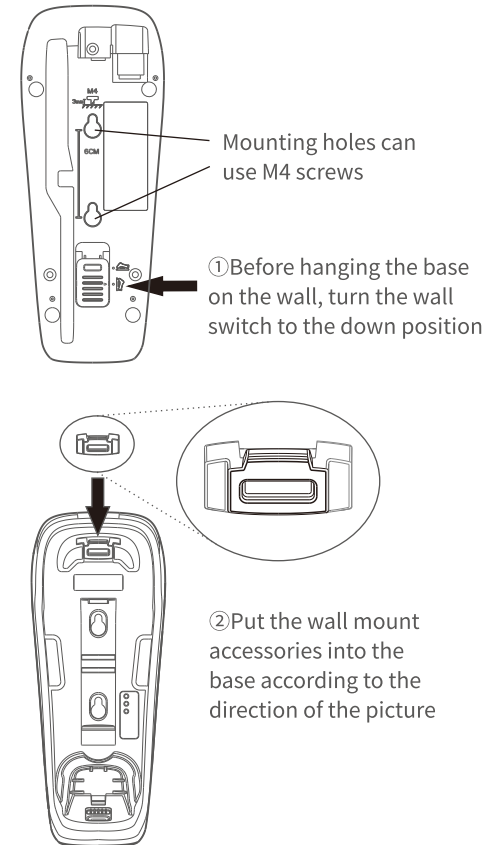

Indicator Light & Buzzer Status

Working Status (Barcode Scanner)	Indicator Light Prompt	Buzzer Prompt
Power on	Green light on	Continuous beep
The scanner is in standby status or the scanner is not powered	N	N
Waiting for pairing connection	Flashing state lasts for 10s	Intermittent short beep lasts for 10s
Read Barcode Successfully	Green light flashes	A short beep
Barcode transmission completed	Green light flashes	A short beep
Transmission error or invalid data	Red light flashes	Report an error with a long beep
Low battery alert status	Red light on	N
Transmission error or invalid data	Red light flashes	Report an error with a long beep
Called status	Blue light flash	short beep 3 times long beep 1 time

Working status (base)	Base Indicator Light Prompt	Buzzer Prompt
Base power on	N	Beep 4 times
The base has successfully connected with the scanner	Green light on	N
The base is disconnected from the scanner	Green breathing light status	N
Data has been transferred	Green light flashes	N
Information reset, transmission error or invalid data	Red light on	N
Scanner is on charging	Yellow breathing light status	N
Call barcode scanner	Sky blue light flashes	N

Working status (backup battery compartment)	Battery charging indicator prompt
The battery compartment is powered, or the battery in the battery compartment is fully charged	Three battery indicator lights are always on
The battery is charging	Battery Indicator flashes

Common Problem

Question 1: The scanner does not work

Answer : The scanner may be exhausted

Solution: Put the scanner into the base to charge or replace the battery

Question 2: The scanner does not upload data (there is no prompt of successful barcode reading)

Answer: The reading of the corresponding barcode type is not enabled

Solution: Turn on the reading of the corresponding barcode type

Answer: The barcode is damaged, distorted and deformed, resulting in unreadable

Solution: Make sure the barcode is not damaged, twisted or deformed

Answer: The distance between the scanner and the barcode is incorrect

Solution: move the scanner closer or away from the barcode

Question 3: The scanner does not upload data (there is a prompt of successful barcode reading)

Answer: The host interface configuration is incorrect

Solution: scan the corresponding host interface parameter barcode to set

Answer: The scanner has not been paired with the base
Solution: follow the pairing method to pair with the base

Answer: beyond the effective transmission distance
Solution: Ensure that the scanner and the base are within the effective communication distance

Answer: The cable is loose or damaged
Solution: Make sure that the cable has been connected and fixed. If you still cannot upload data, please contact after-sale service.

Question 4: The data is incorrectly displayed on the host

Answer: The input method is incorrect
Solution: Use English input method

Answer: The host interface configuration is incorrect
Solution: scan the corresponding host interface parameter barcode for setting

Answer: The zone configuration is incorrect
Solution: Choose the corresponding country/region and language coding scheme

Precautions

- When you get the barcode scanner first time, the battery may not be fully charged Status, please use the charging base to fully charge before use
- Do not use aiming light or fill light to shoot people's eyes directly during use
- Please use the original charger, do not change the base or adapter at will
- Please avoid metal objects (such as keys, etc.) from contacting battery electrodes or artificially short-circuiting battery electrodes
- Do not put the battery in an overheated, humid or corrosive environment, and do not squeeze or bump
- If the battery is swollen, please replace it with a new one in time

FCC STATEMENT :

This device complies with Part 15 of the FCC Rules. Operation is subject to the following two conditions:

This device may not cause harmful interference, and

This device must accept any interference received, including interference that may cause undesired operation.

Warning: Changes or modifications not expressly approved by the party responsible for compliance could void the user's authority to operate the equipment.

NOTE: This equipment has been tested and found to comply with the limits for a Class B digital device, pursuant to Part 15 of the FCC Rules. These limits are designed to provide reasonable protection against harmful interference in a residential installation. This equipment generates uses and can radiate radio frequency energy and, if not installed and used in accordance with the instructions, may cause harmful interference to radio communications. However, there is no guarantee that interference will not occur in a particular installation. If this equipment does cause harmful interference to radio or television reception, which can be determined by turning the equipment off and on, the user is encouraged to try to correct the interference by one or more of the following measures:

Reorient or relocate the receiving antenna.

Increase the separation between the equipment and receiver.

Connect the equipment into an outlet on a circuit different from that to which the receiver is connected.

Consult the dealer or an experienced radio/TV technician for help.

RF warning statement:

The device has been evaluated to meet general RF exposure requirement. The device can be used in portable exposure condition without restriction.