

## Quick Start Guide

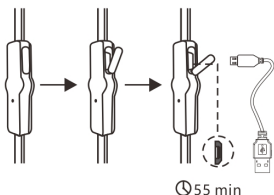

### CHARGING

Start charging your NITRO-X by inserting the included cable.

55min gives full charge.  
10min gives 2 hours of playtime.

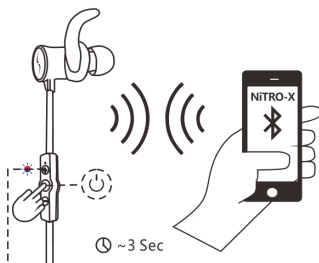

### QUICK'N' EASY PAIRING

1. Activate bluetooth on your transmitting device.
2. Press power button on the NITRO-X remote until the LED switches in red/blue color.
3. Choose "NITRO X" on your transmitting device.
4. The voice prompt "NITRO-X connected" will indicate when the pairing process is completed.

LED indication	Function
	No device connected
	Device connected
	Pairing mode
	Low battery <10%
	Charging battery

### COMFORT & FITTING

Choose the correct size of wings and pads for your ears to maximize comfort and listening experience.



This device complies with part 15 of the FCC Rules. Operation is subject to the following two conditions: (1) this device may not cause harmful interference, and (2) this device must accept any interference received, including interference that may cause undesired operation.

Any changes or modifications not expressly approved by the party responsible for compliance could void the user's authority to operate the equipment.

NOTE: This equipment has been tested and found to comply with the limits for a Class B digital device, pursuant to Part 15 of the FCC Rules. These limits are designed to provide reasonable protection against harmful interference in a residential installation. This equipment generates, uses and can radiate radio frequency energy and, if not installed and used in accordance with the instructions, may cause harmful interference to radio communications. However, there is no guarantee that interference will not occur in a particular installation.

If this equipment does cause harmful interference to radio or television reception, which can be determined by turning the equipment off and on, the user is encouraged to try to correct the interference by one or more of the following measures:

- Reorient or relocate the receiving antenna.
- Increase the separation between the equipment and receiver.
- Connect the equipment into an outlet on a circuit different from that to which the receiver is connected.
- Consult the dealer or an experienced radio/TV technician for help.

The device has been evaluated to meet general RF exposure requirement. The device can be used in portable exposure condition without restriction