

SCHOK FLIP

QUICK GUIDE

(Model number SC3218B / SC3218T)



Conventions used in this guide

In this user guide, we use the following symbols to indicate useful and important information:

NOTE: Notes, usage tips, or additional information.



Warning

Situations that could cause injury to yourself or others.



Caution

Situations that could cause damage to your device or other equipment.



Tips

Suggestions and advice that can help in the usage of the device.

Index:

Basics

Specifications

Inbox

Phone overview

Basic operation

Battery

Inserting the battery

How to insert the device SIM card and Micro SD card

Turning phone On or Off

How to navigate the operating system of your Schok flip

The left and right soft keys

The home screen and Status bar

Daily operation use

How to make phone calls

To answer, accept or reject phone calls

To end or reject a phone call

To make a phone call from the contact list

The recent phone call window

Switching between current phone calls

Setting up your voice mail

Checking up your voice mail

Schok Virtual mouse

Safety and Precautions

Basics:

Specifications:

Model number:	SC3218B
Operating system:	AOSP Android™ 11 (Go edition)
Display Size & Resolution:	3.2" 320 x 240 (QVGA) (Color)
Secondary Display:	2" 176 x 220 (Color)
Processor:	Qualcomm® QM215
Processor speed and number of core:	1.2GHz / Quad-Core
Graphic processing unit (GPU):	Adreno 308 @ 485MHz
Memory (RAM):	1 GB DDR 3
System and User Memory:	8 GB
SD Card Slot max capacity:	128 GB
Sim card slots and SIM size:	1 Nano SIM card
Rear Camera (primary):	5MP with flash
Front Camera:	Using rear camera and 2 nd display as viewfinder
Rear camera video recording:	VGA @ 30 FPS
Battery type:	Lithium ION rechargeable
Battery capacity:	3.8V 2,000 mAh / 7.6Wh
Battery limited voltage:	4.35V
Battery standard:	UL2054, 1/CP6/50/59
Wi-Fi and band:	802.11/a/b/g/n. 2.4GHz
GPS:	GPS & AGPS
Bluetooth:	4.2 with BR/EDR + BLE
USB port:	Type-C™ connector
G-Sensor:	Yes
Barometer sensor:	Yes
Light and Proximity sensor:	Yes
Phone communication standards:	4GLTE/VoLTE
Phone bands 2G:	2G: GSM 850/900/1800/1900
Phone bands 3G:	UMTS Band 2/4/5
Phone CDMA bands:	BC0 / BC1 / BC10
Phone bands 4G:	2/4/5/12/13/17/25/26
Phone bands 4G:	28(A&B)/30/41/66/71
Hearing Aid Compatibility:	M3 / T4
Water rating:	IPX2
Dimensions:	4.53 x 2.44 x 0.81 inches
Phone weight with Battery:	5.50oz / 157g
Battery weight:	1.27oz / 36g
Structure outside & Inside:	Plastic
Phone electric input:	5.0V ± 1.0A
USB Wall charger input:	100-240V ~ 50/60Hz 0.2A
USB Wall charger output:	5.0V ± 1.0A

In Box

The Schok flip comes with the following items included in the box:

1. Schok flip phone (SC3218)
2. Rechargeable Lithium-Ion battery (SB2000)
3. USB Type-C™ charging and sync cable (2.62ft / .8m)
4. Quick start guide
5. Safety precautions guide.

Phone Overview



Basic operation

Battery



TIP

Browsing the web frequently, extended data and GPS usage, being in a poor signal area, or subjecting the device to extreme temperatures will cause the battery to discharge quicker than normal. To increase battery life, limit your data usage, or turn off location, WiFi and Bluetooth when not required. Battery operating time gradually decreases over time.

Your battery can be fully charged in less than three hours. In order to have the battery at optimal operation, never leave the device charging for extended periods of time. As a good rule of thumb, disconnect the charging cable after battery has been fully charged.

Warning

The battery of the Schok flip is removable. Only use a Schok authorized replacement battery, otherwise it can damage your phone and will lose its warranty. The Schok battery replacement model number for this device is **SB2000**.

Inserting the Battery

1. With the phone facing down, insert fingernail into the back cover cutout and gently but firmly lift and remove the back cover.
2. Insert the removable battery making sure that the three gold connectors are lined up to the phone gold connectors.
3. Put the back cover back in place, press down along all the edges of the phone, every time there is a clicking sound, the back cover is being secured in place.
4. Connect the USB-Type-C side of the cable to the Schok Classic USB Type-C connector.
5. Connect the USB side (Larger connector) of the cable to the wall charger USB port.
6. Connect the phone wall charger to the electric outlet.
7. Charge your device for at least two hours.



USB Type-C connector. (Insert charging cable here)

Back cover cutout. (Insert fingernail here)

How to insert the device SIM card and Micro SD card

1. With the phone facing down, insert fingernail into the back cover cutout (Image on page 7), gently but firmly lift and remove the back cover.
2. Remove the battery by inserting the fingernail at the bottom of the battery. It is marked "Pull/Jale" and lift the battery out.
3. Locate the slot for the Nano SIM card (A) and slide it completely until there a natural stop by reaching the end of the tray. The angled cut of the SIM card must be facing the left space of the SIM card slot, the SIM card gold-colored connectors must be facing down.
4. To insert or remove a Micro SD Memory Card please repeat number one and number two of this list.
5. Locate the slot for the micro SD card (B)
6. Slide the Micro SD card until you feel a natural stop by reaching the end of the tray.

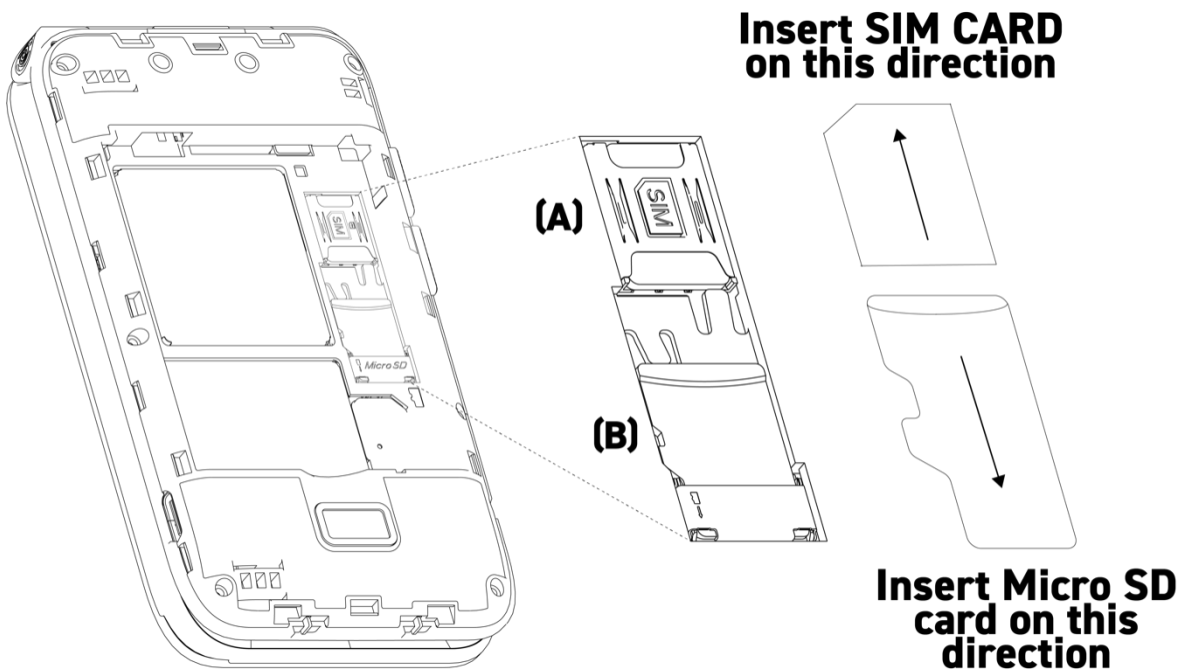

Turning phone On or Off

To turn ON; Firmly, “press and hold” the power button for three seconds.

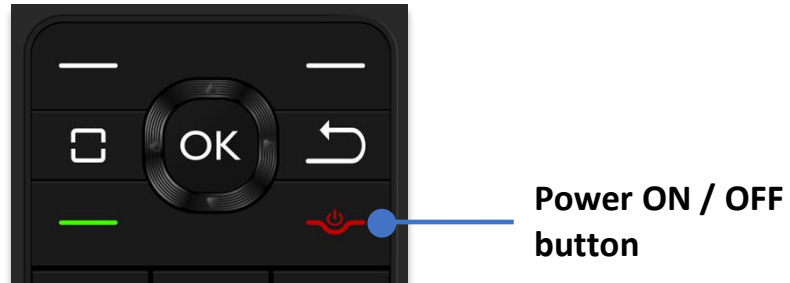

To turn OFF; Firmly, “press and hold” the power button for one second. A menu with three options will appear, using the Navigation key, highlight the “Power off” icon, click the OK key.

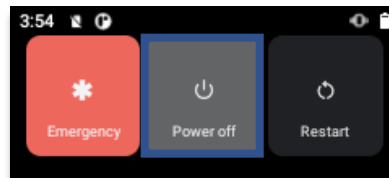

How to navigate the operating system of your Schok flip

By pressing the 4-way Navigation Key you can scroll and select items. Think of it as a compass in which you have UP, DOWN, LEFT and RIGHT. When the item is selected, simply press the OK key.



The Left and Right soft keys

The soft key is an App or feature-driven multi-function key that when available, allows to select certain applications or commands at either the left or the right bottom of the display.

The Home screen and Status bar

The Home Screen is where you can see the time, date, and access the shortcut to open contacts, messages, or open the menu apps window.

The Status Bar which resides on top of the home screen shows the phone vitals such as battery level, signal strength, time, and notifications such as alarms, messages, calendar events to mention some.

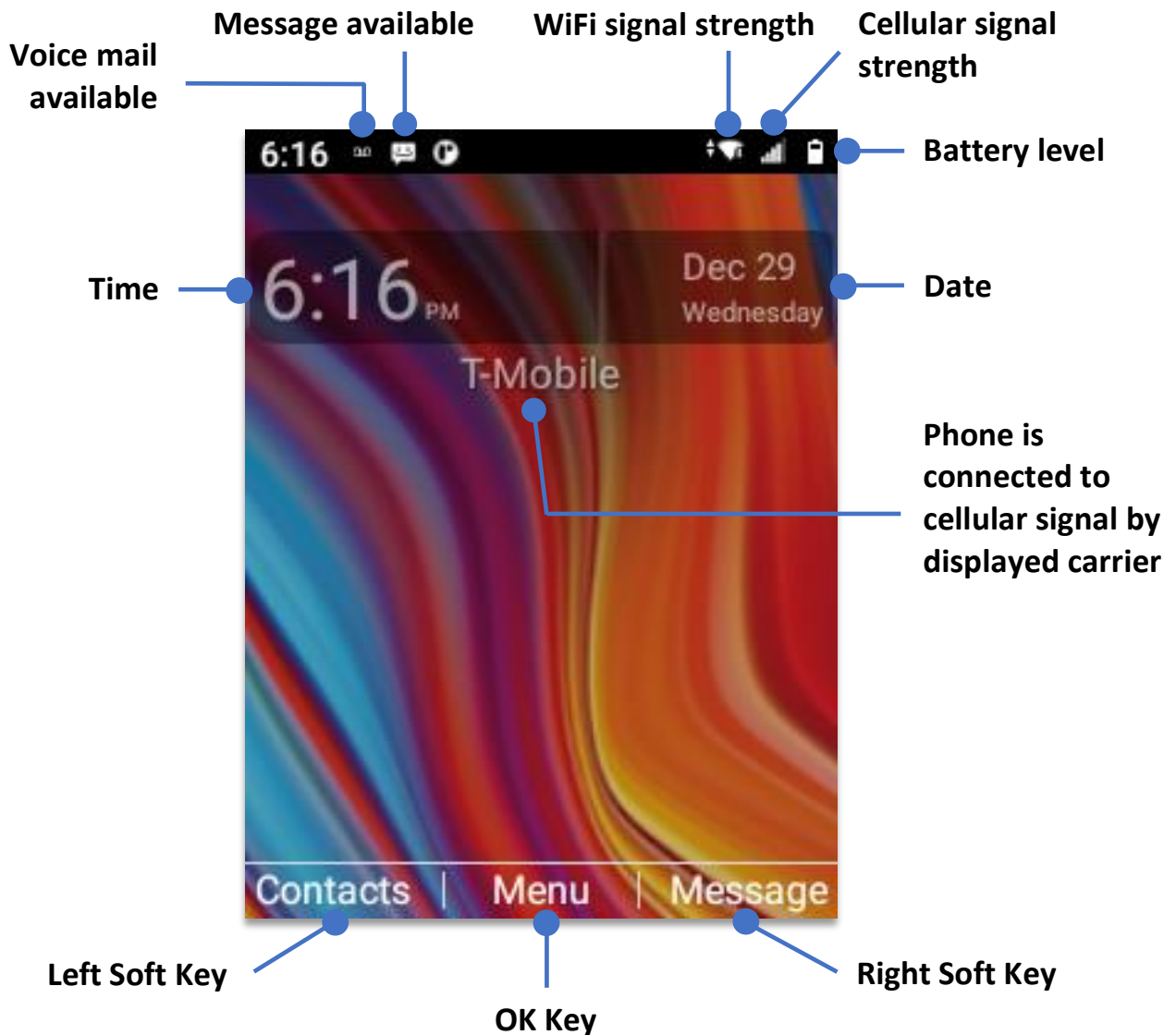

Daily operation

How to make phone calls

From the Home Screen, simply input the number and press the **OK key** to initiate the call.



To make a phone call from anywhere in the system, simply press the **Back key** until the Home Screen is displayed, then, input the number using the device keypad and press the **OK key** to initiate the call.

To answer, accept or reject phone calls

If the phone is closed and begins to ring, the caller ID will tell you who is calling. Simply flip (open) the phone and automatically the call will be answered.

If the phone lid is opened and begins to ring, the caller ID will tell you on the main display who is calling, press the **Answer call** Key to answer the call.

To end or reject a phone call

To end or reject a phone call, simply press the **End call key**.



To make a phone call from the contact list

There are two current methods to open the Contacts application.

Method one: Using the Contacts shortcut.

1. From the home screen, click the OK key to open your applications.
2. Using the navigation key, highlight the **“Contacts”** app and press the **OK Key**.
3. Using the navigation key, scroll down or up until you find the contact that you desire to call.
4. Press the **Answer Call** key to initiate the phone call.

Method two: Open the Contacts application.



1. From the home screen, click the OK key to open your applications.
2. Using the navigation key, highlight the **“Contacts”** app and press the **OK Key**.
3. Using the navigation key, scroll down or up until you find the contact that you desire to call.
4. Press the **Answer Call** key to initiate the phone call.

The recent calls window

The Schok flip has the ability to automatically create a recent phone list of calls either accepted, missed or dialed. This list is constantly been updated by the new phone calls, deleting the oldest entries.

From the home menu, press the **Answer Key**. The recent calls window will appear.

Using the Navigation key, scroll left or right to display the records by the type of call.

“All calls” will be the default displayed, one click right and it will change the window to **“Missed calls”**, another  right click and **“Received calls”** will appear ; finally another right click will show **“Dialed Calls”** 

The recent calls window will display the date, time and the phone number. If the phone number is already added to the address book (Contacts application) it will show the name of the contact.

If there is the need to get more information from an specific recent phone call, choose from the following options:

1. Press **Left Soft key** to send a message.
2. Press **OK key** to view more call information.
3. Press **Right Soft key** to open the options page, showing:
 - a. Add to contacts: Save the caller's number as new contact
 - b. Delete: Delete the phone record.
 - c. Delete multiple: Select the records you want to delete.
 - d. Lock: Block or unblock calls from the marked phone number
 - e. Add to call rejection: Save the number to a call rejection list

Switching between current phone calls

If you are on a phone call and you receive another phone call, the Schok flip will beep indicating that you have another call waiting. The caller ID will work during the call and let you know who is calling.

If you want to put the current call on hold and answer the new phone call, simply Press the **Answer call** key.

If you want to return to the first phone call, press the **Answer call** key again.

Three way call: To do a three-way phone call, while on the first call, press the Right Soft Key (Options), select New Call and dial the phone number of the second party.

When the second party answers the phone, press the **Right Soft Key** (Options), then press the number 2 Key to merge the call.

Setting up your voice mail

1. Long press number one (1) on the keypad or dial your phone number and press the Answer Call button.
2. Follow the instructions.

Checking up your voice mail

1. Long press number one (1) on the keypad or dial your phone number and press the Answer Call button.
2. Follow the instructions.

Schok virtual mouse

A unique feature of the Schok flip is the ability to invoke a virtual mouse. This feature is extremely useful if you need to control an application installed on the phone that was made for touch panel devices such as smartphones.

NOTE: This is not a real mouse but a virtual mouse made by software, than when invoked, an arrow appears on the display. This arrow can be controlled by the navigation keys resulting of being able to mimic the movement of a mouse and the right click. The speed of the typical right click will take more than normal.

To invoke the virtual mouse:

1. Whenever the menu or position that you are, simply long press the **OK for 2 seconds**.
2. An arrow will appear on the screen
3. Using the navigation keys, move the arrow up, down, left or right.
4. When the arrow is in the correct position, simply click the **OK key** to simulate a right click.

To de-activate the virtual mouse:

1. Whenever the menu or position that you are, simply long press the **OK for 2 seconds**.
2. An arrow will appear on the screen

Safety and Precautions

Please read before proceeding

THE BATTERY OF THIS DEVICE IS REMOVABLE, HOWEVER, ONLY USE ORIGINAL SCHOK SB2000 LITHIUM ION BATTERY. NEVER TRY TO DISSASSEMBLE OR TAKE APART THE BATTERY, OR THE DEVICE, AS YOUR WARRANTY WILL BE INVALIDATED.

Privacy restrictions

Some countries require full disclosure of recorded telephone conversations, and stipulate that you must inform the person with whom you are speaking that the conversation is being recorded. Always obey the relevant laws and regulations of your country when using the recording feature of your phone.

Disclaimers

ANY WEATHER, STOCK, OR OTHER INFORMATION, DATA, OR DOCUMENTATION (“ACCESSED INFORMATION”) ARE PROVIDED “AS IS” AND WITHOUT ANY WARRANTY OR ANY TECHNICAL SUPPORT. TO THE MAXIMUM EXTENT PERMITTED BY APPLICABLE LAW, Schok, LLC expressly disclaim any and all representations and warranties, arising by law or otherwise, related to the Accessed Information, including without limitation any express or implied representation or warranty of merchantability, fitness for a particular purpose, non-infringement, quality, accuracy, completeness, effectiveness, reliability, or usefulness. Without limiting the foregoing, it is further understood that Schok LLC is not responsible for any use of the Accessed Information or the results arising from such use and that you use such information at your own risk.

Limitation of damages

TO THE MAXIMUM EXTENT PERMITTED BY APPLICABLE LAW, IN NO EVENT SHALL AMERICAN NETWORK SOLUTIONS LLC OR ITS AFFILIATES BE LIABLE TO YOU, ANY USER, OR THIRD PARTY FOR ANY INDIRECT, SPECIAL, CONSEQUENTIAL, INCIDENTAL OR PUNITIVE DAMAGES OF ANY KIND, ARISING IN CONTRACT, TORT, OR OTHERWISE, INCLUDING, BUT NOT LIMITED TO, INJURY, LOSS OF REVENUE, LOSS OF GOODWILL, LOSS OF BUSINESS OPPORTUNITY, LOSS OF DATA, AND/OR LOSS OF PROFITS, REGARDLESS OF THE FORESEEABILITY THEREOF OR WHETHER AMERICAN NETWORK SOLUTIONS LLC OR ITS AFFILIATES HAVE BEEN ADVISED OF THE POSSIBILITY OF SUCH DAMAGES. AND IN NO EVENT SHALL THE TOTAL LIABILITY OF AMERICAN NETWORK SOLUTIONS LLC OR ITS AFFILIATES EXCEED THE AMOUNT RECEIVED FROM YOU, REGARDLESS OF THE LEGAL THEORY UNDER WHICH THE CAUSE OF ACTION IS BROUGHT. THE FOREGOING DOES NOT AFFECT ANY STATUTORY RIGHTS WHICH MAY NOT BE DISCLAIMED.

Important health information and safety precautions

When using this product, the safety precautions below must be taken to avoid possible legal liabilities and damages. Retain and follow all product safety and operating instructions. Observe all warnings in the operating instructions on the product. To reduce the risk of bodily injury, electric shock, fire and damage to the equipment, observe the following precautions.

Electrical safety

This product is intended for use when supplied with power from the designated battery or power supply unit. Other usage may be dangerous and will invalidate any approval given to this product.

Safety precautions for proper grounding installation

Connecting to improperly grounded equipment can result in an electric shock to your device. This product is equipped with a USB Cable for connecting with desktop or notebook computer. Be sure your computer is properly grounded (earthed) before connecting this product to the computer. The power supply cord of a desktop or notebook computer has an equipment grounding conductor and a grounding plug. The plug must be plugged into an appropriate outlet which is properly installed and grounded in accordance with all local codes and ordinances.

Safety precautions for power supply unit

1. **Use the correct external power source.** This product should be operated only from the type of power source indicated on the electrical ratings label. If you are not sure of the type of power source required, consult your authorized service provider or local power company. For a product that operates from battery power or other sources, refer to the operating instructions that are included with the product. This product should be operated only with the following designated power supply unit(s). Travel charge: Input: 100-240V, 50/60Hz, 0.2A Output: 5V, 1000mA
2. **Handle battery packs carefully.** This product contains a Lithium-ion polymer or Lithium-ion battery. There is a risk of fire and burns if the battery pack is handled improperly. Do not attempt to open or service the battery pack. Do not disassemble, crush, puncture, short external contacts or circuits, dispose of in fire or water, or expose a battery pack to temperatures higher than **140°F (60°C)**.
 **Danger of explosion if battery is incorrectly replaced.** To reduce risk of fire or burns, do not disassemble, crush, puncture, short external contacts, expose to temperature above **140°F (60°C)**, or dispose of in fire or water. Replace only with specified SB2000 battery. Recycle or dispose used batteries according to the local regulations or reference guide supplied with your product.



3. Take extra precautions

- Keep the battery or device dry and away from water or any liquid as it may cause a short circuit.
- Keep metal objects away so they don't come in contact with the battery or its connectors as it may lead to short circuit during operation.
- The phone should only be connected to products that bear the USB-IF logo or have completed the USB-IF compliance program.
- Do not use a battery that appears damaged, deformed, or discolored, or the one that has any rust on its casing, overheats, or emits a foul odor.
- Always keep the battery out of the reach of babies and small children, to avoid swallowing of the battery. Consult the doctor immediately if the battery is swallowed.
- Only use the battery with a charging system that has been qualified with the system per this standard, IEEE-Std-1725. Use of an unqualified battery or charger may present a risk of fire, explosion, leakage or other hazard.
- Replace the battery only with another battery that has been qualified with the system per this standard, IEEE-Std-1725. Use of an unqualified battery may present a risk of fire, explosion, leakage or other hazard.
- Avoid dropping the phone or battery. If the phone or battery is dropped, especially on a hard surface, and the user suspects damage, take it to a service center for inspection.
- If the battery leaks:
 - Do not allow the leaking fluid to come in contact with skin or clothing. If already in contact, flush the affected area immediately with clean water and seek medical advice.
 - Do not allow the leaking fluid to come in contact with eyes. If already in contact, DO NOT rub; rinse with clean water immediately and seek medical advice.
 - Take extra precautions to keep a leaking battery away from fire as there is a danger of ignition or explosion.

4. Safety precautions for direct sunlight

Keep this product away from excessive moisture and extreme temperatures. Do not leave the product or its battery inside a vehicle or in places where the temperature may exceed 140°F (60°C), such as on a car dashboard, window sill, or behind a glass that is exposed to direct sunlight or strong ultraviolet light for extended periods of time. This may damage the product, overheat the battery, or pose a risk to the vehicle.

5. Prevention of hearing loss

Permanent hearing loss may occur if earphones or headphones are used at high volume for prolonged periods of time.

6. Safety in aircraft

Due to the possible interference caused by this product to an aircraft's navigation system and its communications network, using this device's phone function on board an airplane is against the law in most countries. If you want to use this device when on board an aircraft, remember to turn off your RF on your phone by switching to Airplane Mode.

7. Environment restrictions

Do not use this product in gas stations, fuel depots, chemical plants or where blasting operations are in progress, or in potentially explosive atmospheres such as fueling areas, fuel storehouses, below deck on boats, chemical plants, fuel or chemical transfer or storage facilities, and areas where the air contains chemicals or particles, such as grain, dust, or metal powders. Please be aware that sparks in such areas could cause an explosion or fire resulting in bodily injury or even death.

8. Explosive atmospheres

When in any area with a potentially explosive atmosphere or where flammable materials exist, the product should be turned off and the user should obey all signs and instructions. Sparks in such areas could cause an explosion or fire resulting in bodily injury or even death. Users are advised not to use the equipment at refueling points, such as service or gas stations, and are reminded of the need to observe restrictions on the use of radio equipment in fuel depots, chemical plants, or where blasting operations are in progress. Areas with a potentially explosive atmosphere are often, but not always, clearly marked. These include fueling areas, below deck on boats, fuel or chemical transfer or storage facilities, and areas where the air contains chemicals or particles, such as grain, dust, or metal powders.

9. Road safety

Full attention must be given to driving at all times in order to reduce the risk of an accident. Using a phone while driving (even with a hands-free kit) causes distraction and can lead to an accident. You must comply with local laws and regulations restricting the use of wireless devices while driving.

10. Safety precautions for RF exposure

- a. Avoid using your phone near metal structures (for example, the steel frame of a building).
- b. Avoid using your phone near strong electromagnetic sources, such as microwave ovens, sound speakers, TV and radio.
- c. Use only original manufacturer-approved accessories, or accessories that do not contain any metal.
- d. Use of non-original manufacturer-approved accessories may violate your local RF exposure guidelines and should be avoided.

11. Interference with medical equipment functions

This product may cause medical equipment to malfunction. The use of this device is forbidden in most hospitals and medical clinics. If you use any other personal medical device, consult the manufacturer of your device to determine if they are adequately shielded from external RF energy. Your physician may be able to assist you in obtaining this information. Turn your phone OFF in health care facilities when any regulations posted in these areas instruct you to do so. Hospitals or health care facilities may be using equipment that could be sensitive to external RF energy.

12. Non-ionizing radiation

Your device has an internal antenna. This product should be operated in its normal-use position to ensure the radioactive performance and safety of the interference. As with other mobile radio transmitting equipment, users are advised that for satisfactory operation of the equipment and for the safety of personnel, it is recommended that no part of the human body be allowed to come too close to the antenna during operation of the equipment.

Use only the supplied integral antenna. Use of unauthorized or modified antennas may impair call quality and damage the phone, causing loss of performance and SAR levels exceeding the recommended limits as well as result in non-compliance with local regulatory requirements in your country. To assure optimal phone performance and ensure human exposure to RF energy is within the guidelines set forth in the relevant standards, always use your device only in its normal-use position. Contact with the antenna area may impair call quality and cause your device to operate at a higher power level than needed. Avoiding contact with the antenna area when the phone is IN USE optimizes the antenna performance and the battery life.

13. Electrical safety

Accessories

- Use only approved accessories.
- Do not connect with incompatible products or accessories.
- Take care not to touch or allow metal objects, such as coins or key rings, to contact or short circuit the battery terminals.

Connection to a car

- Seek professional advice when connecting a phone interface to the vehicle electrical system.

Faulty and damaged products

- Do not attempt to disassemble the phone or its accessory.
- Only qualified personnel must service or repair the phone or its accessory.

14. General precautions

You alone are responsible for how you use your phone and any consequences of its use. You must always switch off your phone wherever the use of a phone is prohibited. Use of your phone is subject to safety measures designed to protect users and their environment.

Avoid applying excessive pressure to the device

Do not apply excessive pressure on the screen and the device to prevent damaging them and remove the device from your pants' pocket before sitting down. It is also recommended that you store the device in a protective case and only use the device stylus or your finger when interacting with the touch screen. Cracked display screens due to improper handling are not covered by the warranty.

Device getting warm after prolonged use

When using your device for prolonged periods of time, such as when you're talking on the phone, charging the battery or browsing the Web, the device may become warm. In most cases, this condition is normal and therefore should not be interpreted as a problem with the device.

Heed service markings

Except as explained elsewhere in the Operating or Service documentation, do not service any product yourself. Service needed on components inside the device should be done by an authorized service technician or provider.

Protect your phone

- Always treat your phone and its accessories with care and keep them in a clean and dust-free place.
- Do not expose your phone or its accessories to open flames or lit tobacco products.
- Do not expose your phone or its accessories to liquid, moisture or high humidity.
- Do not drop, throw or try to bend your phone or its accessories.
- Do not use harsh chemicals, cleaning solvents, or aerosols to clean the device or its accessories.
- Do not paint your phone or its accessories.
- Do not attempt to disassemble your phone or its accessories, only Schok authorized personnel must do so.
- Do not expose your phone or its accessories to extreme temperatures, minimum - 4°F (-20°C) and maximum 122°F (50°C).
- Please check local regulations for disposal of electronic products.
- Do not carry your phone in your back pocket as it could break when you sit down. If Damaged, it will require service
- Unplug the product from the electrical outlet, remove the battery and refer servicing to an authorized service technician or provider under the following conditions:
 - Liquid has been spilled or an object has fallen into the product.
 - The product has been exposed to rain or water.
 - The product has been dropped or damaged.
 - There are noticeable signs of overheating.
 - The product does not operate normally when you follow the operating instructions.

Avoid hot areas

The product should be placed away from heat sources such as radiators, heat registers, stoves, or other products (including amplifiers) that produce heat.

Avoid wet areas

Never use the product in a wet location.

Avoid using your device after a dramatic change in temperature

When you move your device between environments with very different temperature and/or humidity ranges, condensation may form on or within the device. To avoid damaging the device, allow sufficient time for the moisture to evaporate before using the device.

NOTICE:  When taking the device from low-temperature conditions into a warmer environment or from high-temperature conditions into a cooler environment, allow the device to acclimate to room temperature before turning on power.

Avoid pushing objects into product

Never push objects of any kind into cabinet slots or other openings in the product. Slots and openings are provided for ventilation. These openings must not be blocked or covered.

Air bags

Do not place a phone in the area over an air bag or in the air bag deployment area. Store the phone safely before driving your vehicle.

Mounting accessories

Do not use the product on an unstable table, cart, stand, tripod, or bracket. Any mounting of the product should follow the manufacturer's instructions and should use a mounting accessory recommended by the manufacturer.

Avoid unstable mounting

Do not place the product with an unstable base.

Use product with approved equipment

This product should be used only with personal computers and options identified as suitable for use with your equipment.

Adjust the volume

Turn down the volume before using headphones or other audio devices.

Cleaning

Unplug the product from the wall outlet before cleaning. Do not use liquid cleaners or aerosol cleaners. Use a damp cloth for cleaning, but NEVER use water to clean the LCD screen or any internal part of the device.

Small children

Do not leave your phone and its accessories within the reach of small children or allow them to play with it. They could hurt themselves, or others, or could accidentally damage the phone. Your phone contains small parts with sharp edges that may cause an injury, or which could become detached and create a choking hazard.

Repetitive motion injuries

- To minimize the risk of RSI, when texting or playing games with your phone:
- Do not grip the phone too tightly
- Press the buttons lightly
- Make use of the special features in the handset which minimize the number of buttons which have to be pressed, such as message templates and predictive text.
- Take lots of breaks to stretch and relax.

Operating machinery

Full attention must be given to operating the machinery in order to reduce the risk of an accident.

Loud noise

This phone is capable of producing loud noises which may damage your hearing.

Emergency calls

This phone, like any wireless phone, operates using radio signals, which cannot guarantee connection in all conditions. Therefore, you must never rely solely on any wireless phone for emergency communications.

Regulatory agency identifications**1. FCC Regulations:**

This mobile phone complies with part 15 of the FCC Rules. Operation is subject to the following two conditions: (1) This device may not cause harmful interference, and (2) this device must accept any interference received, including interference that may cause undesired operation. This mobile phone has been tested and found to comply with the limits for a Class B digital device, pursuant to Part 15 of the FCC Rules. These limits are designed to provide reasonable protection against harmful interference in a residential installation. This equipment generates, uses and can radiated radio frequency energy and, if not installed and used in accordance with the instructions, may cause harmful interference to radio communications.

However, there is no guarantee that interference will not occur in a particular installation. If this equipment does cause harmful interference to radio or television reception, which can be determined by turning the equipment off and on, the user is encouraged to try to correct the interference to radio or television reception, which can be determined by turning the equipment off and on, the user is encouraged to try to correct the interference by one or more of the following measures:

- Reorient or relocate the receiving antenna.
- Increase the separation between the equipment and receiver.
- Connect the equipment into an outlet on a circuit different from that to which the receiver is connected.
- Consult the dealer or an experienced radio/TV technician for help.
- Changes or modifications not expressly approved by the party responsible for compliance could void the user's authority to operate the equipment.

2. RF Exposure Information (SAR)

This mobile phone meets the government's requirements for exposure to radio waves. This phone is designed and manufactured not to exceed the emission limits for exposure to radio frequency (RF) energy set by the Federal Communications Commission of the U.S. Government. The exposure standard for wireless mobile phones employs a unit of measurement known as the Specific Absorption Rate, or SAR. The SAR limit set by the FCC is 1.6W/kg. Tests for SAR are conducted using standard operating positions accepted by the FCC with the phone transmitting at its highest certified power level in all tested frequency bands. Although the SAR is determined at the highest certified power level, the actual SAR level of the phone while operating can be well below the maximum value. This is because the phone is designed to operate at multiple power levels so as to use only the power required to reach the network. In general, the closer you are to a wireless base station, the lower the power output.

The highest SAR value for the model phone as reported to the FCC when tested for use at the ear is **0.36 W/kg** and when worn on the body, as described in this user guide, is **1.02 W/kg** (Body-worn measurements differ among phone models, depending upon available accessories and FCC requirements.)

While there may be differences between the SAR levels of various phones and at various positions, they all meet the government requirement.

The FCC has granted an Equipment Authorization for this model phone with all reported SAR levels evaluated as in compliance with the FCC RF exposure guidelines. SAR information on this model phone is on file with the FCC and can be found under the Display Grant section of www.fcc.gov/oet/ea/fccid after searching on FCC ID: 2ALZM-SC3218B.

For body worn operation, this phone has been tested and meets the FCC RF exposure guidelines for use with an accessory that contains no metal and the positions the handset a minimum of 1.5 cm from the body. Use of other accessories may not ensure compliance with FCC RF exposure guidelines. If you do not use a body-worn accessory and are not holding the phone at the ear, position the handset a minimum of 1.5 cm from your body when the phone is switched on.

3. HEARING AID COMPATIBILITY HAC FOR WIRELESS TELECOMMUNICATIONS DEVICES

THIS PHONE HAS A HAC RATING OF M4/T3. WHAT IS HEARING AID COMPATIBILITY?

The Federal Communications Commission has implemented rules and a rating system designed to enable people who wear hearing aids to more effectively use these wireless telecommunications devices. The standard for compatibility of digital wireless phones with hearing aids is set forth in American National Standard Institute (ANSI) standard C63.19. There are two sets of ANSI standards with ratings from one to four (four being the best rating): an “M” rating for reduced interference making it easier to hear conversations on the phone when using the hearing aid microphone, and a “T” rating that enables the phone to be used with hearing aids operating in the tele-coil mode thus reducing unwanted background noise.

HOW WILL I KNOW WHICH WIRELESS PHONES ARE HEARING AID COMPATIBLE?

The Hearing Aid Compatibility rating of this smartphone is M4/T3. A phone is considered Hearing Aid Compatible for acoustic coupling (microphone mode) if it has an “M3” or “M4” rating. A digital wireless phone is considered Hearing Aid Compatible for inductive coupling (tele-coil mode) if it has a “T3” or “T4” rating.

HOW WILL I KNOW IF MY HEARING AID WILL WORK WITH A PARTICULAR DIGITAL WIRELESS PHONE?

- You’ll want to try a number of wireless phones so that you can decide which works the best with your hearing aids.
- You may also want to talk with your hearing aid professional about the extent to which your hearing aids are immune to interference, if they have wireless phone shielding, and whether your hearing aid has a HAC rating.

NEED SOME HELP?

The MySchok application installed in your Schok flip device is the portal where you can find statistics of your device, diagnostics, manuals and an always updated FAQ.

Also, you are welcome to visit www.schokgear.com or call us at **1-888-48-SCHOK**.

©2022 Schok LLC. All rights reserved. SC3218B, SC3218B – DOCV0.9