

# Acoustic AUDIO

by Goldwood™

## 5.1CH SOUNDBAR SPEAKER SYSTEM AA5190



Prior to first use, please read the manual carefully.

### Operation explanation:

#### Specifications

Power Audio: 700W Total System Power

Drive Units: 2.25" x 3 + 3" x 2 + 5.25" x 1

Frequency response: 20Hz-20KHz

Power supply: ~120V/60Hz

Dimensions: Soundbar: W23.6" x H2.8" x D3.2"

Subwoofer: W7.7" x H10" x D7.8"

Satellite: W3.7" x H4.6" x D4.5"

#### Features:

- Soundbar with built-in amplifier
- Full audio spectrum performance, ideal for your favorite entertainment from Mp3, Mp4, CD/DVD movies and digital playbacks.
- Quality materials : Only the best components to recreate sound across all frequencies.

#### Package contents

Soundbar	-----	1 pc
Subwoofer	-----	1 pc
Satellite	-----	2 pc
Remote control	-----	1 pc
User manual	-----	1 pc
Optical cable	-----	1 pc
3.5mm AUX cable	-----	1 pc
3.5mm RCA cable	-----	1 pc
Power adaptor	-----	1 pc

NO.1

### Button Panel on Soundbar

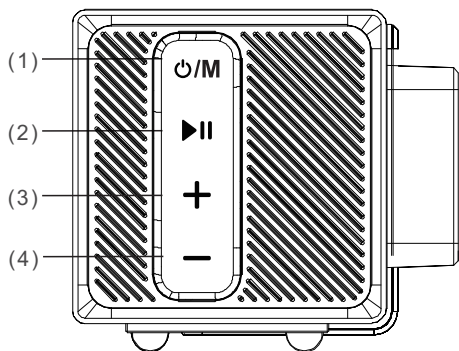

1. The Speaker system is in "⏻" (stand by) mode when power is on, and the LED is on. Please press the "⏻/M" to select appropriate source. Keeping the "⏻/M" key pressed for long will put it back in "⏻" (stand by) mode.

\*\* You can toggle through the input modes by pressing the "⏻/M" key.  
"BT" Denotes Bluetooth Mode. "HD" denotes ARC Mode.  
"OPT" denotes Optical Mode. "AU" denotes AUX Mode.  
"USB" denotes USB card mode.

2. Play/Pause the songs.
3. Long press for volume increase / short press for next track.
4. Long press for volume decrease / short press for prev track.

NO.2

### How to use the remote control

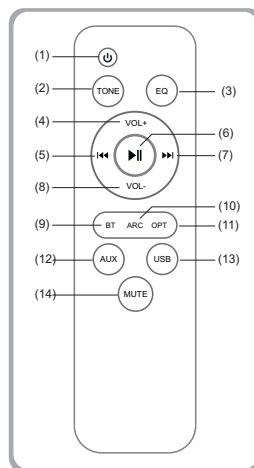

1. ⏻
2. TONE
3. EQ
4. VOL+
5. ⏮
6. ⏸
7. ⏭
8. VOL-
9. BT
10. ARC
11. OPT
12. AUX
13. USB
14. MUTE

1. ⏻: Power ON or Standby modes.
2. TONE: you can choose "TREBLE" and "BASS" "VOL+/-" means you can increase or decrease volume of "TREBLE" or "BASS".
3. EQ: NORMAL, CLASSIC, POP, ROCK, JAZZ.
4. VOL+: To increase the Volume by short or long press of VOL+.
5. ⏮: Play the previous song by pressing "⏮" but not in AUDIO mode.
6. ⏸: Play/pause in USB/BT mode and MUTE in AUDIO mode.
7. ⏭: Play next song by pressing "⏭", but not in AUDIO mode.
8. VOL-: To decrease the Volume by short or long press of VOL-.
9. BT: Bluetooth mode selection.
10. ARC: ARC mode selection.
11. OPT: OPTICAL mode selection.
12. AUX: AUX input mode selection.
13. USB: USB mode selection.
14. MUTE: Turn volume off. Depress again to activate the sound.

NO.3

## BT Pairing Method

Press “BT” button on the remote to convert to Bluetooth input mode, LED display will start to flash fast to search for the Bluetooth device. Turn on your mobile Bluetooth device and search for the devicename “BT SPEAKER”, press pair on your Bluetooth device. When you have successfully paired your mobile to the speaker system, the LED is long bright. When starting to play your mobile music, The functions “PREVIOUS/NEXT”, “PLAY/PAUSE”, can operate via the front panel. On BT mode, when connecting with mobile, press “▶||” for 3 seconds, bluetooth function can be force-disconnected.

## Rear panel

## Soundbar

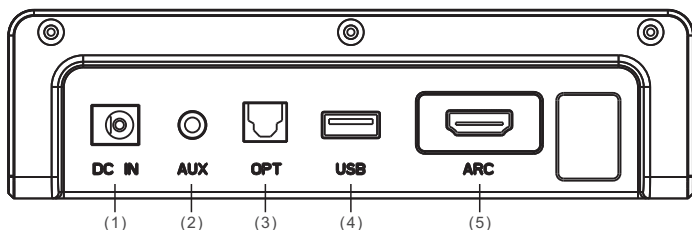

1. DC Power cord
2. Input Connect to sound sources such as computer, CD player, MP3, etc
3. Optical Input
4. USB Input
5. ARC Input



\*\*\* Do NOT use USB for charging devices, as it is not designed for charging. Thank you.

## ENNO.4

### System connection diagram

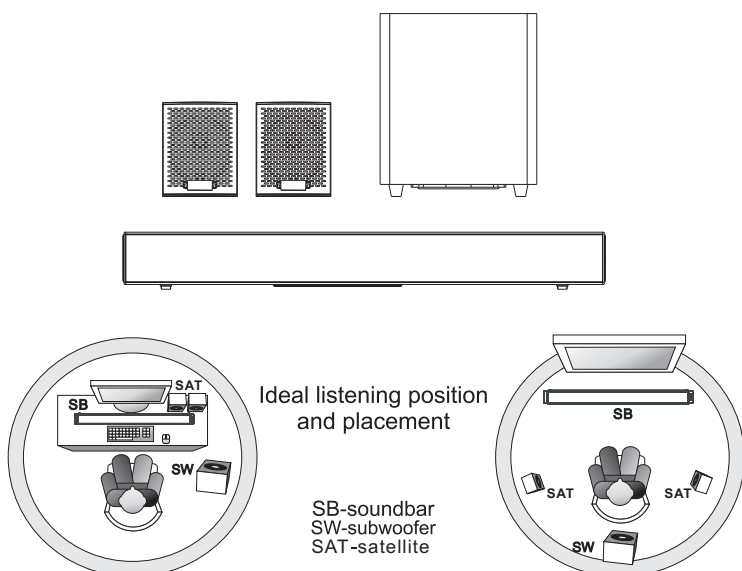

- ① **Sub-woofer** Place the sub-woofer any place on the floor.
- ② **Soundbar Speaker** Place it near the TV or DVD player.



**Please Note:**

\* Do not leave objects generating magnetism near the speakers.

NO.6

## Subwoofer

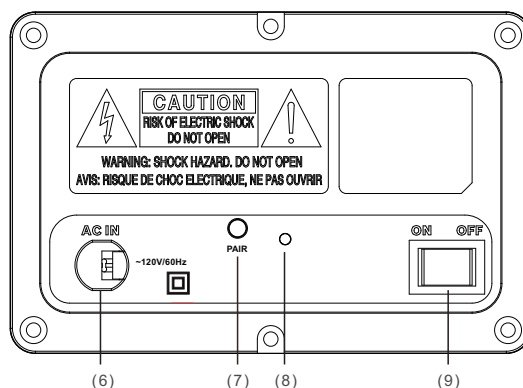

6. AC IN: AC Power cord
7. PAIR: Tap "PAIR" to enter the pairing mode, and tap again to confirm the pairing. Press and hold to power off and press again to power on.
8. LED: When the red light stays on the system is in standby mode. When the blue light is on, the TWS connection is successful. Blue light slowly blinking is pairing status.
9. Power ON/OFF: Switch for turning on/off the unit.

=NO.5

**In use please pay attention to the following items:**

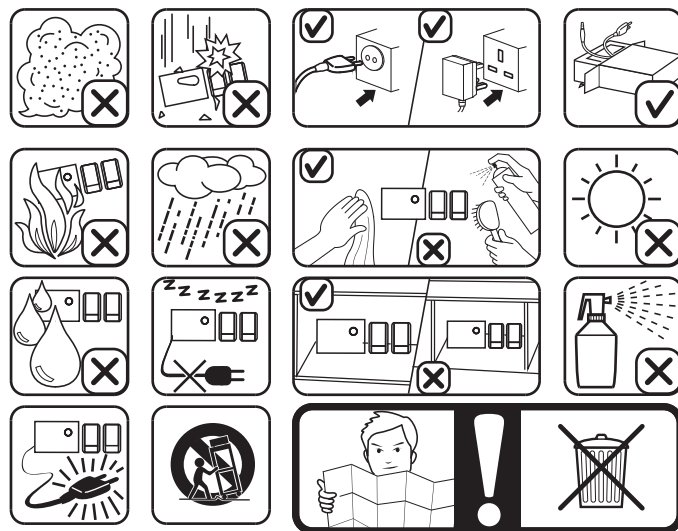

\*if the remote control doesnt function, it is because the battery of remote control has been used up. thank you.

=NO.7

#### FCC Caution.

This device complies with part 15 of the FCC Rules. Operation is subject to the following two conditions:

- (1) This device may not cause harmful interference, and
- (2) this device must accept any interference received, including interference that may cause undesired operation.

Any Changes or modifications not expressly approved by the party responsible for compliance could void the user's authority to operate the equipment.

Note: This equipment has been tested and found to comply with the limits for a Class B digital device, pursuant to part 15 of the FCC Rules. These limits are designed to provide reasonable protection against harmful interference in a residential installation. This equipment generates uses and can radiate radio frequency energy and, if not installed and used in accordance with the instructions, may cause harmful interference to radio communications. However, there is no guarantee that interference will not occur in a particular installation. If this equipment does cause harmful interference to radio or television reception, which can be determined by turning the equipment off and on, the user is encouraged to try to correct the interference by one or more of the following measures:

- Reorient or relocate the receiving antenna.
- Increase the separation between the equipment and receiver.
- Connect the equipment into an outlet on a circuit different from that to which the receiver is connected.
- Consult the dealer or an experienced radio/TV technician for help.

\*RF warning for Mobile device:

This equipment complies with FCC radiation exposure limits set forth for an uncontrolled environment. This equipment should be installed and operated with minimum distance 20cm between the radiator & your body.