

cycli

the social cycle

User's Guide

What's included

Your Cycli package includes:

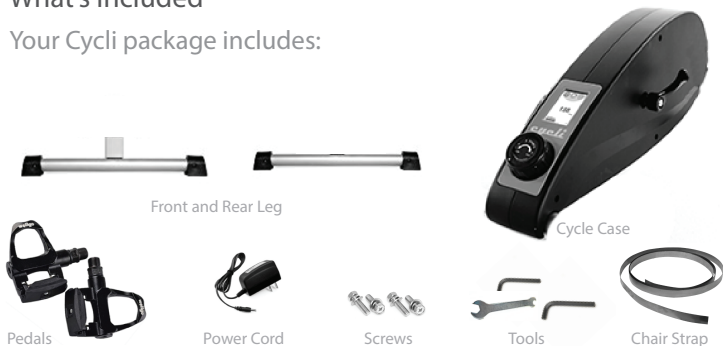

Setting up Cycli

Follow these steps to set up your Cycli

1. Use the screws to attach the Rear Leg to the Cycle Case.

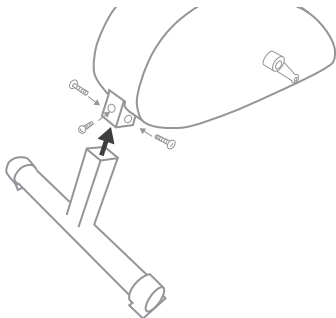

2. Use the screws to attach the Front Leg to the Cycle Case.

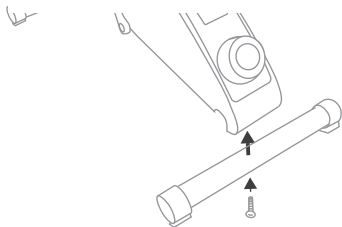

3. Install the Pedals by screwing them into the pedal arm. Use the flat wrench to tighten the pedals by threading the bolt as indicated.

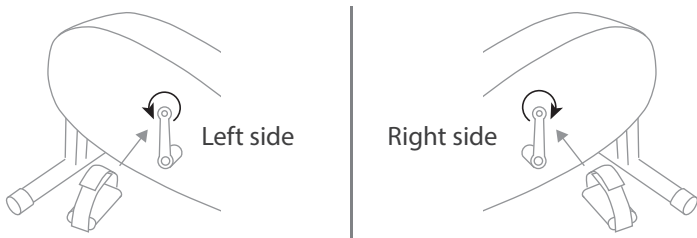

4. Plug the Power Cord to an electrical outlet, then plug the other end into the back of your Cycli.

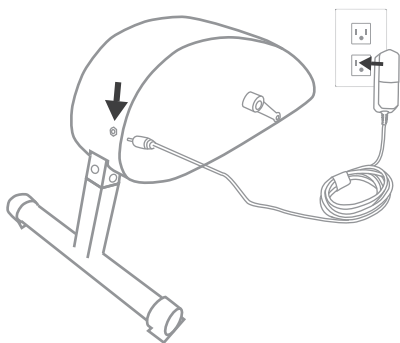

NOTE: it may take up to 2 hrs for Cycli to be fully charged. You can check the battery status icon on Cycli's built in touch screen: 

The Cycli Touch Screen

Get to know the elements on your Cycli's touch screen:

Move the pedals or tap on the screen in order to activate the Cycli display screen.

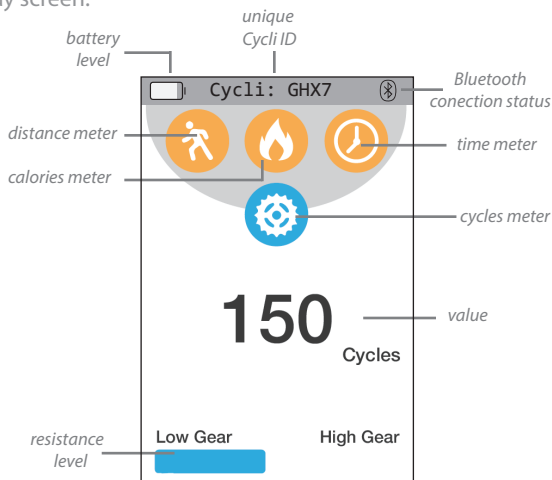

The Cycli App

Learn how to use your phone with Cycli.

To begin, install the Cycli App on your phone, then open it.



Once the Cycli App launches, you will need to register a new account with a username, email and password.

The first time you register, you will be asked to pair your phone with your Cycli. To do this:

1. Make sure the Bluetooth feature on your phone is turned on.
2. Make sure your Cycli display is active.
3. Select your Cycli from the Bluetooth devices that show up on your phone. If you see more than one, select the one that matches the unique Cycli ID on the top of your Cycli touch screen.

Using the Cycli App with Cycli

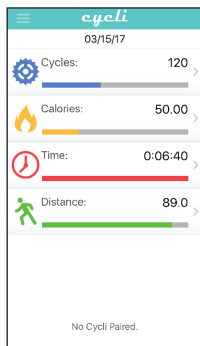

Dashboard

This will be your main screen when you launch the app. Your daily value for each metric is shown, along with your progress towards your Daily Goal.

The button on the bottom of the screen will show your connection status to Cycli. If you're having trouble connecting, try closing and restarting the app!

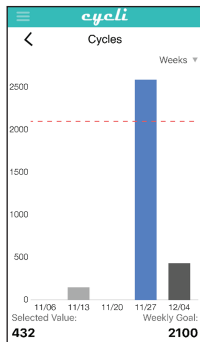

Metric Trends

When you tap on any of the metrics, you will see a graph of your current and past exercise sessions. You can view the data by day, week, month or year.

You can use this screen to set your personal goals by changing the value in the bottom right-hand corner.

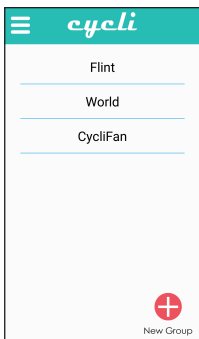

Groups

When you open the Groups panel, you will see a list of all the Cycli groups you are a part of. You can join or create new groups by tapping the button on the bottom of the screen.

Every Cycli user is automatically added to the World group, so you can see how you stack up against everyone! You can leave this group in Account Settings.

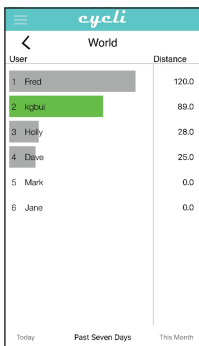

Group Trends

Tap a group to see how you compare to everyone else in that group for today, the past 7 days, or the current month.

Group data is always ranked by total distance. Your ranking is shown to the left of your name. Scroll down to see additional members.

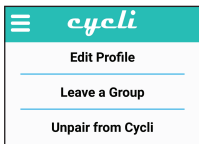

Account Settings

On this screen you are able to edit your profile information, leave a group or unpair from your Cycli.

Contact Information

Please use the information below to contact Flint Rehab Devices in the event of any device malfunction, complaint, return request or compliment!

Mailing Address:

Flint Rehab Devices
18023 Sky Park Circle, Suite H2
Irvine, CA 92614

Phone Contact:

Customer Service: 1-800-59-FLINT (800-593-5468)

Internet and Email Contact:

E - mail: support@flintrehab.com

Website: www.flintrehab.com

FCC STATEMENT :

This device complies with Part 15 of the FCC Rules. Operation is subject to the following two conditions:

- (1) This device may not cause harmful interference, and
- (2) This device must accept any interference received, including interference that may cause undesired operation.

Warning: Changes or modifications not expressly approved by the party responsible for compliance could void the user's authority to operate the equipment.

NOTE: This equipment has been tested and found to comply with the limits for a Class B digital device, pursuant to Part 15 of the FCC Rules. These limits are designed to provide reasonable protection against harmful interference in a residential installation. This equipment generates uses and can radiate radio frequency energy and, if not installed and used in accordance with the instructions, may cause harmful interference to radio communications. However, there is no guarantee that interference will not occur in a particular installation. If this equipment does cause harmful interference to radio or television reception, which can be determined by turning the equipment off and on, the user is encouraged to try to correct the interference by one or more of the following measures:

- Reorient or relocate the receiving antenna.

- Increase the separation between the equipment and receiver.

- Connect the equipment into an outlet on a circuit different from that to which the receiver is connected.

- Consult the dealer or an experienced radio/TV technician for help.

FCC Radiation Exposure Statement:

This equipment complies with FCC radiation exposure limits set forth for an uncontrolled environment. This equipment should be installed and operated with minimum distance 20cm between the radiator & your body.

- English: "

This device complies with Industry Canada licence-exempt RSS standard(s). Operation is subject to the following two conditions:

- (1) this device may not cause interference, and
- (2) this device must accept any interference, including interference that may cause undesired operation of the device."

- French:"

Le présent appareil est conforme aux CNR d'Industrie Canada applicables aux appareils radio exempts de licence. L'exploitation est autorisée aux deux conditions suivantes :

- (1) l'appareil n' doit pas produire de brouillage, et
- (2) l'utilisateur de l'appareil doit accepter tout brouillage radioélectrique subi, même si le brouillage est susceptible d'en compromettre le fonctionnement."