

Massage Chair Manual

BODYFRIEND
Massage Chair
REX-L
User Manual

REX·L

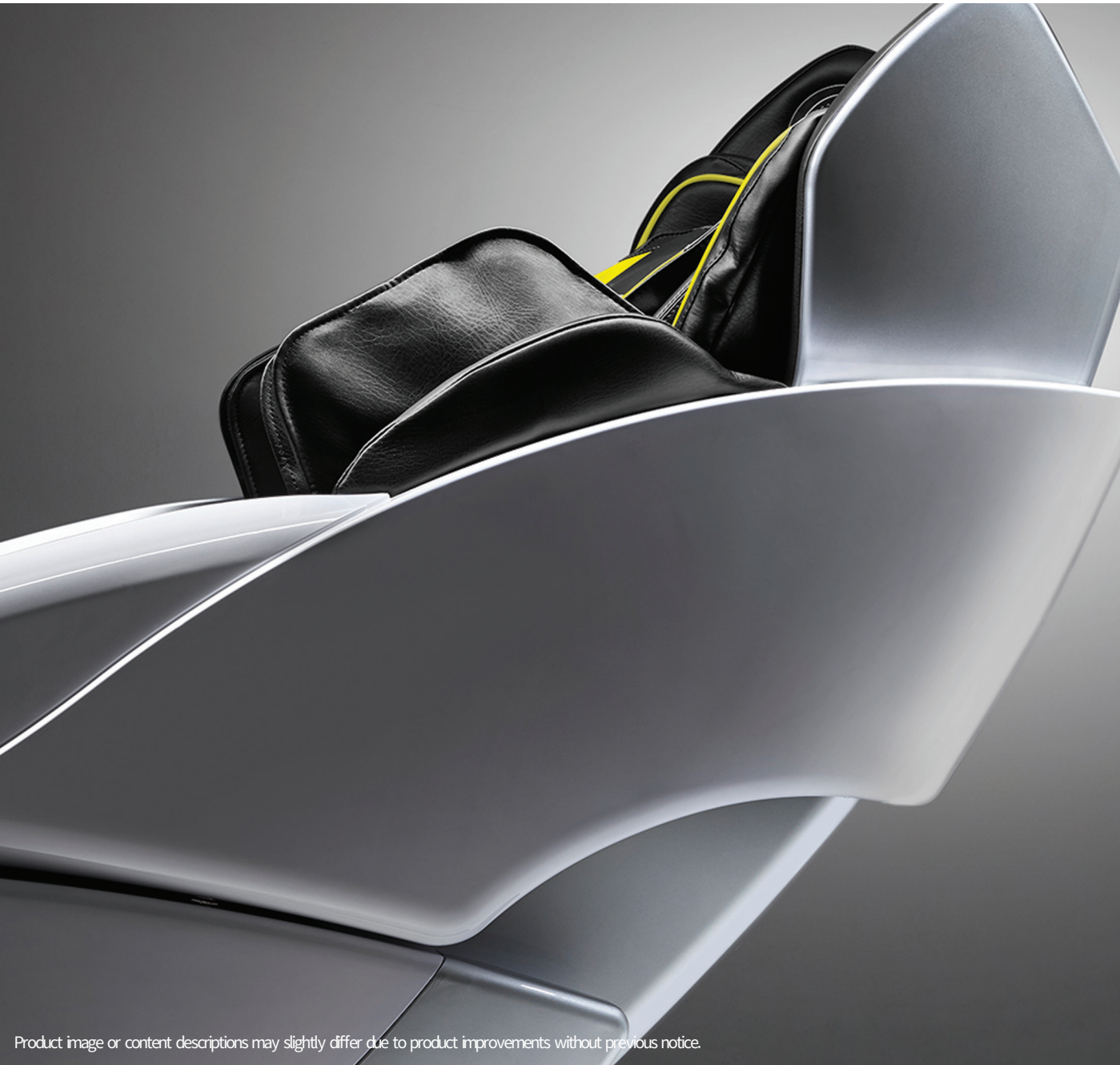

Product image or content descriptions may slightly differ due to product improvements without previous notice.

Introduction

Thank you for purchasing BODYFRIEND Massage Chair. Before using our product, please read through the safety precautions and operation instructions carefully. We kindly ask users to understand that there may be slight differences in image and content descriptions presented throughout this manual due to product quality improvements. Thank you.

Product Features



Zero Gravity



Ergonomic Frame

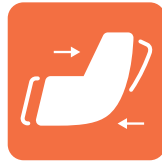

Zero Wall



Auto Massage Indicator



Auto Massage Modes



Full Body Massage



Hand/Arm/Shoulder Massage



Audio Guidance



Sole Reflexology Rollers



Bluetooth Connectivity



Dual Airpump



Language



Stereo Speakers

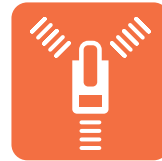

Zipper Upholstery



Heating

Zero Gravity

Distributing gravitational pressure by a weightless positioning of the body, recline angles can further be adjusted to optimize the massage experience.

Ergonomic Frame

SL Frame best supports the body and massages the entire length of the body from the head down to the buttocks by conforming to the contours of the body.

Zero Wall

Zero Wall feature automatically slides chair forward when the chair is reclined, saving the trouble of allocating extra space behind the chair.



WARNING - Do not install massage chair under direct sunlight or where high temperature fluctuations can occur.



▲ IMPORTANT - Product image or content descriptions may slightly differ due to product quality improvements.

Table of Contents

Before Use Instructions	Product Features	02
	Safety Precautions	04
	Important Safety Instructions	05
	Components and Descriptions	06
	Transporting/Grounding	07
<hr/>		
Installation Instructions	Installation	08
<hr/>		
Controller Information	Controller Button Descriptions	12
	Controller Function Descriptions	14
<hr/>		
Program Descriptions	BODYFRIEND Customized Programs	19
<hr/>		
Product Specifications	Product Specifications	20
<hr/>		
Troubleshooting	Troubleshooting	21
	Customer Support Guidelines	22
<hr/>		

Before Use: Safety Precautions

Before using, please carefully read the “Safety Precautions” section for proper installation and operation.

WARNING - Please do not try to install or repair massage chairs without the assistance of technicians.



Bodyfriend is not responsible for replacement costs if the product is damaged or breaks due to self-troubleshooting.



CAUTION - Please Do Not Install Outside the Home.



This product is for non-commercial household use only. Warranty is subject to cancellation if the product is used for commercial purposes.



Prohibited

To reduce injury and risk of fire:

- 01 Do not install in bathrooms or areas with high humidity levels. Could result in electric shock.
- 02 Avoid using in areas with dust or areas prone to rust.
- 03 Do not operate this device in settings with temperatures exceeding 104F°.
- 04 Do not use outdoors.
- 05 Do not use near heaters or anything radiating heat.
- 06 Install and use only when properly grounded on flat surfaces.
- 07 Use in areas with ample space and reasonable air circulation.
- 08 Do not use after disassembling parts. Can result in product malfunctions.
- 09 Do not use concurrently with other electronic or medical devices.
- 10 Do not use aerosol (spray) products.
- 11 Do not place heavy objects on top of this product.
- 12 Please take precautionary measures to ensure toddlers, pets, and small beings do not crawl under the body of the chair, leg rest, etc. to prevent any injuries or damage.
- 13 Do not allow more than one person to operate the machine at a time.
- 14 If the power cord or power plug becomes damaged in any way, disconnect from the main supply immediately and consult an authorized service engineer for repair or replacement.
- 15 Do not damage, excessively bend, pull, twist, or knot any device cords.
- 16 Do not stand on the legrest before, after, or while the device is sliding forward or back to its original resting position.

Important Safety Instructions

● Compulsory

- 01 Check power supply before using.
- 02 Do not handle with wet hands.
- 03 Do not operate when body is wet.
- 04 Do not use after excessive eating.
- 05 Take precautionary measures to ensure parts of the body or objects do not get caught in any openings of the massage chair.
- 06 When using targeted massage functions, be aware of individual body signals, not to over-stimulate targeted areas.
- 07 Individuals who have been hospitalized for extended periods of time or are recovering from medical injuries are asked to use this product with caution.
- 08 Do not use if experiencing high fever or show symptoms of high fever.
- 09 Do not use if suffering from skin diseases or have wounds not yet fully healed.
- 10 Consult a doctor before using if you are a patient or suffer from any body malfunctions.
- 11 This device is not intended for use by persons with reduced physical, sensory, or mental capabilities or lack experience and knowledge unless they are supervised or have been given instructions concerning the use of this device. Children should also be supervised when using this device.
- 12 Consult a doctor before using if you suffer from any spinal disorders, osteoporosis, or any other bone disorders.
- 13 Consult a doctor before using if you have a pacemaker or any implantable medical device.
- 14 Do not use if pregnant or have recently given birth.
- 15 Please limit the use of this product for children.
- 16 Be cautious not to let massage balls exert excessive pressure to the spine.
- 17 Do not use this product on areas of the body not intended for this device.
- 18 While the massage balls are initializing, stay in the correct upright position for accurate sensor locating.
- 19 Make sure the massage chair is upright when mounting and dismounting.
- 20 Be cautious of hypothermia if unusual fatigue or sleepiness ensues after receiving a massage.
- 21 If you feel any pain or discomfort, immediately stop the machine or adjust settings to accommodate to personal health needs/preferences.
- 22 Operate this device based on individual health status.
- 23 People over 242lbs are not advised to use this device.
- 24 Do not stand on the device. Operate the chair only while being seated.
- 25 Do not stand on the leg rest.

This device complies with Part 15 of the FCC Rules. Operation is subject to the following two conditions: (1) This device may not cause harmful interference, and (2) this device must accept any interference received, including interference that may cause undesired operation.

Components and Descriptions

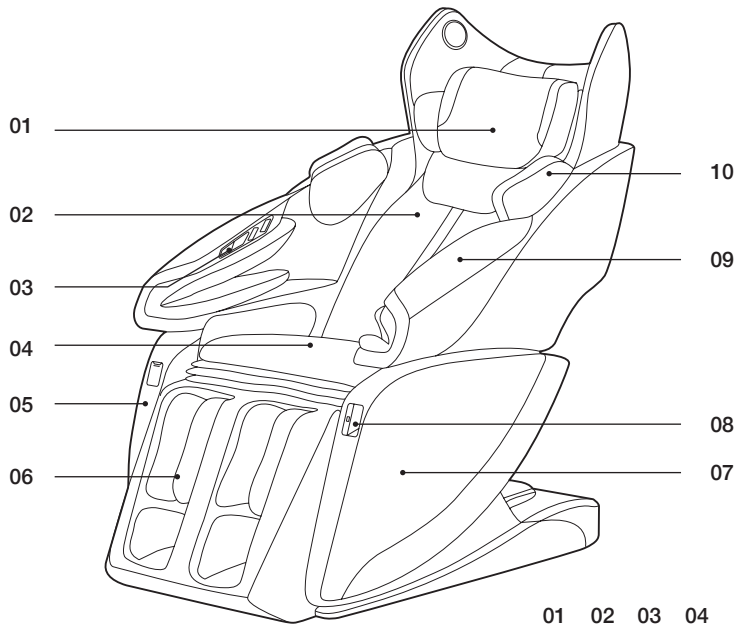

Exterior

- 01 Head Rest
- 02 Back Rest
- 03 Embedded Touch Switch
- 04 Seat Cushion
- 05 Controller Storage
- 06 Leg Massage Unit
- 07 Side Panel
- 08 USB Charging Port
- 09 Arm Massage Unit
- 10 Shoulder Massage Unit

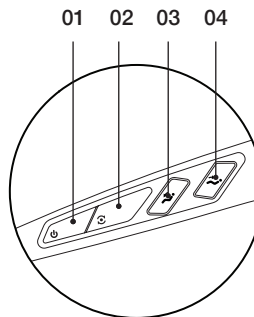

Embedded Touch Switch

- 01 Power ON/OFF
- 02 Auto
- 03 Back Ascend
- 04 Back Descend

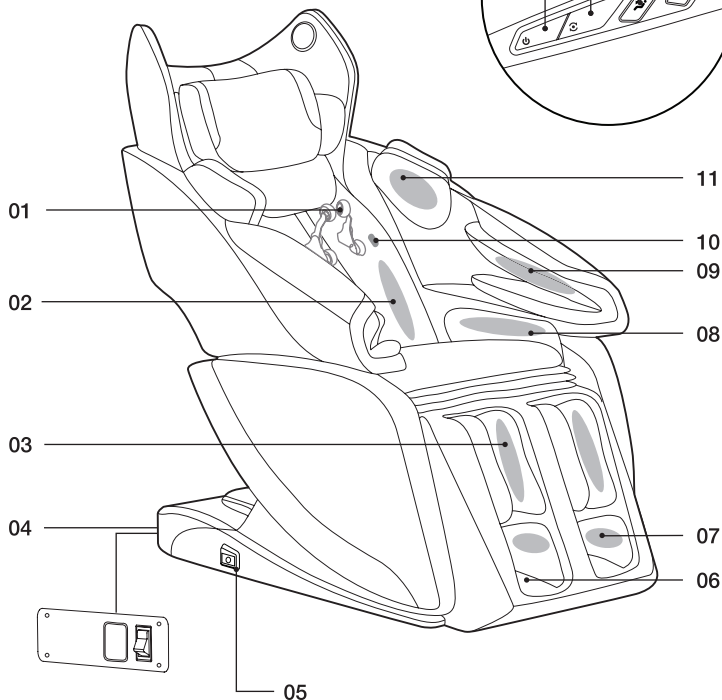

Interior

- 01 Back Massage Ball
- 02 Back/Waist Airbags
- 03 Calf Airbags
- 04 Power Source Terminal
- 05 Controller Socket
- 06 Feet Rollers
- 07 Feet Airbags
- 08 Thigh/Buttocks Airbags
- 09 Arm Airbags
- 10 Back Heating Pad
- 11 Shoulder Airbags

Transporting/Grounding

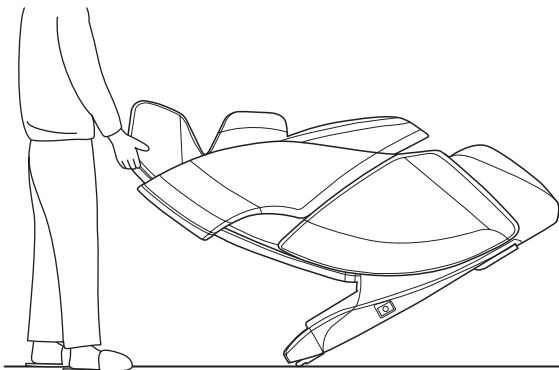

After removing all cables and miscellaneous objects from the floor, tilt the massage chair backward at an angle and lift. After arriving at the desired location, safely place the chair securely on the floor and begin re-installation of the chair.

⚠ WARNING

- ※ Do not drag and take precautions to not damage the floor.
- ※ Do not lift the chair by the leg unit.

⚠ IMPORTANT

- ※ To avoid injury or damage to the device, we recommend two or more people when transporting.

- 01** Reserve space for installation of the massage chair.
- 02** Remove all miscellaneous objects around or in direct contact with the machine.
- 03** Remove and disconnect any cables beneath or around the chair.

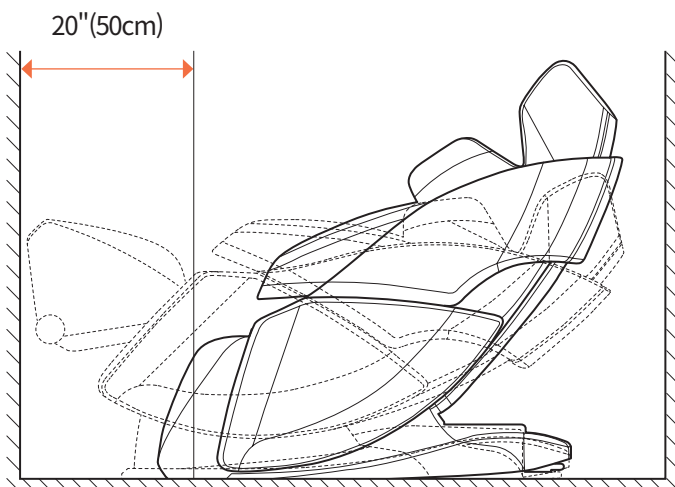
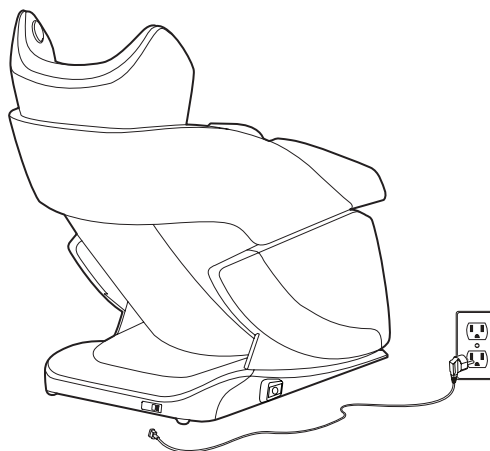

Installation Part 01

STEP 1. Undo Packaging

This product is packaged in three separate boxes.
Please check that you have received all necessary parts.

- **Main Box** : Back sheet, Head sheet, Seat cushion, Accessories (controller, cables, and manual)
- **Arm / Shoulder Unit**
- **Leg Unit**

STEP 2. Constructing the Leg Unit

- 01** With the controller, recline the chair to be parallel with the floor. Then, install the connector and air hose pieces within the leg unit.
- 02** Connect the leg unit to the main body frame by aligning the parts as shown in the diagram below.
- 03** When all parts are aligned and in place, use the controller to lower the leg unit to its original resting position.

Fasten the parts together using nails.

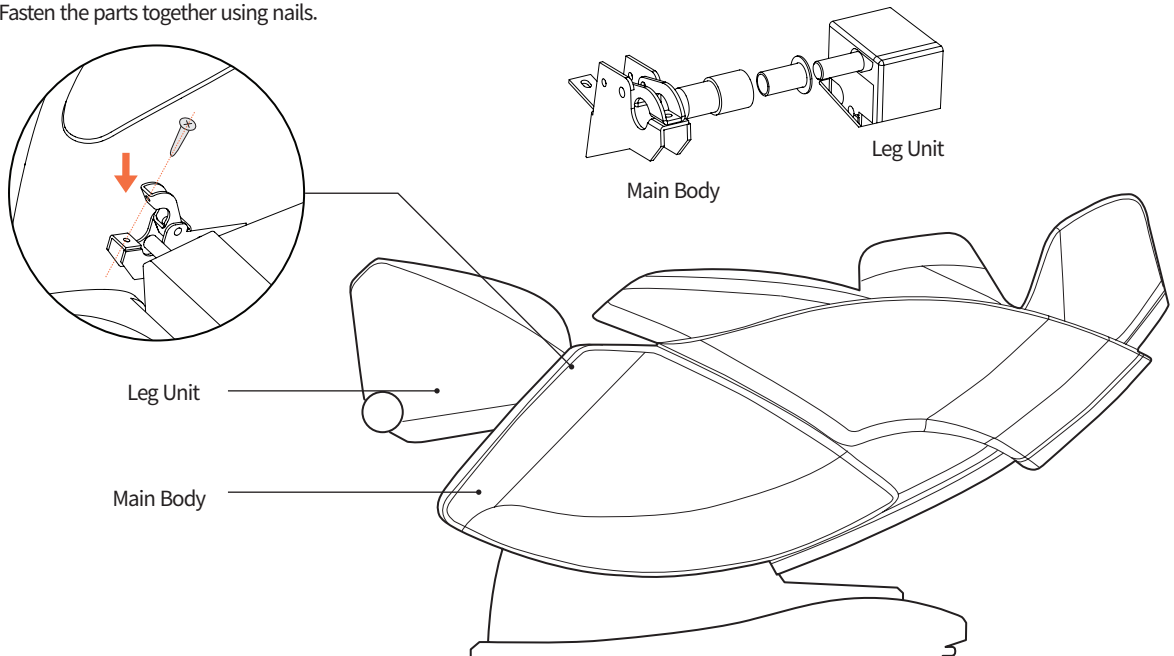

Installation Part 02

STEP 3. Assemble the Arm Unit / Attach the Back Cover

01 Connect the air hose and connector beneath the interior of the side panel.

02 After aligning the corresponding parts, fasten using nails.

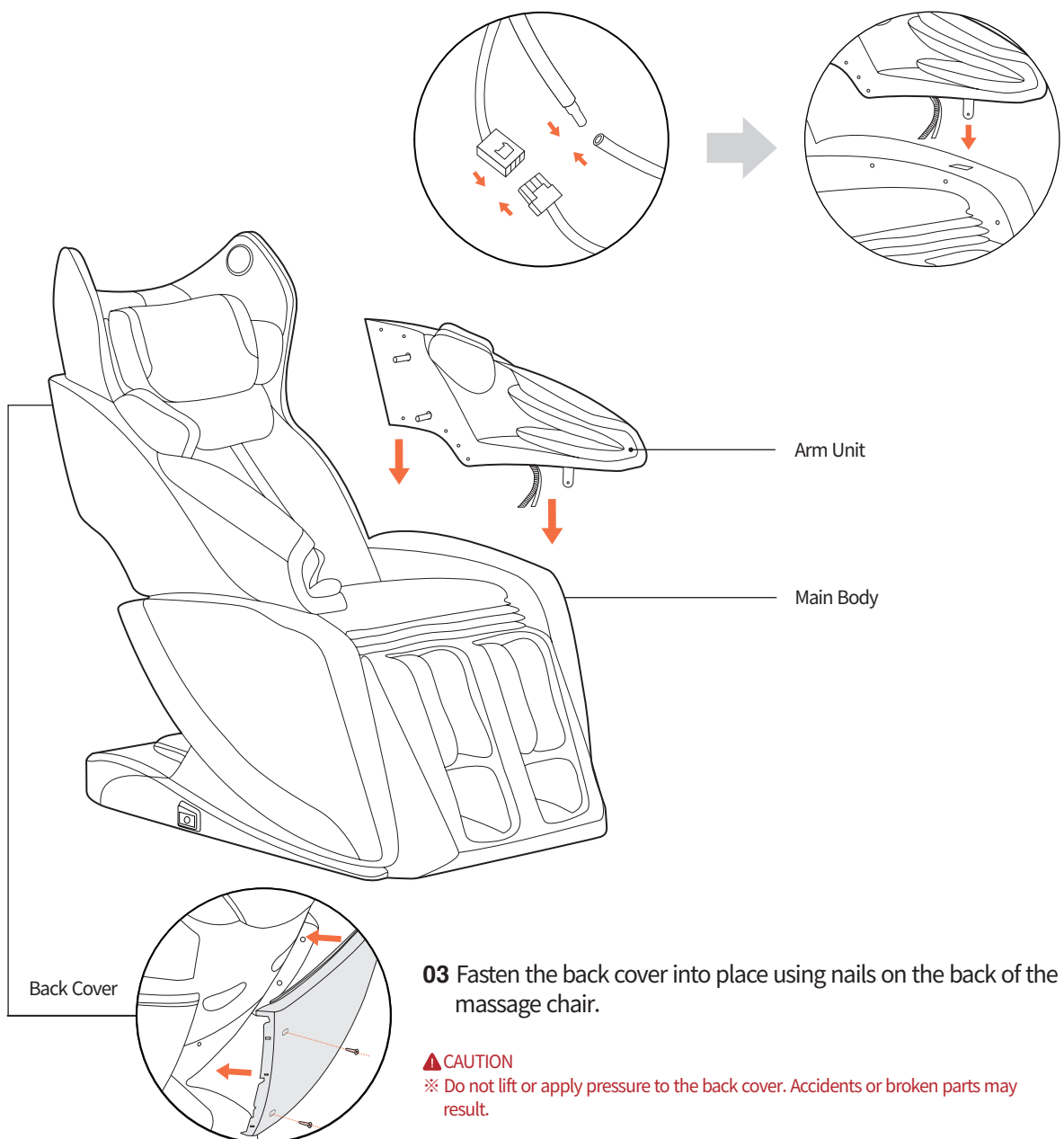

Installation Part 03

STEP 4. Connecting the Controller

Locate the controller socket towards the right arm rest and connect the controller cables with its socket.

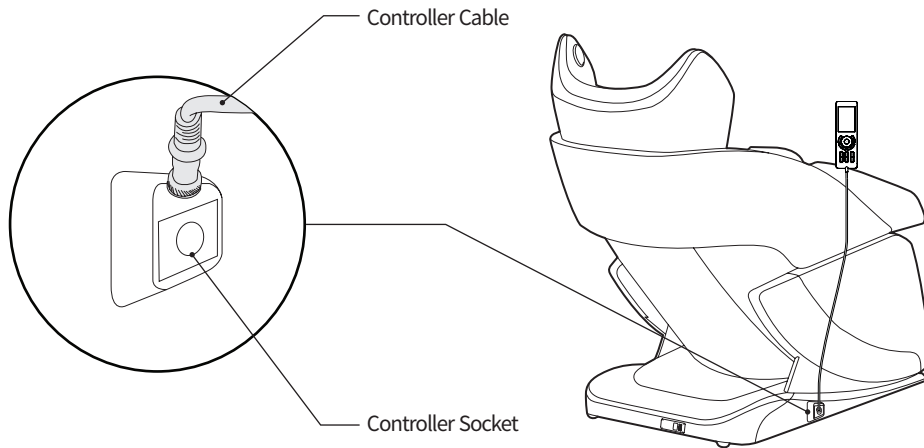

STEP 5. Connecting to Power Supply

Plug the power cable into the socket at the lower end of the massage chair as depicted below. After plugging in the power cable, turn on the power switch.

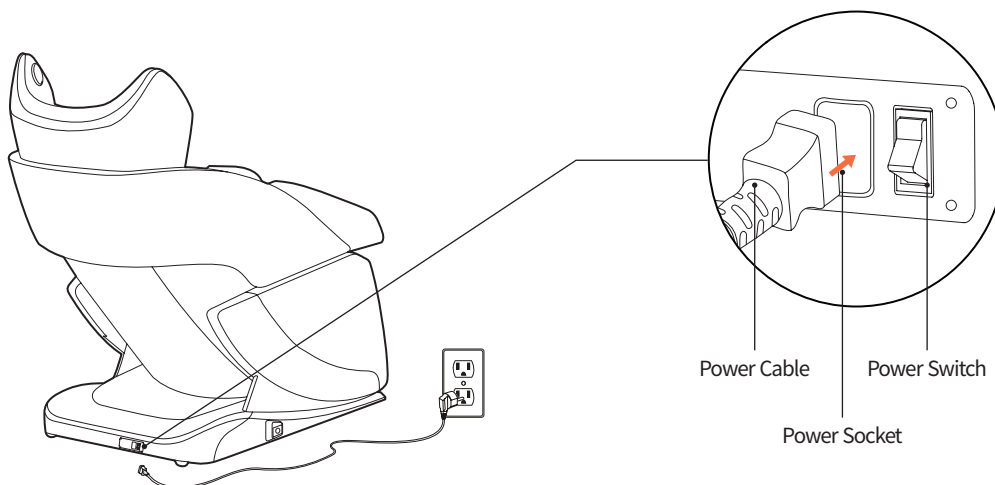

Installation Part 04

STEP 6. Back / Head Unit Construction

Head cushion and pillow can be installed depending on preference.
The head cushion can be used to soften the intensity of the shoulders and neck massage.
Construct the back unit using the zipper (01) and adherent (02).
Install the head cushion using the adherent (03) (length can be adjusted based on preference).

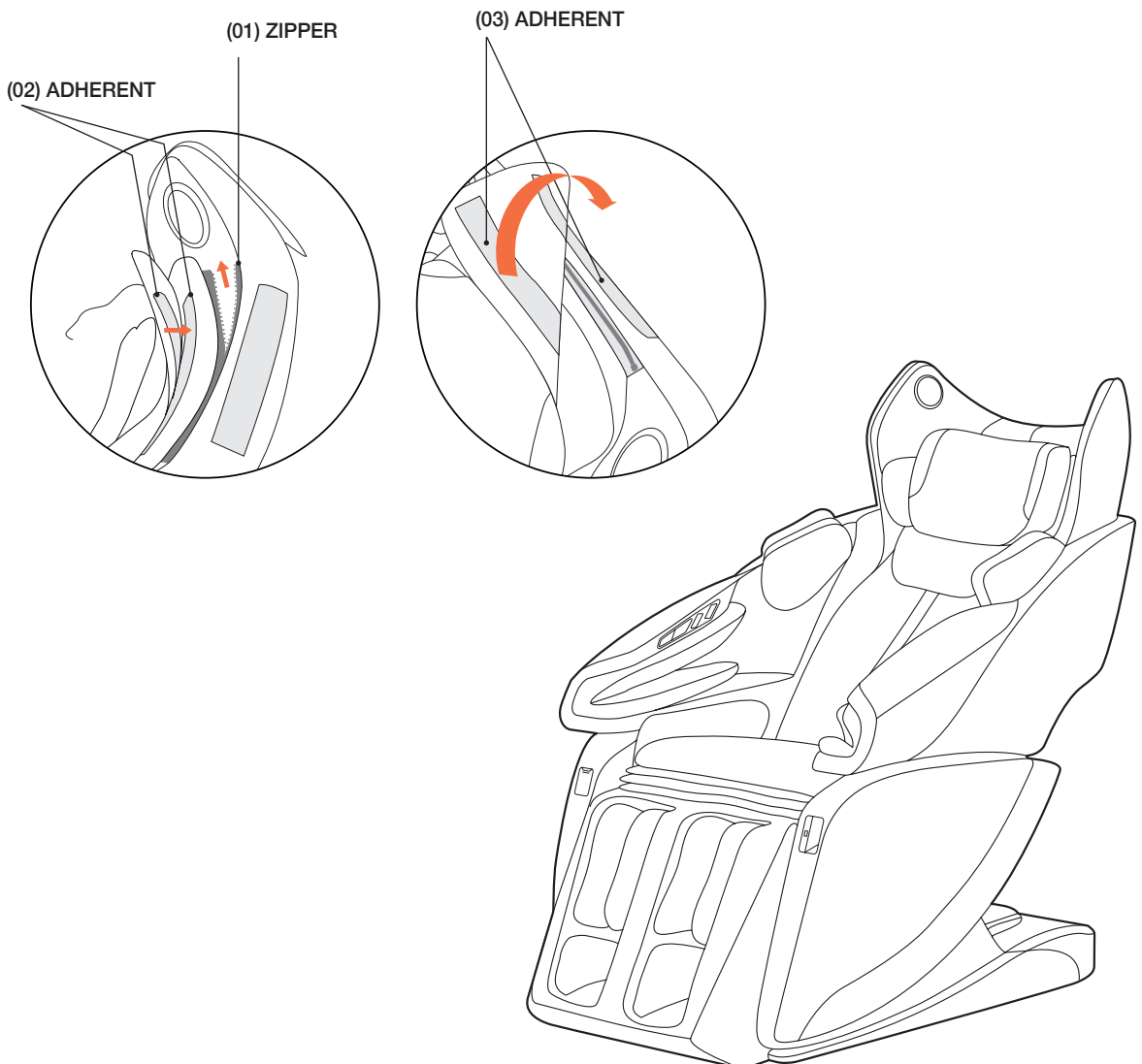

Controller Button Descriptions 01

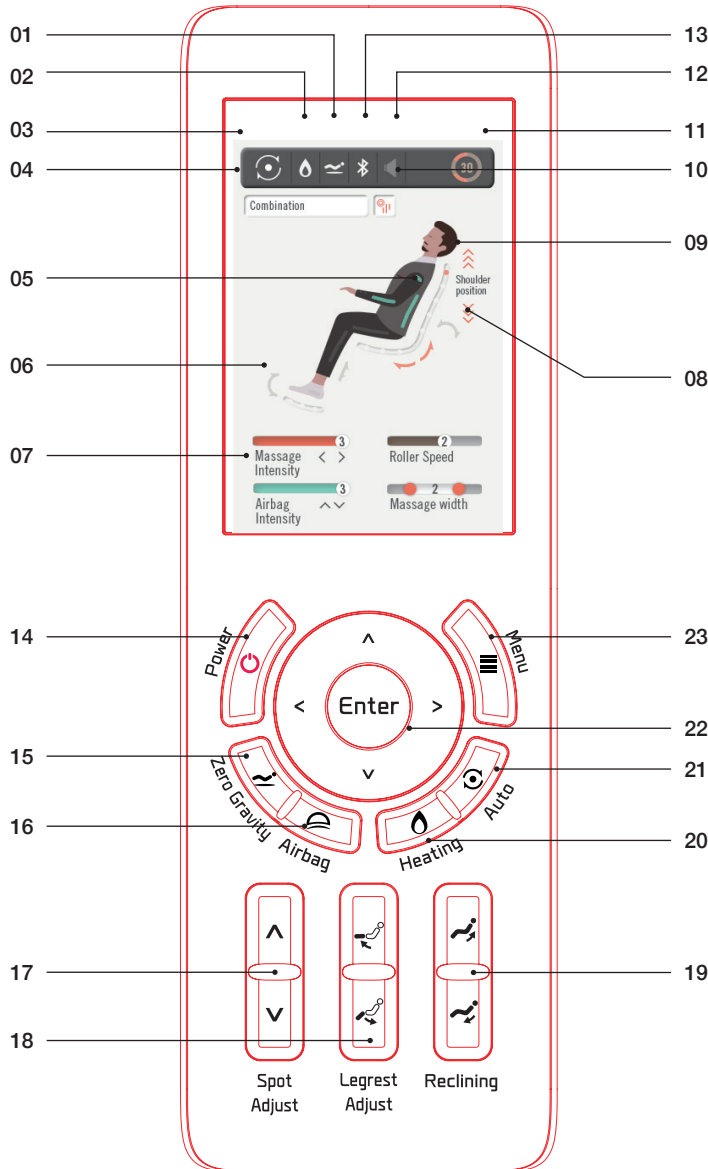

Controller LCD Components

- 01 Zero Gravity Indicator
- 02 Heating Indicator
- 03 Auto/Manual Mode Indicator
- 04 Auto or Manual Massage Technique Indicator
- 05 Air Massage Indicator
- 06 Legrest Adjust Indicator
- 07 Massage Intensity Indicator
- 08 Reclining Indicator
- 09 Massage Module Movement Tracking
- 10 Massage Module Spot Indicator
- 11 Time Elapsed Indicator
- 12 Volume Control
- 13 Bluetooth Connectivity Indicator

Controller Button Components

- 14 Power
- 15 Zero Gravity
- 16 Airbag
- 17 Spot Adjust
- 18 Legrest Adjust
- 19 Reclining
- 20 Heating
- 21 Auto
- 22 Enter
- 23 Menu



Slide Safety Mode



This massage chair is equipped with the automatic sliding function. Therefore, if the power button is pressed during operation, the chair will start to automatically slide back to its original resting position. When the chair is sliding back to its original state, please make sure children, pets, or other objects do not get caught. If there are any obstacles preventing the chair from sliding back to its original state, immediately press any button on the controller to stop the auto slide. Please use with caution.

Controller Button Descriptions 02

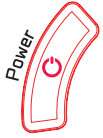

Power

This is the power button. If the [Power] button is pressed during a massage, the screen will ask the user if he/she would like to end the massage. In the case of a ceased massage mode, massage balls, sliding features, and etc. will all return to its original resting state.

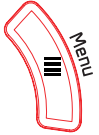

Menu

When the [Menu] button is pressed during operation, the menu screen will appear or take you back to the previous screen.

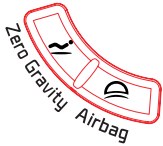

Zero Gravity

The [Zero Gravity] button will transition the body into the zero gravity position and angle.

Airbags

When the [Airbag] button is pressed during operation, the airbag installation screen will appear, allowing airbag massage spot, intensity, and etc., to be adjusted.



Auto

During a massage mode, press the [Auto] button to quickly transition the massage mode to a different auto massage mode.

Heating

Pressing the [Heating] button during operation will cause the heating screen to appear and heat temperature and heating location can be adjusted.

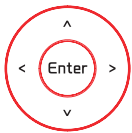

Arrow Keys

The arrow keys allow user to navigate the controller. On the main screen, the [left/right] buttons control massage intensity levels and the [up/down] buttons control airbag pressure levels.

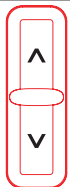

Spot Adjust

The controls displayed on the left adjust the spot of the massage balls on manual mode. The controls displayed on the right adjust the shoulder spot on automatic mode.

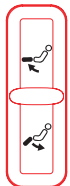

Legrest Adjust

These buttons allow leg angles to be adjusted.

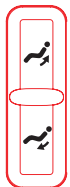

Reclining

Reclining buttons adjust the recline angles for the body.

Controller Function Descriptions 01

Start

Press the [Power] button to turn on the screen and activate the massage chair. When the child safety lock screen appears, hold down the [Enter] button for three seconds.

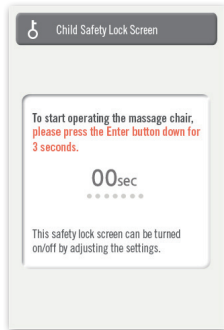

Child Safety Lock Screen

The child safety lock screen is emplaced as a safety precaution. After activating the controller, the child safety lock screen will appear requiring the user to hold down the [Enter] button for three seconds to transition to the next screen to start operating the massage chair. Users can make necessary changes in the settings option.

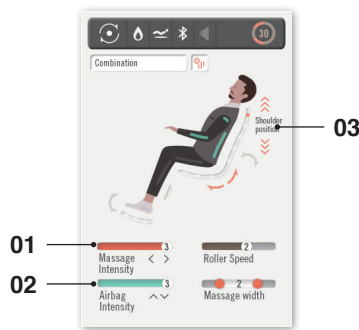

Main Screen

The main screen shows the current state of the massage, time, and etc. [Right/Left] arrow keys control message intensity levels. [Up/Down] arrow keys control airbag pressure levels. After the auto body scanning is complete, the [Up/Down] arrow keys allow shoulder spot adjustment.

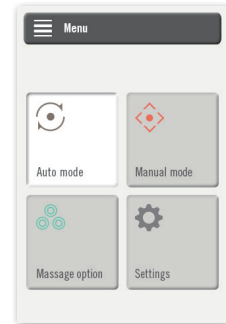

Menu Screen

The menu screen will appear when the [Menu] button is pressed. Four options will appear: Auto Mode, Manual Mode, Massage Options, and Settings. Detailed Massage Options can be accessed through Massage Options. Any other setting can be accessed through Settings.

Finish

After finishing a massage mode or if there is a need to quit during a massage, press the [Power] button. A screen will appear asking for confirmation to end the massage. Press [Enter] to confirm the end of the massage mode and the machine will shut down with all parts moving back to its original resting position.

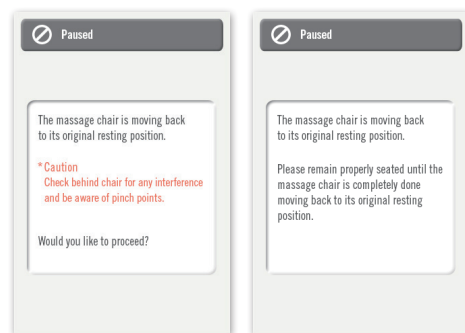

Pinch Point Prevention Screen

The pinch point prevention screen appears as a safety measure just before the device is turned off. Check for any objects that may prevent the chair from moving back to its original position and then press [Enter] to completely turn off the device.

Controller Function Descriptions 02

Auto Modes

[Menu] > Auto > Use the [Up/Down] arrow keys to pick preferred massage modes > [Enter] > Auto Body Scanning will use sensors to pinpoint areas of your body > Massage balls will relocate to corresponding locations > Massage session will begin.

Refresh	Massage mode that simultaneously uses kneading and tapping techniques on targeted shoulder area.
Relax	Massage mode concentrated on shoulders, back, and waist through continuous kneading and tapping.
Hip-Up	Massage mode that alternates acupressure and kneading techniques on the buttocks.
Rest	Massage mode that provides 30 minutes of concentrated kneading for the entire back.
Athlete	Massage mode that combines tapping, kneading, and acupressure techniques targeting the shoulders while operating dual chopping feet rollers.
Office	Massage mode using tapping and acupressure massaging techniques focusing on the waist while automatically reclining the body at different angles to promote relaxation.
Stretch	Massage mode using tapping and kneading techniques while fully reclining the body at different angles to gently stretch the legs and body separately.
Auto Upper	Massage mode that provides tapping for the shoulders and back while using acupressure and various other massaging techniques for the upper body.
Auto Lower	Massage mode relieves tension in the lower body area by concentrating on the legs and operating rollers for the feet.
Lymphatic	Massage mode uses pinpointed massage therapy to stimulate the lymphatic system to drain toxins from the body.
Digestive	Massage mode uses acupressure massage techniques to facilitate digestion, ease hangovers, and improve circulation throughout the arms and legs to the digestive organs.
Waist Focused	Massage mode uses massage balls targeted around the body's core to strengthen the waist and improve body posture.

Controller Function Descriptions 03

Manual Modes

[Menu] > Manual Mode > Choose preferred area of massage on the body > (Press [Menu] to go back to previous screen)

[Up/Down] > Choose massage techniques > [Enter] > Message set-up screen will appear

[Right/Left] to personalize message options > [Enter] to start message mode.

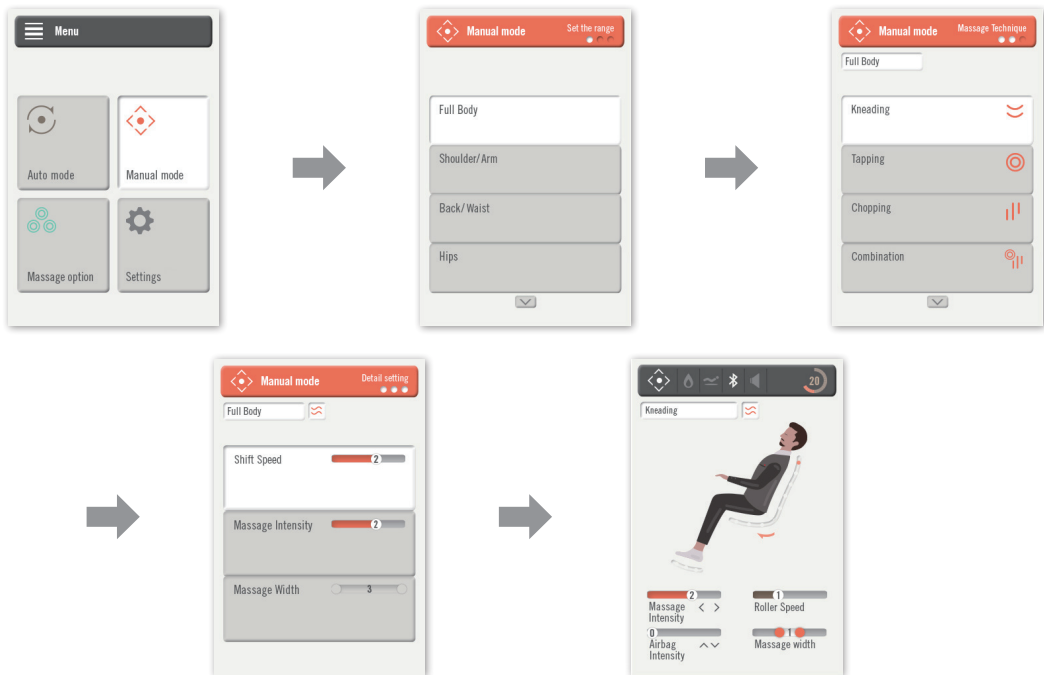

- Adjust the area of the back-side that needs to be massaged.
- Full Body: This message incorporates all areas of the body.
- Shoulders: Massages area from the neck to shoulders.
- Back/Waist: Massages back and waist area.
- Buttocks: Massage the buttocks area.
- Leg: Massages the legs (detailed message options cannot be adjusted)

Spot Adjust

Massage Techniques

Choose among (kneading/tapping/chopping/combination (kneading and tapping)/acupressure) massage techniques.

Specific Settings

- Message intensity, width, and shift speeds are able to be adjusted.
- Shift Speed: Speed in which massage balls move from upper body to lower body can be adjusted from Level 1 to Level 3.
- Intensity Levels: Different intensity level options starting from Level 1 to Level 3.
- Width: Width of the massage modules can be adjusted (narrow/medium/wide)

※ While in Auto Massage Mode, Manual Mode Options (massage techniques/spot/intensity) cannot be adjusted.

Controller Function Descriptions 04

[Menu] > [Massage options] > roller speed, heating, airbag settings can be adjusted.

Roller Speed

Adjust roller speeds for the feet, change to manual feet massage mode, and use [Right/Left] arrow keys to adjust roller speeds.

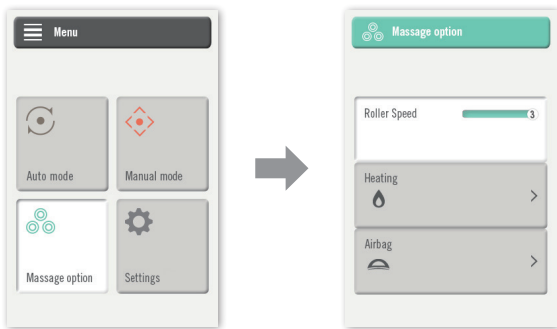

Heating

There are heating options for the back and waist. Heating temperature can also be adjusted in increments of 9°F from 86°F to 140°F. [Right/Left] arrow keys control different heating levels and at level 0, the heating function is shut off.

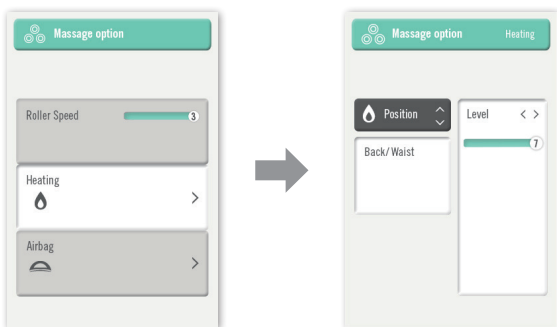

Airbags

Airbag massage function (Airbag Spot/Intensity) can be set up. [Up/Down] arrow keys adjust the location of airbags. [Right/Left] arrow keys adjust airbag levels.

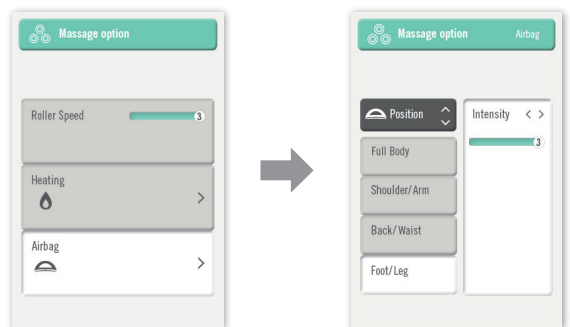

Controller Function Descriptions 05

[Menu] > Settings

Set up message duration times, child safety lock screen, language, Bluetooth connectivity, audio guidance volume, and etc.

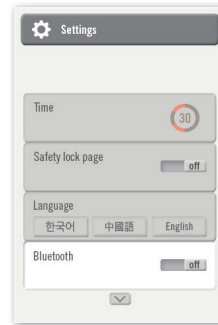

Bluetooth Connectivity

- 01 Use the controller to turn the Bluetooth function on under the settings menu.
- 02 Turn Bluetooth ON on mobile device.
- 03 Pair the devices by finding " BODYFRIEND REX-BT1 "

Time Elapsed

Set message duration times for 15/20/25/30 mins. [Right/Left] arrow keys increase or decrease duration times.
(Sleep mode is pre-set at 30 min. and cannot be adjusted).

Bluetooth Connectivity

Sync personal mobile device with Bluetooth function to play music through the speakers while receiving a massage.

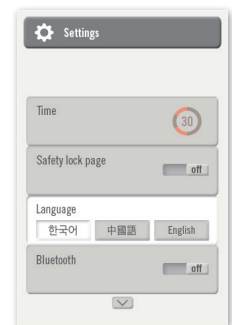
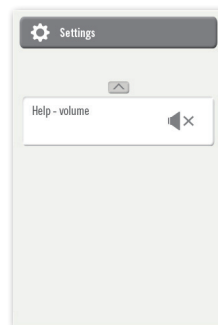

Child Safety Lock Screen

Child safety lock screen can be emplaced to prevent young children from operating the massage chair. If the safety lock screen is set up, it will appear when the controller is turned on. When this screen appears, hold down the [Enter] button for three seconds to proceed to the main screen. Under settings, [Right/Left] arrow keys switch the safety lock screen on/off.

Audio Guide Volume

Audio guidance can be turned on/off and volume controls can also be adjusted.

Language

Change language settings to either Korean, Chinese, or English. Use the [Right/Left] arrow keys to switch between languages to pick the preferred language.

BODYFRIEND Customized Programs

New Massage Modes

BODYFRIEND's new massage modes **have a variety of customers' needs in mind.**

Athlete Muscle soreness or knots from exercise can be relieved through Athlete mode. Alternating between the shoulder, waist, and buttocks, the entire body is massaged to relax the muscles. There are different reclining options for this mode to rejuvenate the body and mind.

Office For those who put a lot of pressure on the waist, Office Mode focuses acupressure and tapping techniques on the waist area. Office Mode relieves built up tension in the waist caused by sedentary lifestyles.

Hip-Up Relaxing muscle tensions throughout the lower body, the hip-up mode targets the buttocks and hips. Massaging these areas by kneading, acupressure, air pressure, and a combination of these techniques, let the body experience the benefits of hip-up mode.

Rest

BODYFRIEND's Rest Mode provides healing bodies need (30min.). Rest Mode is one of BODYFRIEND's exclusively patented technologies.

STEP 01

Relieve tensions throughout the body with medium or strong massage levels at recline angles up to 135°.

STEP 02

Set at recline angle around 150°, medium intensity kneading and acupressure massages transcend the user to sleep. The back of the neck and head is gently kneaded to further induce sleep.

STEP 03

Reclined at 170°, gentle kneading and acupressure techniques relax the body and keep the body physically and mentally stabilized.

Stretch

Extend the body while relaxing on a massage chair. BODYFRIEND's unique **Stretch Mode** stretches the body even while sitting down. The entire body is encapsulated with airbags and air compression massage ensues. Airbags gently tug and pull on the body to create an "extending" effect. From head to toe, gentle stretching allows the muscles to be loosened and body to be elongated.

Product Specifications

Product Specifications are subject to change without previous notifications due to product improvements.

Model	BFS-8000US
Reclining Angle	135°- 170°
Lower Body Angle	0°-90°
Kneading Speed	25-35 kneads per minute
Kneading Width	2.4in – 6.7in (6-17cm)
Tapping	320-560 taps per minute
Heating Temperature	Max 140°F
Power Supply	110-120V~
Rated current	1.8A
Power Frequency	60Hz
Auto Timer	15min/20min/25min/30min
Airbags	Shoulders/Waist/Arms/Hips/Calves/Feet
Rollers	Feet Soles
Massage Balls	Neck/Shoulder/Back/Buttocks (Spot&Range)
Auto Mode	12 Auto Massage Modes
Weight (including packaging)	322lbs
Product Weight	276lbs
Cover / Upholstery	ABS / Synthetic Leather
Dimensions Reclined	68.9in X 32.7in X 37in (175cmx83cmx94cm)
Dimensions Upright	59.1in X 32.7in X 49.2in (150cmx83cmx125cm)
Product Name	Massage chair

Troubleshooting

If you encounter minor malfunctions or errors, please refer below before contacting Customer Support.

Problem	Causes	Solutions
Massage chair does not operate.	Controller [Power] Button is not turned on.	Press [Power] to turn on the controller on.
	Auto Mode was not selected.	Press [Enter] to select an Auto mode.
	Power cord is not properly plugged in.	Properly plug power cord into socket.
	Dead power cord.	Please contact Customer Support.
	Burnt fuse.	Please contact Customer Support.
	Non-electrical problem.	Please contact Customer Support.
Beeping during activation.	Machine noises occur.	Not a problem. Machines generate noise.
Right and left shoulder massage balls do not align.	Massage balls are manufactured with about 0.8”(2cm) difference in alignment.	Not a malfunction. Purposely manufactured to created alternating massage effects.
Noises get louder during use.	After extended hours of operation.	Please turn off the machine for 30min and start again.
	Worn out after years of use.	Please contact Customer Support.
Machine suddenly stops during massage.	Accidently pressed the OFF button.	Press the [Power] to restart the machine.
	Massage time has finished.	Restart the massage after 30 minutes.
Back motor and legangle motor does not move.	Check for any stuck objects.	Remove stuck objects.
	Excessive pressure applied.	Please turn off the machine for 30 mins and start again.
Does not go back to original resting state.	Aggressive use.	Please contact Customer Support.
Controller overheating.	Overuse.	Please contact Customer Support.
Power cord and controller cord overheating.	Excessive use.	Please turn off machine for 30 min and start again.
	Other miscellaneous causes.	Please contact Customer Support.
Airbags don't activate.	Air hose disconnected.	Connect the air hose.
	Air related power cord disconnected.	Please contact Customer Support.

Customer Support Guidelines

Customer Support Contact Information: service@bodyfriend.com / 888-299-8218 (toll free)

Register your device at www.bodyfriend.com to ensure your product is in our system for a quick and easy warranty process if ever you should need it.

Warranty Guidelines	Massage chair interior parts
	Mainboard, board parts, motors, air pump
	Interior electrical wiring/airhose
Fees Applied	Cover sheet Any fading or deterioration of fabric, product parts, exterior cover sheet, etc. caused by personal use.
	Controller Broken screens, damaged controller, etc. caused by personal use.

※ Noises does not imply broken device

Fees Applied

Fees apply for the following.

- 01 Problems due to liquids spilled within interior of product.
- 02 Broken or disabled parts due to excessive pressure.
- 03 Problems due to deformation or external defects caused by personal actions.
- 04 Problems due to not using parts or cords provided by Bodyfriend.
- 05 Problems due to incorrect use of product.
- 06 Problems caused by user disabling parts of the machine.
- 07 Problems caused by repairs conducted by non-Bodyfriend technicians/employees.
- 08 Problems caused by natural disasters.
- 09 Failure to follow safety precautions listed in User Manual.
- 10 Problems caused by user's personal mistakes.
- 11 Problems caused by user's reckless behavior, inability to follow guidelines, and etc.

※ If after evaluation results conclude problems are not user's fault, warranty will be issued.

*** REFER TO ADDITIONAL WARRANTY HANDOUT FOR
SPECIFIC INFORMATION AND WARRANTY CARD ***

Memo

REX·L

Product Name	Massage Chair
Model	BFS-8000US
Manufacturer	Shanghai BODYFRIEND Electronic Technology Co., Ltd./China
Importer	BODYFRIEND Inc.
Customer Support Contact Information	service@bodyfriend.com / 888-299-8218 (toll free)
Voltage/Frequency	110-120V~, 60Hz
Rated Current	1.8A

FCC Information to User

This equipment has been tested and found to comply with the limits for a Class B digital device, pursuant to Part 15 of the FCC Rules. These limits are designed to provide reasonable protection against harmful interference in a residential installation. This equipment generates, uses and can radiate radio frequency energy and, if not installed and used in accordance with the instructions, may cause harmful interference to radio communications. However, there is no guarantee that interference will not occur in a particular installation. If this equipment does cause harmful interference to radio or television reception, which can be determined by turning the equipment off and on, the user is encouraged to try to correct the interference by one of the following measures:

- Reorient or relocate the receiving antenna.
- Increase the separation between the equipment and receiver.
- Connect the equipment into an outlet on a circuit different from that to which the receiver is connected.
- Consult the dealer or an experienced radio/TV technician for help.

Caution

Modifications not expressly approved by the party responsible for compliance could void the user's authority to operate the equipment.

FCC Compliance Information : This device complies with Part 15 of the FCC Rules. Operation is subject to the following two conditions: (1) This device may not cause harmful interference, and (2) this device must accept any interference received, including interference that may cause undesired operation.

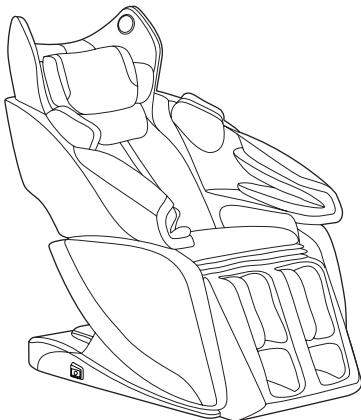

IMPORTANT NOTE:

FCC RF Radiation Exposure Statement:

This equipment complies with FCC RF radiation exposure limits set forth for an uncontrolled environment. This equipment should be installed and operated with a minimum distance of 20 centimeters between the radiator and your body. This transmitter must not be co-located or operating in conjunction with any other antenna or transmitter.
