

Brand: SGUAI

Name: SGUAI T30 SMART WATER BOTTLE

***SGUai***

Manufacturer: SGUAI (Shenzhen) Intelligent Technology Co., Ltd  
Address: 2nd floor, Building 11,Zhiheng Industrial Park, Guankou Second Road Nantou Street, Nanshan District, Shenzhen City, Guangdong Prowince.

	T30-Smart
	Water Bottles



# USER MANUAL

625.43.004.0°



## CAUTION

**Please read this guide  
carefully before use.**



## CIRCULAR READING

**SGUai**

SINCE 2016  
INNOVATIVE BRAND

## Innovative brand for smart water bottles

## T30-Smart Water Bottles

Flip-top Lid

Double  
drinking spout

Straw

### Charging Method

Place the bottle on the wireless base and connect it to the power supply to start charging. Remember to keep the surface dry to avoid damage.

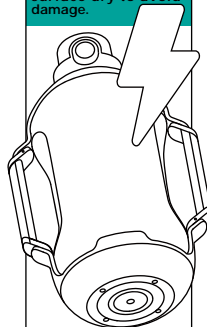

Bottle Body

Handle

SGUAI  
30T

Glow Indicator

Wireless Charging Coaster

Green light on Fully Charged  
Green light flashing In charging  
Red light flashing Low battery

Before using, please check if the accessories are complete first.

Package  
Included

Charging Coaster Carrying Strap  
User Manual Smart Bottle

## ATTENTION !

### For the first time use:



Clean your SGUAI Smart Water Bottle with soap and hot water before first use.



Please dry the water stains and ensure that the bottom of the bottle and the surface of the coaster are dry to avoid damage.



Activate the bottle by connecting it to the charging coaster, and make sure the phone Bluetooth has been turned on.



Download our free SGUAI app to discover its smart features. The app will guide you through the set up and installation.

### In use



#### Avoid falling and touching

Avoid heavily impact, damage and replaced the part by yourself.



#### Clear excess water

When the bottle is idle for a long time, remember to pour out the remaining water in the bottle.

Android/Apple users must meet the following conditions when binding a water cup: the phone's hardware supports Bluetooth 4.0 or above; The Android operating system must be based on Android 8.0 or above; The iOS operating system must be based on 10.0 or above;

## Innovative brand for smart water bottles



Recommended  
drinking  
water volume



Data  
visualization



Intelligent  
reminder



Custom  
Lights



- 1.DO NOT overfill. Fill liquids to the fill line or below to avoid accidental spilling.
- 2.DO NOT microwave or freeze.

# STEP

## APP Download

- Download our free SGUAI App from the App Store or on Google Play.
- Search "SGUAI"
- Download SGUAI APP



## APP Login Page Introduction

- If first time using, please select "Login/Sign up with Code" to access the sign-up page. (see img 2)
- Enter your email address or mobile phone number and click "Send" to receive a verification code.
- Once received the code, and fill it in the designated field and click "Sign Up." This will take you to the password setting page. (see img 3)
- On the password setting page, set your password and click "Submit" to complete your registration.
- After creating the account, please set parameters for a personalized hydration goal, to discover its smart features. (see img4)

# REMINDER



## Interface

Click the plus sign, enter "Discover the Device", then it will display the bottle to be bound, and confirm.

Click the icon to enter bottle settings.

# BLUETOOTH & CONNECTIVITY

### Water Reminder:

you can choose "Smart reminder" and "custom reminder" two kinds of mode

### Power display:

Displays remaining charge and charging status

### More settings:

You can remark the water bottle, modify personal information and unbind the water bottle



Water intake statistic:  
Display current water consumption data

### Power display:

Displays remaining charge and charging status

### Custom Lights:

you can customize two kinds of ambient light and drinking reminder light color

# CONNECT

Please ensure that your phone's Bluetooth is turned on

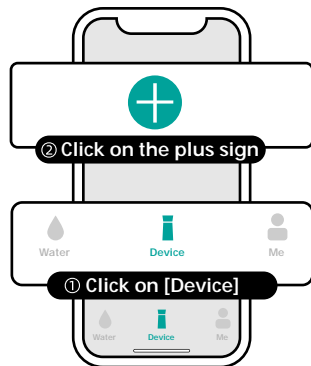

# MONITOR

# STAT

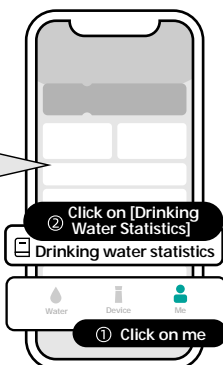
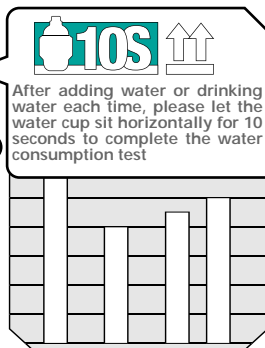
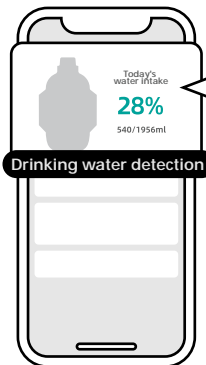

# CONNECT

Please ensure that your phone's Bluetooth is turned on

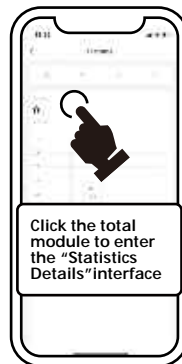

## Water Consumption Detection

You can track how much water you had through the APP[Device]-[Statistic] page, once you start following your water intake you will find that on the days when you reach your daily goal, you look and feel more energized.

Fill your bottle completely with water. Make sure the sensor stick is attached to the lid securely. Screw on the bottle lid and let sit on a flat stable surface for 10 seconds to calibrate.

Set down your bottle after every refill and drink. Remember to sync the app near the bottle each day so your water is tracked correctly.



## Water Drinking Reminder

You can access your settings through the APP[Device]-[Water Reminder] to enter the page. There are "smart reminder" and "Scheduled reminder" two kinds of drinking water reminder mode.

## Smart Reminder Mode

According to your actual water consumption, weight, activity level to design a scientific and reasonable drinking time, and through the flashing light to remind you to drink water.

Based on your last water drinking time, recalculate the next reminder time.

You can set 8 scheduled groups of drinking alarm (from 6:30AM to 22:30PM) to remind drinking regularly.

# CONNECT

Please ensure that your  
phone's Bluetooth is turned on



## Custom Lights Setting

You can access your settings through the  
● APP[Device]-[Custom Lights] to enter the setting page.

Customize to Match Your Style: Make it your own by picking the perfect color, then  
● choose from custom glow colors and exciting light patterns available in the app.



## Three light modes

- a. Monochrome Mode: click on the color plate area lights up monochrome light
- b. Gradient light: slide the color plate area to light up the illumination light
- c. Reminder light: remind to drink water when the light is on



Built-in dynamic sensor module, when you pick up the water bottle, the lights up, the length of the lighting mode can be adjusted.

# CONNECT

Please ensure that your  
phone's Bluetooth is turned on

## SPECIFICATIONS

Model	SGUAI-T30
Capacity	44 oz/1300 ml
Battery	430mAh
Weight	0.88 lb/400 g
Dimension	6.1*4.3*9.9 inches
Waterproof	IPX6
Lid Material	Food grade PP+Silicone
Charging Method	Charging Coaster
Charging Time	1.5 H
Lasting Time	7~15 Days
Rated voltage	3.7V
Input Parameter	5V/1A
Connectivity	Bluetooth
Body Material	Food grade Tritan

## CLEANING INSTRUCTIONS

- Wash thoroughly before first use.
- Do not wash the cap using the dishwasher.
- Hand wash the cap under the faucet, use a cleaning sponge if necessary.
- Also, clean the closing cap that protects the mouthpiece.
- ALWAYS allow parts to dry completely before storage.

# WARRANTY & SERVICE

- 30 days free return and quickly unconditional refund.
- 6-month free replacement for product quality issue
- Lifetime prompt buyer support and friendly customer service. Customer's satisfaction is our first priority please contact us first when you have any questions we will try our best to give you a 100% satisfying solution.

## Received the item

Unsatisfied /Need Support

Contact us via Amazon  
or our mailbox  
support@sguai.com

Prompt response,  
and friendly service within  
24 hours with satisfying  
solution.

Satisfied

Share your experience  
via reviews or feedback.  
recommend to your  
friends or families.



Hazardous substance description: The content of hazardous substance elements in the materials used in our products has complied with the limit requirements of GB/26572, where the part "X" indicates that the development of the global technical level cannot replace the content of hazardous substance elements. Our company will strive to achieve the substitution of hazardous substances based on the development of global technology, and will not be notified in case of technological development and environmental protection upgrades of hazardous substances in materials.

# ATTENTION !

- Do not connect the charging coaster with water stains on the cup body;
- Do not use heating equipment such as microwaves to heat the product
- Do not use a dishwasher for cleaning;
- When filled with hot water, please place the product out of reach of children to avoid injury/scalding;
- Do not expose to sunlight;
- Non professionals are not allowed to disassemble the cup body for repair or replacement of components
- This product has passed the IPX6 waterproof grade test and can be rinsed with confidence;
- The cup body is equipped with electronic components, please do not immerse it in water for a long time and do not boil it in water;
- Before the product is discarded, the appliance is powered off and the battery is safely disposed of by relevant professionals.

# CERTIFICATE

Brand	SGUAI	Model	T30
Manufacturer	SGUAI (Shenzhen) Intelligent Technology Co., Ltd		
Telephone	400 888 7516		
Address	2nd floor, Building 11, Zhiheng Industrial Park, Guankou Second Road Nantou Street, Nanshan District, Shenzhen City, Guangdong Province.		

# EXECUTIVE STANDARDS

Executive standards	GB4706.1-2005	Scope of application	For food contact
Standard Name	Safety of household and similar electrical appliances		
Safety standard	GB4806.7-2016 GB4806.11-2016		
Inspector	001	Date	2023.05.05



[www.twitter.com/sguaiofficial](https://twitter.com/sguaiofficial)



[www.instagram.com/sguaiofficial](https://www.instagram.com/sguaiofficial)



[www.facebook.com/sguaiofficial](https://www.facebook.com/sguaiofficial)



[www.sguai.com](https://www.sguai.com)



[support@sguai.com](mailto:support@sguai.com)

## FCC Warning

This device complies with part 15 of the FCC Rules. Operation is subject to the following two conditions: (1) This device may not cause harmful interference, and (2) this device must accept any interference received, including interference that may cause undesired operation.

Any Changes or modifications not expressly approved by the party responsible for compliance could void the user's authority to operate the equipment.

**Note:** This equipment has been tested and found to comply with the limits for a Class B digital device, pursuant to part 15 of the FCC Rules. These limits are designed to provide reasonable protection against harmful interference in a residential installation. This equipment generates uses and can radiate radio frequency energy and, if not installed and used in accordance with the instructions, may cause harmful interference to radio communications. However, there is no guarantee that interference will not occur in a particular installation. If this equipment does cause harmful interference to radio or television reception, which can be determined by turning the equipment off and on, the user is encouraged to try to correct the interference by one or more of the following measures:

- Reorient or relocate the receiving antenna.
- Increase the separation between the equipment and receiver.
- Connect the equipment into an outlet on a circuit different from that to which the receiver is connected.
- Consult the dealer or an experienced radio/TV technician for help.

The device has been evaluated to meet general RF exposure requirement. The device can be used in portable exposure condition without restriction.