

iTime™ MAX SMARTWATCH

USER MANUAL

Smart Watch



1. Downloading the App

Scan the following QR code, download and install the APP called Da Fit



Scan QR Code and Download

2. Charging and Active

Charging the device to active before the first time using;
To charge your device, plug the charging cable into the adapter or USB port on your computer.



(picture just for reference)

3. Pairing

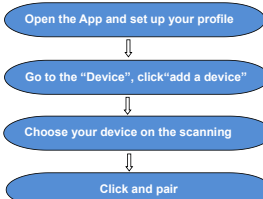

The MAC address on the watch "Setting"- "About"page could help you identify your device on the scanning list.

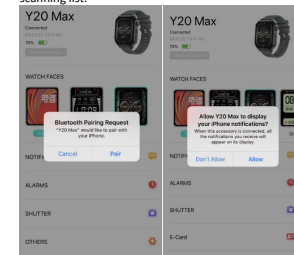

Important: After you have connected in the Da Fit App of your smartwatch, Please note that in order to be able to receive and display all the messages from the phone you must accept the permissions.

4. Use the Touch Screen



5. Smart Watch Features

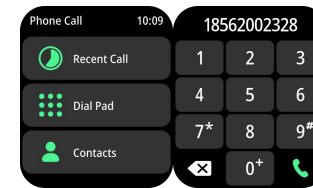

Phone

After connecting the smart watch to the APP, you can use the watch to dial and control the phone to make calls and answer calls.

You can also view the call history from the watch and add frequent contacts. You must keep establishing the connection between the watch and the phone when using the phone call function.

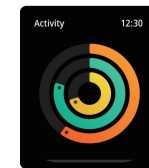

Activity

Smart watch automatically tracks the steps taken on the screen.
NOTE: Your movement stats reset to zero at midnight.



Sleep

If you keep wearing smart watch in your sleep, it can provide the hours slept and quality of sleep stats on both the screen and the APP.
NOTE: Sleep stats reset to zero at 8:00 pm.

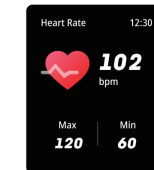

Heart Rate Test

The smart watch could record your heart rate all day. You also could tap on the page to start measuring heart rate



Blood Pressure Test

Tap on the blood pressure page to start measuring your blood pressure.
On the blood pressure page, It can show the blood pressure measured data of the last times.

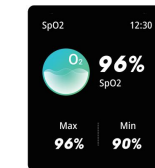

SPO2 Test

Tap the SpO2 page to start measuring your SpO2.
On the SpO2 page, It can show the SpO2 measured data of the last times.

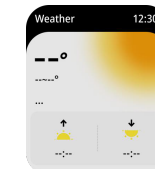

Weather

It could show the weather forecast, location, sunrise and sunset.
Weather info is synced after connected with the APP, it will not be updated after a long disconnected.



Exercise

Click on the icon on the menu to start a new training session.
Sports details including time, steps, distance, calories, heart rate and current time.
Slide to the left to pause or end exercise.

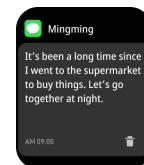

Message Reminder

The device can sync incoming notifications from Twitter, Facebook, Whatsapp, Instagram etc.
Recently 8 messages can be stored.
Note: You can switch on/off the incoming notification in the APP.

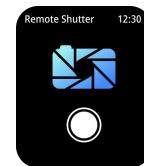

Remote Camera

After connecting the device, you can remote control the camera on your phone.



Music Control

After connecting the device, you can remote control the music player stop/play, last song, next song and volume + or -
Note: You can switch on/off the music control in the APP.



Stopwatch

Tap the start button on stopwatch page to start timing, and tap the stop button to stop timing.

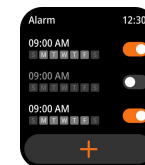

Alarm

Set up the alarm on the APP or watch, the device will vibrate to remind on time.



Remind To Drink

The smart watch will remind you "Time to Drink Some Water" at the planned drinking time.
Note: You can set the feature in APP.

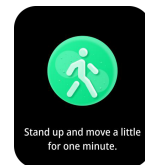

Remind To Move

The device will vibrate to remind you to make a relax after 1 hour sitting.
Note: You can switch on/off the feature in the APP.

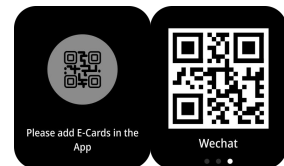

E-Cards

You can upload the QR code of the social app (like Wechat, Whatsapp ect.) from mobile phone album, and then it will be displayed on the smart watch.

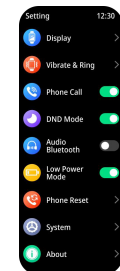

Settings

Include display, vibrate, do not disturb, low power mode, reset, system, about.

6. Getting To Know Your Device

1. Using in Wet Conditions

Your device is water-resistant, which means it is rain-proof and splash-proof and can stand up to even the sweatiest workout.

NOTE: Do not swim with your smart watch. We also don't recommend showering with your watch; Though the water won't hurt the device, wearing it 24/7 does not give your skin a chance to breathe. Whenever you get your bracelet wet, dry it thoroughly before putting it back on.

2. Using Quick View

With Quick View you can check the time or the message from your phone on your watch without taping. Just turn your wrist towards you and the screen will appear for a few seconds.

7. General Info & Specifications

1.Environmental Conditions
Operating temperature: 14°F to 122°F (-10°C to 50°C)
Non-operating temperature: -4°F to 140°F (-20°C to 60°C)

2. Disposal and Recycling

Please kindly be aware that it is the consumer's responsibility to properly dispose and recycle Smart Bracelet and accompanying components. Do not dispose of Smart Bracelet with common household waste, the Smart Bracelet unit is considered electronic waste and should be disposed of at your local electronic equipment collection facility.
For more information, please contact your local electronic equipment waste management authority or the retailer where you bought the product.

8. FCC Compliance Statement

This device complies with Part 15 of the FCC Rules. Operation is subject to the following two conditions:
(1) This device may not cause harmful interference, and (2) this device must accept any interference received, including interference that may cause undesired operation.

NOTE 1: This equipment has been tested and found to comply with the limits for a Class B digital device, pursuant to part 15 of the FCC Rules. These limits are designed to provide reasonable protection against harmful interference in a residential installation. This equipment generates, uses and can radiate radio frequency energy and, if not installed and used in accordance with the instructions, may cause harmful interference to radio communications. However, there is no guarantee that interference will not occur in a particular installation. If this equipment does cause harmful interference to radio or television reception, which can be determined by turning the equipment off and on, the user is encouraged to try to correct the interference by one or more of the following measures:
- Reorient or relocate the receiving antenna.
- Increase the separation between the equipment and receiver.
- Connect the equipment into an outlet on a circuit different from that to which the receiver is connected.
- Consult the dealer or an experienced radio/TV technician for help.

NOTE 2: Any changes or modifications to this unit not expressly approved by the party responsible for compliance could void the user's authority to operate the equipment.

The device has been evaluated to meet general RF exposure requirement. The device can be used in portable exposure condition without restriction.

Supplier's Declaration of Conformity

47 CFR § 2.1077 Compliance Information

Product Name: Smart Watch
Product Model: iTime Max
Manufacturer:
Accutime Watch Corporation
1001 Avenue of the Americas
6th Floor
New York, NY 10018
info@accutimewatch.com
www.accutimewatch.com

This device complies with part 15 of the FCC Rules. Operation is subject to the following two conditions:
(1) This device may not cause harmful interference, and (2) this device must accept any interference received, including interference that may cause undesired operation.

9. One-Year Watch Service Limited Warranty

Do NOT return the watch to the store.

This watch is warranted for a period of one (1) year from the date of purchase to be free from original defects in materials and workmanship under normal use. In the event of any defect or failure, the manufacturer will replace the watch with an exact or similar valued model without charge at our option.

This warranty does not cover wear or consequential damage to the watch case or strap. This warranty does not cover water damage, improper use, negligence, or unauthorized service or repairs and is considered void for other factors not due to defects in materials or workmanship.

U. S. residents must include a shipping and handling fee of \$10.00 in the form of a check or money order payable to Accutime Watch Corp. Additional fees may apply. Send your watch for warranty service to:

Accutime Watch Corp.
ATTN: Service Dept.
1001 Avenue of the Americas, 6th Floor New York, NY 10018