



WiFi Door/Window Sensor



IC-CWD1W
FCC ID : 2ALNA-ICCWD1W

User Manual

Description
The iclever Security Window/Door Alarm provides a simple-to-use, cost-effective security solution to protect you and your family against home invasions. Thanks to the rechargeable lithium battery, this door sensor can be used for many years to come. With the IoT Wi-Fi technology, you can easily connect the door sensor and the cloud server together, letting you get know of the alarm in no time.

Application
Houses, apartments, hotels, villas and anywhere that surveillance is needed.

Features
1. Professional electromagnetic switch
2. Switch status detection transmission
3. Support low power detection and daily detection
4. Support on-site alarm (with LED flashing) and remote alarm (connect the Wi-Fi and cloud server together and alert your smartphone via the APP)
5. Rechargeable & long-lasting lithium battery
6. Hardware watchdog

Specifications
Power: 3.7V lithium battery (500mA lithium battery)
Charging Mode: Micro-USB 5V/1A
Power Consumption: peak currents 300mA / standby currents 5µA

-01-

WiFi only support 2.4G frequency, 802.11b / g / n
Working Temperature: 14~122°F / -10~+50 °C
Working Humidity: 10%~95% RH
Installation: using adhesive tape
Applied Environment: indoors
Dimension: 2.83x1.69x0.62in/72x42.8x15.8mm
Weight: 1.27oz/36g

How to Install
Note: Before installation, make sure all the configuration needed for the APP is done.
1. Tear off the film of the 3M adhesive tape on the back of the door sensor and then fix the sensor to the place you want—usually on the door or window frame.
2. The door sensor is consist of two parts. Make sure to align them on one side along the white line. Make sure the distance between the two parts is less than 5mm when the door is closed.
3. When the battery power is low, remove the sensor and charge it with the 5V-micro USB charger. When the blue LED goes off, the charging is done.

Warning
1. Do not mount the door sensor too low to avoid damage.
2. Do not install the door sensor near the large magnetic field.
3. For more accurate alarm, make sure the distance the two parts is as small as possible.

-02-

App Instructions

1. Download APP
Method 1: Scan the QR code below and download the app.
Method 2: Search "Smart Life" and download the app. (For the IOS users, please download the app from the Apple store; for the Android users, please download from any app store. Like Google Play Store.)

2. Register
Open the app and finish the registration under the instructions given.



-03-

3. Add Device
a. Log in the app, then select "Add Device" --> Security Sensor --> Sensor (Wi-Fi).
b. Press the power button.
c. After 10s, press and hold the reset button for 5s and switch to the Wi-Fi configuration state.
d. Then there will be two modes displayed at the app interface --> EZ mode (Wi-Fi connected mode) and AP mode (hotspot distribution mode).

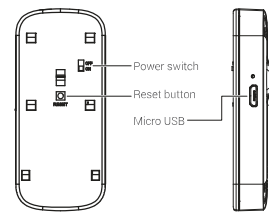

-04-

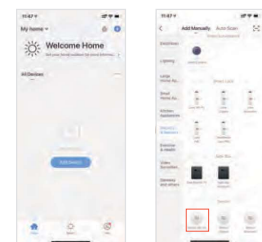

-05-

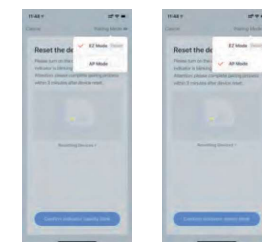

According to the instructions of the app, input the Wi-Fi SSID and password to start the connection. Wait about 60 seconds to finish the network configuration of the device and its connection to the Tuya cloud server for synchronization with the APP. After adding the device, the app interface will switch to its operation and monitoring interface directly. You can change the name of the device or share the device to other people through the app directly. Under the operation interface, you can check its status, alarm, offline & alarm release, history record and other setting options.

-06-

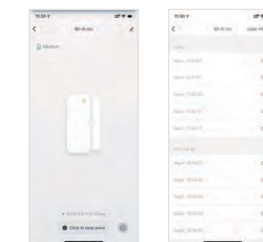

Note:
Make sure the device and the app work under the same Wi-Fi or hotspot network to make sure the validity of the device set through EZ or AP mode and the device information recognized by the APP. If the Wi-Fi network is not available, choose AP mode to finish the configuration.

-07-

Multimode Connection

EZ Mode (Default Mode)
When configuring under the EZ mode, make sure the Wi-Fi network connect to the internet normally, and ensure the APP and the device work under the same Wi-Fi network with the LED indicator light keeping flashing fast. Input the SSID and password to connect the device with cloud server and finish the configuration. If you need to use different Wi-Fi network, select "Change network" on the app.

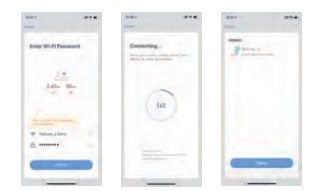

-08-

AP Mode
When configuring under the AP mode, make sure the hotspot network connect to the internet normally, and ensure the APP and the device work under the same hotspot network with the LED indicator light keeping flashing slowly. Under the AP mode, input the SSID and password, connect your smartphone to the hotspot of the device (mobile device or tablet) and then connect to the hotspot network "SmartLife-xxxx" (select on the Wi-Fi network list). If the connection is successful, it will return to the app interface and the configuration will be done automatically.

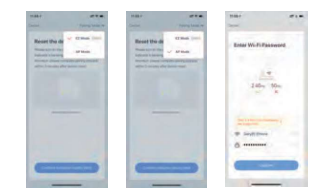

-09-



Note
After turning on the device, press and hold the reset button for 5s and it will enter the fast flash state by default; press and hold the reset button again, it will enter the slow flash state.

Once the device is added to the "Smart Life" user account, the indicator light will go off, and the app interface will switch to the operation interface, which indicates that the device has been added successfully. If not, repeat the steps until you add the device successfully.

-10-

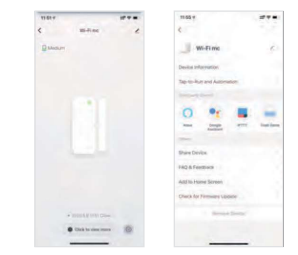

Delete Device
Select the "Edit" icon to enter the operation interface, Choose "Remove device" to delete the device.

-11-

Door Magnetic Detection Alarm
If the state of the door changes, the red LED indicator light on the front of the sensor will flash once, and the LED will show differently according to the state of the door. The alarm data will be sent to the cloud server, and the cloud server will send the alarm information to the APP simultaneously. The APP interface displays as below.



-12-

FCC Statement
Changes or modifications not expressly approved by the party responsible for compliance could void the user's authority to operate the equipment.

This equipment has been tested and found to comply with the limits for a Class B digital device, pursuant to Part 15 of the FCC Rules. These limits are designed to provide reasonable protection against harmful interference in a residential installation. This equipment generates uses and can radiate radio frequency energy and, if not installed and used in accordance with the instructions, may cause harmful interference to radio communications. However, there is no guarantee that interference will not occur in a particular installation. If this equipment does cause harmful interference to radio or television reception, which can be determined by turning the equipment off and on, the user is encouraged to try to correct the interference by one or more of the following measures:
-- Reorient or relocate the receiving antenna.
-- Increase the separation between the equipment and receiver.
-- Connect the equipment into an outlet on a circuit different from that to which the receiver is connected.
-- Consult the dealer or an experienced radio/TV technician for help.

This device complies with part 15 of the FCC rules, Operation is subject to the following two conditions (1) this device may not cause harmful interference, and (2) this device must accept any interference received, including interference that may cause undesired operation.

This equipment complies with FCC radiation exposure limits set forth for an uncontrolled environment. This equipment should be installed and operated with minimum distance 20cm between the radiator & your body

-13-



www.iclever.com
Email: support@iclever.com
18 Months Replacement Warranty