



DEAR CUSTOMERS/尊敬的客户
 Thank you for choosing our product./感谢您的购买
 Please read this manual carefully before use and keep it properly for future reference.
 在使用前,请务必阅读此说明书及包装箱中随附的安全指南,请妥善保管好此说明书。

Product Information/一般特征表

Product Model/产品型号	VA01
Wireless Version/无线版本	V5.0
Transmission Distance/传输距离	10m
Frequency Response/频率	50Hz-20KHz
Impedance/阻抗	32Ω
Rated Power/额定功率	2mW
Driver Unit/驱动单元	13mm
Battery Capacity/电池容量	Charging case, Earbud/充电盒、耳机:280mAh, 25mAh
Input/输入	DC5V-500mA
Playing Time/播放时间	4-5H
Charging Times/充电次数	2-3 times/次
Standby Time/待机时间	3个月
Charging Time/充电时间	Charging case, Earbud/充电盒、耳机:2h
Product Net Weight/产品净重	42.5g
Product Size/产品尺寸	52*21.5*46mm
Product Color/产品颜色	White/白
Support Bluetooth Protocol/支持蓝牙协议	A2DP, AVRCP, HSP, HFP, EDR



On/Off 开/关机

开机: 耳机从充电盒取出, 耳机自动开机;
 关机: 将耳机放入充电盒内关闭充电盒盖, 耳机自动关机 提示音: 滴

Power on: Take the earbuds out of the charging case and auto power on.
 Power off: Put the earbuds in the charging case and close the cover to auto power off. Prompt tone: Di.

TWS Pairing TWS配对

1. 打开充电盒, 取出耳机, 耳机自动进入配对模式;
2. 手机打开蓝牙, 搜索耳机配对名: VA01;
3. 按手机提示音点击连接。

Indicator Description 指示灯说明

- 充电中橙灯常亮 充满电橙灯熄灭
- 耳机入充电盒内, 关闭充电盒盖绿灯亮10S左右 (电量在30%~100%)。
- 充电盒电量在30%~100%合盖时亮绿灯, 电量少于30%合盖时亮橙灯
- The orange light stays on during charging, and off when fully charged.
- Put the earbuds in the charging case, and close the cover with the green light on for 10S (a battery level of 30%-100%).
- With a battery level of 30%-100%, the green light is on when closing the charging case; with less than 30% power, the orange light is on.

Earbud Touch Control 耳机触控操作

- 接听: 来电状态单击
- 拒接: 来电状态长按
- 挂断: 通话状态单击
- 播放/暂停: 单击 (左、右耳都可以)
- 上一曲: 双击左耳
- 下一曲: 双击右耳
- Siri: 三击左耳语音控制
- 音量 -: 长按2秒左耳
- 音量 +: 长按2秒右耳
- Answer: Tap once to answer an incoming call.
- Reject: Tap and hold to reject an incoming call.
- Hang up: Tap once to end the call.
- Play/Pause: Tap once (left/right earbud).
- Previous track: Double-tap the left earbud.
- Next track: Double-tap the right earbud.
- Siri: Triple-tap the left earbud.
- Volume -: Tap and hold the left earbud for 2S.
- Volume +: Tap and hold the right earbud for 2S.

Safety Instruction 使用重要说明

Protect Your Hearing 为您的听力负责

Sound/声音	Noise Level (dB) 噪音等级 (dB)	Effect/效果
Bass/低音	30	Very quiet./非常安静
Quiet offices/安静的办公环境 Vacuum cleaner or hairdryer 吸尘器、吹风机	50-60	Comfortable hearing range below 60dB./低于60dB的舒适听力范围
Food processor 食品搅拌机	65-90	85dB is the threshold at which hearing loss (continuous exposure to the sub-environment for 8 hours) starts. 85dB听力受损的临界点于此环境中达到1小时开始的疼痛
Garbage truck cement mixer 垃圾车、水泥搅拌机	100	For a sound between 90 and 100dB, it is recommended that the exposure time should not exceed 15 minutes without protection. 介于90到100dB的声音, 建议在未受保护的情况下暴露于此的时间不超过15分钟
Electric saw, electric drill, jackhammer 电锯、电钻/手磨机	110	Regular exposure to sounds above 100dB for more than 1 minute may cause permanent hearing damage. 经常性暴露于100dB以上的声音超过1分钟可能会造成永久性听力损害
Rock concert (Specific situation varies) 摇滚音乐会 (具体情况有别)	110-140	A sound above 125dB starts to make people feel painful. 125dB的声音开始令人产生痛感

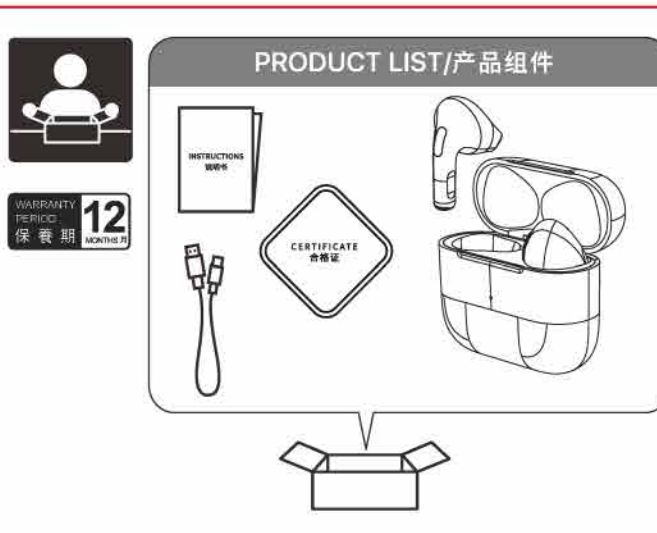

Warranty/保修条例

This product is covered under warranty for a period of one year from the date of sale limited to normal use and maintenance of the machine parts, materials and functions. Problems and failures verified upon further identification will be provided free repair and replacement parts.
 本产品有效保修期为自出售之日起一年内, 在保修期限内正常使用和维护的情况下, 机器本身材料材料及功能出现问题, 发生故障, 经查属实, 本公司将提供免费修理及更换零件。

This warranty does not apply/本产品的保修不适用于:

- (A) to a product that is out of warranty/耳机已超出保修期;
- (B) to damage caused by operating the product outside the permitted or intended uses described by WK/用户未按照说明书要求, 造成耳机折断, 外壳破损;
- (C) to a product that has been disassembled, repaired or modified without the authorization of WK/未经本公司授权自行拆装, 修理, 改动结构;
- (D) if warranty card and proof of purchase cannot be presented
无法提供保修卡及消费凭证;
- (E) to damage caused by earthquake, fire or other external causes, natural disasters, etc./因自然灾害等不可抗力 (如地震、火灾) 原因造成的产品故障或损害;

Note: The warranty does not include product transport costs and does not provide on-site maintenance services.
 注: 保修服务不包括产品运输费用及上门维修服务

本保修条款解释权归韦睿科技所有
 WK reserves all rights to clarify this warranty interpretation.

Warranty Feedback Form (Tick Off)
 保修反馈表 (勾选)

A. Can not recharge 无法充电

B. Sound quality deteriorates 音质变差

C. No sound 耳机无声音

D. Touch cannot be operated 触控无法操作

E. Unable to pair with other device 无法配对设备

F. Others/其他

Time Of Purchasing/用户购买时间 _____

When Did The Problem Occur/问题出现时间 _____

Dealers Of Sale/购买经销商 _____

User's Contact Info/用户联系方式 _____

WEKOME®

RMINE INDUSTRIAL (ASIA) CO., LTD. 博通實業 (亞洲) 有限公司
 Office Address/地址: 25/F, Two Grand Tower, 625 Nathan Road, Kowloon, Hong Kong/香港九龍彌敦道625號維多利亞中心二期25樓 - Manufacturer/製造商: Shenzhen WEKOME Technology Co., Ltd./深圳韦睿科技有限公司 - Assembled: 1st Floor of A2 Building, MingJun Industrial Park, No. 6 HuaNing Road, Longhua New District, Shenzhen/深圳市宝安区福永街道明君工业园A2楼1楼 - Service/热线: 400-800-630

WEKOME WeChat www.wekome.hk

This device complies with Part 15 of the FCC Rules. Operation is subject to the following two conditions: (1) this device may not cause harmful interference, and (2) this device must accept any interference received, including interference that may cause undesired operation.

Changes or modifications to this unit not expressly approved by the party responsible for compliance could void the user's authority to operate the equipment.

NOTE: This equipment has been tested and found to comply with the limits for a Class B digital device, pursuant to Part 15 of the FCC Rules. These limits are designed to provide reasonable protection against harmful interference in a residential installation. This equipment generates uses and can radiate radio frequency energy and, if not installed and used in accordance with the instructions, may cause harmful interference to radio communications. However, there is no guarantee that interference will not occur in a particular installation. If this equipment does cause harmful interference to radio or television reception, which can be determined by turning the equipment off and on, the user is encouraged to try to correct the interference by one or more of the following measures:

- Reorient or relocate the receiving antenna.
- Increase the separation between the equipment and receiver.
- Connect the equipment into an outlet on a circuit different from that to which the receiver is connected.
- Consult the dealer or an experienced radio/TV technician for help.

This device and its antenna(s) must not be co-located or operation in conjunction with any other antenna or transmitter.

Radiation Exposure Statement

The device has been evaluated to meet general RF exposure requirement in portable exposure condition without restriction.