

Packing List

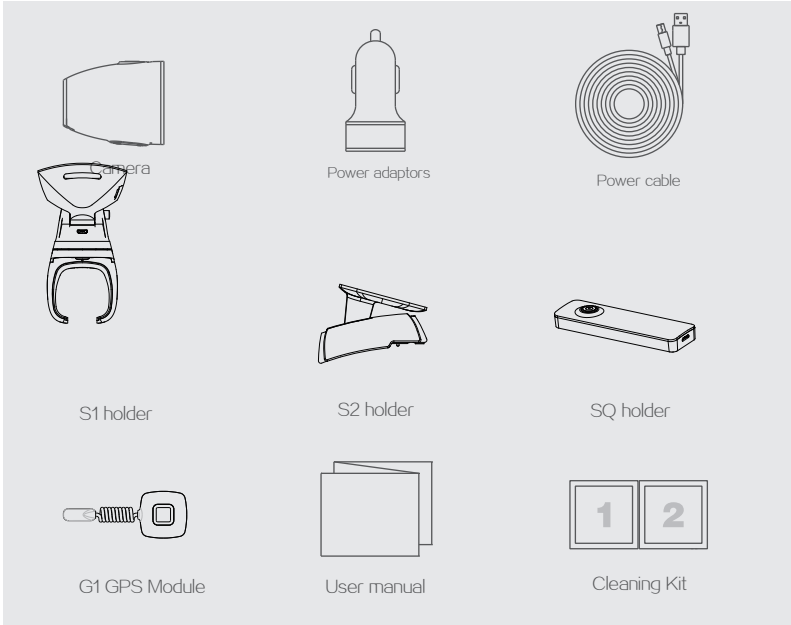

Installation Steps

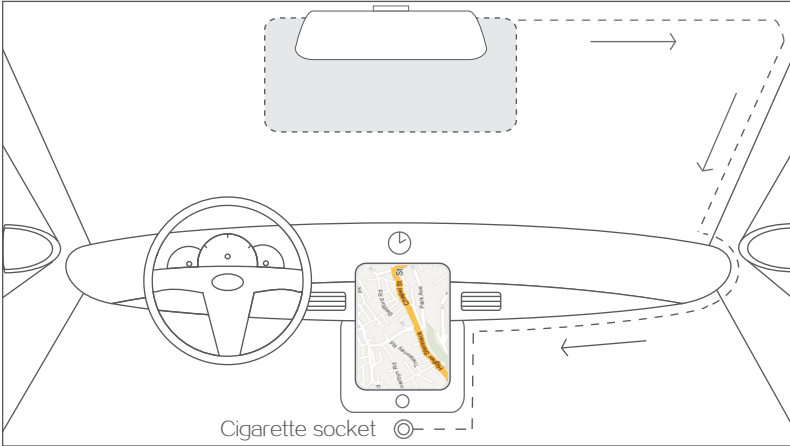

1. Select and clean installation position
2. Fix car holder
3. Arrange charging cable
4. Insert car adapter to cigar lighter socket
5. Insert memory card to device
5. Insert holder to device

Instruction Manual

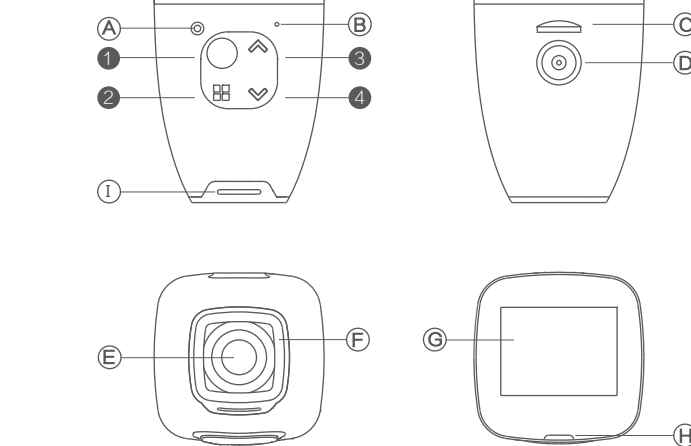

1. Power switch / OK
2. Menu/Mode
3. Up select button
4. Down select button
- (A) Reset button
- (B) MIC hole
- (C) TF card slot
- (D) Magnet DC in/Radiator
- (E) Wide angel lens
- (F) Optical coating tempering glass
- (G) High-definition screen
- (H) Working condition light
- (I) Working condition light

Key features

Button	Operational status	Conventional Functions
Power	Power off	Short-press to turn it on
	Arbitrary state	Long-press to turn it off
	Preview mode	Short-press on “start/stop” to record
	Main menu	Short-press on “Confirm”
	Photo mode	Short-press on” Photos-taking”
	Playback mode	Short-press on “play/pause”
Menu	Recording state	Short-press on” lock recording”
	Main menu	Short-press to change from Mode menu to Setting menu
	Main menu	Long-press to change mode from photos to preview to playback”
UP	Preview/recording/camera	Short-press on ” Focus”
	Preview state	Long-press on “180° rotate”
	Menu state	Short-press on “UP”
	Playing state	Short-press on “accelerate 2X,4X,8X”
Down	Preview/recording/camera	Short-press on “Focus”
	Preview state	Long-press on” turn MIC on/off”
	Menu state	Short-press on” Down”
	Playing state	Short-press on “accelerate 2X,4X,8X”
RESET	Short-press to reset	

Notes: The yellow marks are

Specifications

Chipsets	NT96658
Sensor	SONY imx322
Lens	F2.0 150° Diagonal Viewing Angle 6 layer glass + IR
Spectacles	Optical coating tempering glass
LCD	1.5" 480x240dots
Resolution/FPS	1080P / 30fps ,720P / 60fps
Battery	Built-in polymer Li-ion Battery
Loudspeaker	8Ω 0.5W
Storage	MAX:64G micro SD
Image Technology	H.264/MOV/x4 digital zoom/WDR
Security Application	G-sensor/Motion detection /LDWS /Parking Mode
Machine Features	Quick disassembling /Magnet power supply/360° rotation
Working Temperature	- 20℃~70℃

**Using tips**  
The device has the quick way of dismounting for portability; When it was taken out from the holder, LCD has the selection and notice of “Turn off”.So it will turn off automatically without any operations.

FCC Warning Statement

Changes or modifications not expressly approved by the party responsible for compliance could void the user’s authority to operate the equipment. This equipment has been tested and found to comply with the limits for a Class B digital device, pursuant to Part 15 of the FCC Rules. These limits are designed to provide reasonable protection against harmful interference in a residential installation. This equipment generates uses and can radiate radio frequency energy and, if not installed and used in accordance with the instructions, may cause harmful interference to radio communications. However, there is no guarantee that interference will not occur in a particular installation. If this equipment does cause harmful interference to radio or television reception, which can be determined by turning the equipment off and on, the user is encouraged to try to correct the interference by one or more of the following measures:

- Reorient or relocate the receiving antenna.
- Increase the separation between the equipment and receiver.
- Connect the equipment into an outlet on a circuit different from that to which the receiver is connected.
- Consult the dealer or an experienced radio/TV technician for help.

This device complies with part 15 of the FCC rules. Operation is subject to the following two conditions (1) this device may not cause harmful interference, and (2) this device must accept any interference received, including interference that may cause undesired operation.

Recording Settings menu(Preview>short-press on menu)

Resolution	Cyclic recording	WDR	Exposure	Motion detection	Record audio	Parking monitoring system	Off course	Date stamp	G-sensor
1080FHD1920x1080	Off	On	+0.0	Off	Off	Off	Off	Off	Off
			+2.0 -1/3						
720P1280x720	3 minutes		+5/3 -2/3						High
		Off	+4/3 -1.0	On	On	On	On	On	Middle
WVGA 848x480	5 minutes		+1.0 -4/3						
			+2/3 -5/3						
VGA 640x480	10 minutes		+1/3 -2.0						Low

Notes

Q: How to select Micro SD card?  
A: Pleases choose branded SD card, the maximal support of which is class 10 Micro SD card–64GB (this card has to be formatted before being used in Windows and it has to be set in FAT32 document system).Recordings will be lost and damaged if defective SD card being used.

Q: How long the car DVR can keep working?  
A: Device has a built-in 420mAh polymer battery, and it can provide 60-minute recording without power supplying.

Q: How to use Parking Monitoring System?  
A: When the G-sensor of the car DVR has been collided, it will record for 15 seconds automatically and save as an urgent file.; The power of the machine is provided by its built-in battery.

Q: Could the power supply line be changed?  
A: We don’t suggest that you change the power supply line according to the feedback from most customers.(Firstly, besides supplying power to the car DVR, our car adapter with double interface also could provide another interface for supplying power; The factory may reject providing maintenance if you have changed the original

System Settings menu (Preview>short-press on Menu>short-press on menu)

Date/Time	Beep sound	Language	Frequency	Screensavers	License plate	Format	Default settings	Version
Existed	On	English/French/Spanish	50HZ	Off	Existed	Existed	Existed	Existed
		Portuguese/German/Italian		1 minute				
	Off	Simple- Chinese/Traditional	60HZ	3 minutes				
		Chinese/Russian/Japanese		5 minutes				

Camera setup menu (Preview>long-press on Menu>short-press on Menu)

Capture mode	Resolution	Sequence	Image quality	Sharpness	White Balance	Color	ISO	IOS	Exposure	Anti-shaking	Quick preview	Date stamp
Single	3M 2048x1536	Off	Superior	Strong	Auto	Color	Auto		+0.0		Off	Off
	2MHD 1920x1080								+2.0	-1/3		
2S timer	VGA 640x480						100		+5/3	-2/3		2 seconds
	13M 1280x960								+4/3	-1.0		
5Stimer	12M 4032x3024	On	Normal	Normal	Cloudy	Black& White	200		+1.0	-4/3	On	Date
	10M 3648x2736								+2/3	-5/3		
10Stimer	8M 3264x2448						400		+1/3	-2.0		5 seconds
	5M 2592x1944											

Notes: The gray marks are

Operation: Preview>>long-press on “Menu” >>long-press on “Menu” again>>short-press on “Menu” Esc: Back to Preview by pressing on “Menu”

Video playback menu

Delete	Protect	Photo play
Delete current	Lock current	2 seconds
	Unlock current	5 seconds
Delete all	Lock all	8 seconds
	Unlock all	

Q: Shall we open Car mode function by hand?  
A: We needn’t to open function by hand when the power is supplied by the Car cigarette lighter for it will start recording when the car runs and stop in 15 seconds when the car flameout.

Q: How to flip the picture when the Car DVR used on SQ holder?  
A: Device has an easily shooting access function. You can get 180 rotation pictures by a long-press on ” ^” in Preview.

Q: What is to be noticed when users use SD card?  
A: The Car DVR will turn off automatically or the recording will lost or be damaged when you take out the TF card whiling recording.

## How to download APP ?

1. Manufacturer provide the APP to user .
2. For Android OS phone : go to Google play to search “Lerccenker” to download it to install .
3. For IOS phone : go to APP Store to search “Lerccenker” to download it to install .

## How to turn on the WiFi (WiFi Off default)

1. Two ways to turn on WiFi
  - a) Shortcut key : Long press “DOWN” button under Video Mode (recommend)
  - b) Turn it on from Setting Menu : Video Mode ->press “Menu”->press “Menu”, select WiFi setting to turn it on .
2. After turn on WiFi , the ID and PW and will be shown on the screen of DVR as following :



3. After connect WiFi by smart phone , the ID and PW will be disappear and the WiFi icon will be turn to be green .



4. The working distance between DVR and smart phone is about 10 meters max .

## APP connection

1. Download and install APP to Android and IOS smart phone .
2. Open APP and enter the login page .
3. Go to the WiFi setting of smart phone, search the SSID which shown on the DVR screen and connect to it , the PW is 12345678 . Connect it successfully and exit it .
4. Back to the APP , you can see the real video from DVR in your APP .