

Compatible with 310 MHz, 315 MHz or 390 MHz garage door openers manufactured after January 1, 1993. Make sure the garage door opener has a working light bulb because it is a programming indicator.

For use with commercial door operators or other products that are 310 MHz, 315 MHz or 390 MHz and have a Learn button. Refer to your product manual for the location of the Learn button.

# WIRELESS KEYLESS ENTRY

## PREPARE

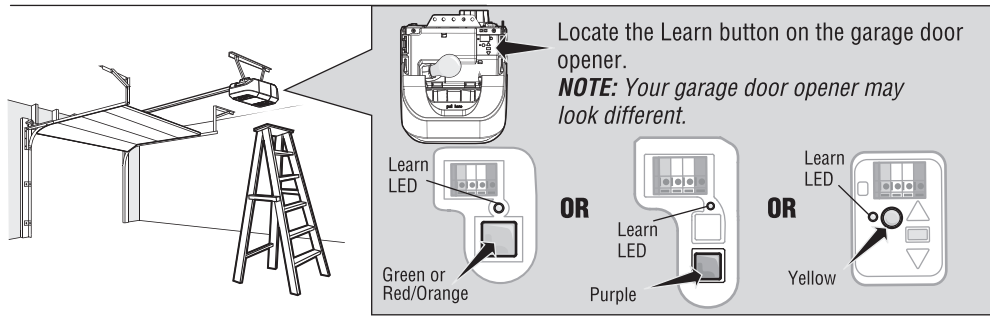

## PROGRAM INITIAL PIN

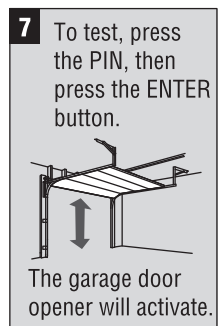
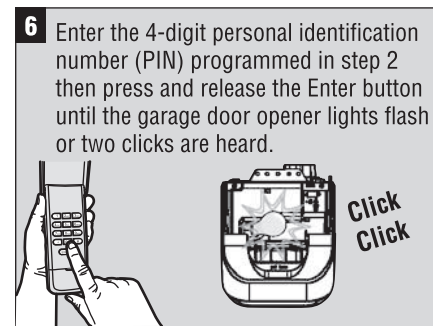
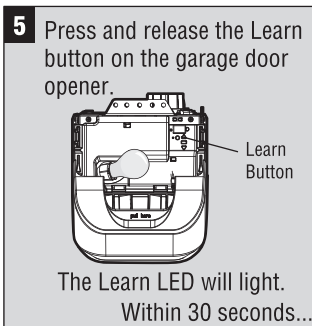
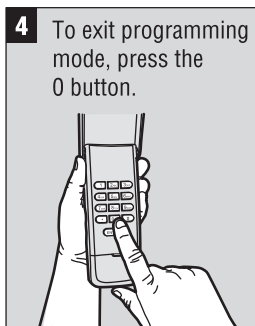
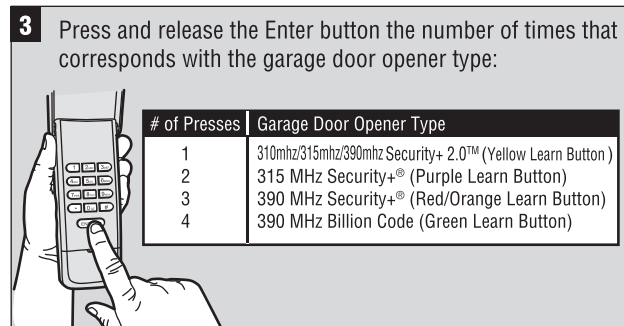
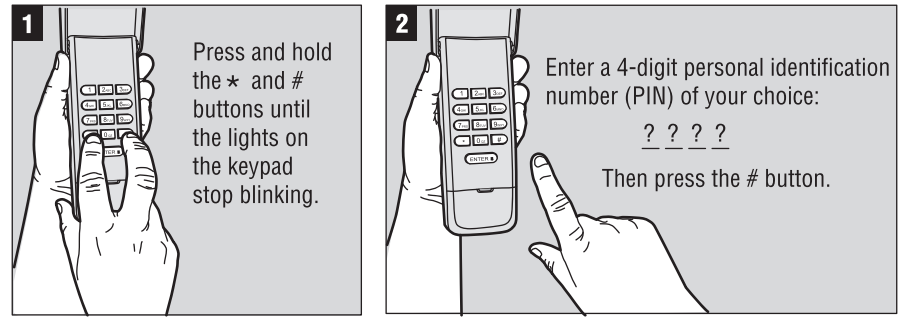

To program the Keyless Entry to more than one garage door opener, repeat the steps above using a new PIN for each additional garage door opener.

## CHANGE AN EXISTING PIN\*

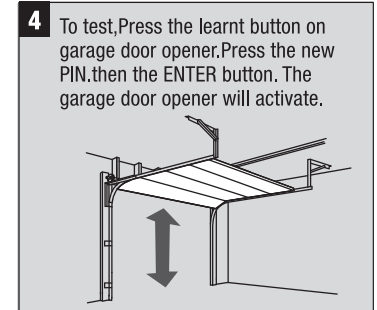
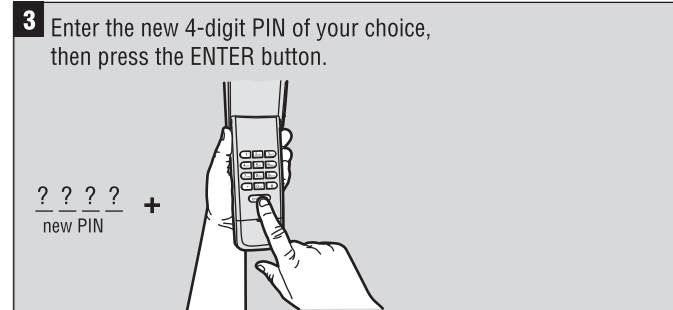
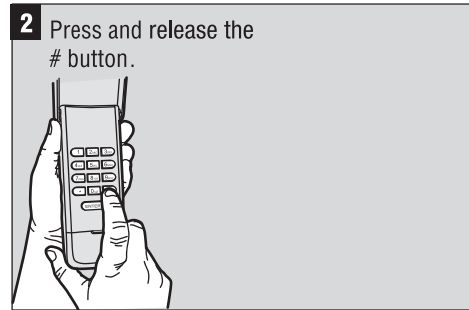
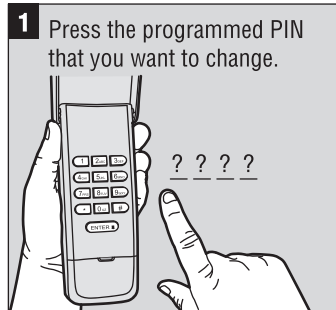

# PROGRAM A TEMPORARY PIN

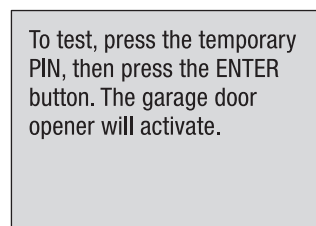
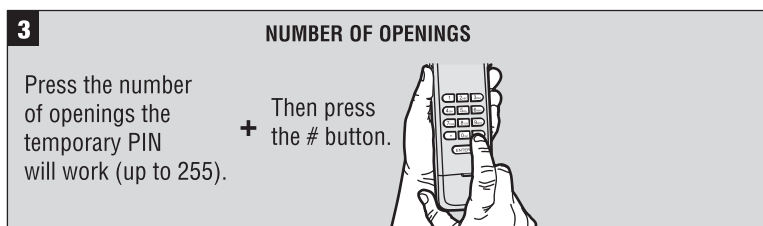
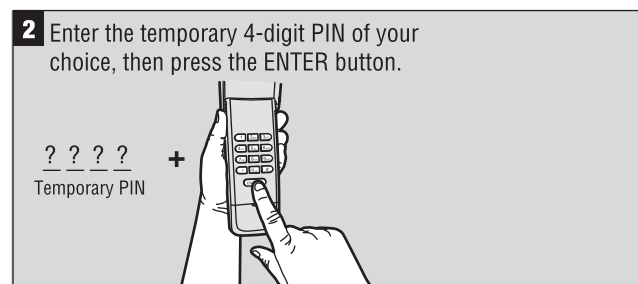
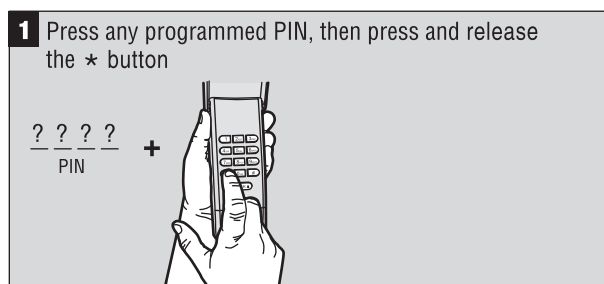

## INSTALLATION

- Select a location to mount the Keyless Entry at a minimum height of 5 feet (1.5 m) out of the reach of children.
- Remove battery cover and battery.
- Mark the top mounting hole and drill 1/8 inch (3.2 mm) pilot hole.
- Install the top screw, allowing 1/8 inch (3.2 mm) to protrude above the surface. Position the Keyless Entry over the top screw.
- Mark the bottom hole and drill 1/8 inch (3.2 mm) pilot hole. Install the bottom screw. Do not overtighten to avoid cracking the plastic housing.
- Reinstall battery and replace cover.

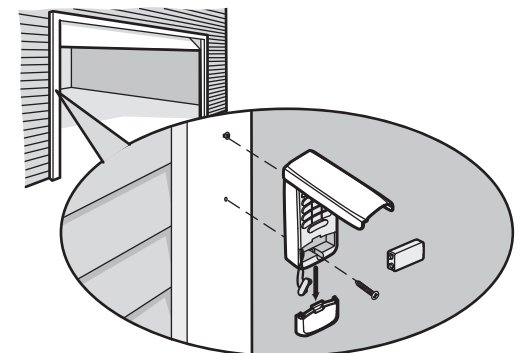

## REPLACEMENT PARTS

Battery . . . . .9V

## WARRANTY

ONE YEAR LIMITED WARRANTY

### FCC Statement:

Any Changes or modifications not expressly approved by the party responsible for compliance could void the user's authority to operate the equipment. This device complies with part 15 of the FCC Rules. Operation is subject to the following two conditions:

- (1) This device may not cause harmful interference, and
- (2) This device must accept any interference received, including interference that may cause undesired operation.

Note: This equipment has been tested and found to comply with the limits for a Class B digital device, pursuant to part 15 of the FCC Rules. These limits are designed to provide reasonable protection against harmful interference in a residential installation. This equipment generates, uses and can radiate radio frequency energy and, if not installed and used in accordance with the instructions, may cause harmful interference to radio communications. However, there is no guarantee that interference will not occur in a particular installation. If this equipment does cause harmful interference to radio or television reception, which can be determined by turning the equipment off and on, the user is encouraged to try to correct the interference by one or more of the following measures:

- Reorient or relocate the receiving antenna.
- Increase the separation between the equipment and receiver.
- Connect the equipment into an outlet on a circuit different from that to which the receiver is connected.
- Consult the dealer or an experienced radio/TV technician for help.

### RF warning for Portable device:

The device has been evaluated to meet general RF exposure requirement. The device can be used in portable exposure condition without restriction.