



CASSIA S1000 / S1100 Bluetooth Router

QUICK START GUIDE

© Cassia Networks, Inc. Cassia Networks and the Cassia Networks logo are trademarks of Cassia Networks, Inc.

GETTING STARTED -- ENGLISH

I. INCLUDED IN PACKAGE

(1) S1000/S1100 Router



(1) Micro USB Power Cable

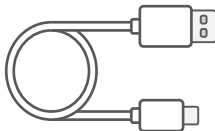

(1) USB Power Plug

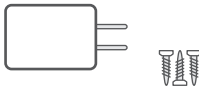

(3) Mounting Screws

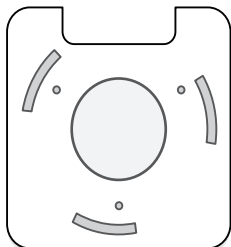

(1) Mounting Plate



(1) Quick Start Guide

II. MOUNTING & INSTALLATION

- 1) Place the S1000/1100 on a flat, unobstructed surface or mount it using the supplied mounting kit in a vertical or horizontal orientation
- 2) If mounting, first screw mounting plate into wall or ceiling

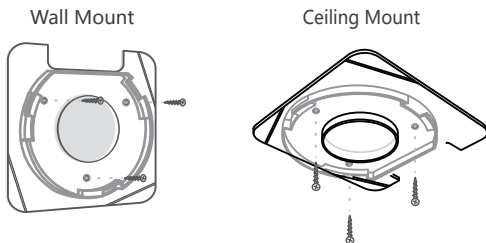

- 3) Then, connect S1000 to Power with supplied Micro USB cable & power adapter and to a WiFi Access Point via Ethernet or WiFi (2.4GHz only). S1100 can also connect to power-over-ethernet (POE) connection.

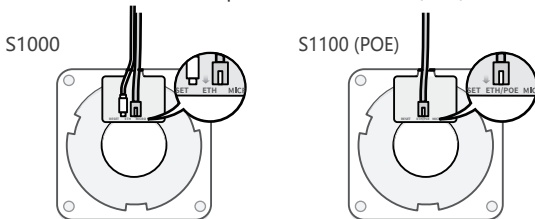

MOUNTING & INSTALLATION - cont.

- 4) Place S1000/1100 router at a slight angle against the mounting plate and twist into place (clockwise)

Wall Mount

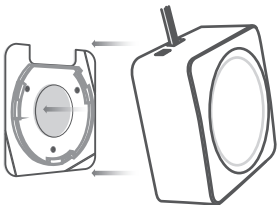

Ceiling Mount

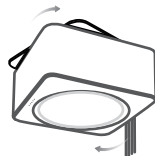
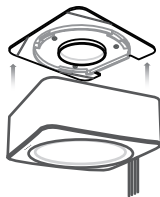

IMPORTANT: For best range results, we recommend mounting the S1000/1100 on the ceiling in an unobstructed location.

III. SETUP S1000/1100 BLUETOOTH ROUTER

- 1) The Cassia IoT Access Controller (AC) is the software used to easily setup and manage both your S1000/1100 and your Bluetooth low energy end devices
- 2) For instructions on accessing and using the AC, please go to the Cassia Networks website for the latest information:
<http://www.cassianetworks.com/enterprise/s1000-start>

IV. PRODUCT INTERFACE

Bluetooth (4.0, 4.1)

WiFi (802.11b/g/n, 2.4GHz only)

Ethernet (10/100 Base-T); PoE 48V power (802.3af/at for S1100 only)

Micro USB (2.0; DC 5V, 2.1A power)

USB (2.0; supports 3G/4G dongle)

LEDs (activity indicator) & Reset Button

V. ENVIRONMENTAL

Operating temperature: 0°C to 50°C (32°F to 122°F)

Humidity: 5% to 90% non-condensing

For additional assistance, please email: support@cassianetworks.com

Federal Communications Commission (FCC) Interference Statement

This equipment has been tested and found to comply with the limits for a Class B digital device, pursuant to part 15 of the FCC Rules. These limits are designed to provide reasonable protection against harmful interference in a residential installation. This equipment generates, uses and can radiate radio frequency energy and, if not installed and used in accordance with the instructions, may cause harmful interference to radio communications. However, there is no guarantee that interference will not occur in a particular installation. If this equipment does cause harmful interference to radio or television reception, which can be determined by turning the equipment off and on, the user is encouraged to try to correct the interference by one or more of the following measures:

- Reorient or relocate the receiving antenna.
- Increase the separation between the equipment and receiver.
- Connect the equipment into an outlet on a circuit different from that to which the receiver is connected.
- Consult the dealer or an experienced radio/TV technician for help.

Note: Any changes or modifications not expressly approved by the party responsible for compliance could void the user's authority to operate the equipment.

For additional information, please go to: <http://www.cassianetworks.com>



Routeur Bluetooth CASSIA S1000 / S1100

GUIDE DE DÉMARRAGE RAPIDE

© Cassia Networks, Inc. Cassia Networks et le logo
Cassia Networks sont des marques déposées de Cassia Networks, Inc.

DÉMARRER - FRANÇAIS

I. INCLUS DANS L'EMBALLAGE

(1) Routeur S1000 / S1100



(1) Câble d'alimentation Micro USB

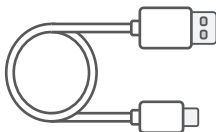

(1) Fiche d'alimentation USB

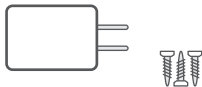

(3) Vis de fixation

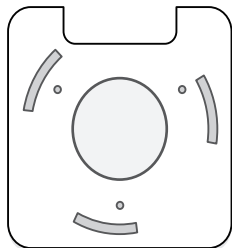

(1) Plaque de fixation



(1) Guide de démarrage rapide

II. MONTAGE ET INSTALLATION

- 1) Placer le S1000/1100 sur une surface plane et dégagée ou l'assembler à l'aide du kit de montage fourni en position horizontale
- 2) En cas de montage, visser d'abord la première plaque de fixation dans le mur ou le plafond

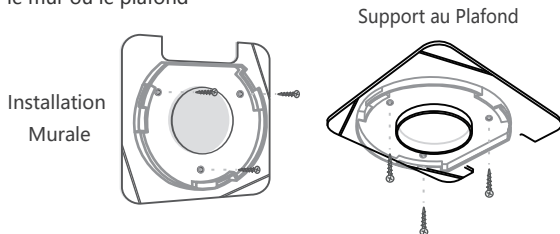

- 3) Ensuite, brancher le S1000 avec le câble micro USB et l'adaptateur secteur fournis et le relier à un point d'accès WiFi via Ethernet ou WiFi (2,4 GHz uniquement). Le S1100 peut également se connecter via la connexion Power-over-Ethernet (POE).

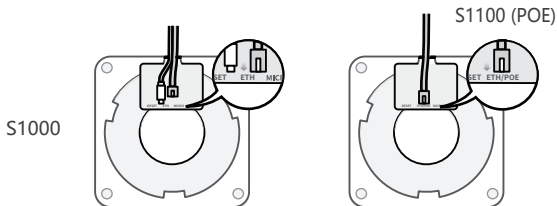

MONTAGE ET INSTALLATION - suite

- 4) Positionner le routeur S1000/1100 légèrement en biais contre la plaque de fixation et faire tourner en place (sens des aiguilles d'une montre)

Installation Murale

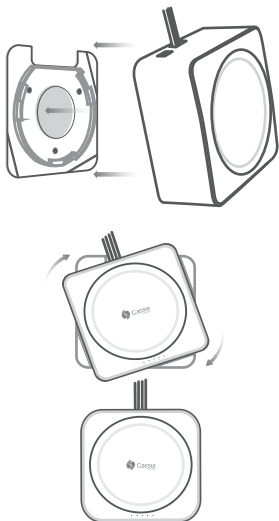

Support au Plafond

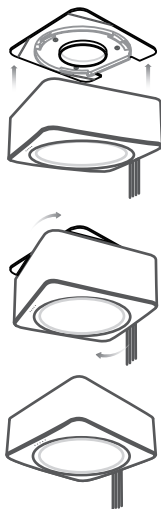

IMPORTANT: Pour obtenir la meilleure portée possible, nous vous recommandons d'installer le S1000 / 1100 au plafond dans un endroit non obstrué.

III. CONFIGURATION DU ROUTEUR BLUETOOTH X1000

- 1) Le IoT Access Controller (AC) de Cassia est le logiciel utilisé pour configurer et gérer facilement vos appareils terminaux à faible énergie S1000 / 1100 et Bluetooth
- 2) Pour savoir comment obtenir et utiliser le logiciel AC, veuillez consulter le site Web de Cassia Networks pour obtenir les dernières informations:
<http://www.cassianetworks.com/enterprise/s1000-start>

IV. INTERFACE PRODUIT

Bluetooth (4.0, 4.1)

WiFi (802.11b/g/n, 2.4GHz uniquement)

Ethernet (10/100 Base-T; PoE 48V - 802.3af/at pour S1100 seulement)

Micro USB (2,0; DC 5V, 2.1A puissance)

USB (2.0; Prend en charge 3G / 4G dongle)

LEDs (indicateur d'activité) & Bouton de Réinitialization

V. ENVIRONNEMENT

Température de fonctionnement: 0°C à 50°C (32°F à 122°F)

Humidité: 5% à 90% sans condensation

Pour obtenir de l'aide supplémentaire, envoyez un courriel à support@cassianetworks.com

IC Radiation Exposure Statement for Canada

This device complies with Industry Canada licence-exempt RSS standard(s). Operation is subject to the following two conditions: (1) this device may not cause interference, and (2) this device must accept any interference, including interference that may cause undesired operation of the device.

Le présent appareil est conforme aux CNR d'Industrie Canada applicables aux appareils radio exempts de licence. L'exploitation est autorisée aux deux conditions suivantes : (1) l'appareil ne doit pas produire de brouillage, et (2) l'utilisateur de l'appareil doit accepter tout brouillage radioélectrique subi, même si le brouillage est susceptible d'en compromettre le fonctionnement.

Pour obtenir de l'aide supplémentaire, rendez-vous sur:

<http://www.cassianetworks.com>

Beijing Cassia Networks Technology Co., Ltd.

RF exposure warning

This equipment must be installed and operated in accordance with provided instructions and the antenna(s) used for this transmitter must be installed to provide a separation distance of at least 20 cm from all persons and must not be co-located or operating in conjunction with any other antenna or transmitter. End-users and installers must be provided with antenna installation instructions and transmitter operating conditions for satisfying RF exposure compliance.

EU Regulatory Conformance

Cassia Networks Inc., hereby declares that Cassia S1000/S1100 Series Bluetooth Router are in compliance with directives listed below:

EMC Directive 2014

Low Voltage Directive 2014

R&TTE Directive 1999

REACH Regulation (EC) No.: 1907/2006

RoHS Directive 2011

WEEE Directive 2012

A Declaration of Conformity for these directives is available for viewing at

<http://www.cassianetworks.com>.

Beijing Cassia Networks Technology Co., Ltd.

