

SMART-PIN MANUAL

GOLF BUDDY®
ACCURACY MATTERS™

PATENTS : SEE GOLFBUDDY.COM/PATENT

1.HW SPEC



HW SPEC	
MCU	STM BLE+MCU Flash 1M Byte
GPS	UBLOX M8230/GPS, QZSS, GLONASS/SBAS
ANT	KSCA-F2650MS619A – Flexible PCB Ant
Battery	Li-ion - 21700/5000mAh/Samsung Cell X 4EA
Key	Function Key, Reset Key
Type C USB	F/W UP, Serial Log, Charge
Sensor	G-sensor
ETC	

2. Specifications

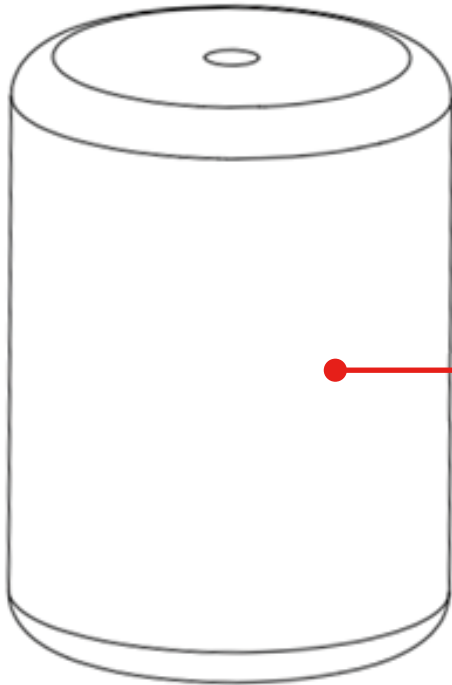

SMART PIN

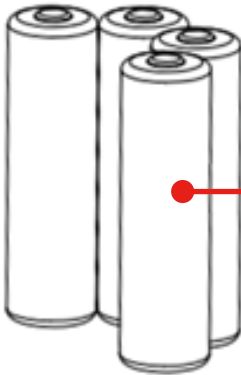

BATTERY

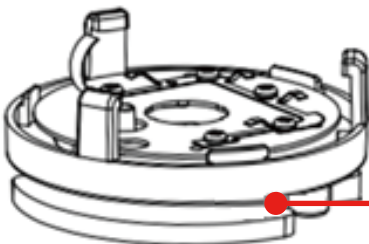

BATTERY
COVER

3. How to works

- A. Open the USB cover and press the reset button for 3 seconds.

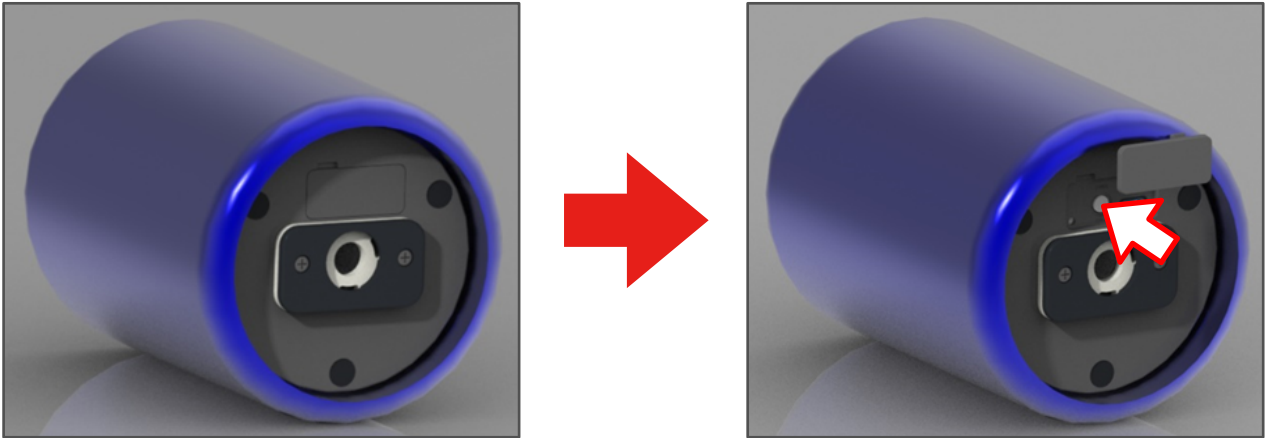

4. How to charge

- A. Open the USB cover and connect the USB cable to the USB Connector.

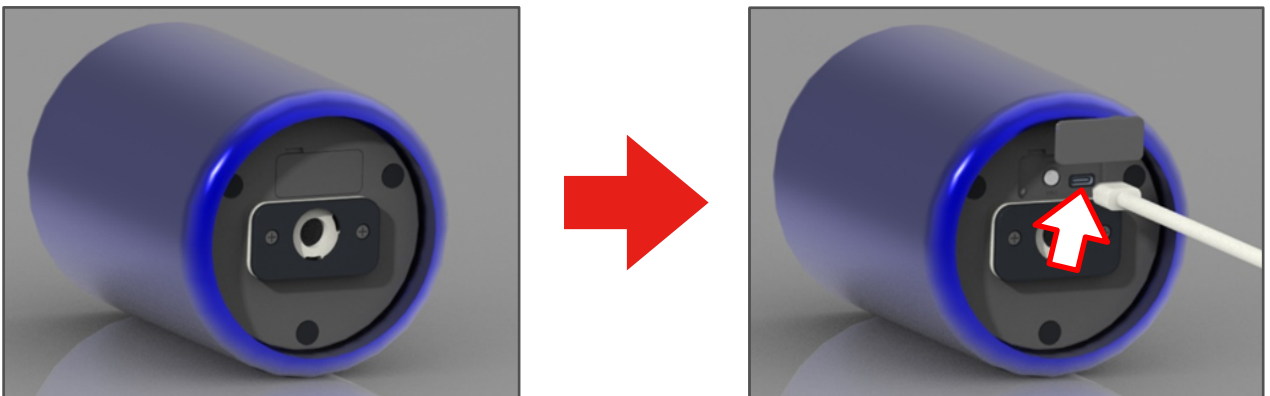

5. Operational description

- After the product is installed on the pin, press reset to start operation. After acquiring the GPS coordinates of the current location, ADVERTISE the current location information through BLE.
- The ADVERTISE signal is received from our brand's product and displays the position of the pin to help the game during PLAY.

How to Obtain Warranty Service or Other Information

USA	Toll-free : 888-251-6058 / Fax : 888-441-5237 Email : support@golfbuddyglobal.com Address : 10700 Norwalk Blvd. Santa Fe Springs, CA 90670, U.S.A. (USA Office) Website : www.golfbuddyamerica.com
-----	--

※ If you have any inquiry regarding warranty service, please contact to the shop where you purchased the product

Name of Company : GolfzonDeca Inc.

Product Name : SMART PIN

Model : LP-SMART PIN

FCC ID : 2ALG4LPSMARTPIN

This device complies with part 15 of the FCC Rules. Operation is subject to the following two conditions: (1) This device may not cause harmful interference, and (2) this device must accept any interference received, including interference that may cause undesired operation.

FCC Part 15.19

This device complies with part 15 of the FCC Rules. Operation is subject to the following two conditions: (1) This device may not cause harmful interference, and (2) this device must accept any interference received, including interference that may cause undesired operation.

FCC Part 15.21

Any changes or modifications (including the antennas) to this device that are not expressly approved by the manufacturer may void the user's authority to operate the equipment.

FCC RF Radiation Exposure Statement: This equipment complies with FCC RF Radiation exposure limits set forth for an uncontrolled environment.

This device and its antenna must not be co-located or operating in conjunction with any other antenna or transmitter. This equipment should be installed and operated with a minimum distance of 20 cm between the radiator and your body.

GOLF BUDDY®

GOLFZON DECA

