

# AIMH10

User Manual  
Golf Rangefinder  
GOLFBUDDY

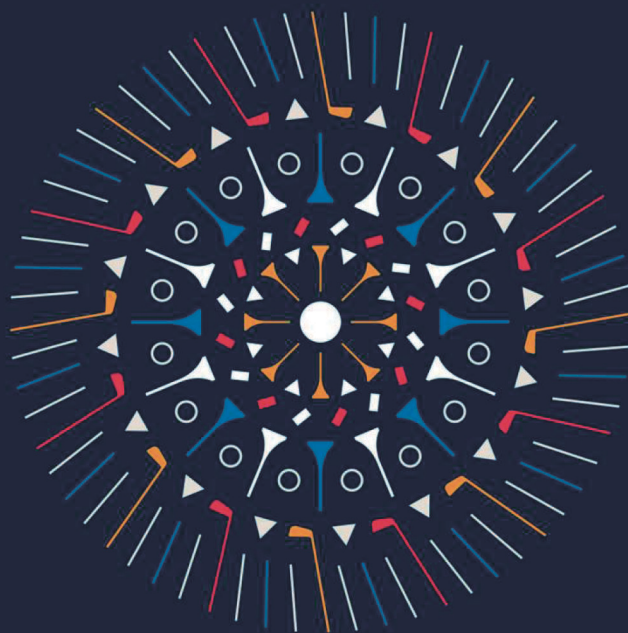



# Overview

## 1. PACKAGE INCLUDES



AIMH10



USB Cable (Micro 5pin)

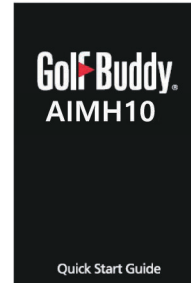

Quick Start Guide

## 2. OVERVIEW



Power Button

Touch Screen

Voice Button

Speaker

USB Port

- Power Button : Turn on/off the device, activate backlight, Lock or unlock the screen
- Touch Screen : Swipe or tap to select menus and functions  
Tap to turn on the backlight
- Voice Button : Hear the voice feature and return the previous screen in the setting menu

## 3. SCREEN DESCRIPTION

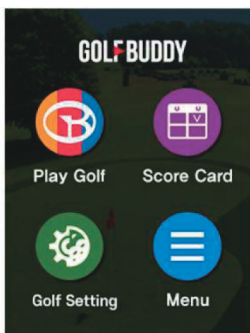

[Main Menu]

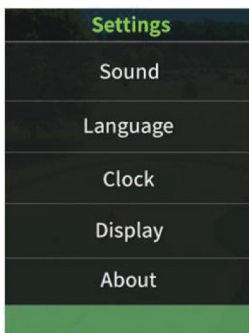

[Settings]

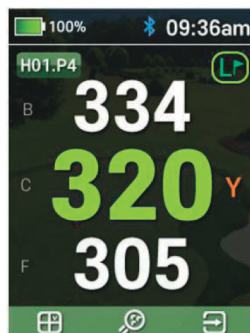

[Front/Center/Back]

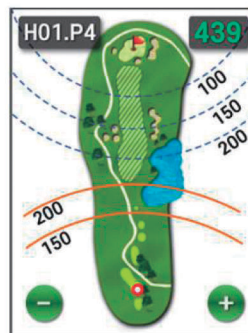

[Hole View]



[Green View]



[Hazards]

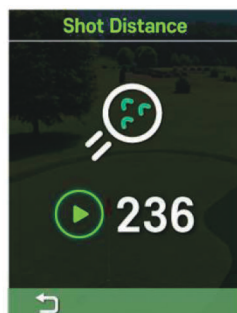

[Shot Distance]

HOLE	PAR	STROKE	PUTT
H1	3	5	2
H2	4	4	1
H3	3	5	2
H4	5	6	1
H5	4	4	1
Total: 26(+4)			

[Scorecard]

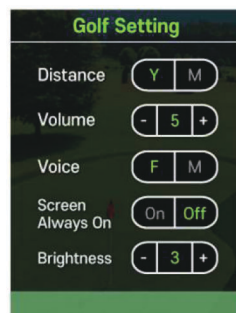

[Golf Settings]

# Golf Play

## 4. PLAY GOLF OVERVIEW



- Tap the 'Play Golf' icon in the 'Main Menu', and the H10 will automatically search for the golf course.
- ※ GPS sync can take up to 2 minutes, if the signal is too weak follow the instructions on the screen

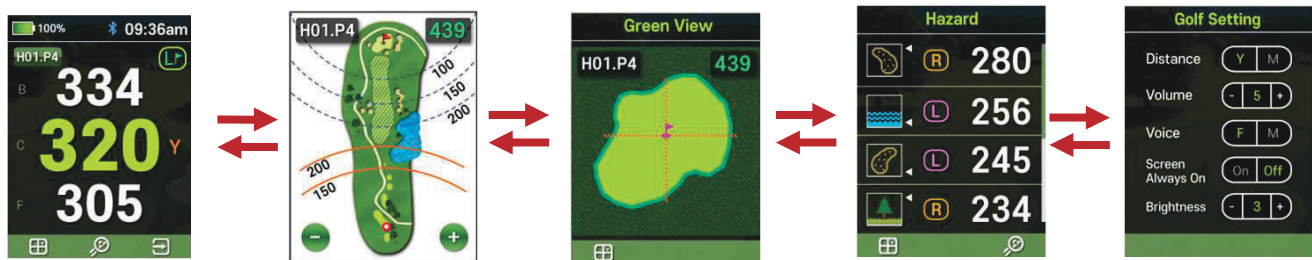

- Swipe from right to left to navigate to the following features Hole View, Green View, Hazards, Golf Settings. Swipe from left to right to return to the previous feature

### ► Front / Center / Back Screen Overview

Hole Number and Par Info — H01.P4

Distance to the back of the Green — B 334

Distance to the center of the Green — C 320 Y

Distance to the front of the Green — F 305

Scorecard feature — [Grid Icon]

Shot Distance — [Target Icon]

Left(L), Right(R) Green. L or R will appear next to the hole if available — L R

Unit (Yard / Meter) — Y

Exit / Finish Play Golf — [Exit Icon]

### ► Hole Overview

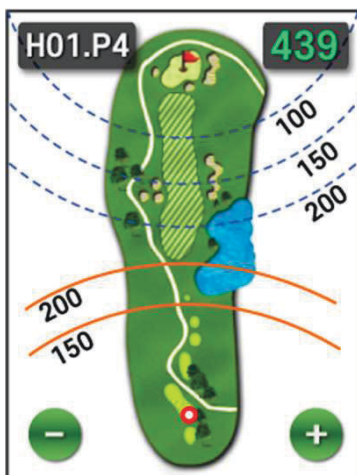

- Red Dot : Current Golfers position
- Red Arc : Distances from the Golfers position
- Blue dotted Arc : Distances from the Center of the Green
- +/- : Zoom In or Out

# Golf Play

## ▶ Green View and Pin Placement

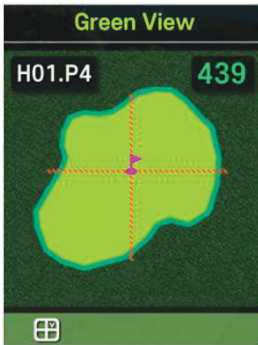

- You will see the shape of the green
- Touch the screen for 2 seconds to activate the Pin Placement feature → Move the Pin to any place on the Green and the Center distance reading will adjust accordingly

## ▶ Hazards

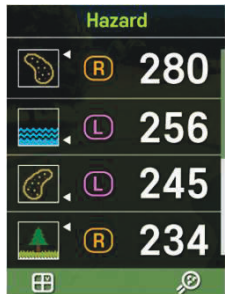

- Hazard distances from the Golfers position (farthest to closest)
- Hazards Icon Definitions



Tree



Bunkers



Out of Bounds



Water

## ▶ Golf Settings

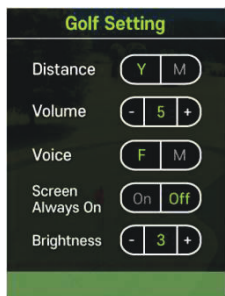

- In the Golf Setting Screen, you are able to set your preferred options while playing your round.
  - Distance, Volume level, Voice type, Screen Always On/Off, Brightness level

## ▶ Voice



Voice Button

- Press the 'Voice Button' once for Center of the Green, press and hold for distances to the Front and Back of the Green.
- ※ Supported Languages: English, Spanish, Korean, Chinese, Japanese, French, German, and Italian

## ▶ Scorecard



Golfzon County				
HOLE	PAR	STROKE	PUTT	
H1	3	5	2	
H2	4	4	1	
H3	3	5	2	
H4	5	6	1	
H5	4	4	1	
Total:		26(+4)		

4H Par5 Hcp9		
SCORE	PUTT	
Birdie	4	1
Par	5	2
Bogey	6	3
2x Bogey	7	4
3x Bogey	8	5
Total:		26(+4)

- Touch the Scorecard icon → choose the hole number → scroll up or down to enter your strokes → touch the ↺ icon to return
- ※ The score will be saved and can be viewed or modified later in the Main Menu under Score Card

# Golf Play

## ▶ Manual Hole Selection

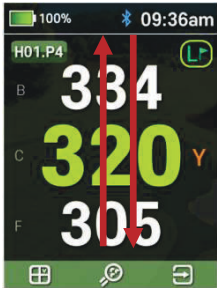

- You can change Holes by swiping the screen from top/bottom to the next Hole or swipe from bottom/top to previous Hole

dd.

## ▶ Changing Left / Right Green

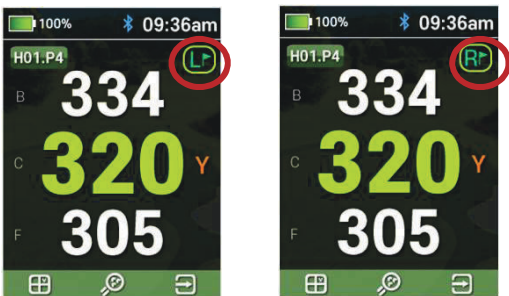

- The Hole distances adjusts completely when changing Greens  
→ Left / Right Green switch

## ▶ Shot Distance

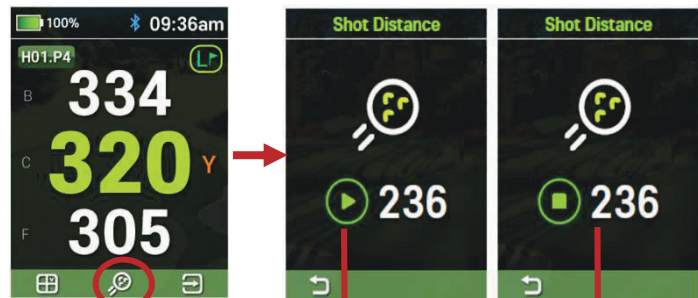

Shot Distance Icon 'Start' measuring the shot distance 'Stop' measuring and read the distance

- Tap 'Shot Distance' Icon → Tap '▶' button to measure shot distance → Tap '■' button to finish measuring and view your shot distance.

## ▶ Bluetooth

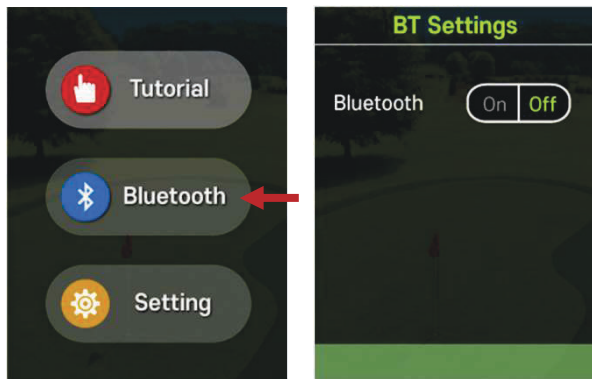

- 'Main Menu' → 'Bluetooth On/Off' to pair the H10 with your mobile device.
- ※ Turn on the Bluetooth on your mobile device to pair the AIM H10

[Bluetooth Pairing]

1. Start the GOLFBUDDY App. from your mobile device
2. Login and press 'Find My GOLFBUDDY' from the menu
3. Select AIM H10 from the menu to complete pairing

## ▶ Casting

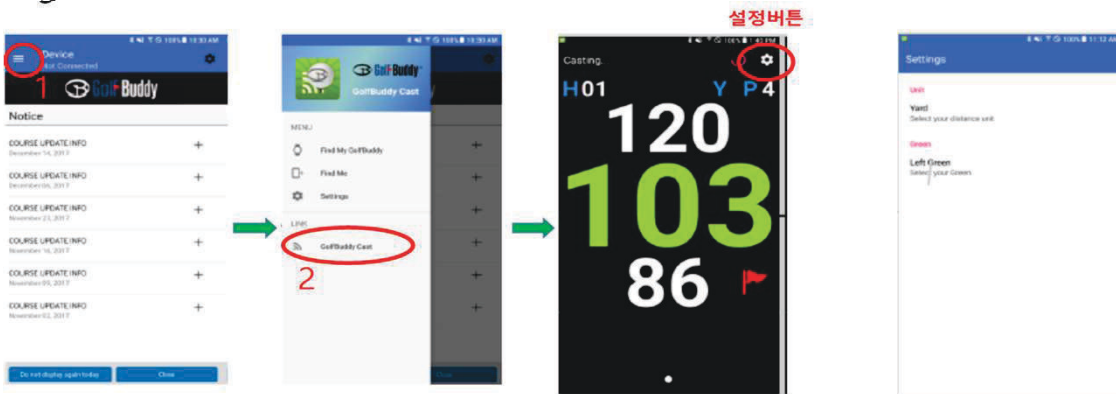

캐스팅 화면

캐스팅 설정화면

1. Download the GOLFBUDDY App in the Apple or Google Play store for free
2. Start GOLFBUDDY Smart App when AIM H10 is paired with your mobile device
3. Press 'GOLFBUDDY Cast' from the menu
4. Your mobile screen will show "casted" information from the H10

# Trouble and Update

## 5. Troubleshoot

If you experience incorrect distance readings or glitches, you can reset the H10 to "factory default", by using the "RESET" feature in "General Settings".

## 6. Software and Course Updates

Use GolfBuddy GB Manager to gain access to the latest firmware and free course updates for 40,000+ golf courses in 170+ countries

Visit our website at [www.golfbuddy.com](http://www.golfbuddy.com) for more information on downloading the GB course Manager to access the latest firmware & course updates

## 7. Disclaimer

- Please remove all the stickers before using.
- The H10 is water resistant and not water proof. Keep the device away from water or high humidity. Any defects caused by improper use might void the warranty.
- Functions will be limited in indoor due to lack of satellite reception
- Reset the unit, when you experience abnormal behavior or distance readings
- Use of 5V/2A adapter is recommended.
- Charging and storing the unit at extreme temperatures (-40° to 140° F, -40° C to 60° C) will harm the unit and void the warranty
- Date and time settings will be reset, when the battery is depleted and will have to be set again, once fully charged.

※ Images on the manual may change after software update.

## -LIMITED WARRANTY-

### Warranty Period

GOLFBUDDY products come with a limited warranty against defects in materials and workmanship when used under normal consumer use for a period of one (2) year ("Limited Warranty"). The Limited Warranty begins to run from the date of original retail purchase. GOLFBUDDY, at its sole and absolute discretion, shall either (i) replace or repair the defective part(s) or the unit with a new or reconditioned part(s), or (ii) issue a credit for the parts or products that are covered under the Limited Warranty.

### Eligibility

This Limited Warranty is applicable only to the original authorized purchasers who purchase the products for resale and/or end users of the products. All authorized distributors shall provide its customers a copy of this Limited Warranty and communicate any and all waivers and limitations contained in this Limited Warranty. No unauthorized modifications to or unauthorized representations made by distributors will be valid or honored. The purchaser must present the original purchase receipt showing the date of purchase, place of purchase, and amount paid for the product in question, at the time a warranty claim is filed. The product must be in its original packaging along with all associated accessories and instruction manuals.

### Warranty Claim Procedures

To obtain warranty repair service, you must contact GOLFBUDDY technical support at [support@golfbuddyglobal.com](mailto:support@golfbuddyglobal.com) and obtain a Return Authorization Number. All returned products must be accompanied by an original purchase receipt and the Return Authorization Number. Any products that are returned without the requisite information shall be returned at the purchaser's cost and expense.

### Warranty Exclusions

Except against defects in material and workmanship and as expressly warranted by GOLFBUDDY, GOLFBUDDY Disclaims all warranties, express and implied, applicable to products, including, without limitation, any warranty of merchantability or fitness for a particular purpose and any warranty that any products is delivered free of claims of third parties by way of infringement or the like. GOLFBUDDY disclaims all express and implied warranties applicable To products accessories and products which are not manufactured by GOLFBUDDY. GOLFBUDDY further disclaims all warranties applicable to products which are accepted by purchaser but are subsequently damaged as a result of the following events:

- » Product purchased through the internet, other e-commerce channels, or any distributor or retailer that obtained the Product from a supplier or distributor not authorized by GOLFBUDDY.
- » Any and all loss or damage to the product during transit.
- » Improper or non-recommended use, storage or handling of the product, use of product with non-GOLFBUDDY components such as USB cables or charges, misuse, operation at settings other than those recommended or specified, non-compliance with instructions or guidelines set forth in the User's Operation Manual.
- » Modification or alteration of the Product in any manner, including but not limited to, removal or addition of any component or part by purchaser or unauthorized service provider, or any accidental or intentional damage to the product.
- » Any loss of software, firmware, data information, memory data contained on any products returned to GOLFBUDDY for repair, or those modifications necessary due to a change in the GPS made by the U.S. government or any other governmental agencies.
- » Use of product in contravention with the laws of any country.

### Limitation of Warranty

GOLFBUDDY SHALL NOT IN ANY EVENT BE LIABLE FOR INDIRECT, SPECIAL, CONSEQUENTIAL OR LIQUIDATED DAMAGES OR PENALTIES, INCLUDING CLAIMS FOR LOST REVENUE, PROFITS OR BUSINESS OPPORTUNITIES, EVEN IF GOLFBUDDY HAD OR SHOULD HAVE HAD ANY KNOWLEDGE, ACTUAL OR CONSTRUCTIVE, OF THE POSSIBILITY OF SUCH DAMAGES. GOLFBUDDY'S TOTAL LIABILITY FOR ANY CLAIM ARISING HEREUNDER SHALL NOT EXCEED THE PURCHASE PRICE WHICH PURCHASER PAID FOR THE PRODUCT.

### Motherboards

WARNING: Products with exposed solder may contains lead, a chemical known to the State of California to cause birth defects and other reproductive harm. Please wash hands after handling internal components and motherboards and avoid inhalation of fumes if heating the solder.



## How to Obtain Warranty Service or Other Information

<b>USA</b>	Deca International Corp. dba GolfBuddy 10700 Norwalk Blvd. Santa Fe Springs, CA 90670
------------	--

NOTE: This equipment has been tested and found to comply with the limits for a Class B digital device, pursuant to part 15 of the FCC Rules. These limits are designed to provide reasonable protection against harmful interference in a residential installation. This equipment generates uses and can radiate radio frequency energy and, if not installed and used in accordance with the instructions, may cause harmful interference to radio communications. However, there is no guarantee that interference will not occur in a particular installation. If this equipment does cause harmful interference to radio or television reception, which can be determined by turning the equipment off and on, the user is encouraged to try to correct the interference by one or more of the following measures:

- Reorient or relocate the receiving antenna.
- Increase the separation between the equipment and receiver.
- Connect the equipment into an outlet on a circuit different from that to which the receiver is connected.
- Consult the dealer or an experienced radio/TV technician for help

Changes or modifications not expressly approved by the party responsible for compliance could void the user's authority to operate the equipment.

This device complies with Part 15 of the FCC Rules. Operation is subject to the following two conditions: (1) this device may not cause harmful interference, and (2) this device must accept any interference received, including interference that may cause undesired operation.

**GOLFZON**  
**DECA**

