

User manual

Electric skateboard

M/N:H2

Specification

	Parameter
Mass of equipment	4kg
The fastest speed	15Km/h
Max Upslope Angle	15°
Battery	3.7V,150mA
Operation temperature	-10℃-40℃
Max weight	100kg
Charging time	2hours
Electric skateboard Size	712*220*140mm

Packaging

Electric skateboard	1 pcs
Remote control	1 pcs
User manual	1 pcs
Charger	1 pcs

The correct posture

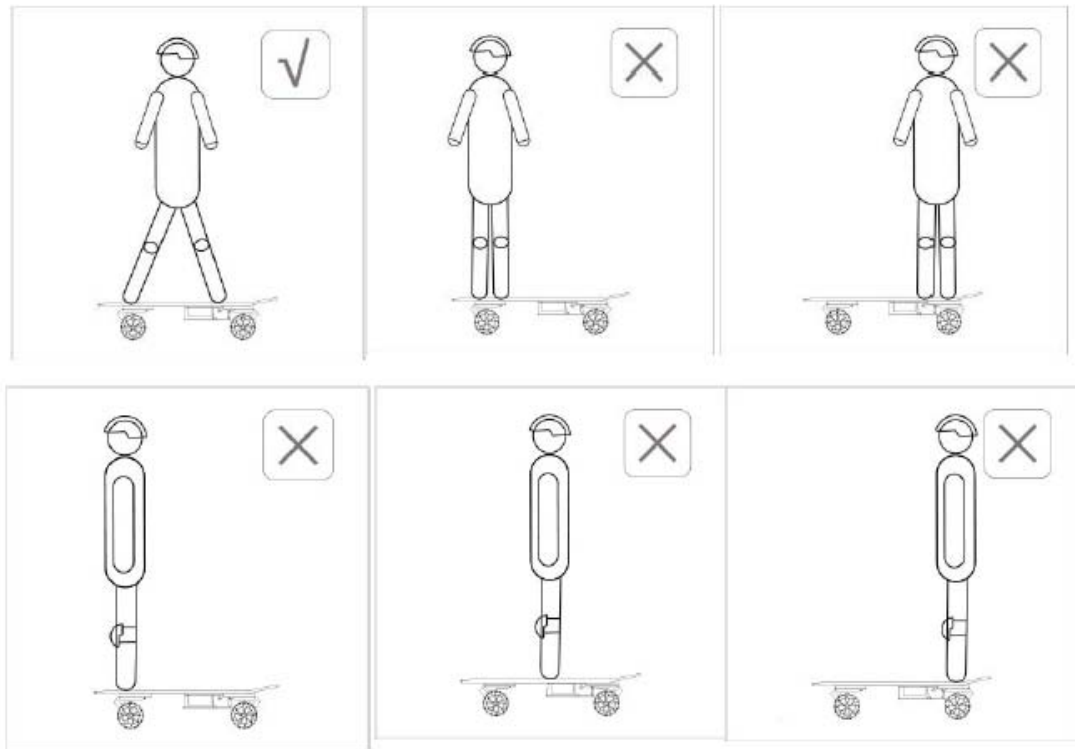

Remote control



Open the remote control power switch, remote control buzzer sound (small fish no beep). Dial the lever, then remote control led lights flash. If not, please follow the fault instructions;

Pair

Boot, and in 5S toggle a learning key, quickly press and hold the small light board to learn the button until the remote control LED from flash to become off, this time to promote the remote control to observe the controller board green LED is flashing at the same time, flashing on behalf of success.

FCC Statement

This device complies with part 15 of the FCC Rules. Operation is subject to the following two conditions:

(1) This device may not cause harmful interference, and (2) this device must accept any interference received, including interference that may cause undesired operation. Any Changes or modifications not expressly approved by the party responsible for compliance could void the user's authority to operate the equipment.

Note: This equipment has been tested and found to comply with the limits for a Class B digital device, pursuant to part 15 of the FCC Rules. These limits are designed to provide reasonable protection against harmful interference in a residential installation. This equipment generates uses and can radiate radio frequency energy and, if not installed and used in accordance with the instructions, may cause harmful interference to radio communications. However, there is no guarantee that interference will not occur in a particular installation. If this equipment does cause harmful interference to radio or television reception, equipment generates, uses and can radiate radio frequency energy and, if not installed and used in accordance with the instructions, may cause harmful interference to radio communications. However, there is no guarantee that interference will not occur in a particular installation. If this equipment does cause harmful interference to radio or television reception,

- Reorient or relocate the receiving antenna.
- Increase the separation between the equipment and receiver.
- Connect the equipment into an outlet on a circuit different from that to which the receiver is connected.
- Consult the dealer or an experienced radio/TV technician for help.

FCC RF Radiation Exposure Statement

The device has been evaluated to meet general RF exposure requirement. The device can be used in portable exposure condition without restriction.