

Selecting the Alarm Week Mode

Your SmartSet® clock radio allows you to select from three different alarm week modes for each alarm. The Alarm Week Modes are:

- **Everyday** - the alarm will turn on all 7 days
- **Weekdays only** - the alarm will only turn on Monday through Friday
- **Weekends only** - the alarm will only turn on Saturday and Sunday



To check the Alarm Week Mode setting for Alarm1, press briefly the **AL1** button. The display will show Alarm1's wake up time and the **DAY OF WEEK** indicators will show the Alarm Week Mode selected.

- If all 7 indicators are 'On', the Everyday mode is selected.
- If only the MON (Monday) through FRI (Friday) indicators are 'On', the Weekdays only mode is selected.
- If only the SAT (Saturday) and SUN (Sunday) indicators are 'On', the Weekends only mode is selected.

To change the Alarm Week Mode setting for Alarm1, press and hold the **AL1** button and press the **WEEK** button until the **DAY OF WEEK** indicators show the desired week mode: Everyday, Weekdays only, or Weekends only operation. Release the **AL1** button and the display will return to the current time.

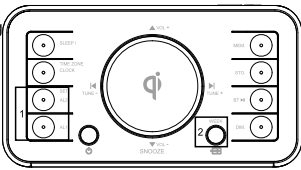

Follow the same procedure to select the desired Alarm Week Mode for Alarm2 if necessary.

Checking the Wake Up Time and Alarm Week Mode

To check the wake up time and the alarm week mode settings, press either the **AL1** or **AL2** button. The display will change from current time to wake up time and the **DAY OF WEEK** indicators will show you the Alarm Week Mode which is currently selected. Leave idle for 4 secs, it will restore to current time display.

Setting Alarm Volume for Wake-To-Radio and Wake-To-Buzzer Alarm Mode

- Press the **POWER** button to turn the unit On.
- Press the **SOURCE** button to select FM Radio mode.
- Tune in or recall your favorite station from Memory that you wish to hear when the alarm comes On.
- Press the **VOL +** or **VOL -** button to set the radio volume at which the alarm will reach gradually at wake up time, otherwise, the volume level right before the unit turned Off will be chosen by default.

Note: The alarm volume for Wake-To-Buzzer will be the volume level right before the unit turned Off.

Activating and Deactivating the Alarm

- Press the **AL1** or **AL2** button repeatedly to select your desired Alarm Mode: Wake to Radio, Wake to Buzzer, or Off.
- When the '1/2' indicator glows, the wake up to Radio alarm will be On.
- When the '1/2' indicator glows, the wake up to Buzzer alarm will be On.
- To completely turn Off the alarm, press the **AL1** or **AL2** button repeatedly until the Radio '1/2' indicator or the Buzzer '1/2' indicator is Off.

Snooze Alarm

When the alarm comes On, press the **SNOOZE** button to pause it for 9 minutes. Alarm indicator will flash during Snooze Alarm mode. To turn off Snooze Alarm, press either the **POWER**, **AL1**, or **AL2** button once.

Note: If not turned off, the Snooze Alarm will only be active for one hour. After Snooze Alarm turned Off, the alarm will come On again same time next day (depends on your Alarm Week Mode setting).

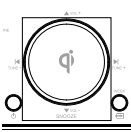

10 Listening to FM Radio

Turn On / Off Radio Mode

- Extend the power cord fully and orient it for better FM reception.
- Press the **POWER** button to turn the unit from Standby mode to On.
- Press the **SOURCE** button repeatedly until the **MHz** indicator turns 'On', and the FM station frequency displays.
- Set the VOLUME by pressing the **VOL +** or **VOL -** button to a level that suits your needs.
- When you finish listening to radio, press the **POWER** button to turn the radio Off. The **MHz** indicator will then turn 'Off'.

Note: Wireless charging can interfere FM reception. Please use wired USB charging while listening to radio when necessary.

Receive your desired station with the TUNING control:

- Press the **TUNE + / TUNE -** button briefly, the receiving frequency will increase / decrease by one step.
- Press and hold the **TUNE + / TUNE -** button for 3 seconds then release, Auto Station Seeking will be engaged, the receiving frequency will increase / decrease automatically until a station with acceptable reception is found.

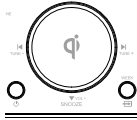

Storing and Recalling Radio Station Memory Manually

When you have a few favorite radio stations to listen to, you may like to save them in specific memory locations and pick one of them in a few seconds without the need of searching it each time. Our digital tuning technology allows you to do this easily by following the steps listed below:

Storing Station to the Memory

- Turn the unit On and select Radio mode (**MHz** indicator 'On').
- Tune in the desired station by the TUNING control as described.
- Press and hold the **STO.** button (for 2 seconds) until 'P XX' blinks, indicating the memory location to store the station currently tuned in.
- While 'P XX' is blinking, press the **TUNE +** or **TUNE -** button can change the memory location from 1 through 20. For example, 'P 03' means the current listening station is about to be stored into the 3rd location of the memory.
- After deciding the memory location, press the **STO.** button again, the currently listening station is then stored accordingly.
- The display will show the frequency of the station, and after a few seconds, it will restore the current time.

Recalling Station from the Memory

- Turn the unit On and select Radio mode.
- Press the **MEM.** button, 'P XX' shows on the display, and the station according to the memory location will then be tuned in.
- Repeatedly pressing the **MEM.** button or the **TUNE + / TUNE -** button will change the memory location from 1 through 20, and the station stored in the location will then be tuned in once the memory location is selected and all buttons released.
- The display will show the frequency of the station, and then returns to the current time after a few seconds.

11 Listening to Bluetooth Speaker

- Press the **POWER** button to turn the unit ON.
- Press the **SOURCE** button to select Bluetooth (bt) mode (BT indicator 'Flashes' for pairing).
- Enable your Bluetooth device and select **ER100202** from its Available/Paired device list. If pairing successful, the unit will prompt and **BT** indicator will become solid.
- Automatic connection with your Bluetooth devices is possible if they have been paired successfully with this unit before.
- After paired, you can play your music through this Bluetooth Speaker.
- Press briefly the **BT** button can pause or resume playback streaming over your Bluetooth device.

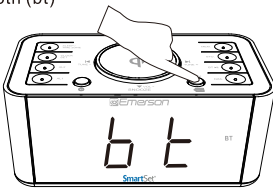

Note: If pairing unsuccessful, all previously paired Bluetooth devices around should be disconnected first by pressing and holding the **BT** button until it prompts, or Turn Off their Bluetooth connection, in order to avoid making any auto reconnection between them. Then, set this unit to Bluetooth mode, and tap the Bluetooth switch on your phone/device Off and back on again to refresh/search any nearby **ER100202** for pairing.

12 Enjoying Audio Sources via AUX IN Jack

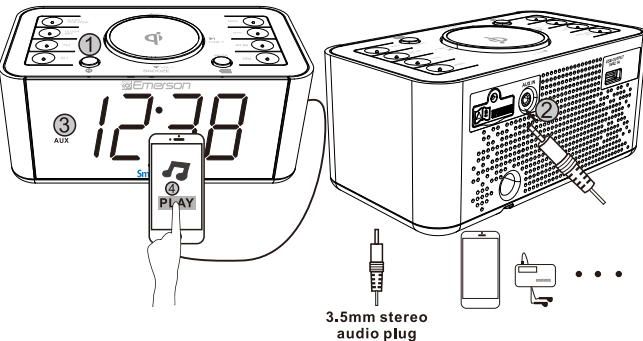

This clock radio is equipped with AUX IN jack for you to enjoy iPod, MP3 music player or other audio source.

- Connect your iPod, MP3 player or other audio source from its earphone jack to the AUX IN jack of this unit via an audio cable (not included) with both ends in 3.5mm stereo plug.
- AUX indicator will light on after you power on the unit and change to AUX mode by pressing the **SOURCE** button.
- Start to play iPod, MP3 music player or other audio player, and set the player volume to its maximum when necessary.
- Adjust the volume of this clock radio to meet your desired level as well.

Note: When alarm time comes, music playing through the AUX IN jack will be muted, and Wake-To-Music or Wake-To-Buzzer can only be heard according to your alarm setting.

13 Sleeping to Music Timer

Press the **POWER** button to turn ON the unit, and press the **SOURCE** button to select either Bluetooth, FM Radio or AUX mode to play music or listen to radio

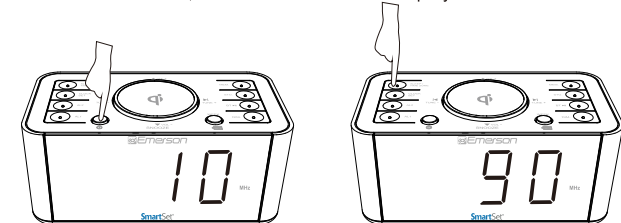

- Press the **SLEEP** button. The display will show the sleep timer.
- Press the **SLEEP** button repeatedly to choose your desired sleep timer (10-90 minutes or OFF).
- To display the sleep timer during count down process, press the **SLEEP** button.
- To cancel the sleep timer during count down process, press the **POWER** button to shut Off the unit.

14 Qi Wireless Charging

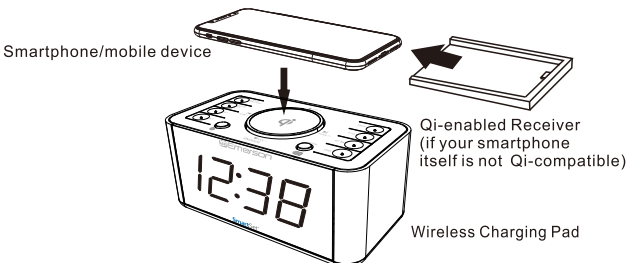

A Fast Wireless Charging Pad is built on top of this unit for wireless power transfer to any Qi-compatible smartphones or Qi-enabled receivers over a vertical distance of not more than 0.2 inches (5 mm).

- ① Place your Qi-compatible smartphone or receiver (only one set at a time) on top of the Wireless Charging Pad. The center of your smartphone or receiver must be positioned properly right at the middle of this charging pad in order to maximize the charging efficiency.
- ② While wireless charging started or detected, the indicator will be flashing 'Red' slowly.
- ③ To make sure wireless charging performs properly, check the charging icon and/or charging message displays on your smartphone.
- ④ While your smartphone is fully charged, the indicator will turn solid 'Green' (except for iPhones). Please also check the charging icon and/or charging message on your smartphone to ensure it is fully charged, then remove it from the wireless charging pad.

Note:

- This wireless charging pad works with Qi-compatible device including 7.5W iPhone XS Max/XS/XR/X/8 Plus/8, 10W Galaxy S10 Plus/S10E/S10/S9, and 5W all Qi-enabled phones.
- Wireless charging may not work properly if the protective case or accessory placed at the back of your smartphone is thicker than 0.2 inches (5 mm), remove the protective case or accessory before placing your smartphone (screen facing upward) on the wireless charging pad.
- Do not place any foreign objects, such as coins, keys, metallic objects, magnets, and magnetic stripe cards, between your smartphone and the wireless charger, to avoid interference or overheating. While wireless charging error occurred, the indicator will be flashing 'Red' rapidly to alert user to get the erroneous receiver removed.

15 USB for Charging

This clock radio has a USB port at the back, which can provide up to 5V 2.1A to charge devices like smartphone, tablet etc. via a USB cable (not provided).

Note: Electrical energy drawn from the USB port may vary due to different charging cable condition, battery characteristic or power management system of your device being charged.

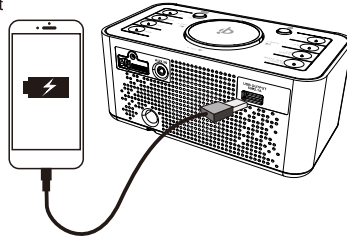

16 4-Level Dimmer Control

Press the **DIM.** button while in standby mode to select any of the four levels. It also can be adjusted when the Bluetooth, Radio or AUX is On.



17 Changing the Lithium Battery

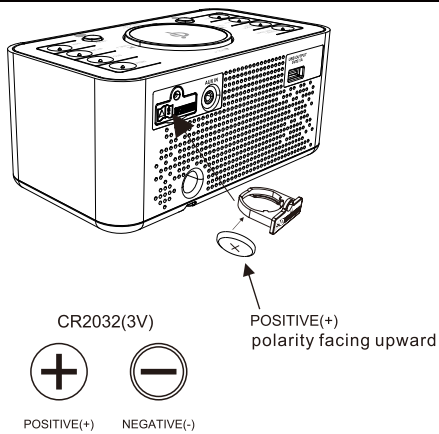

The lithium backup battery needs replacement when the LOW BATTERY indicator flashes, otherwise, the time and alarm settings will be lost/reset after a power outage.

- Leave the AC adapter connected to your AC outlet to retain memory while the original battery is removed.
- Unscrew the battery holder from the cabinet with a small screwdriver and insert a new battery with the same CR2032 or equivalent type into the holder the same way, observing the positive (+) polarity before sliding the holder back into the slot. The LOW BATTERY indicator should then be Off.

18 Care and Maintenance

Care Of Cabinets

If the cabinet becomes dusty, wipe it with a soft cloth. If the cabinet becomes smudged or dirty, clean it with a soft, slightly dampened cloth. Never allow water or any liquid to get inside the cabinet. Never use any abrasive cleaners or cleaning pads as these will damage the finish of your radio.

Lithium Battery Precautions

- Dispose of the old battery properly. Do not leave it lying around where a young child or pet could play with or swallow it. If the battery is swallowed, contact a physician immediately.
- The battery may explode if mistreated. Do not attempt to recharge it or disassemble it. Do not dispose of the old battery in a fire.

19 LIMITED WARRANTY

Emerson Radio Corp. warrants this product to be free from manufacturing defects in original material, including original parts, and workmanship under normal home use and conditions ("manufacturing defect") for a period of ninety (90) days from date of original purchase in, and if used in the United States. Should service be necessary under this warranty, Emerson will provide the following at our Return Repair Facility provided the manufacturing defect is verified along with the date of purchase:

* **Repair service for ninety (90) days from date of original purchase at no charge for labor and parts.**

To Receive Authorization to Return a Defective Item, please contact Emerson Customer Service at 1-800-898-9020 or at <http://www.emersonradio.com/service/return-policy>. Have your Model number, Serial Number and dated Proof of Purchase with you when you call.

In the event the product must be returned to Emerson:

- * Pack the unit in a well-padded heavy corrugated box. Please insure the item is well padded to avoid damage while in transit back to our facility. **If the item incurs damage, it will NOT be replaced and the consumer will be responsible for return freight costs to receive their same unit back.**
- * Enclose your check or money order payable to Emerson Radio in the amount of \$10 to cover return shipping and handling costs.
- * Enclose a note with your name, address, phone number, Return Authorization number and brief reason for returning the unit.
- * Enclose a copy of your proof of purchase (warranty service will not be provided without dated proof of purchase).
- * Ship the unit prepaid via UPS or parcel post (SHIP INSURED and obtain a tracking number).

NOTE This warranty does not cover:

- (a) Damage to equipment not properly connected to the product.
- (b) Cost incurred in the shipping of the product to and from Emerson's Return Facility.
- (c) Damage or improper operation of unit caused by customer abuse, misuse, negligence or failure to follow operating instructions (including cleaning instructions) provided with the product.
- (d) Ordinary adjustments to the product which can be performed by customer as outlined in the owner's manual.
- (e) Signal reception problems caused by external antenna or cable systems.
- (f) Products not purchased in the United States.
- (g) Damage to product if used outside the United States.

THIS WARRANTY IS NON-TRANSFERABLE AND APPLIES ONLY TO THE ORIGINAL PURCHASER AND DOES NOT EXTEND TO SUBSEQUENT OWNERS OF THE PRODUCT. ANY APPLICABLE IMPLIED WARRANTIES, INCLUDING THE WARRANTY OF MERCHANTABILITY, ARE LIMITED IN DURATION TO A PERIOD OF THE EXPRESSED WARRANTY AS PROVIDED HEREIN BEGINNING WITH THE DATE OF ORIGINAL PURCHASE AT RETAIL AND NO WARRANTIES, WHETHER EXPRESSED OR IMPLIED, SHALL APPLY TO THE PRODUCT THEREAFTER. EMERSON MAKES NO WARRANTY AS TO THE FITNESS OF THE PRODUCT FOR ANY PARTICULAR PURPOSE OR USE. THE EXTENT OF EMERSON RADIO CORP'S LIABILITY UNDER THIS LIMITED WARRANTY IS THE REPAIR OR REPLACEMENT PROVIDED ABOVE AND, IN NO EVENT, SHALL EMERSON RADIO CORP'S LIABILITY EXCEED THE PURCHASE PRICE PAID BY THE PURCHASER OF THE PRODUCT. UNDER NO CIRCUMSTANCES SHALL EMERSON RADIO CORP. BE LIABLE FOR ANY LOSS, DIRECT, INDIRECT, INCIDENTAL, SPECIAL, OR CONSEQUENTIAL DAMAGE ARISING OUT OF OR IN CONNECTION WITH THE USE OF THIS PRODUCT. THIS WARRANTY IS VALID ONLY IN THE UNITED STATES OF AMERICA. THIS WARRANTY GIVES YOU SPECIFIC LEGAL RIGHTS. HOWEVER, YOU MAY HAVE OTHER RIGHTS WHICH MAY VARY FROM STATE TO STATE. SOME STATES DO NOT ALLOW LIMITATIONS ON IMPLIED WARRANTIES OR EXCLUSION OF CONSEQUENTIAL DAMAGE, THEREFORE THESE RESTRICTIONS MAY NOT APPLY TO YOU.

10-90-1402A

The serial number can be found on the back cabinet. We suggest that you record the serial number of your unit in the space below for future reference

Model Number: ER100202

Serial Number: _____

Emerson

----- SERVICE -----

FOR ADDITIONAL SET-UP OR OPERATING ASSISTANCE
PLEASE CALL:
1-800-898-9020

FOR CUSTOMER SERVICE, PLEASE E-MAIL TO:
internet@emersonradio.com

OR WRITE TO:
Emerson Radio Corp.
Consumer Affairs Dept.
35 Waterview Blvd
Parsippany, NJ 07054