

Model No:OfficeCore M2, OfficeCore M2 Record, OfficeCore M2 Lite,
OfficeCore M220 Lite
FCC ID:2ALCN-EMTM2
IC:23496-EMTM2



eMeet OfficeCore 系列/シリーズ/Seite

智能会议宝

無線ハンズフリー電話
Smart Conference Speaker

—
用户说明书/User Manual

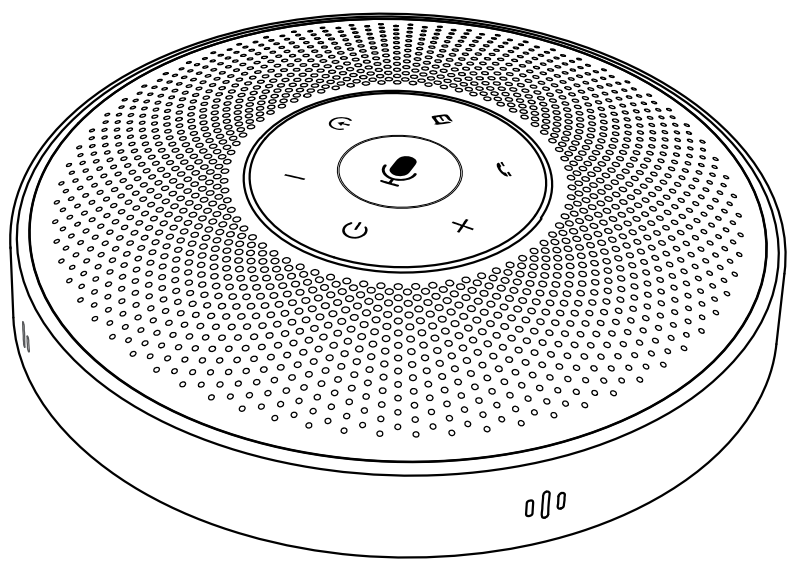

PMN: eMeet M2

English

Packaging contents

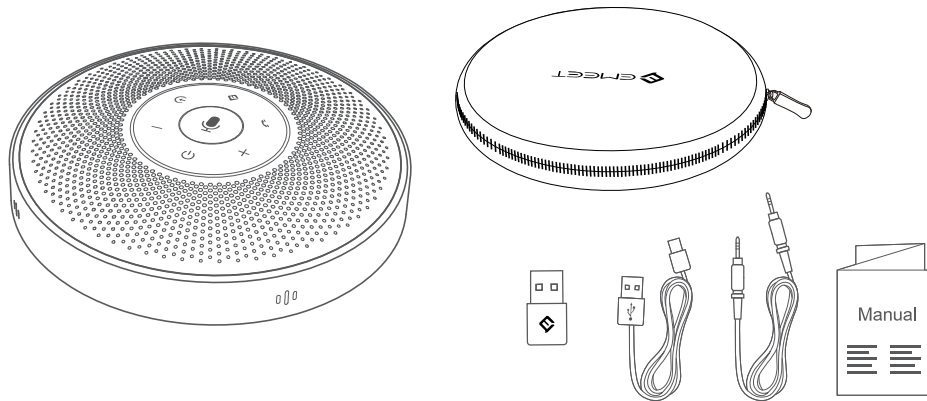

Product description

The eMeet OfficeCore series smart wireless speakerphone allows sending and receiving audio during talk time. Connection of OfficeCore products to PC, phone or tablet PC via Bluetooth, USB or AUX (analog audio) is available. The OfficeCore series products include a small portable omnidirectional microphone speaker with high-quality connection for far-field, 360-degree sound recognition and pick-up.

Function display

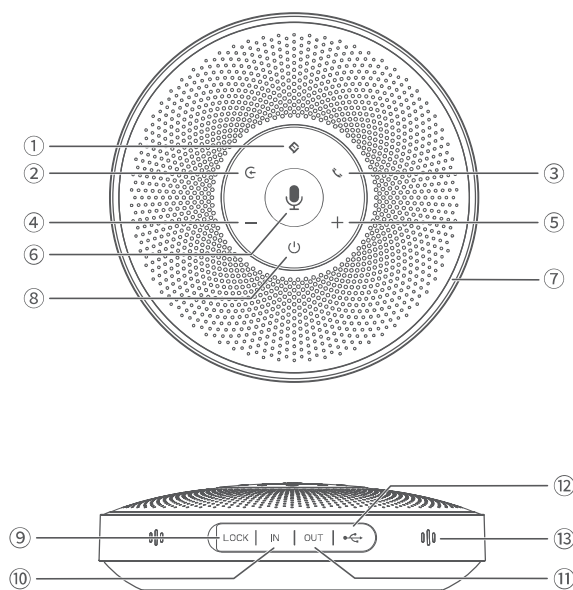

- ① AI noise reduction on/off button
- ② Input source
- ③ Answer/end button
- ④ Volume down
- ⑤ Volume up
- ⑥ Mute button
- ⑦ Status light
- ⑧ On/off
- ⑨ Lock
- ⑩ AUX audio input port
- ⑪ Earphone audio output port
- ⑫ USB port
- ⑬ Microphone

How to use

1、 On/off



Long press On/Off “  ” for 2 seconds to turn on or off.

2. Three operating modes.



2.1 The first mode: connect the computer to eMeet OfficeCore product with a USB cable

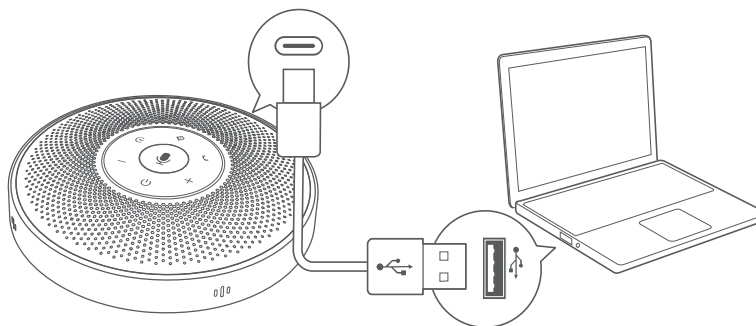

2.2 The second mode: connect eMeet OfficeCore product via Bluetooth

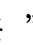

- ① Press the “  ” for two seconds. The status light is blue when pairing
- ② Turn on Bluetooth on mobile phone or PC and select eMeet OfficeCore product from the list of devices

- Different models have different Bluetooth names:

	Prout name	Bluetooth name
①	eMeet OfficeCore M2	eMeet M2
②	eMeet OfficeCore M2ce	eMeet M2ce

2.3 The third mode: connect eMeet OfficeCore product with AUX analog audio wire

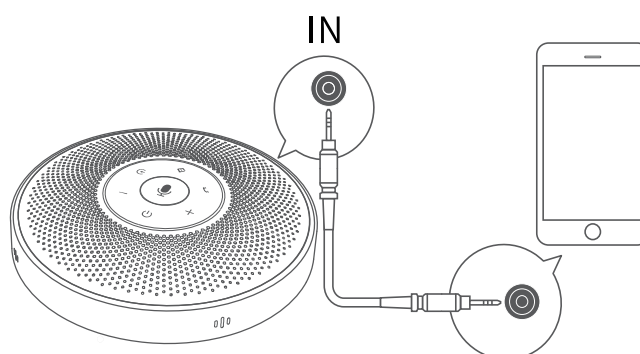

2.4 When multiple sound sources are input simultaneously, select the required source by pressing the “ ← ” button.



- ① The blue light shows switch to Bluetooth status
- ② The white light shows switch to AUX status
- ③ The green light shows switch to USB status

3. Answer/ end the call



- ① When there is an incoming call, press the “ 📞 ” button to answer the call
- ② In the talk mode, press the “ 📞 ” button to end the call

4. AI noise reduction on/off



Short press “ 📏 ” AI Noise Reduction button to enable/disable AI noise function. Turning on VoicelA noise reduction can greatly reduce some noises in the meeting scene, such as from keyboard tapping, air conditioning noise, and general unwanted background noise

Note: After the noise reduction mode is enabled, in order to maintain good sound pickup effect, please make a call within a sound pickup range of 1.5 meters.

5. Control volume

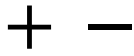

Press the volume “ + ” , volume “ - ” to increase or decrease the volume.

6. Charge eMeet OfficeCore product

6.1 Via the computer

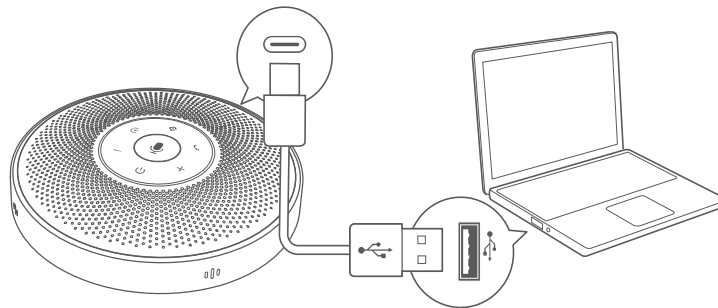

6.2 Through the adapter

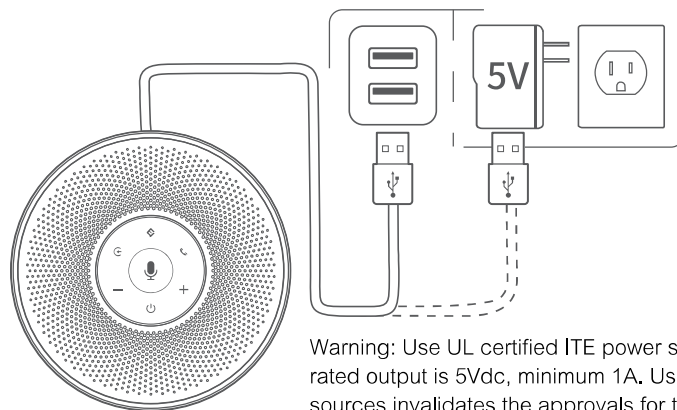

Warning: Use UL certified ITE power supply only, the rated output is 5Vdc, minimum 1A. Using other power sources invalidates the approvals for this device and triggers potential danger.

7. Check the battery



Short press “  ” to check the current residual capacity of eMeet OfficeCore product. The percentage of the green light represents

When the battery is low, the ring light will be red with a low battery beep (once every 5 minutes) till the power is exhausted and the device automatically shuts down.

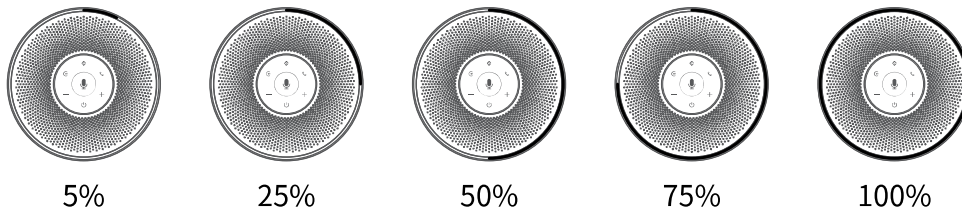

8. External speaker \ headset

8.1 External speaker: connect the speaker to the AUX OUT port of eMeet Office-Core product with audio wire. The sound will be played through the speaker to volume up.

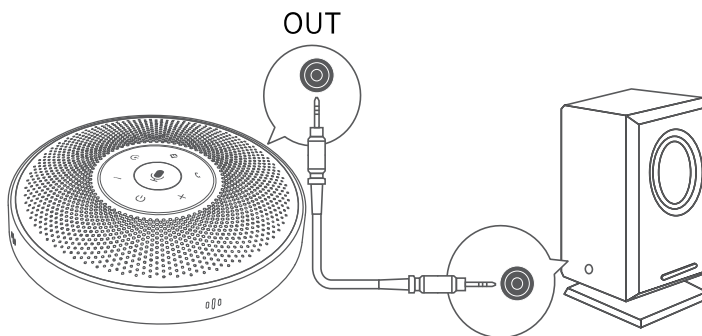

8.2 External headset: connect the headset to the AUX OUT port of eMeet Office-Core product. The sound will be played through the headset.

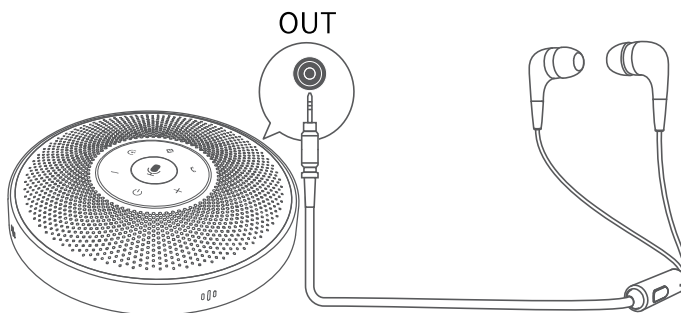

9. Bluetooth wireless adaptation

- ① Plug Bluetooth wireless adapter into computer, turn on eMeet OfficeCore product and enter pairing.
- ② The Bluetooth wireless adapter will be automatically connected to eMeet OfficeCore product.

For more information, please visit www.emmeet.ai/support

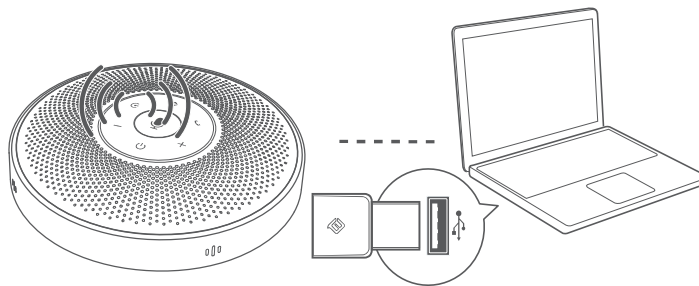

Notes

- ① Do not place the battery in direct sunlight or fire exposure places.
- ② Note: If the battery or battery pack is improperly replaced, there will be explosion hazard. Only technical engineers of our company or our authorized service points can replace with battery of the same or equivalent type.
- ③ The whole device and accessories should be placed in dry ventilated indoor places to avoid rain, water drop, water ingress, fall and coverage of vent holes.
- ④ To protect the environment, put the discarded products into the designated sorting trash bin and do not discard directly.



Only applicable to areas of an altitude below 2000m



Only applicable to non-tropical climate



The Bluetooth® words and trademarks are reserved by Bluetooth SIG, Inc.

Product information

Speaker output rating	3W RMS
Frequency response	20Hz~20KHz(± 1 dB)
SNR	>80dB
Bluetooth version	V4.2
Bluetooth distance	20m
Microphone sensitivity	26dB
Microphone frequency response	100Hz~8KHz
Microphone directivity	360 degree omnidirectional
Battery specification	3.7V/2500mAh
Charge time	3-4hours
Usage time	Talk time: 12 hours(Depending on the usage, the talk time varies)
Charge specification	5V/1A
Size	125x125x35mm
Weight	300g

FAQ:

Problem or phenomenon	Possible Causes	Method
Startup failure	Low or no battery	Access the adapter to charge
Automatic shutdown soon after starting up	Low battery	Access the adapter to charge
No sound	Check the correct connection; select correct audio input; turn on the volume	Select the correct audio input; adjust the device volume
USB failure	Error with using USB wire	Please use the original USB wire
AUX failure	Error with using AUX wire	Please use the original AUX wire
Device charge failure	Faulty charging device or full battery	Replace with a functional device

Warranty

Limited one (1) Year Warranty with proof of purchase. Exempt from warranty are limited-life consumable components subject to normal wear and tear, e.g. batteries and other accessories.

Contact us

For all customer service and technical support

Email: support@emeet.ai Website: www.emeet.ai

Federal Communication Commission (FCC) Radiation Exposure Statement

The device has been evaluated to meet general RF exposure requirement, The device can be used in portable exposure condition without restriction

FCC statements:

This device complies with part 15 of the FCC rules. Operation is subject to the following two conditions: (1) this device may not cause harmful interference, and (2) this device must accept any interference received, including interference that may cause undesired operation.

NOTE: The manufacturer is not responsible for any radio or TV interference caused by unauthorized modifications or changes to this equipment. Such modifications or changes could void the user's authority to operate the equipment.

NOTE: This equipment has been tested and found to comply with the limits for a Class B digital device, pursuant to part 15 of the FCC Rules. These limits are designed to provide reasonable protection against harmful interference in a residential installation. This equipment generates uses and can radiate radio frequency energy and, if not installed and used in accordance with the instructions, may cause harmful interference to radio communications. However, there is no guarantee that interference will not occur in a particular installation. If this equipment does cause harmful interference to radio or television reception, which can be determined by turning the equipment off and on, the user is encouraged to try to correct the interference by one or more of the following measures:

- Reorient or relocate the receiving antenna.
- Increase the separation between the equipment and receiver.
- Connect the equipment into an outlet on a circuit different from that to which the receiver is connected.
- Consult the dealer or an experienced radio/TV technician for help.

ISED:

This device complies with Industry Canada license-exempt RSS standard(s).

Operation is subject to the following two conditions:

- (1) this device may not cause interference, and
- (2) this device must accept any interference, including interference that may cause undesired operation of the device.

Cet appareil est conforme avec Industrie Canada RSS exemptes de licence standard(s).

Son fonctionnement est soumis aux deux conditions suivantes:

- (1) cet appareil ne peut pas provoquer d'interférences, et
- (2) cet appareil doit accepter toute interférence, y compris celles pouvant causer un mauvais fonctionnement de l'appareil.

This Class B digital apparatus complies with Canadian ICES-003.

Cet appareil numérique de la classe B est conforme à la norme NMB-003 du Canada.

Radiation Exposure Statement

The product comply with the Canada portable RF exposure limit set forth for an uncontrolled environment and are safe for intended operation as described in this manual. The further RF exposure reduction can be achieved if the product can be kept as far as possible from the user body or set the device to lower output power if such function is available.

Déclaration d'exposition aux radiations:

Le produit est conforme aux limites d'exposition pour les appareils portables RF pour les Etats-Unis et le Canada établies pour un environnement non contrôlé.

Le produit est sûr pour un fonctionnement tel que décrit dans ce manuel. La réduction aux expositions RF peut être augmentée si l'appareil peut être conservé aussi loin que possible du corps de l'utilisateur ou que le dispositif est réglé sur la puissance de sortie la plus faible si une telle fonction est disponible.