

**Take Off Guide**  
Maestro T4HU1608

MAESTRO  
remote control

### 1 Maestro Remote Control

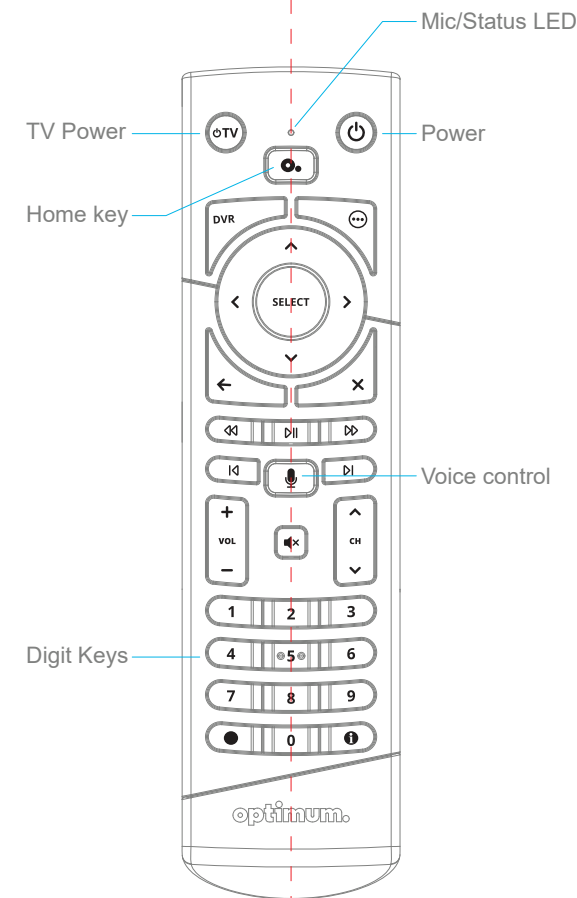

### 2 Turn On Maestro

Maestro remote control arrives with a 3 AAA batteries blister inside a polybag. To turn on your Maestro remote control, please follow the instructions below.

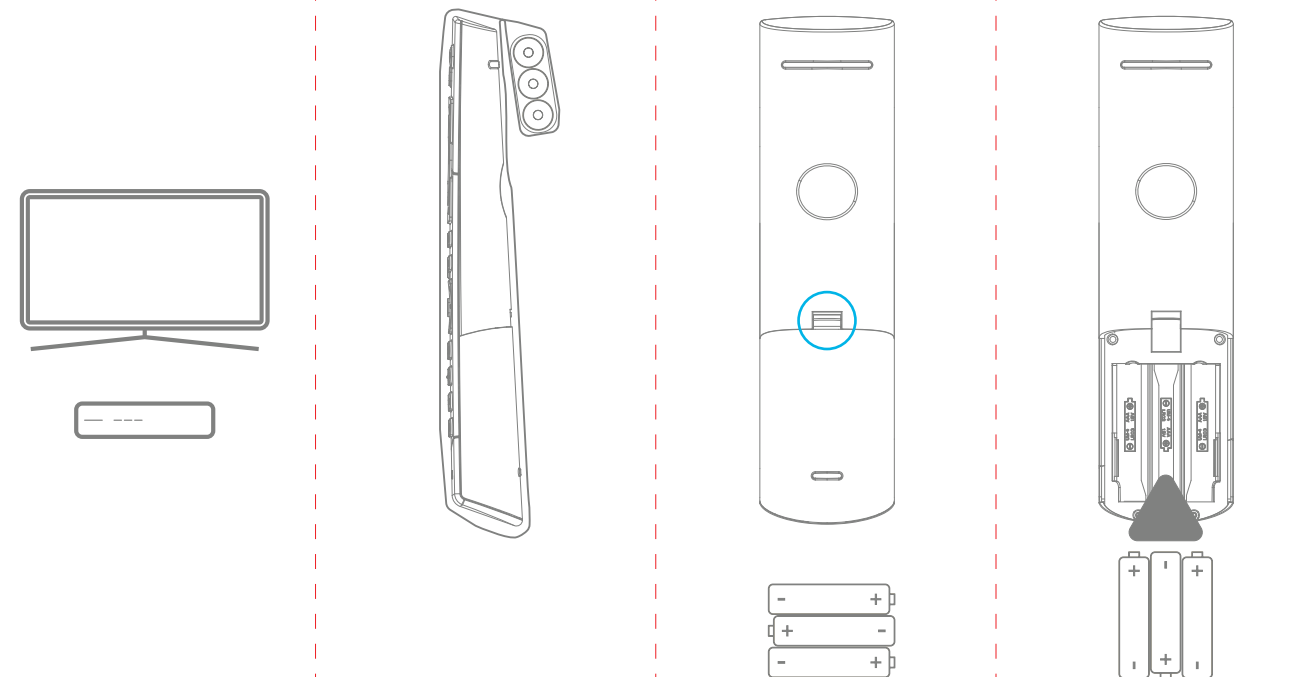

1. Turn ON your TV and your Set Top Box.
2. Remove your Maestro remote control and the batteries from the plastic bag.
3. Remove the battery lid.
4. Place the batteries on the Maestro remote control as indicated in the image above and close it with the battery lid.
5. After place the batteries, wait a few seconds and the Maestro is ready to operate.

### 3 Maestro Control Your TV

Maestro remote control is able to control your TV. This feature is called Quick Search by Brand. To setup your remote control, please follow the example below.

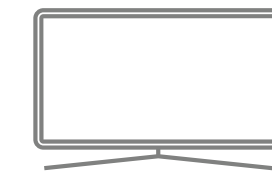

Top Brand ID	Brand Name
1	Insignia
2	LG
3	Panasonic
4	Philips/Magnavox
5	Samsung
6	Sanyo
7	Sharp
8	Sony
9	Toshiba
0	Vizio

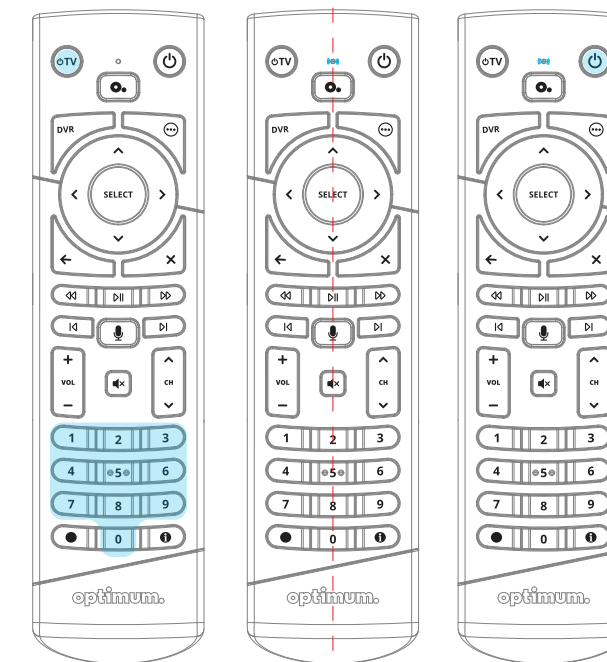

1. Turn on your TV.
2. In your Maestro remote control, press and hold by 3 seconds the TVpower key and the digit key which refers to your TV model.
3. The RCU confirms Setup mode activation by turning on the MIC LED. The MIC LED remains on while Quick Search by Brand is active
4. Release the keys.
5. Press and release the Power key until your TV turned off. Once your TV is turned off, the setup is completed. Now you can control your TV volume, mute and power on/off.

#### FCC Compliance Statements

This device complies with Part 15 of the FCC Rules. Operation is subject to the following two conditions: (1) this device may not cause harmful interference, and (2) this device must accept any interference received, including interference that may cause undesired operation.

NOTE: This equipment has been tested and found to comply with the limits for Class B digital device, pursuant to Part 15 of the FCC Rules. These limits are designed to provide reasonable protection against harmful interference in a residential installation. This equipment generates, uses and can radiate radio frequency energy and, if not installed and used in accordance with the instructions, may cause harmful interference to radio communications. However, there is no guarantee that interference will not occur in a particular installation.

If this equipment does cause harmful interference to radio or television reception, which can be determined by turning the equipment off an on, the user is encouraged to try to correct the interference by one or more of the following measures:

- Reorient or relocate the receiving antenna.
- Increase the separation between the equipment and receiver.
- Connect the equipment into an outlet on a circuit different from that to which the receiver is connected.
- Consult the dealer or an experienced radio/TV technician for help.

#### FCC Radiation Exposure Statement:

This equipment complies with FCC radiation exposure limits set forth for an uncontrolled environment. This transmitter must not be co-located or operating in conjunction with any other antenna or transmitter.