

Installing in-Car

1. Install firmly onto the windshield

- ❖ Attach camera to bracket

Attach the bracket to the device, slide it into bracket holder until it clicks.

- ❖ Detach camera from bracket

Press the unlock button and pull out from the bracket holder

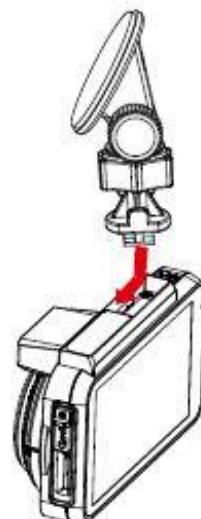
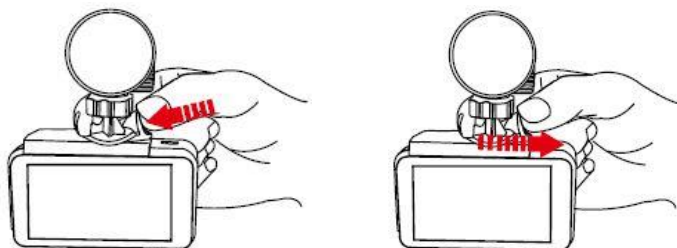

- ❖ Please ensure the bracket is firmly fixed.

Please clean the surface of the front windshield first. Peel off the protection film from the 3M adhesive bracket, place and press the bracket firmly onto the front windshield for 10s for strengthening.

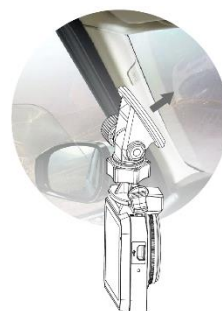

2. Adjust front camera position

- ❖ Loosen the knob, and adjust the device in vertical direction
- ❖ Loosen the knob and adjust the device in horizontal direction (360°)
- ❖ Tighten the knob and make sure the device is firmly fixed.

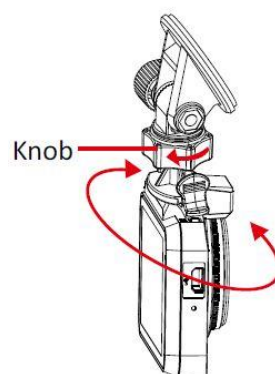
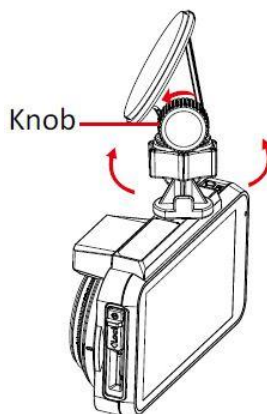

Connect to the vehicle power

- ❖ Please use the included car charger to power on and charge the super capacitor.
- ❖ Connect the cable of Car Cigar power charger to the USB slot of the device.

