

# Thrillmotion Cyber-Rex

2.4GHZ RC SERIES 6 CHANNEL

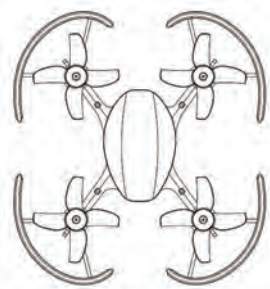

## Remote control Manual and Main features of Cyber-Rex

- The opposed four-axis structure makes the aircraft more flexible and faster when turning.
- The Built-in barometer allows you to hover precisely at any set height.
- Modular design facilitates faster replacement of damaged parts.
- One-click 360-degree roll feature.
- The materials and specifications in the manual or the parts in the package are for reference only.

1

## Safety and Precaution Guide

-This aircraft can be dangerous. Please fly in a safe area away from people. Improper installation of propellers and incorrect connection of electronic control equipment may damage this product.

-Users must pay close attention during flight, stay alert and use common sense.

- 1: Do not fly around crowds, children, and animals. Keep away from humid environments and water.
- 2: Please follow the instructions to assemble and to operate this product in a proper way.
- 3: Keep hands and fingers away from propellers and other parts of the drone that may cause injury.
- 4: Please operate in the order of power on / off. Incorrect power switch sequence may cause the product to run out of control and cause damage to itself or others.

## Disclaimer & Precautions

1: This product needs a high level of caution. Please read the disclaimer carefully before using this product. By using this product, you hereby agree to this disclaimer and signify that you have read them carefully and completely.

**2: This product is not suitable for people under the age of 14.**

3: Please follow the instructions to assemble and to operate this product in a proper way.

## What is included:

- Cyber-Rex X1
- Radio X1
- Propeller X4
- Battery X1
- USB Charger X1
- Instruction manual X1
- Screwdriver X1

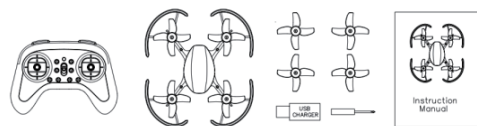

2

## Controller Features and Button Layout

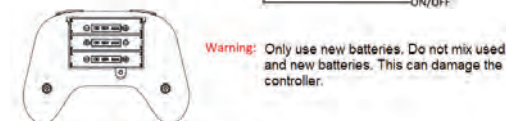
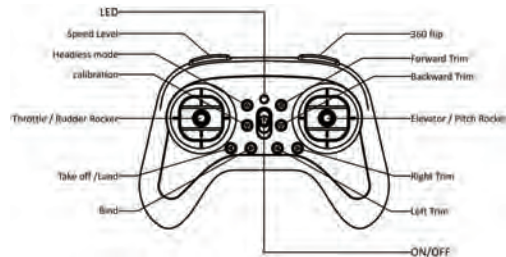

Use 3 \* 1.5V AAA batteries for assembly (not included in the package)

Do not mix alkaline, standard (carbon-zinc), or re-chargeable batteries.

## Flight control

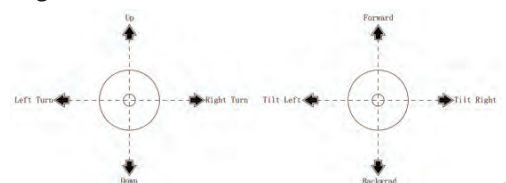

3

## Change Battery

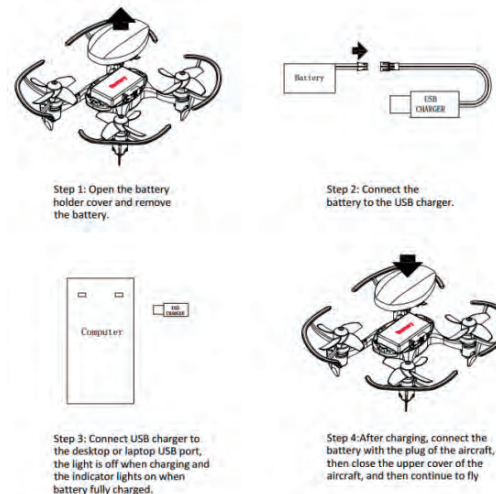

## Charging time

Approximate 50 minutes: for about 5-6 minutes flight-time

NOTE:

Please use the USB port of the computer to charge the battery. Do not use the charging plug of a mobile phone or tablet or use a socket with a USB plug to charge, this will damage the battery. Please do not leave the product alone when charging.

## Cautions when charging

- 1: When charging, please put this product on a dried or ventilated area and keep it away from heat sources that might be explosive.
- 2: Please remove the battery from the aircraft when charging. The charging process should be supervised by an adult to avoid accidents.
- 3: Please wait 5 minutes before recharging the battery after flying. Charging a hot battery can damage it and cause it to puff reducing its life cycle.
- 4: Please use the original USB charger in the package to charge the battery. If battery begins to swell after several uses, please stop using that battery and replace it.
- 5: Keep in mind, that leaving a drained battery without use for a long period of time will damage the battery.

## Starting guide

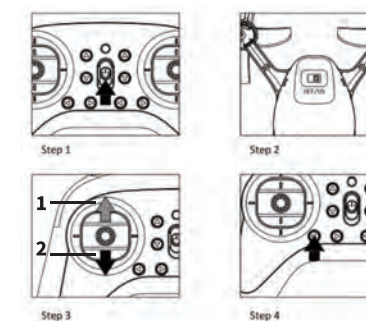

1. First, Push the power switch upwards to turn on remote control.
2. Connect the battery to the aircraft and install top cover in position before flying.
3. Then, push the left lever up and then down!
4. Final, Press the take off button on the controller to start flying.

5

## Land

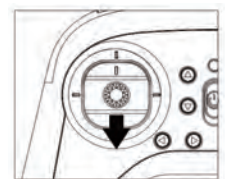

METHOD 1: Hold down the left stick, to lower the elevation of the drone, until it lands.

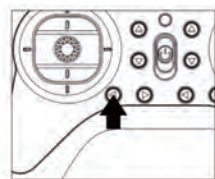

METHOD 2: Press the land button. The aircraft slowly descends from the air, to the ground.

## Remote control mode and instructions



Pressing the top left switch will rotate between 2 different speed levels. We recommend starting with the stock speed level, then work your way to the highest level. ONLY fly at higher speed levels outdoors when learning.

6

## Aircraft working direction

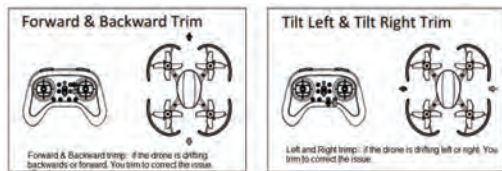

## Minor-tuning operation

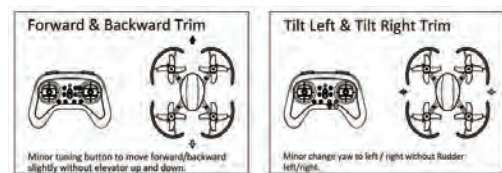

## Headless mode:

Headless mode makes it easy to fly the Cyber-Rex. When in headless mode, you will be able to control the drone in a way, that the orientation of the front of the drone will not matter.

7

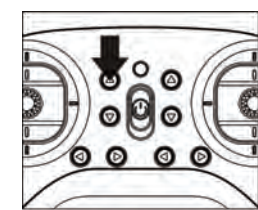

Press the Headless Mode button, the aircraft will Entry / Exit Headless Mode.

## 360° FLIP

The 360° flip feature allows the aircraft to maneuver a flip. You can decide which direction the drone will flip. Press the 360° flip button located on the top right side of the controller. Then use the right stick to direct what side the drone will do the 360° flip. Make sure you are at least 4 feet from the floor before doing so.

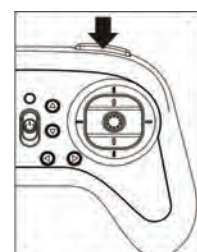

Step 1: Press 360 flip button.

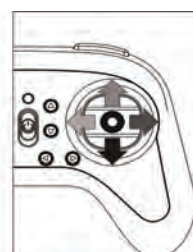

Step 2: Push the right rocker in any direction

8

## Radio / aircraft / charger indicator information

1. Control and Drone are not bound = Drone will flash continuously.
2. Drone is low battery: Drone will flash rapidly.
3. Charging indicators: A red light will turn on when the charger is connected to the USB port; While battery charges the light will stay one. Once the battery is fully charged, the light will turn off.

## Battery storage

- 1: The battery should be placed in a dry and ventilated place; the ambient temperature should be about 18-25 °C.
- 2: Repeated use will reduce the lifetime of the battery.
- 3: When storing the battery for a longer term, charge the battery to 50% to keep it from discharging to an unhealthy level.

## Propeller replacement guidelines

When installing a new set of propellers, you have to pay attention to the direction of the propellers. If the propellers are not in the correct direction, the drone will not fly. Please see graph below to match the direction of the propellers.

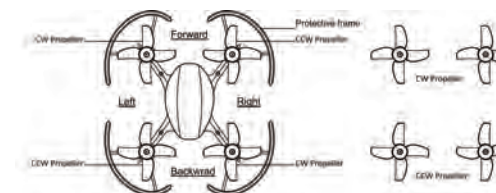

## FCC Warning Statement

Changes or modifications not expressly approved by the party responsible for compliance could void the user's authority to operate the equipment. This equipment has been tested and found to comply with the limits for a Class B digital device, pursuant to Part 15 of the FCC Rules. These limits are designed to provide reasonable protection against harmful interference in a residential installation. This equipment generates uses and can radiate radio frequency energy and, if not installed and used in accordance with the instructions, may cause harmful interference to radio communications. However, there is no guarantee that interference will not occur in a particular installation. If this equipment does cause harmful interference to radio or television reception, which can be determined by turning the equipment off and on, the user is encouraged to try to correct the interference by one or more of the following measures:

- Reorient or relocate the receiving antenna.
- Increase the separation between the equipment and receiver.
- Connect the equipment into an outlet on a circuit different from that to which the receiver is connected.
- Consult the dealer or an experienced radio/TV technician for help.



**WARNING:**

## CHOKING HAZARD

This product is not suitable for children under 14 years.



10

cyber-rex说明书  
黑白80g双胶纸  
尺寸:100X70mmX5p正反印刷

2021-1-22 by lin