



August 2020
QSG1_A_EN

Reolink Argus 2E
Quick Start Guide

Contents

What's in the Box	2
Camera Introduction	3
Set up the Camera	4
Charge the Battery	5
Install the Camera	6
Notes on PIR Motion Sensor	11
Important Notes on Rechargeable Battery	13
Troubleshooting	14
Specifications	15
Notification of Compliance	15

What's in the Box



Reolink Argus 2E



Micro USB Cable



Camera Bracket



Magnetic Bracket
(with Strap)

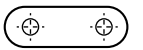

Mounting
Hole Template



Reset Needle

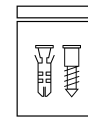

Pack of Screws



Surveillance Sign



Quick Start Guide

Camera Introduction

Micro USB Port

Speaker

6 Pcs IR LEDs

Daylight Sensor

Lens

Status LED

Built-in PIR Motion Sensor

Built-in Mic

Outdoor Security Mount

Reset Button

Micro SD Card Slot

Different states of the status LED:

● Red Light: WiFi connection Failed

● Blue Light: WiFi connection succeeded

Blinking: Standby status

On: Working status



Set up the Camera

Download and launch the Reolink App or Client software and follow the onscreen instructions to finish initial setup.

• On Smartphone

Scan to download the Reolink App.



• On PC

Download path of the Reolink Client: Go to <https://reolink.com> > Support > App & Client.

Charge the Battery



Charge the battery with a power adapter.



Charge the battery with the Reolink Solar Panel.



For better weatherproof performance, always keep the USB charging port covered with the rubber plug after charging the battery.

Charging indicator:

- Orange LED: Charging
- Green LED: Fully charged

NOTE: The battery is a built-in one so do not remove it from the camera. Also note that the solar panel is NOT included in the package. You can buy one on Reolink official online store.

Install the Camera

- Install the camera **2-3 meters (7-10 ft)** above ground. This height maximizes the detection range of the PIR motion sensor.
- For effective detection, please install the camera angularly.

NOTE: If a moving object approaches the PIR sensor vertically, the camera may fail to detect motion.

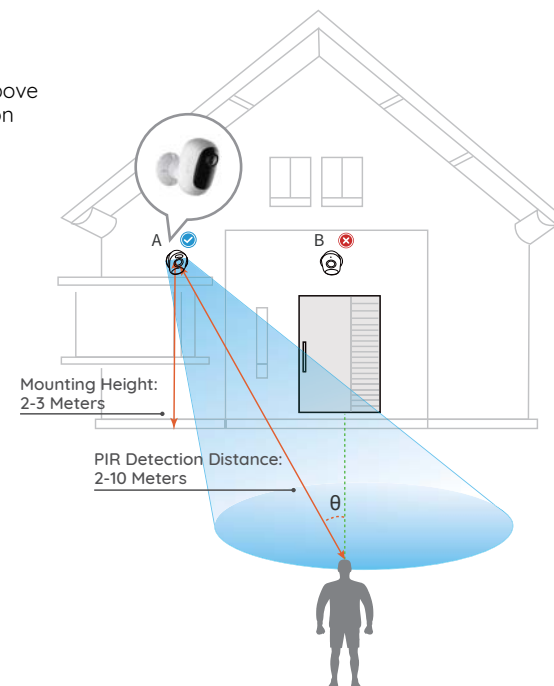

Install the Camera Outdoors

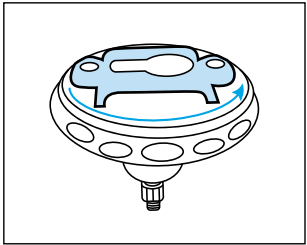

Rotate to separate parts of the bracket.

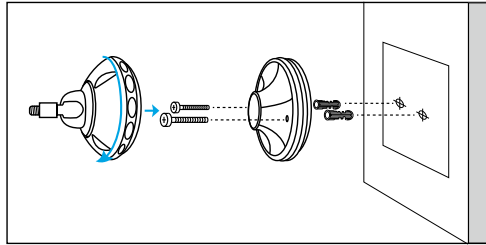

Drill holes in accordance with the mounting hole template and screw the base of the bracket onto the wall. Next, attach the other part of the bracket onto the base.

NOTE: Use the drywall anchors included in the package if needed.

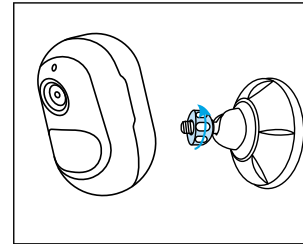

Screw the camera to the bracket.

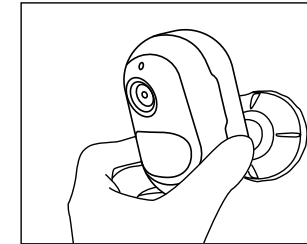

Adjust the camera angle to get the best field of view.

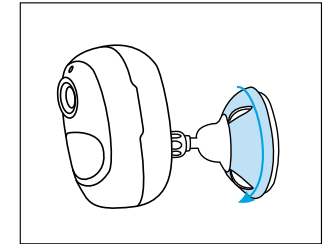

Secure the camera by turning the part on the bracket identified in the chart clockwise.

NOTE: To adjust the camera angle later, please loosen the bracket by turning the upper part anticlockwise.

Install the Camera Indoors

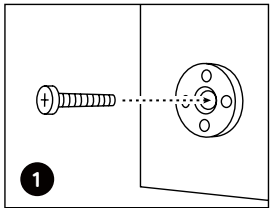

1 Screw the hook provided in the package to the wall.

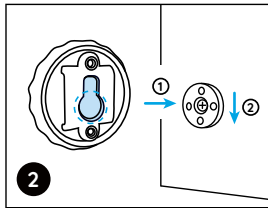

2 Hang the wall mount on to the hook.

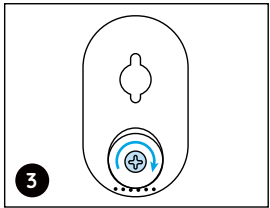

3 Screw the magnetic to the camera with screw driver.

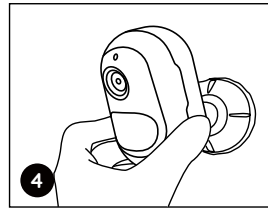

4 Attach the camera to the wall mount and twist the camera to adjust direction.

NOTE: The hook also supports to hang the other security bracket included in the package.

Install the Camera with Loop Strap

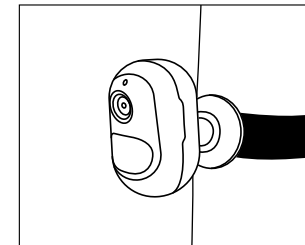
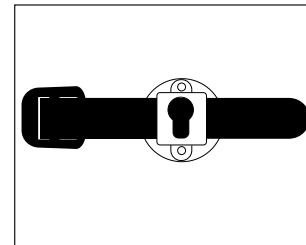

Thread the loop strap through the slots and fasten the strap. It is the most recommended installation method if you plan to set up the camera on the tree.

Notes on PIR Motion Sensor

Detection Distance of PIR Sensor

The PIR detection range can be customized to meet your specific needs. You can refer to the following table to set it up in Device Settings via Reolink App.

Sensitivity	Value	Detection Distance (For moving and living objects)
Low	0 - 50	Up to 5 meters (16ft)
Mid	51 - 80	Up to 8 meters (26ft)
High	81 - 100	Up to 10 meters (33ft)

NOTE: The detection range would be wider with higher sensitivity but it would lead to more false alarms. It is recommended to set up the sensitivity level to “Low” or “Mid” when you install the camera outdoors.



Important Notes on Reducing False Alarms

- Do not face the camera towards any objects with bright lights, including sunshine, bright lamp lights, etc.
- Do not place the camera too close to a place with heavy traffic. Based on our numerous tests, the recommended distance between the camera and the vehicle would be 16 meters (52ft).
- Do not place the camera near outlets, including the air conditioner vents, humidifier outlets, the heat transfer vents of projectors, etc.
- Do not install the camera at places with strong wind.
- Do not face the camera towards a mirror.
- Keep the camera at least 1 meter away from any wireless devices, including WiFi routers and phones in order to avoid wireless interference.

Important Notes on Rechargeable Battery Usage

Reolink Argus 2E is not designed for 24/7 full capacity running or around-the-clock live streaming. It's designed to record motion events and remotely view live streaming only when you need it. Learn useful tips on how to extend the battery life in this post:

<https://support.reolink.com/hc/en-us/articles/360006991893>

1. Charge the rechargeable battery with a standard and high-quality DC 5V/9V battery charger or Reolink solar panel. Do not charge the battery with solar panels from any other brands.
2. Charge the battery when temperatures are between 0°C and 45°C and always use the battery when temperatures are between -20°C and 60°C.
3. Keep the USB charging port dry, clean and free of any debris and cover the USB charging port with the rubber plug when the battery is fully charged.
4. Do not charge, use or store the battery near any ignition sources, such as fire or heaters.
5. Do not disassemble, cut, puncture, short-circuit the battery, or dispose of the battery in water, fire, microwave ovens and pressure vessels.
6. Do not use the battery if it gives off an odor, generates heat, becomes discolored or deformed, or appears abnormal in any ways. If the battery is being used or charged, remove the battery from the device or the charger immediately, and stop using it.
7. Always follow the local waste and recycle laws when you get rid of the used battery.

Troubleshooting

Camera Is Not Powering on

If your camera is not turning on, please apply the following solutions:

- Make sure the power switch is turned on.
- Charge the battery with a DC 5V/2A power adapter. When the green light is on, the battery is fully charged.

If these won't work, please contact Reolink Support <https://support.reolink.com/>.

Failed to Scan QR Code on the Phone

If you cannot scan QR code on your phone, please try the following solutions:

- Remove the protective film from the camera lens.
- Wipe the camera lens with a dry paper/towel/tissue.

- Vary the distance between your camera and the mobile phone so that the camera can focus better.
- Try to scan the QR code under sufficient lighting.

If these won't work, please contact Reolink Support <https://support.reolink.com/>.

Failed to Connect to WiFi During Initial Setup Process

If the camera fails to connect to WiFi, please try the following solutions:

- Please make sure the WiFi band is 2.4GHz because the camera does not support 5GHz.
- Ensure that you have entered the correct WiFi password.
- Put the camera closer to your router to ensure a strong WiFi signal.
- Change the encryption method of the WiFi network to WPA2-PSK/WPA-PSK (safer encryption) on your router interface.
- Change your WiFi SSID or password and

make sure that SSID is within 31 characters and password is within 64 characters.
• Set your password using only the characters available on the keyboard.

If these won't work, please contact Reolink Support <https://support.reolink.com/>.

Specifications

Video

Video Resolution: 1080p HD at 15 frames/sec
Field of View: 120° diagonal
Night Vision: Up to 10m (33 ft)

PIR Detection & Alerts

PIR Detection Distance:
Adjustable/up to 10m (33ft)
PIR Detection Angle: 100° horizontal
Audio Alert:
Customized voice-recordable alerts
Other Alerts:
Instant email alerts and push notifications

General

Operating Temperature:
-10°C to 55°C (14°F to 131°F) Weather Resistance:
IP65 certified weatherproof Size: 96 x 61 x 58 mm
Weight (Battery included): 230g

Notification of Compliance

FCC Caution

This device complies with part 15 of the FCC Rules. Operation is subject to the following two conditions: (1) This device may not cause harmful interference, and (2) this device must accept any interference received, including interference that may cause undesired operation.

Any Changes or modifications not expressly approved by the party responsible for compliance could void the user's authority to operate the equipment.

Note: This equipment has been tested and found to comply with the limits for a Class B digital device, pursuant to part 15 of the FCC Rules. These limits are designed to provide reasonable protection against harmful interference in a residential installation. This equipment generates uses and can radiate radio frequency energy and, if not installed and used in accordance with the instructions, may cause harmful interference to radio communications. However, there is no guarantee that interference will not occur in a particular installation. If this equipment does cause harmful interference to radio or television reception, which can be determined by turning the equipment off and on, the user is encouraged to try to correct the interference by one or more of the following measures:

- Reorient or relocate the receiving antenna.
- Increase the separation between the equipment and receiver.
- Connect the equipment into an outlet on a circuit different from that to which the receiver is connected.
- Consult the dealer or an experienced radio/TV technician for help.

This equipment complies with FCC radiation exposure limits set forth for an uncontrolled environment. This equipment should be installed and operated with minimum distance 20cm between the radiator & your body.

Simplified EU Declaration of Conformity

Reolink declares that this device is in compliance with the essential requirements and other relevant provisions of Directive 2014/53/EU.

Correct Disposal of This Product

This marking indicates that this product should not be disposed with other household wastes throughout the EU. To prevent possible harm

to the environment or human health from uncontrolled waste disposal, recycle it Simplified EU Declaration of Conformity responsibly to promote the sustainable reuse of material resources. To return your used device, please use the return and collection systems or contact the retailer where the product was purchased. They can take this product for environment safe recycling.

Limited Warranty

This product comes with a 2-year limited warranty that is valid only if purchased from Reolink official stores or a Reolink authorized reseller. Learn more: <https://reolink.com/warranty-and-return/>.

NOTE: We hope that you enjoy the new purchase. But if you are not satisfied with the product and plan to return, we strongly suggest that you reset the camera to factory default settings and take out the inserted SD card before returning.

Terms and Privacy

Use of the product is subject to your agreement to the Terms of Service and Privacy Policy at reolink.com. Keep it out of reach of children.

End User License Agreement

By using the Product Software that is embedded on the Reolink product, you agree to the terms of this End User License Agreement (“EULA”) between you and Reolink. [Learn more: https://reolink.com/eula/](https://reolink.com/eula/).

ISED Radiation Exposure Statement

This equipment complies with RSS-102 radiation exposure limits set forth for an uncontrolled environment. This equipment should be installed and operated with minimum distance 20cm between the radiator & your body.

OPERATING FREQUENCY (the maximum transmitted power)

2412MHz—2462MHz (15dBm)

Technical Support

If you need any technical help, please contact our support team before returning the products, <https://support.reolink.com>.

IC Caution:

This device complies with Industry Canada's licence-exempt RSSs. Operation is subject to the following two conditions:

- (1) This device may not cause interference; and
- (2) This device must accept any interference, including interference that may cause undesired operation of the device.

To maintain compliance with RF exposure guidelines, this equipment should be installed and operated with a minimum distance of 20cm between the radiator and your body.

Le présent appareil est conforme aux CNR d'Industrie Canada applicables aux appareils radio exempts de licence. L'exploitation est autorisée aux deux conditions suivantes:

- (1) l'appareil ne doit pas produire de brouillage, et
- (2) l'utilisateur de l'appareil doit accepter tout brouillage radioélectrique subi, même si le brouillage est susceptible d'en compromettre le fonctionnement.

Pour maintenir la conformité aux directives d'exposition aux radiofréquences, cet équipement doit être installé et utilisé avec une distance minimale de 20 cm entre le radiateur et votre corps.