

Netvue Technologies Co.,Ltd.

Address:

A501-502, Academy of Aerospace Technology,
10th Kejinan Road, Shenzhen Science Park,
Nanshan District, Shenzhen, P.R.China

Customer Service : +1(866)749-0567

Email : support@netvue.com

Website : www.netvue.com

©Netvue Technologies Co., Ltd
All rights reserved.

Version 1.1

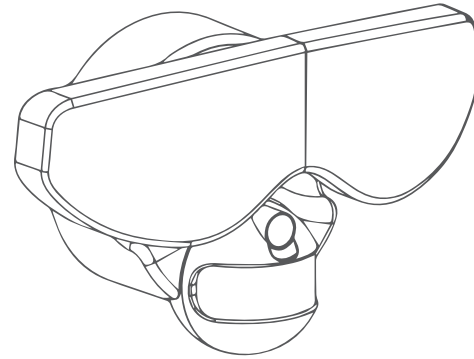

netvue Floodlight Cam

Quick Start Guide

1. FCC WARNING

1. This device complies with Part 15 of the FCC rules. Operation is subject to the following two conditions:

- (1) This device may not cause harmful interference .
- (2) This device must accept any interference received,including interference that may cause undesired operation.

2. Changes or modifications not expressly approved by the party responsible could void the user' s authority to operate the equipment.

NOTE:This equipment has been tested and found to comply within the limits for Class B digital device, pursuant to Part 15 of the FCC Rules.These limit a design to provide reasonable protection against harmful interference in residential installation.

This equipment generates uses and can radiate radio frequency energy and, if not installed and used in accordance with the instructions, may cause harmful interference to radio communication. However, there

is no guarantee that interference will not occur in a particular installation .If this equipment does cause harmful interference to radio or television reception, which can be determined by turning the equipment off and on, the user is encouraged to try to correct the interference by one or more of the following measures:

- Reorient or relocate the receiving antenna.
- Increase the separation between the equipment and receiver.
- Connect the equipment into an outlet on a circuit different from that to which the receiver is connected.
- Consult the dealer or an experienced radio/TV technician for help.

RF Exposure warning statement

The antennas used for this transmitter must be installed to provide a separation distance of at least 20cm from all persons and must not be collocated or operating in conjunction with any other antenna or transmitter.

2. PACKING LIST

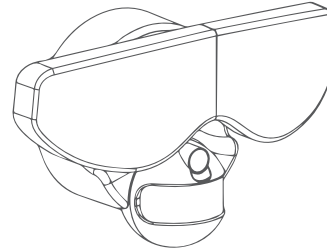

Floodlight Cam
X1



Quick Start Guide
X1



Waterproof sealing ring
X1



Hook
X1



Screw Accessories
X1



Installation bracket
(with earth wire)
X1



Electrical Cap
X3



Installation screw
X1



Setscrews
X2

3. HARDWARE INSTALLATION

Install on the mounting face

Step 1. Turn off the power at the breaker

Step 2. Mark two locations with setscrews on mounting surface spaced apart between 2in(52mm)~ 4in (102mm). Fig.1

(Note: The mounting holes should NOT be located over a drywall surface without a backing support, as this may not provide enough support for the weight of the device.)

Step 3. Drill pilot holes into each of the two marked locations. Fig.2

Tapping into the two longer setscrews in each pilot hole through bracket. Fig.3

Install on a power base junction box

Step 1. Tapping into two shorter setscrews in each pilot hole in the junction box. Fig.4

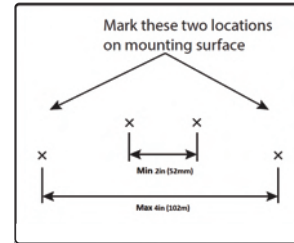

Fig.1

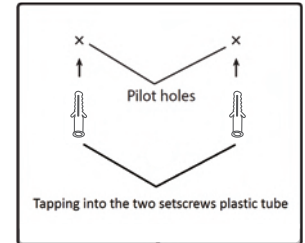

Fig.2

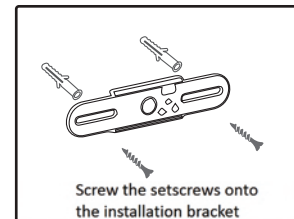

Fig.3

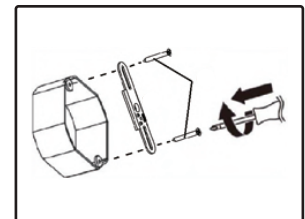
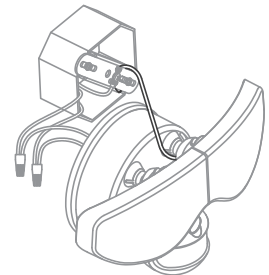

Fig.4

Common Step 1. Hang Floodlight Cam

Use the provided hook to hang Floodlight cam when connecting the wires. Hook one end of the provided hook to Floodlight cam, hook the other end into the bracket.



Common step 2. Connect the wires with Electrical caps.

(Note: After this step, we suggest that you configure the device (security light) in advance, please refer to below description, APP SETUP)

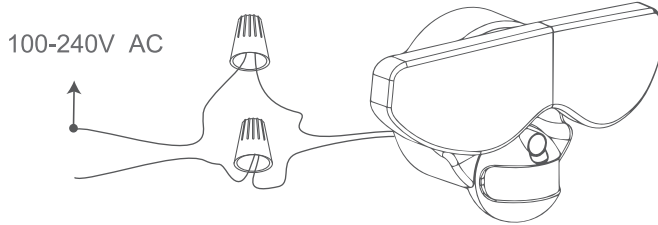
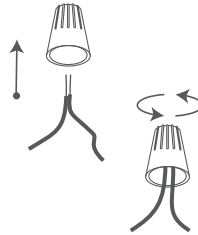

Common Step 3. After power is connected, insert the screw into the hole in the center of the device (Floodlight Cam), and cover the the hole with the rubber piece to finish the installation.

(Note: before this step, we suggest that you configure the device (Floodlight Cam) in advance, please refer to below description, APP SETUP)

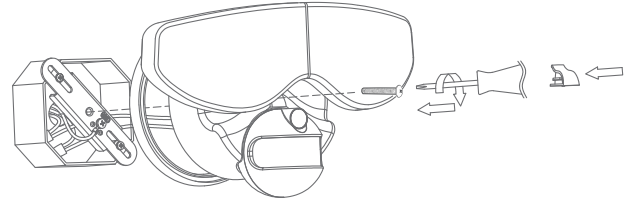

When install on the junction box, put the waterproof sealing ring between junction box and floodlight cam.

Notes:

1. Do not cut any wires with factory installed wire connectors or remove the wire connectors.
2. Do not install on circuits feeding motor loads such kitchen appliances, HVAC equipment, washer/dryer or garage door openers.
3. Do not install when it is raining.
4. Do not stare dierectly at the LEDs for more than a few seconds to avoid eye injury.

Do we need to include **all** the electrical qualifications this light meets? Tech Specifications, Guarantee.

FIRE RISK: Do not mount near combustibile for flammable surfaces.

Floodlight cam does not serviceable parts or replaceable LEDs.

Floodlight cam should be installed outdoors to a wall or eaves, not the ground.

Instructions do not cover everything.

4. APP SET-UP



App Store



Google Play

Scan QR code to download
netvue app

5. ADD DEVICE

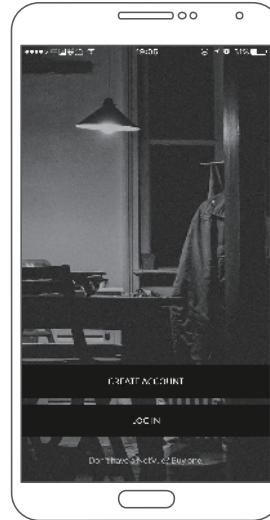

Open the APP



Register an account and log in

6. TWO CONNECTION METHODS

1. QR Code Connection.

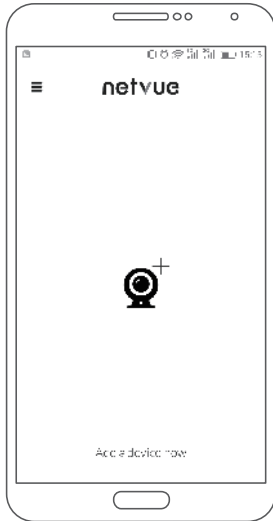

Add device

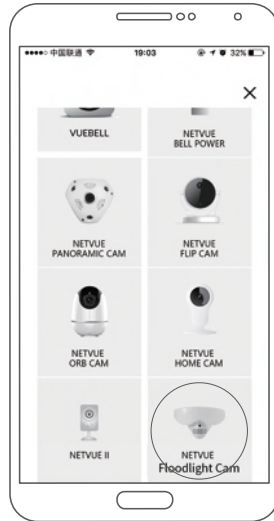

Choose Netvue Floodlight Cam

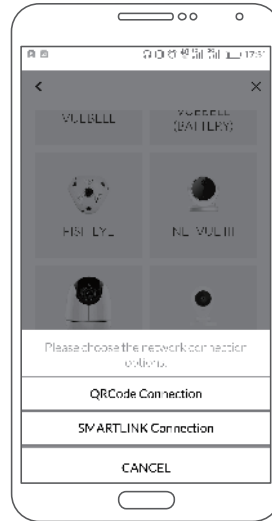

Click QR code connection

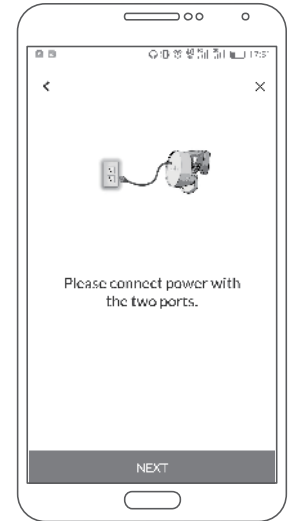

Connect power



Make sure all the devices are in the same WiFi network.



Enter Wi-Fi password. (Do not connect to a 5Ghz WiFi)

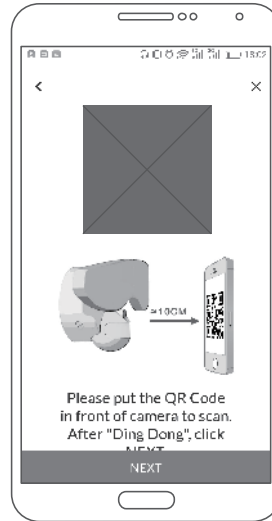

Scan QR code

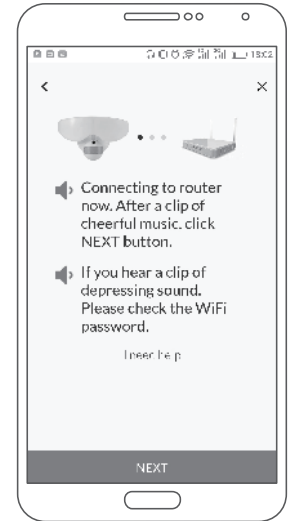

Connect to your router.

2. SMARTLINK Connection



Connect to the server

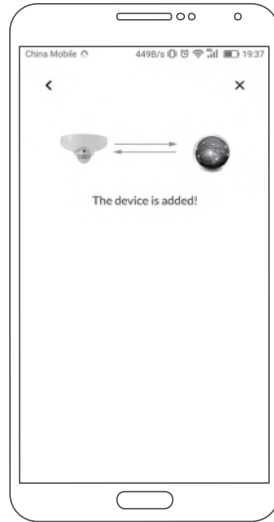

Device added

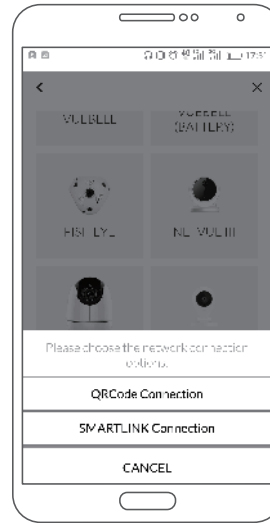

Click SMARTLINK connection

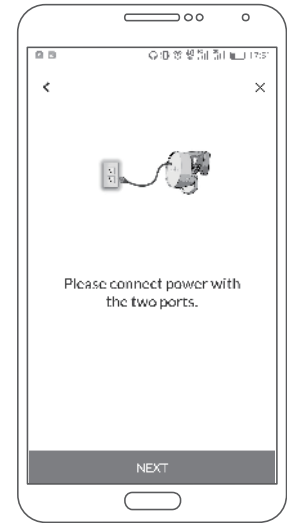

Connect power



Make sure all the devices are in the same WiFi network



Enter Wi-Fi password (Do not connect to a 5Ghz WiFi)



After hearing a buzz, click next

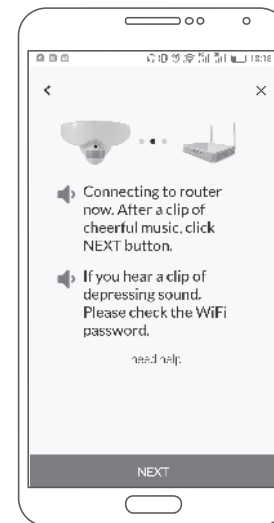

Connect to your router



Connect to the server

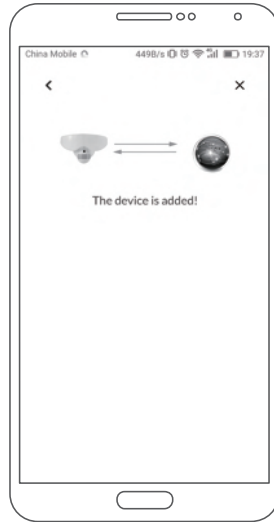

Device added

Notes:

1. Use a valid email address to register your account.
2. Keep the device in a 2.4G WiFi environment with good signal.
3. Strong lights may interfere with the ability for the device to read the QR code.
4. After connecting to the router, the device will make a “ding dong” sound effect. After connecting to the server successfully, it will play a cheerful chime; if it fails, it will play a sad sound effect.
5. If the server fails to connect, you may scan the device ID in the Floodlight cam to connect.

7. HOW TO USE

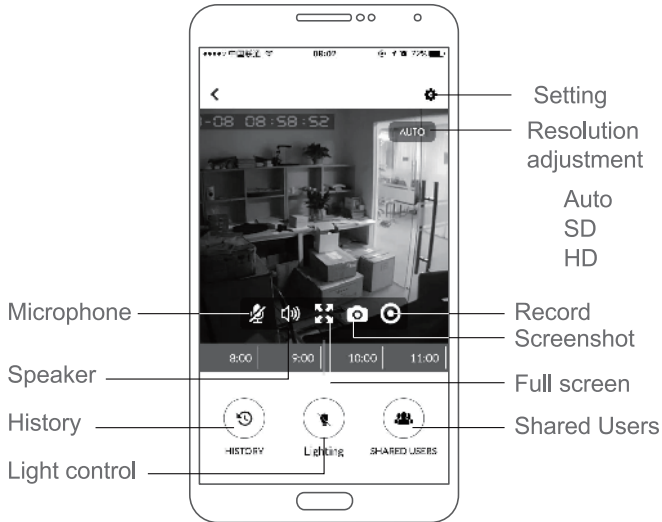

8. CUSTOMIZE MOTION ZONES

Select specific areas to detect or ignore motion. Only the highlighted green zones will be active.

