

WiFi Socket

User Manual



The devices are not intended for use in location where the temperature may be less than actual room conditions, such as unheated warehouses or garages.

Works with Amazon Alexa

Compatible with any smart phone, including Android devices, iPod, iPhone, iPad running Android or iOS.

Download and install the Xenon Smart app for either iOS or Android.



Android



iOS

Once downloaded, the app will ask you to register your device. Enter your smart phone number or email and select country and you will receive a text with the registration code.



Input the Registration Code you received via text and proceed to login.

1 2

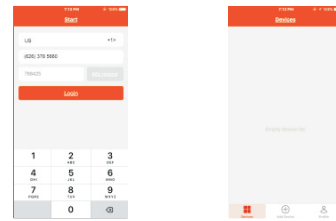

Power button



Adding a New Device in Quick Connection

* Make sure the multi-plug is standby (the blue light button flash in 2 times per second) after plug in the socket.
Otherwise, you should press the power button keep to 6 seconds to reset the multi-plug.
The multi-plug only supports 2.4GHz Wi-Fi router.

- * Open app and click "+" to add device.
- * Select WiFi network, input WiFi password, Connect and click.
- * Once connected the app will prompt the connection> click OK

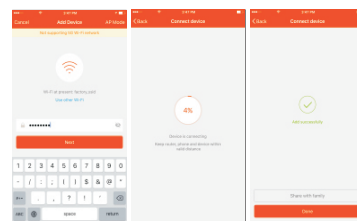

Adding a New Device in AP Mode

- * Make sure the multi-plug is standby (the blue light button flash in 2 times per second) after plug in the socket.
- * Press "+" in the main menu of app
- * Click "AP Mode" and press Next Step in Add Device
- * Select WiFi and input WiFi password, press Next in Set up Wi-Fi for device
- * Press Connect now
- * Go to WLAN setting in your smart phone and select the "SmartLife xxx" for your WiFi, no need to input password once you select the "SmartLifexxx" (you can directly to connect it if your OS is Android);
- * Go back to app and press "Connect" Device name is "SmartLife xxx",
- * Confirm Device

3 4

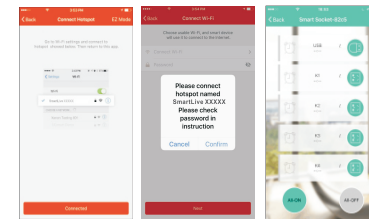
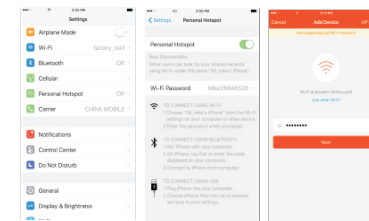

5 6

Why failed to add device?

- * Check routers or related:
- * If router is dual-band router, select 2.4G network and add device. You also need to enable router's broadcasting function.
- * Set up wireless router: Set encryption method as WPA2-PSK and authorization type as AES, or set both as auto. Wireless mode cannot be 11n only.
- * Don't use Chinese character to name router Wi-Fi.
- * To stay strong Wi-Fi signal, please keep device and router within certain distance.
- * Whether connected devices have reached the maximum number of router's connections. If so, please try by turning off the Wi-Fi connection of some device.
- * Router's wireless MAC filtering function is enabled. Remove the device from the filter list and make sure that router is not prohibiting device from connection. Make sure the password entered in App is correct when adding new device

Specification

- * 4 x AC110V-240V Outlets
- * 4 x USB Super Charging Ports
- * 1250W Output Rating
- * Versatile protection on all outlets
- * Compact design, lightweight and portable
- * Neatly arranged plug and ports
- * Includes built-in 5ft. power cord
- * 12 months Warranty and lifetime technical support
- * Radio Protocol: Wi-Fi
- * Radio frequency: 2.4GHz
- * Dimension: 198 x 98 x 28 mm multi-plug
237x 176 x 46 mm gift box

FCC Caution:

This device complies with part 15 of the FCC Rules. Operation is subject to the following two conditions: (1) This device may not cause harmful interference, and (2) this device must accept any interference received, including interference that may cause undesired operation.

Any Changes or modifications not expressly approved by the party responsible for compliance could void the user's authority to operate the equipment.

Note: This equipment has been tested and found to comply with the limits for a Class B digital device, pursuant to part 15 of the FCC Rules. These limits are designed to provide reasonable protection against harmful interference in a residential installation. This equipment generates uses and can radiate radio frequency energy and, if not installed and used in accordance with the instructions, may cause harmful interference to radio communications. However, there is no guarantee that interference will not occur in a particular installation. If this equipment does cause harmful interference to radio or television reception, which can be determined by turning the equipment off and on, the user is encouraged to try to correct the interference by one or more of the following measures:

- Reorient or relocate the receiving antenna.
- Increase the separation between the equipment and receiver.
- Connect the equipment into an outlet on a circuit different from that to which the receiver is connected.
- Consult the dealer or an experienced radio/TV technician for help.

This equipment complies with FCC radiation exposure limits set forth for an uncontrolled environment. This equipment should be installed and operated with minimum distance 20cm between the radiator & your body.